

Operator Exxon Corporation			Lease N. G. PENROSE			Well No. 4		
Unit Letter A	Section 13	Township 22 S	Range 37 E	County LEA				
Actual Footage Location of Well: 350 feet from the NORTH line and 660 feet from the EAST line								
Ground Level Elev: 3327'		Producing Formation BLINEBRY		Pool BLINEBRY		Dedicated Acreage: 40 Acres		

1. Outline the acreage dedicated to the subject well by colored pencil or hachure marks on the plat below.
2. If more than one lease is dedicated to the well, outline each and identify the ownership thereof (both as to working interest and royalty).
3. If more than one lease of different ownership is dedicated to the well, have the interests of all owners been consolidated by communitization, unitization, force-pooling, etc?

☐ Yes ☐ No If answer is "yes," type of consolidation _____

If answer is "no," list the owners and tract descriptions which have actually been consolidated. (Use reverse side of this form if necessary.) _____

No allowable will be assigned to the well until all interests have been consolidated (by communitization, unitization, forced-pooling, or otherwise) or until a non-standard unit, eliminating such interests, has been approved by the Commission.

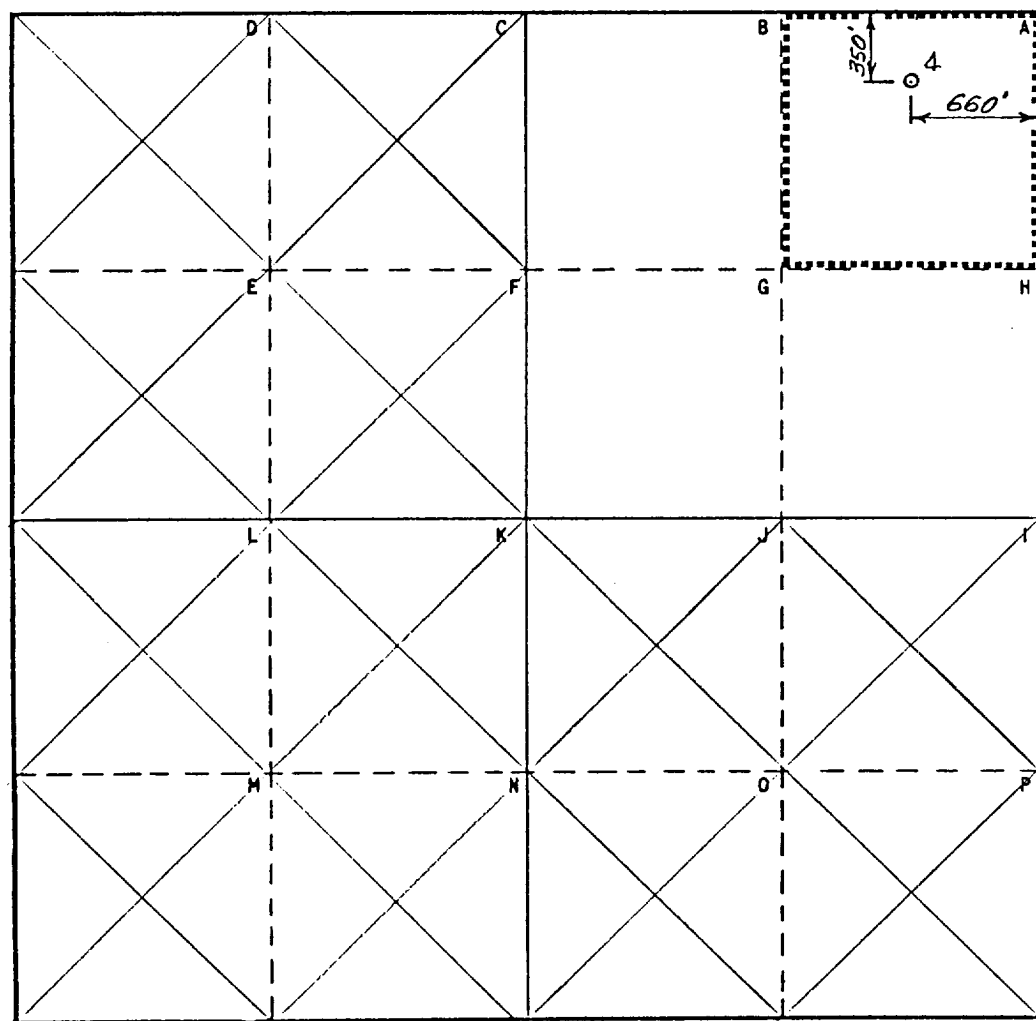

CERTIFICATION

I hereby certify that the information contained herein is true and complete to the best of my knowledge and belief.

Name David A. Murray
Position Permits Supervisor

Company Exxon Corporation
Box 1600 Midland, Texas

Date 7-9-87

I hereby certify that the well location shown on this plat was plotted from field notes of actual surveys made by me or under my supervision and that the same is true and correct to the best of my knowledge and belief.

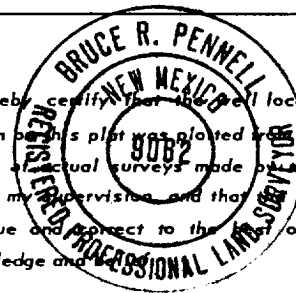

Date Surveyed 6-29-87

Registered Professional Engineer and/or Land Surveyor

Bruce R. Pennell

Certificate No.

9062