

STATE OF NEW MEXICO
ENERGY AND MINERALS DEPARTMENT

OIL CONSERVATION DIVISION

P. O. BOX 2088

SANTA FE, NEW MEXICO 87501

Form C-101
Revised 10-1-78

NO. OF COPIES RECEIVED	
DISTRIBUTION	
SANTA FE	
FILE	
U.S.G.S.	
LAND OFFICE	
OPERATOR	

5A. Indicate Type of Lease
STATE ☐ FEE ☒

5. State Oil & Gas Lease No.

APPLICATION FOR PERMIT TO DRILL, DEEPEN, OR PLUG BACK

1a. Type of Work b. Type of Well OIL WELL <input checked="" type="checkbox"/> GAS WELL <input type="checkbox"/> OTHER <input type="checkbox"/>		DRILL <input checked="" type="checkbox"/> DEEPEN <input type="checkbox"/> PLUG BACK <input type="checkbox"/>		7. Unit Agreement Name	
2. Name of Operator ARCO Oil and Gas Company		SINGLE ZONE <input checked="" type="checkbox"/> MULTIPLE ZONE <input type="checkbox"/>		8. Farm or Lease Name Seven Rivers Queen Uni	
3. Address of Operator Box 1610, Midland, TX 79702		9. Well No. 75		10. Field and Pool, or Wildcat Eunice 7RQ, South	
4. Location of Well UNIT LETTER <u>0</u> LOCATED <u>180</u> FEET FROM THE <u>South</u> LINE AND <u>2620</u> FEET FROM THE <u>East</u> LINE OF SEC. <u>34</u> TWP. <u>22S</u> RGE. <u>36E</u> NMPM		12. County Lea			
11. Elevations (Show whether DF, RT, etc.) 3499.3 GR		19. Proposed Depth 3900		19A. Formation 7RQ	
21A. Kind & Status Plug. Bond Statewide Blanket		21B. Drilling Contractor Not Assigned		20. Rotary or C.T. Rotary	
22. Approx. Date Work will start					

PROPOSED CASING AND CEMENT PROGRAM

SIZE OF HOLE	SIZE OF CASING	WEIGHT PER FOOT	SETTING DEPTH	SACKS OF CEMENT	EST. TOP
12-1/4	8-5/8	24	300	215	Surface
7-7/8	5-1/2	15.5	3900	850	Surface

Propose to drill and complete a development well in the Seven Rivers Queen Zone.
See attached:

1. Administrative Order NSL -2430
2. Drilling Prognosis
3. BOP Program

IN ABOVE SPACE DESCRIBE PROPOSED PROGRAM; IF PROPOSAL IS TO DEEPEN OR PLUG BACK, GIVE DATA ON PRESENT PRODUCTIVE ZONE AND PROPOSED NEW PRODUCTIVE ZONE. GIVE BLOWOUT PREVENTER PROGRAM, IF ANY.

I hereby certify that the information above is true and complete to the best of my knowledge and belief.

Signed Ken W. Gosnell Title Engr. Tech. 915/688-5672 Date 11-20-87

(This space for State Use)

ORIGINAL SIGNED BY JERRY SEXTON

APPROVED BY DISTRICT I SUPERVISOR TITLE DATE NOV 24 1987

CONDITIONS OF APPROVAL, IF ANY:

Permit Expires 6 Months From Approval
Date Unless Drilling Underway.

NSL 2430

RECEIVED

NOV 23 1987

CCD
HARRIS OFFICE

NEW MEXICO OIL CONSERVATION COMMISSION
WELL LOCATION AND ACREAGE DEDICATION PLAT

Form C-102
Supersedes C-128
Effective 1-1-65

All distances must be from the outer boundaries of the Section

Operator Arco Oil & Gas			Lease Seven Rivers Queen Unit		Well No. 75
Unit Letter 0	Section 34	Township 22 South	Range 36 East	County Lea	
Actual Footage Location of Well: 180 feet from the South line and 2620 feet from the East line					
Ground Level Elev. 3499.3	Producing Formation Seven Rivers Queen		Pool Eunice TRQ, South	Dedicated Acreage 40	

1. Outline the acreage dedicated to the subject well by colored pencil or hatchure marks on the plat below.
2. If more than one lease is dedicated to the well, outline each and identify the ownership thereof (both as to working interest and royalty).
3. If more than one lease of different ownership is dedicated to the well, have the interests of all owners been consolidated by communitization, unitization, force-pooling, etc?

☐ Yes ☐ No If answer is "yes," type of consolidation _____

If answer is "no," list the owners and tract descriptions which have actually been consolidated. (Use reverse side of this form if necessary.) _____

No allowable will be assigned to the well until all interests have been consolidated (by communitization, unitization, forced-pooling, or otherwise) or until a non-standard unit, eliminating such interests, has been approved by the Commission.

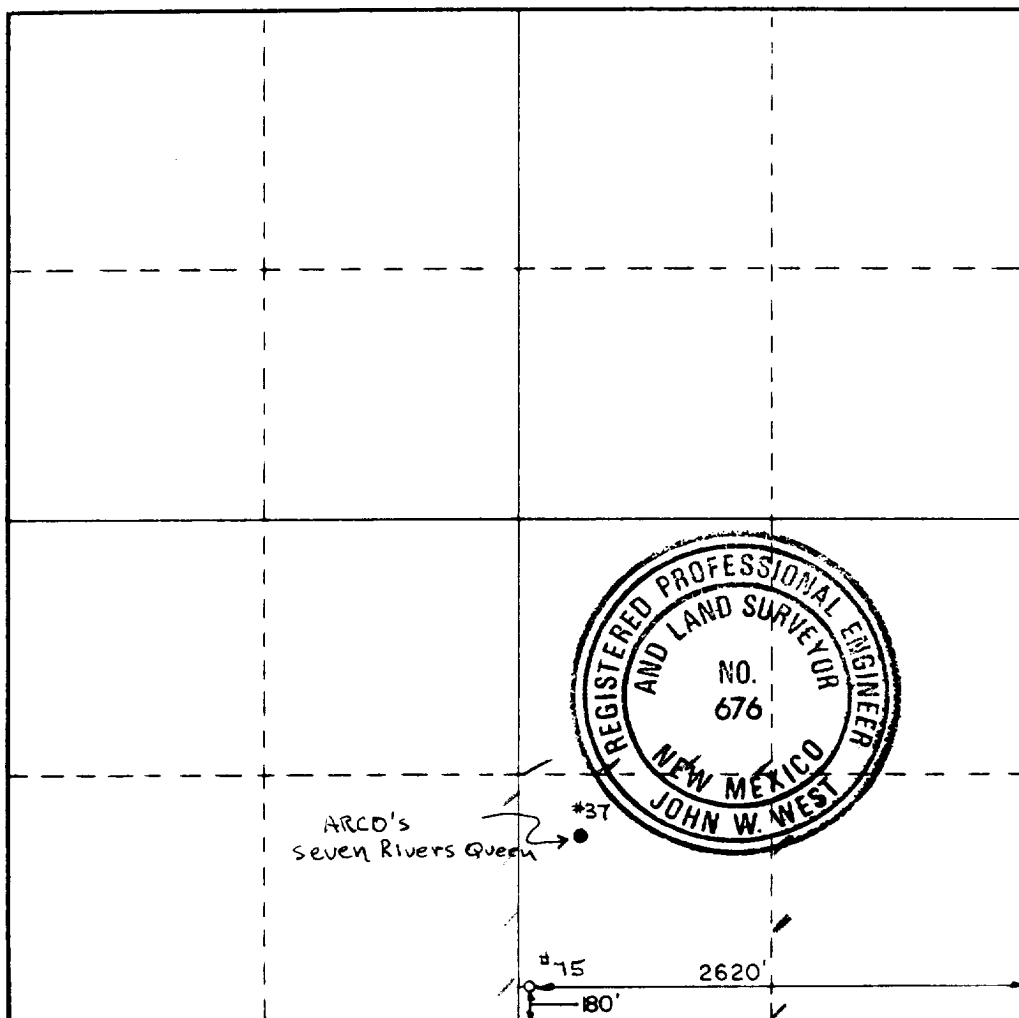

CERTIFICATION

I hereby certify that the information contained herein is true and complete to the best of my knowledge and belief.

Name
Ken W. Gosnell
Position
Engr. Tech.
Company
ARCO Oil & Gas
Date
11-20-87

I hereby certify that the well location shown on this plat was plotted from field notes of actual surveys made by me or under my supervision, and that the same is true and correct to the best of my knowledge and belief.

Date Surveyed
October 21, 1987

Registered Professional Engineer
and/or Land Surveyor

Certificate No. JOHN W. WEST, 676
RONALD J. EIDSON, 3239

HOBBE OFFICE
OCC
NOV 28 1997
RECEIVED



STATE OF NEW MEXICO

ENERGY, MINERALS AND NATURAL RESOURCES DEPARTMENT

OIL CONSERVATION DIVISION

GARREY CARRUTHERS
GOVERNOR

POST OFFICE BOX 2088
STATE LAND OFFICE BUILDING
SANTA FE, NEW MEXICO 87504
(505) 827-5800

November 4, 1987

ARCO Oil and Gas Company
P.O. Box 1610
Midland, TX 79702

Attention: D. J. Hartman

Administrative Order NSL-2430

Gentlemen:

Reference is made to your application for a non-standard location for your Seven Rivers Queen Unit No. 75 to be located 180 feet from the South line and 2620 feet from the East line of Section 34, Township 22 South, Range 36 East, South Eunice Seven Rivers Queen Pool, Lea County, New Mexico. The SW/4 SE/4 of said Section 34 shall be dedicated to the well.

By authority granted me under the provisions of Rule 104 F(I), the above-described unorthodox location is hereby approved.

Sincerely,

A handwritten signature in dark ink, appearing to read "William J. LeMay".

WILLIAM J. LeMAY, DIRECTOR

WJL/DRC/ag

cc: Oil Conservation Division - Hobbs

Drilling Prognosis

Well name

Seven Rivers Queen Unit #75

Date

9/10/87

Authorization numbers

District or province

Central District - North Area

Location

150' FSL and 2630' FWL

Section 34, T22S, R36E, Lea County, New Mexico

Objectives

Seven Rivers/Queen

Total vertical depth

3880'

Total measured depth

3880'

Elevation

The RKB and GL elevations will be recorded on first daily drlg report ($\pm 3510'$)

Estimated formation tops

Top of Salt	- 1500'	Queen	- 3710'
Base of Salt	- 3010'		
Yates	- 3095'		
Seven Rivers	- 3320'		

Well design

Conductor

0 - $\pm 40'$ 16" Conductor grouted to surface with redi-mix.

Surface casing

0 - 300' 8-5/8", 24#, K-55, STC csg.
Cemented to surface with 215 sx Class "H" + 2% CaCl₂
(100% excess).

Protective casings and liners

NA

Production casing

0 - 3880' 5-1/2", 15.5#, K-55, LTC csg.
Cemented to surface with 550 sx Class "H" 65:35:6, followed by
300 sx Class "H" + WL additive (Assumes 100% excess).

Production liner

NA

Casinghead

8-5/8" x 11", 3000 psi WP SOW casinghead
11" 3000 psi x 7-1/16" 3000 psi WP tubinghead

Mud program

0 - 300' Fresh water spud mud
300' - 3880' Salt water, 10 ppg. Reduce FL to 10 - 15cc from 3300' to TD

Logging program

Open Hole: FDC/CNL/GR-Cal (2800 - 3880')
CNL/GR-Cal (2800 - 300')
10 RFIS

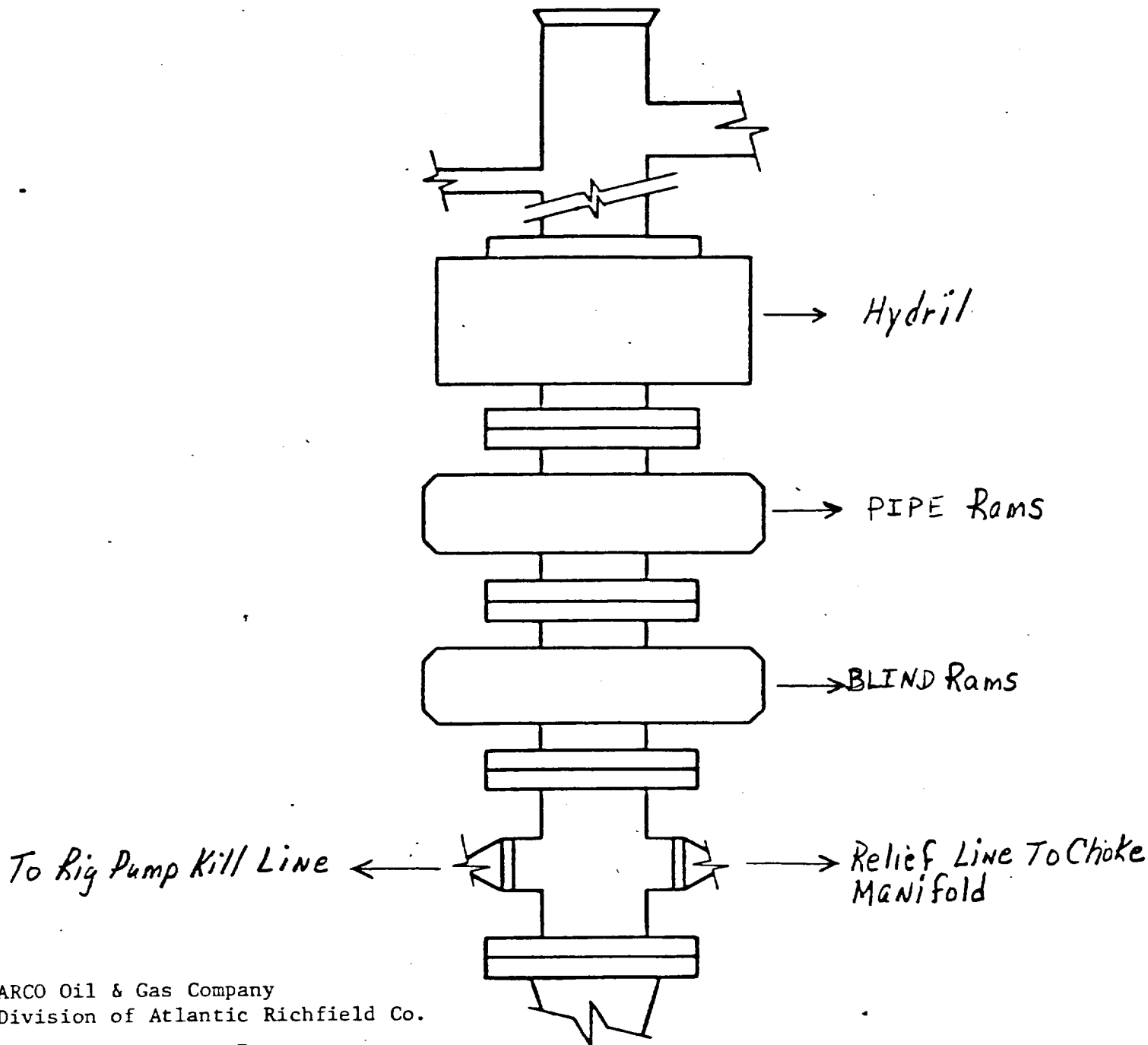

ARCO Oil & Gas Company
 Division of Atlantic Richfield Co.
 Blow Out Preventer Program

Lease Name: Seven Rivers Queen Unit

Well No: 75

Location: 180 FSL & 2620 FEL (Unit Letter O)

Sec. 34-22S-36E, Lea Co. NM

BOP to be tested when installed on well
 and will be maintained in good working
 condition during drilling. All wellhead
 fittings to be of sufficient pressure to
 operate in a safe manner.

RECEIVED
NOV 28 1987
CCD
MOBBS OFFICE

88-4-2-4-88
173