



STATE OF NEW MEXICO
ENERGY, MINERALS AND NATURAL RESOURCES DEPARTMENT

OIL CONSERVATION DIVISION
HOBBS DISTRICT OFFICE

BRUCE KING
GOVERNOR

9-17-93

POST OFFICE BOX 1980
HOBBS, NEW MEXICO 88241-1980
(505) 393-6161

OIL CONSERVATION DIVISION
P. O. BOX 2088
SANTA FE, NEW MEXICO 87501

4-1-3372 (SD)

RE: Proposed:

MC _____
DHC _____
NSL X _____
NSP _____
SWD _____
WFX _____
PMX _____

SD

Gentlemen:

I have examined the application for the:

Sexton Corp. J.L. Greenwood #116-N-9-22-37
Operator Lease & Well No. Unit S-T-R

and my recommendations are as follows:

OK

Yours very truly,

Jerry Sexton
Supervisor, District 1

- /ed

EXXON COMPANY, U.S.A.

POST OFFICE BOX 1600 • MIDLAND, TEXAS 79702-1600

PRODUCTION DEPARTMENT
SOUTHWESTERN DIVISION

ENVIRONMENTAL AND REGULATORY AFFAIRS

Unorthodox Location
Simultaneous Dedication
J. L. Greenwood #13 and #16
Units: L&N
Section 9, T22S-R37E
Lea County, New Mexico
Blinebry (Pro Gas) (Consolidated)

Mr. Michael E. Stogner
New Mexico Oil Conservation Division
P. O. Box 2088
Santa Fe, New Mexico 87504-2088

Dear Mr. Stogner:

Exxon Corp. requests administrative approval of an Unorthodox Location for the J. L. Greenwood #16 based on Rule 104 F,1 "the recompletion of a well previously drilled to a deeper horizon, provided said well was drilled at an orthodox or approved unorthodox location for such original horizon". The #16 was previously an oil completion at an orthodox location in the Paddock. Presently, the #16 is an oil completion in the Blinebry Oil and Gas Pool. Approval has been requested to add Blinebry perforations, acidize and frac. Adding Blinebry perforations will cause this well to go from an oil well to a gas well and therefore be at an unorthodox location in the Blinebry (Pro Gas) (Consolidated).

The J. L. Greenwood #13 is presently completed in the Blinebry (Pro Gas) (Consolidated). Both #13 and #16 are located in the SW/4 of Section 9, T22S-R37E, Lea County, Unit Letters L and N, respectively. Administrative approval is requested to Simultaneously Dedicate the SW/4 160 acres, to both the #13 and #16.

A list of the offset operators that have been notified and a copy of the letter and certified return receipts are enclosed. We have requested that they execute a waiver and send one copy to the N.M.O.C.D and one copy to Exxon.

Administrative Order NSC-3220 (SD) authorized the unorthodox location of well #9 and simultaneous dedication of wells #9 and #11 in the SE4, 160 acres, of Section 9, T22S-R37E.

Also enclosed is a copy of the C102 and C103 that were sent to the district. If you have any questions, please call me at 915/688-6782.

Sincerely,

Alex M. Correa

AMC/mcn
Enclosure
B:51.AMC

RECEIVED

SEP 16 1993

ODD RULES
OFFICE

EXXON COMPANY, U.S.A.

POST OFFICE BOX 1600 • MIDLAND, TEXAS 79702-1600

PRODUCTION DEPARTMENT
SOUTHWESTERN DIVISION

ENVIRONMENTAL AND REGULATORY AFFAIRS

Unorthodox Location
Simultaneous Dedication
J. L. Greenwood #13 and #16
Units: L & N
Section 9, T22S-R37E
Lea County, New Mexico
Blinebry (Pro Gas) (Consolidated)

Offset Operators

Gentlemen:

Exxon Corp. has requested administrative approval of an Unorthodox Location for the J. L. Greenwood #16 and Simultaneous Dedication for the #13 and #16 in the Blinebry (Pro Gas) (Consolidated). These wells are located in Section 9, T22S-R37E, Lea County, New Mexico, Unit Letters L and N, respectively.

Approval is being requested to add additional Blinebry perforations to the #16, acidized and frac. Adding Blinebry perforations will cause this well to go from an oil well to a gas well and therefore be at an unorthodox location.

The #13 is presently completed in the Blinebry (Pro Gas) (Consolidated). Both the #13 and #16 are located in the SW quarter of Section 9 thus requiring Simultaneous Dedication. Copies of the documents sent to the N.M.O.C.D, Santa Fe, are enclosed.

If you have no objections to the above referenced Unorthodox Location and Simultaneous Dedication, please sign and return one copy of the enclosed waiver to the N.M.O.C.D. office in Santa Fe and one copy to me. Return envelopes are enclosed. If you have any questions, please call me at 915/688-6782.

Sincerely,



Alex M. Correa

AMC/mcn
Enclosures
B:49.AMC

RECEIVED

SEP 13 1993

RECEIVED
OFFICE

OFFSET OPERATORS

J. L. GREENWOOD #13 AND #16
SECTION 9, T22S-R37E
Lea County, Mexico

William B. Yarbarough
1400 Briercroft Bldg.
Midland, TX 79701

Zia Energy Inc.
P. O. Box 2219
Hobbs, NM 88240

Shell Western E&P Inc.
Attn: Land Dept.
P. O. Box 576
Houston, TX 77001-0576

Mobil Prod. TX & NM Inc.
Attn: Land Dept
P. O. Box 633
Midland, TX 79702

John H. Hendrix Corp.
223 W. Wall, Ste. 525
Midland, TX 79701-4519

Chevron USA, Inc.
Attn: Land Dept.
P. O. Box 1150
Midland, TX 79702

Amerada Hess Corp.
Attn: Land Dept.
1201 Louisiana, Ste. 700
Houston, TX 77002

Hawkins Oil & Gas Inc.
400 S. Boston, Ste. 800
Tulsa, OK 74103

RECEIVED

SEP 16 1993

JOHN HODGINS
OFFICE

WAIVER

New Mexico Oil Conservation Division
P.O. Box 2088
Santa Fe, New Mexico 87504-2088

This is to advise that the undersigned has been given due notice that Exxon Corp. has made application for an Unorthodox Location for the J.L. Greenwood #16 and Simultaneous Dedication for the J.L. Greenwood #13 and #16 in the Blinebry (Pro Gas) (Consolidated).

We, the undersigned, hereby waive any objection to the granting of this application for an Unorthodox Location for the J.L. Greenwood #16 and Simultaneous Dedication for the J.L. Greenwood #13 and #16 in the Blinebry (Pro Gas) (Consolidated). The #13 is located 1980' FSL & 990' FWL and the #16 is 922' FSL & 2238' FWL of Section 9, T22S - R37E, Lea Co., NM.

Executed this _____ day of _____, 1993.

Company _____

By _____

RECEIVED

SEP 15 1993

SEP 15 1993

Offset Operators to J.L. Greenwood Lease - Exxon Corp.

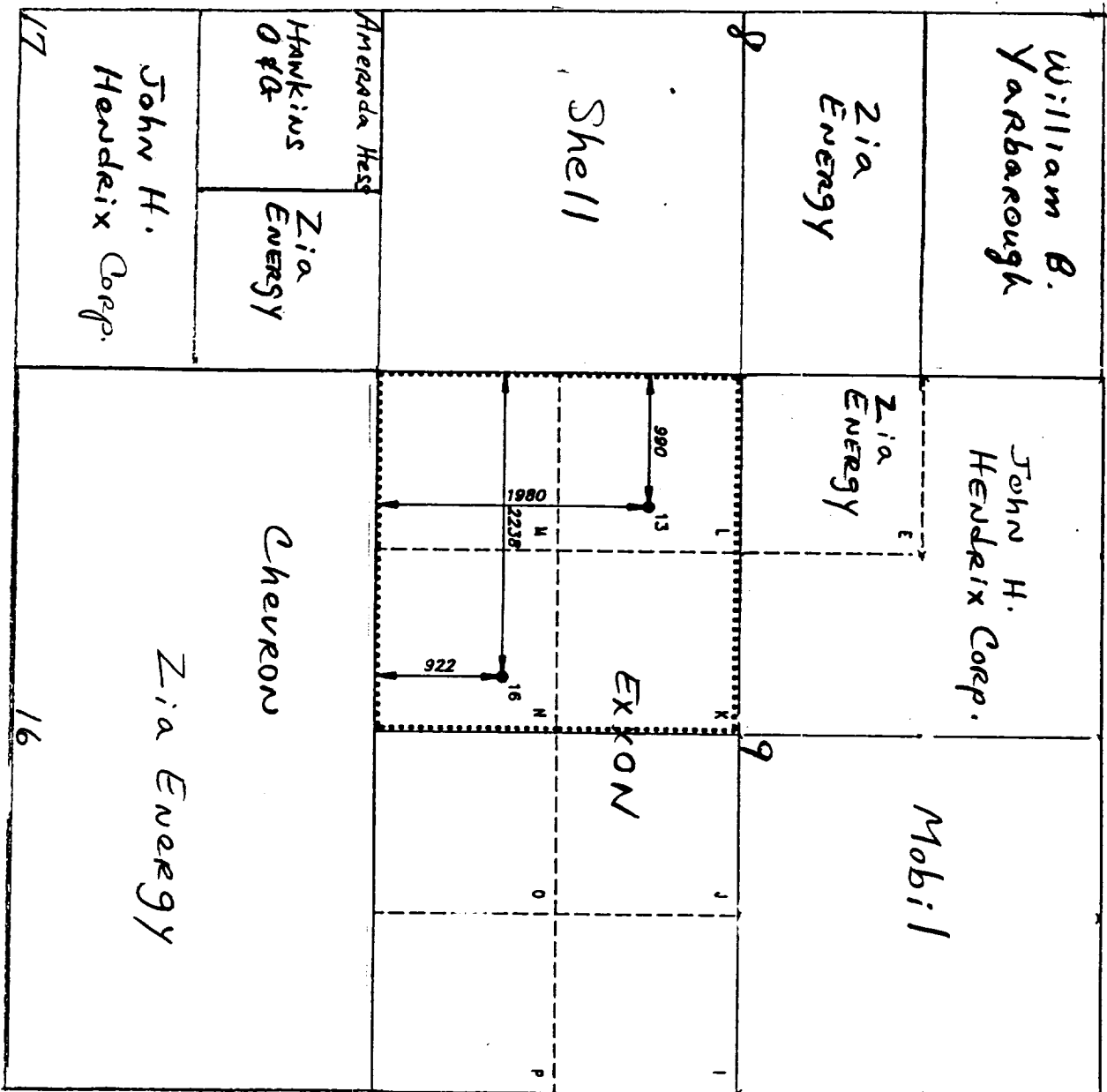

RECEIVED

SEP 11 1993

SPRINT