

Operator Exxon Corporation		Lease J.L. Greenwood		Well No. 16
Unit Letter N	Section 9	Township 22 South	Range 37 East	County Lea
Actual Footage Location of Well: 921.5 feet from the South line and 2238.5 feet from the West line				
Ground Level Elev. 3411	Producing Formation Ellenburger	Pool Brunson	Dedicated Acreage: 40 Acres	

1. Outline the acreage dedicated to the subject well by colored pencil or hatchure marks on the plat below.
2. If more than one lease is dedicated to the well, outline each and identify the ownership thereof (both as to working interest and royalty).
3. If more than one lease of different ownership is dedicated to the well, have the interests of all owners been consolidated by communitization, unitization, force-pooling, etc?

☐ Yes ☐ No If answer is "yes," type of consolidation _____

If answer is "no," list the owners and tract descriptions which have actually been consolidated. (Use reverse side of this form if necessary.) _____

No allowable will be assigned to the well until all interests have been consolidated (by communitization, unitization, forced-pooling, or otherwise) or until a non-standard unit, eliminating such interests, has been approved by the Commission.

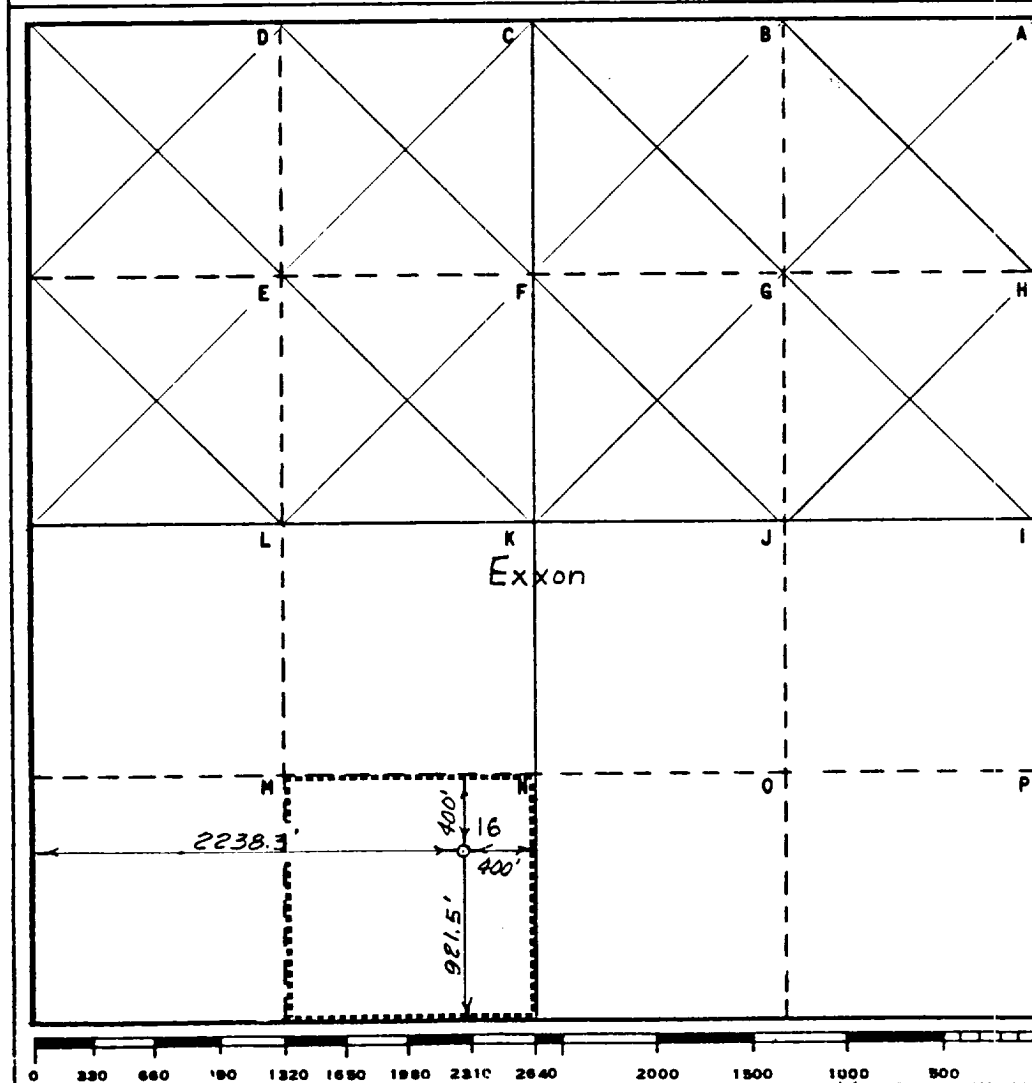

CERTIFICATION

I hereby certify that the information contained herein is true and complete to the best of my knowledge and belief.

Charlotte Harper

Name

Charlotte Harper

Position

PERMITS SUPERVISOR

Company Exxon Corporation

Box 1600 Midland, Texas

Date

8-26-88

I hereby certify that the well location shown on this plat was plotted from field notes of actual surveys made by me or under my supervision, and that the same is true and correct to the best of my knowledge and belief.

Date Surveyed

8-10-88

Registered Professional Engineer and/or Land Surveyor

Bruce R. Pennell

Certificate No.

#9062

2.5 Miles SW of Eunice, New Mexico

C.E. Sec. File No. WA-10139

RECEIVED

AUG 31 1988

DD
HOBBS OFFICE