

Submit to Appropriate  
District Office  
State Lease-6 copies  
Fee Lease-5 copies

State of New Mexico  
Energy, Minerals and Natural Resources Department

Form C-101  
Revised 1-1-89

OIL CONSERVATION DIVISION

P.O. Box 2088  
Santa Fe, New Mexico 87504-2088

DISTRICT I

P.O. Box 1980, Hobbs, NM 88240

DISTRICT II

P.O. Drawer Dd, Artesia, NM 88210

DISTRICT III

1000 Rio Brazos Rd., Aztec, Nm 87410

API NO. (assigned by OCD on New Wells)

30-025-31246

5. Indicate Type of Lease

STATE



FEE



6. State Oil & Gas Lease No.

7. Lease Name or Unit Agreement Name

ARROWHEAD GRAYBURG UNIT

8. Well No.

228

9. Pool name or Wildcat

ARROWHEAD/GRAYBURG

APPLICATION FOR PERMIT TO DRILL, DEEPEN, OF PLUG BACK

1a. Type of Work:

DRILL ☒

RE-ENTER ☐

DEEPEN ☐

PLUG BACK ☐

b. Type of Well:

OIL  
WELL ☒

GAS  
WELL ☐

OTHER

SINGLE  
ZONE ☒

MULTIPLE  
ZONE ☐

2. Name of Operator

CHEVRON U.S.A. INC.

3. Address of Operator

P.O. BOX 1150, MIDLAND, TX 79702 ATTN: P.R. MATTHEWS

4. Well Location

Unit Letter F : 2266 Feet From The NORTH Line and 1793 Feet From The WEST Line

Section 18 Township 22S Range 37E NMPM LEA County

10. Proposed depth

4500

11. Formation

GRAYBURG

12. Rotary or C.T.

ROTARY

13. Elevation (Show DF, RT, GR, etc.)

3425.1 GE

14. Kind & Status Plug Bond

BLANKET

15. Drig Contractor

UNKNOWN

16. Date Work will start

01-01-92

17. PROPOSED CASING AND CEMENT PROGRAM

SIZE OF HOLE	SIZE OF CASING	WEIGHT PER FOOT	SETTING DEPTH	SACKS OF CEMENT	EST. TOP
12 1/4"	8 5/8"	23	1350'	800	CIRC.
7 7/8"	5 1/2"	15.5	4500'	900	CIRC.

CHEVRON REQUEST TO CHANGE THE LOCATION FROM :

1880' FNL & 1980' FWL

TO: 2266' FNL & 1793' FWL SEC. 18, T22S, R37E.

CHEVRON ALSO REQUEST A SIX MONTH EXTENSION FOR THIS DRILLING PERMIT.

IN ABOVE SPACE DESCRIBE PROPOSED PROG IF PROPOSAL IS TO DEEPEN OR PLUG BACK, GIVE DATA ON PRESENT PRODUCTIVE ZONE AND PROPOSED  
NEW PRODUCTIVE ZONE. GIVE BLOWOUT PREVENTER PROGRAM, IF ANY.

I hereby certify that the information above is true and complete to the best of my knowledge and belief.

SIGNATURE P.R. Matthews TITLE TECHNICAL ASSISTANT DATE 10-25-91

TYPE OR PRINT NAME P.R. MATTHEWS TELEPHONE NO. (915)687-7812

ORIGINALLY SIGNED BY JERRY SEXTON

APPROVED BY JERRY D. SUPERVISOR TITLE  DATE OCT 29 1991

CONDITIONS OF APPROVAL, IF ANY:

Superior May 15, 1992

Submit to Appropriate  
District Office  
State Lease - 4 copies  
Fee Lease - 3 copies

State of New Mexico  
Energy, Minerals and Natural Resources Department

Form C-102  
Revised 1-1-89

OIL CONSERVATION DIVISION

P.O. Box 2088

Santa Fe, New Mexico 87504-2088

DISTRICT I

P.O. Box 1980, Hobbs, NM 88240

DISTRICT II

P.O. Drawer DD, Artesia, NM 88210

DISTRICT III

1000 Rio Brazos Rd., Aztec, NM 87410

WELL LOCATION AND ACREAGE DEDICATION PLAT

All Distances must be from the outer boundaries of the section

Operator CHEVRON U.S.A. INC.			Lease ARROWHEAD GRAYBURG UNIT		Well No. 228
Unit Letter F	Section 18	Township 22 SOUTH	Range 37 EAST	County NMPM LEA	
Actual Footage Location of Well: 2266 feet from the NORTH line and 1793 feet from the WEST line					
Ground level Elev. 3425.1	Producing Formation GRAYBURG		Pool ARROWHEAD	Dedicated Acreage: 40 Acres	

- Outline the acreage dedicated to the subject well by colored pencil or hatchure marks on the plat below.
- If more than one lease is dedicated to the well, outline each and identify the ownership thereof (both as to working interest and royalty).
- If more than one lease of different ownership is dedicated to the well, have the interest of all owners been consolidated by communitization, unitization, force-pooling, etc.?  
☐ Yes ☐ No If answer is "yes" type of consolidation \_\_\_\_\_  
If answer is "no" list the owners and tract descriptions which have actually been consolidated. (Use reverse side of this form if necessary.)  
No allowable will be assigned to the well until all interests have been consolidated (by communitization, unitization, forced-pooling, or otherwise) or until a non-standard unit, eliminating such interest, has been approved by the Division.

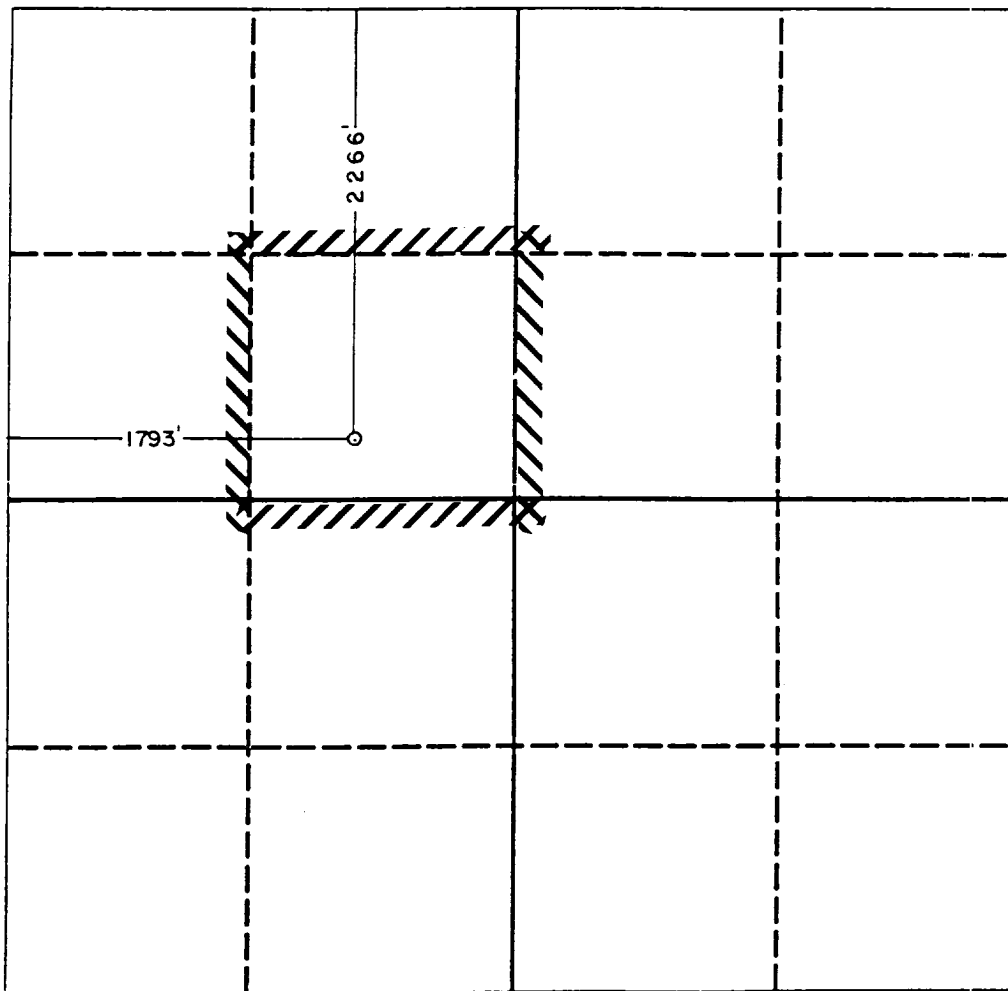

OPERATOR CERTIFICATION

I hereby certify that the information contained herein is true and complete to the best of my knowledge and belief.

Signature

P. R. Matthews

Printed Name

P. R. MATTHEWS

Position

TECHNICAL ASSISTANT

Company

CHEVRON U.S.A. INC.

Date

10-25-91

SURVEYOR CERTIFICATION

I hereby certify that the well location shown on this plat was plotted from field notes of actual surveys made by me or under my supervision, and that the same is true and correct to the best of my knowledge and belief.

Date Surveyed

10-14-91

Signature & Seal of  
Professional Surveyor

*Ronald J. Eidson*  
Certificate No. JOHN W. WEST, 676  
RONALD J. EIDSON, 3239

W.O. 91-14-0148