

UNITED STATES  
DEPARTMENT OF THE INTERIOR  
BUREAU OF LAND MANAGEMENT

APPLICATION FOR PERMIT TO DRILL OR DEEPEN

1a. TYPE OF WORK

DRILL ☒

DEEPEN ☐

b. TYPE OF WELL

OIL  
WELL ☒

GAS  
WELL ☐

OTHER

SINGLE  
ZONE ☒

MULTIPLE  
ZONE ☐

2. NAME OF OPERATOR

CHEVRON U.S.A. INC.

3. ADDRESS AND TELEPHONE NO.

P.O. BOX 1150 MIDLAND, TX 79702 ATTN: P.R. MATTHEWS

4. LOCATION OF WELL (Report location clearly and in accordance with any State requirements.)

At surface

UNIT # 660 FNL & 2045 FEL

At proposed prod. zone

14. DISTANCE IN MILES AND DIRECTION FROM NEAREST TOWN OR POST OFFICE\*

4 MILES S.W. FROM EUNICE NM.

10. DISTANCE FROM PROPOSED\*  
LOCATION TO NEAREST  
PROPERTY OR LEASE LINE, FT.  
(Also to nearest drlg. unit line, if any)

16. NO. OF ACRES IN LEASE

5922.26

17. NO. OF ACRES ASSIGNED  
TO THIS WELL

40

18. DISTANCE FROM PROPOSED LOCATION\*  
TO NEAREST WELL, DRILLING, COMPLETED,  
OR APPLIED FOR, ON THIS LEASE, FT.

19. PROPOSED DEPTH

4500'

20. ROTARY OR CABLE TOOLS

ROTARY

21. ELEVATIONS (Show whether DF, RT, GR, etc.)

3420.7 GE

22. APPROX. DATE WORK WILL START\*

4-25-92

PROPOSED CASING AND CEMENTING PROGRAM

SIZE OF HOLE	GRADE SIZE OF CASING	WEIGHT PER FOOT	SETTING DEPTH	QUANTITY OF CEMENT
12 1/4"	8 5/8"	23	1350	800 SXS. CIRCULATE
7 7/8"	5 1/2"	15.5	4500'	900 SXS. - SEE STIPS.

MUD PROGRAM: 0-1350' FRESH WATER SPUD MUD, 9.0 PPG.  
1350-4500" BRINE WATER AND STARCH, 10.0 PPG.

BOPE EQUIPMENT: 2000 PSI WORKING PRESSURE, SEE ATTACHED CHEVRON U.S.A.  
CLASS II DRAWING.

SEE ATTACHED TO  
GENERAL REQUIREMENTS AND  
SPECIAL STIPULATIONS  
ATTACHED

IN ABOVE SPACE DESCRIBE PROPOSED PROGRAM: If proposal is to deepen, give data on present productive zone and proposed new productive zone. If proposal is to drill or deepen directionally, give pertinent data on subsurface locations and measured and true vertical depths. Give blowout preventer program, if any.

SIGNED P.R. Matthews

TITLE TECHNICAL ASSISTANT

DATE 3-19-20

(This space for Federal or State office use)

PERMIT NO. \_\_\_\_\_

APPROVAL DATE \_\_\_\_\_

Application approval does not warrant or certify that the applicant holds legal or equitable title to those rights in the subject lease which would entitle the applicant to conduct operations thereon.  
CONDITIONS OF APPROVAL, IF ANY:

APPROVED BY \_\_\_\_\_

TITLE \_\_\_\_\_

DATE 4-2-92

\*See Instructions On Reverse Side

OIL CONSERVATION DIVISION

P.O. Box 2088

Santa Fe, New Mexico 87504-2088

DISTRICT I

P.O. Box 1980, Hobbs, NM 88240

DISTRICT II

P.O. Drawer DD, Artesia, NM 88210

DISTRICT III

1000 Rio Brazos Rd., Aztec, NM 87410

WELL LOCATION AND ACREAGE DEDICATION PLAT

All Distances must be from the outer boundaries of the section

Operator CHEVRON U.S.A. INC.			Lease ARROWHEAD GRAYBURG UNIT		Well No. 217
Unit Letter B	Section 18	Township 22 SOUTH	Range 37 EAST	NMPM	County LEA
Actual Footage Location of Well: 660 feet from the NORTH line and 2045 feet from the EAST line					
Ground Level Elev. 3420.7 GE	Producing Formation GRAYBURG	Pool ARROWHEAD		Dedicated Acreage: 40 Acres	

- Outline the acreage dedicated to the subject well by colored pencil or hachure marks on the plat below.
- If more than one lease is dedicated to the well, outline each and identify the ownership thereof (both as to working interest and royalty).
- If more than one lease of different ownership is dedicated to the well, have the interest of all owners been consolidated by communitization, unitization, force-pooling, etc.?  
☐ Yes ☐ No If answer is "yes" type of consolidation \_\_\_\_\_  
If answer is "no" list of owners and tract descriptions which have actually been consolidated. (Use reverse side of this form necessary.)  
No allowable will be assigned to the well unit all interests have been consolidated (by communitization, unitization, forced-pooling, otherwise) or until a non-standard unit, eliminating such interest, has been approved by the Division.

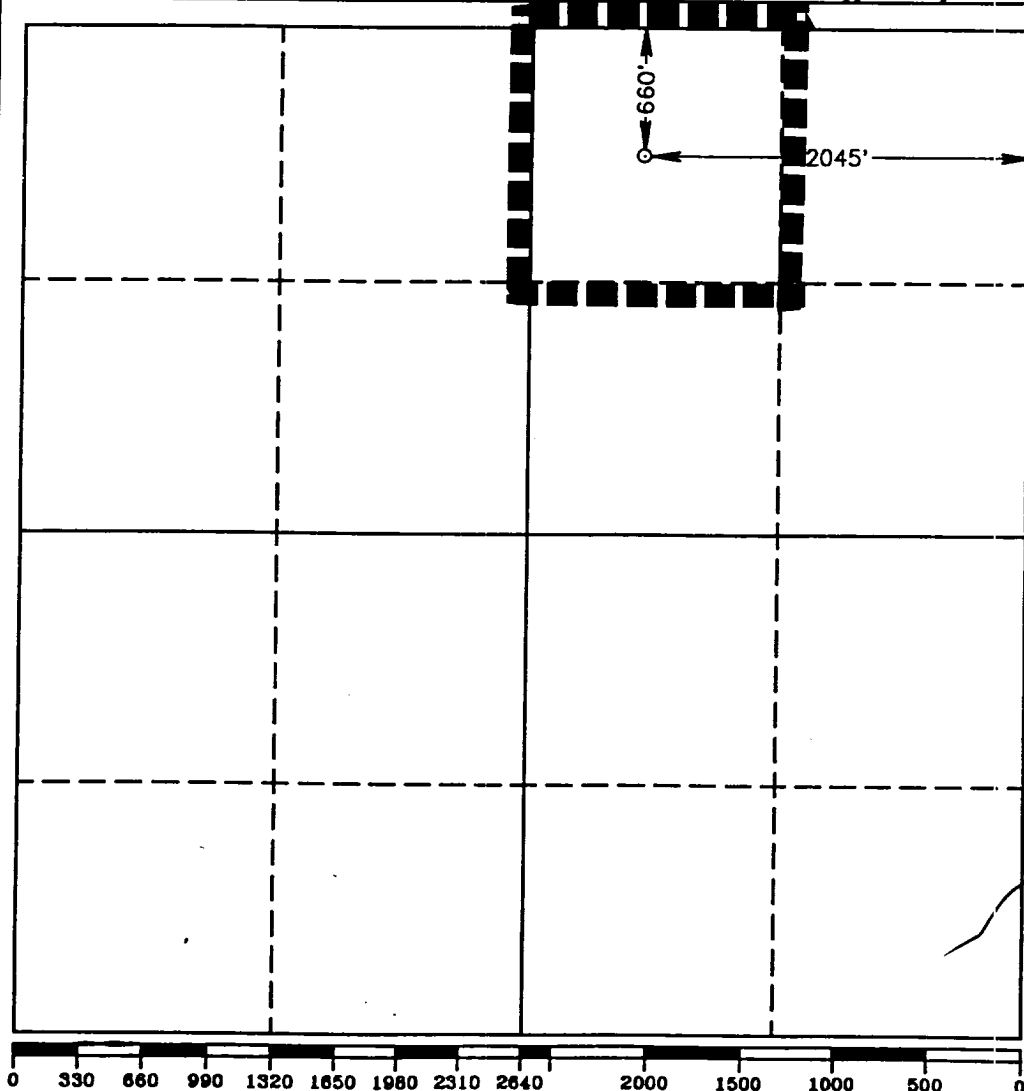

OPERATOR CERTIFICATION

I hereby certify the the information contained herein is true and complete to the best of my knowledge and belief.

Signature  
*P.R. Matthews*  
Printed Name  
P.R. MATTHEWS  
Position  
TECHNICAL ASSISTANT  
Company  
CHEVRON U.S.A. INC.  
Date  
3-16-92

SURVEYOR CERTIFICATION

I hereby certify that the well location shown on this plat was plotted from field notes of actual surveys made by me or under my supervision, and that the same is true and correct to the best of my knowledge and belief.

Date Surveyed  
DECEMBER 17, 1991  
Signature & Seal of Professional Surveyor  
*Ronald J. Edson*  
Certificate No. JOHN W. WEST. 876  
RONALD J. EDSON. 3239  
GARY T. JONES. 7977  
91110524

CHEVRON DRILLING REFERENCE SERIES  
VOLUME ELEVEN  
WELL CONTROL AND BLOWOUT PREVENTION

D. CLASS II-B BLOWOUT PREVENTER STACK:

**Figure 11J.3**  
**Class II-B Blowout Preventer Stack**

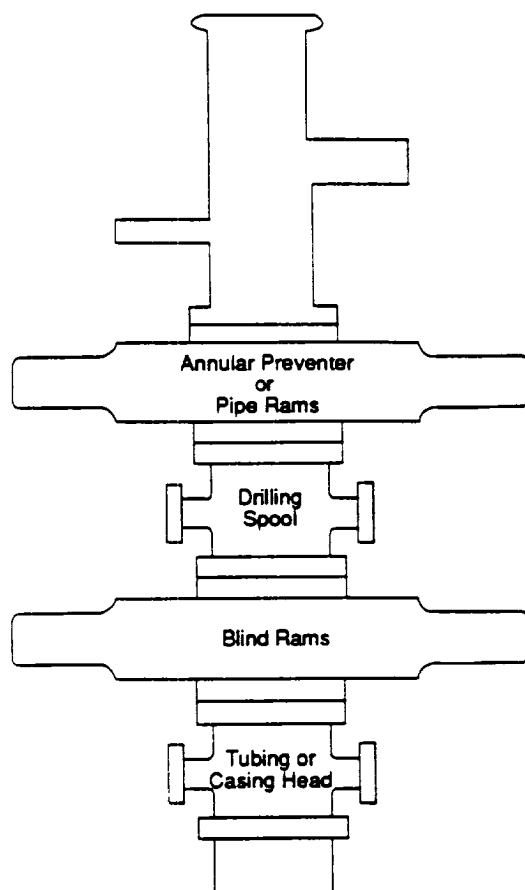

The Class II-B preventer stack is designed for drilling or workover operations. It is composed of a single hydraulically operated annular preventer on top, then a drilling spool, and a single blind ram preventer on bottom. In an alternate configuration, a single pipe ram preventer may be substituted for the annular preventer. The choke and kill lines are installed onto the drilling spool and must have a minimum internal diameter of 2". An emergency kill line may be installed on the wellhead. As the maximum anticipated surface pressure of this stack is less than 2000 psi, screwed connections may be used. All components must be of steel construction. The Class II-B blowout preventer stack is shown to the left in Figure 11J.3.

CHEVRON DRILLING REFERENCE SERIES  
VOLUME ELEVEN  
WELL CONTROL AND BLOWOUT PREVENTION

### C. CLASS II CHOKE MANIFOLD

The Class II choke manifold is suitable for all Class II workovers and drilling operations. The Class II choke manifold is shown below in Figure 11J.7. Specific design features of the Class II choke manifold include:

1. The manifold is attached to the tubing/casing head when a Class II-A preventer stack is used. This hook-up is only recommended for Class II workover operations.
2. The manifold is attached to a drilling spool or top ram preventer side outlets when a Class II-B preventer stack is in use.
3. The minimum internal diameter is 2" (nominal) for outlets, flanges, valves and lines.
4. Includes two steel gate valves in the choke line at the wellhead/drilling spool outlet. The inside choke line valve may be remotely controlled (HCR).
5. Includes one manually adjustable choke which is installed on the side of the manifold cross. Steel isolation gate valves are installed between the choke and the cross, and downstream of the choke.
6. Includes one bleed line installed on the side of the manifold cross which is isolated by a steel gate valve.
7. Includes a pressure gauge suitable for drilling service which can display the casing pressure within view of the choke operator.
8. Screwed connections may be used in lieu of flanges or clamps.

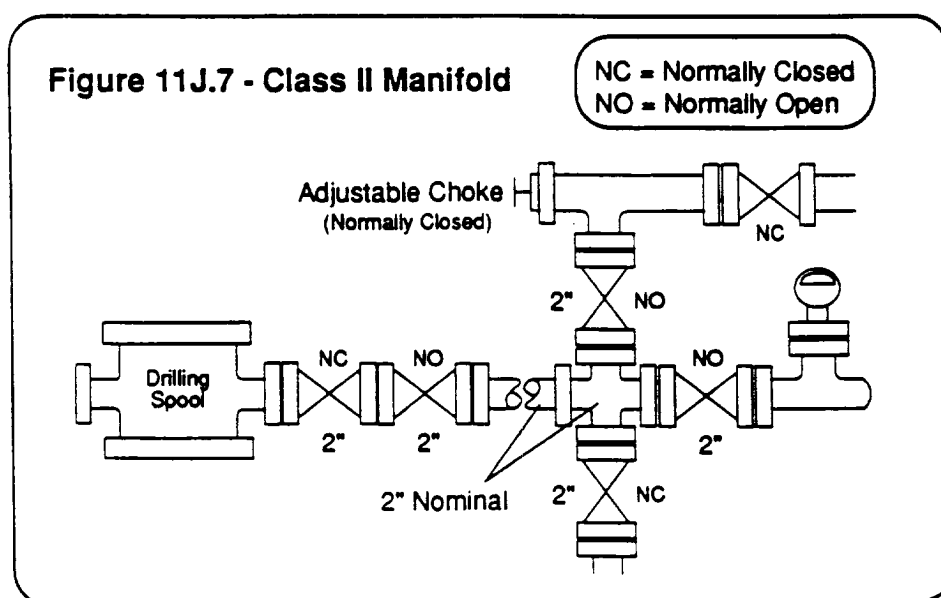



**Chevron U.S.A. Inc.**  
P.O. Box 1150, Midland, TX 79702

RECEIVED

MAR 23 8 30 AM '92

CARL  
AREA 11

Permian Basin Production Business Unit

March 19, 1992

Application for Permit to Drill  
Proposed Arrowhead Grayburg Unit  
Well #217  
Lea County, New Mexico

Bureau of Land Management  
P. O. Box 1778  
Carlsbad, NM 88220

Gentlemen:

We are submitting the information requested in NTL-6 which should accompany application for permit to drill.

Well: Arrowhead Grayburg Unit Well #217

1. **Location:** 660' FNL & 2045' FEL Section 18, T-22-S, R-37-E  
Lea County, New Mexico
2. **Elevation of unprepared ground:** 3,420.7'
3. **Geologic Name of Surface Formation:** Quaternary-Alluvium
4. **Type Drilling Tools:** Rotary
5. **Proposed Drilling Depth:** 4,500'
6. **Estimated Top of Geologic Markers:**

Yates	2,610'
Queen	3,330'
Penrose	3,435'
Grayburg	3,635'
7. **Estimated Depths at which target Formations Expected:**

Grayburg	3,635' - 4,500'
----------	-----------------