

OIL CONSERVATION DIVISION

P.O. Box 2088

Santa Fe, New Mexico 87504-2088

DISTRICT I

P.O. Box 1980, Hobbs, NM 88240

DISTRICT II

P.O. Drawer DD, Artesia, NM 88210

DISTRICT III

1000 Rio Brazos Rd., Aztec, NM 87410

WELL LOCATION AND ACREAGE DEDICATION PLAT

All Distances must be from the outer boundaries of the section

Operator YATES PETROLEUM CORPORATION			Lease JACKAL "ANJ" FEDERAL		Well No. 2
Unit Letter E	Section 4	Township 23 SOUTH	Range 33 EAST	County NMPM LEA	
Actual Footage Location of Well: 2310 feet from the NORTH line and 330 feet from the WEST line					
Ground level Elevation 3699		Producing Formation Delaware		Pool Wildcat Delaware	
				Dedicated Acreage: 40 Acres	

- Outline the acreage dedicated to the subject well by colored pencil or hatchure marks on the plat below.
- If more than one lease is dedicated to the well, outline each and identify the ownership thereof (both as to working interest and royalty).
- If more than one lease of different ownership is dedicated to the well, have the interest of all owners been consolidated by communitization, unitization, force-pooling, etc.?
☐ Yes ☒ No If answer is "yes" type of consolidation _____
If answer is "no" list the owners and tract descriptions which have actually been consolidated. (Use reverse side of this form if necessary.)
No allowable well be assigned to the well until all interests have been consolidated (by communitization, unitization, forced-pooling, or otherwise) or until a non-standard unit, eliminating such interest, has been approved by the Division.

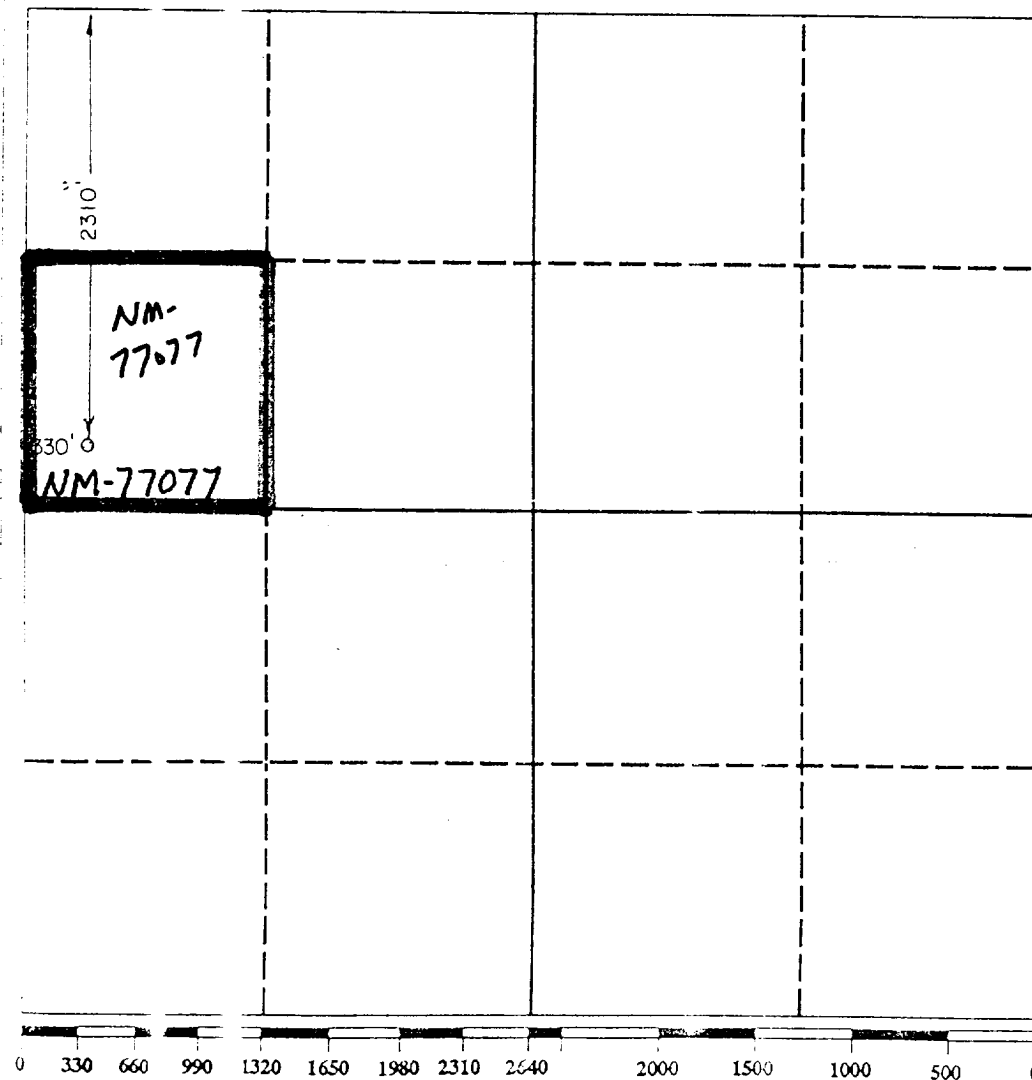

OPERATOR CERTIFICATION

I hereby certify that the information contained herein is true and complete to the best of my knowledge and belief.

Signature
Ken Beardemphl
Printed Name
Ken Beardemphl
Position
Landman
Company
Yates Petroleum Corp.
Date
7/12/93

SURVEYOR CERTIFICATION

I hereby certify that the well location shown on this plat was plotted from field notes of actual surveys made by me or under my supervision, and that the same is true and correct to the best of my knowledge and belief.

Date Surveyed
6/26/93
Signature
Herschel Jones
Professional Surveyor
Certificate No. **3640**
STATE OF NEW MEXICO
REGISTERED LAND SURVEYOR

RECEIVED

SEP 17 1993

JOHN HODGINS
OFFICE