

UNITED STATES
DEPARTMENT OF THE INTERIOR
BUREAU OF LAND MANAGEMENT

N.M. Oil Cons. Division
P.O. Box 1980
Hobbs, NM 88241

FORM APPROVED

Budget Bureau No. 1004-0135

Expires: March 31, 1993

SUNDRY NOTICES AND REPORTS ON WELLS

Do not use this form for proposals to drill or to deepen or reentry to a different reservoir.

Use "APPLICATION FOR PERMIT --" for such proposals

SUBMIT IN TRIPLICATE

1. Type of Well: ☒ OIL WELL ☐ GAS WELL ☐ OTHER

2. Name of Operator
TEXACO EXPLORATION & PRODUCTION INC.

3. Address and Telephone No. 205 E. Bender, HOBBS, NM 88240 397-0405

4. Location of Well (Footage, Sec., T., R., M., or Survey Description)
Unit Letter K : 1330 Feet From The SOUTH Line and 1330 Feet From The
WEST Line Section 20 Township 22-S Range 38-E

5. Lease Designation and Serial No.
LC032104

6. If Indian, Allottee or Tribe Name

7. If Unit or CA, Agreement Designation

8. Well Name and Number
A. H. BLINEBRY FEDERAL NCT-1
50

9. API Well No.
30 025 33802

10. Field and Pool, Exploratory Area
BLINEBRY OIL & GAS (OIL)

11. County or Parish, State
LEA, NM

12. Check Appropriate Box(s) To Indicate Nature of Notice, Report, or Other Data

TYPE OF SUBMISSION

- ☒ Notice of Intent
☐ Subsequent Report
☐ Final Abandonment Notice

TYPE OF ACTION

- ☐ Abandonment
☒ Recompletion
☐ Plugging Back
☐ Casing Repair
☐ Attering Casing
☒ OTHER: Recomplete in Blinebry
☐ Change of Plans
☐ New Construction
☐ Non-Routine Fracturing
☐ Water Shut-Off
☐ Conversion to Injection
☐ Dispose Water

(Note: Report results of multiple completion on Well Completion or Recompletion Report and Log Form.)

13. Describe Proposed or Completed Operations (Clearly state all pertinent details, and give pertinent dates, including estimated date of starting any proposed work. If well is directionally drilled, give subsurface locations and measured and true vertical depths for all markers and zones pertinent to this work,)*.

Texaco intends to recomplete the subject well in the Blinebry zone. After testing the Blinebry, a DHC permit will be applied for and will commingle with the Drinkard-Abo. The intended procedure is as follows:

1. MIRU. TOH w/rds & pmp. Instl BOP & TOH w/prod tbg. tih w/retr tool & latch onto whipstock. TIH w/cutrite shoe & tag up CIBP @ 6856'.
2. Set CIBP above Drinkard-Abo horizontal lateral @ 6800'. TIH w/csg gun & perf fr 5616-5659'. Dump 35' cmt on top of BP.
3. TIH w/trtng pkr on tbg. Test tbg to 9000 psi. Spot 150 gals 15% HCL acid fr 5600-5700'. Pull pkr to 5500'. Spot acid to pkr & acidize perms w/3600 gals 15% NEFE HCL. Fish to btm perf w/2% KCL wtr.
4. Flow or swab back load.
5. Instl frac tree & flowback lines to pit.
6. Frac perms w/48,000 gals YF120LG XL guar gel & 153,000# 16/30 sd.
7. Flow back.
8. Rel pkr & TOH w/tbg.
9. TIH w/2 7/8" tbg & c/o sand to PBTD @ 6765'.
10. Obtain DHC permit to commingle Blinebry Oil & Gas w/Drinkard-Abo South after prod rates stabilize from Blinebry.
11. MIRU pulling unit & pull prod eqpt. TIH w/bit, DC's & tbg. Drill up CIBP. Psh junk to 7234'. TIH w/trtng pkr on tbg. Test tbg to 5000 psi. PSA 6800'. Open bypass & spot acid near pkr. Close bypass & acidize horizontal lateral w/2000 gals 15% NEFE HCL. Fish to btm perf w/2% KCL wtr.
12. SI for 2 hrs. Flow back load. If well will not flow, rel pkr & TOH w/tbg & pkr. TIH w/prmpng eqpt & place well on test.

14. I hereby certify that the foregoing is true and correct

SIGNATURE J. Denise Leake TITLE Engineering Assistant DATE 3/16/99

TYPE OR PRINT NAME J. Denise Leake

(This space for Federal or State office use)

APPROVED BY (ORIG. SGD.) ALEXIS C. SWOBODA TITLE PETROLEUM ENGINEER DATE MAR 24 1999
CONDITIONS OF APPROVAL, IF ANY:

Title 18 U.S.C. Section 1001, makes it a crime for any person knowingly and willfully to make to any department or agency of the United States any false, fictitious or fraudulent statements or representations as to any matter within its jurisdiction.

DISTRICT I

P.O. Box 1980, Hobbs, NM 88241-1980

DISTRICT II

P.O. Box Drawer DD, Artesia, NM 88211-0719

DISTRICT III

1000 Rio Brazos Rd., Aztec, NM 87410

DISTRICT IV

P.O. Box 2088, Santa Fe, NM 87504-2088

State of New Mexico

Energy, Minerals and Natural Resources Department

Form C-102

Revised February 10, 1994

Instructions on back

Submit to Appropriate District Office

State Lease - 4 Copies

Fee Lease - 3 Copies

☐ AMENDED REPORT

OIL CONSERVATION DIVISION

P.O. Box 2088

Santa Fe, New Mexico 87504-2088

WELL LOCATION AND ACREAGE DEDICATION PLAT

¹ API Number 30 025 33802	² Pool Code 6660	³ Pool Name BLINEBRY OIL & GAS (OIL)
⁴ Property Code 10899	⁵ Property Name A. H. BLINEBRY FEDERAL NCT-1	⁶ Well No. 50
⁷ OGRID Number 022351	⁸ Operator Name TEXACO EXPLORATION & PRODUCTION INC.	⁹ Elevation GR-3387'

¹⁰ Surface Location

Ul or lot no. K	Section 20	Township 22-S	Range 38-E	Lot.Idn	Feet From The 1330	North/South Line SOUTH	Feet From The 1330	East/West Line WEST	County LEA
--------------------	---------------	------------------	---------------	---------	-----------------------	---------------------------	-----------------------	------------------------	---------------

¹¹ Bottom Hole Location If Different From Surface

Ul or lot no.	Section	Township	Range	Lot.Idn	Feet From The	North/South Line	Feet From The	East/West Line	County
---------------	---------	----------	-------	---------	---------------	------------------	---------------	----------------	--------

¹² Dedicated Acres 40	¹³ Joint or Infill No	¹⁴ Consolidation Code	¹⁵ Order No.
-------------------------------------	-------------------------------------	----------------------------------	-------------------------

NO ALLOWABLE WILL BE ASSIGNED TO THIS COMPLETION UNTIL ALL INTERESTS HAVE BEEN CONSOLIDATED
OR A NON-STANDARD UNIT HAS BEEN APPROVED BY THE DIVISION

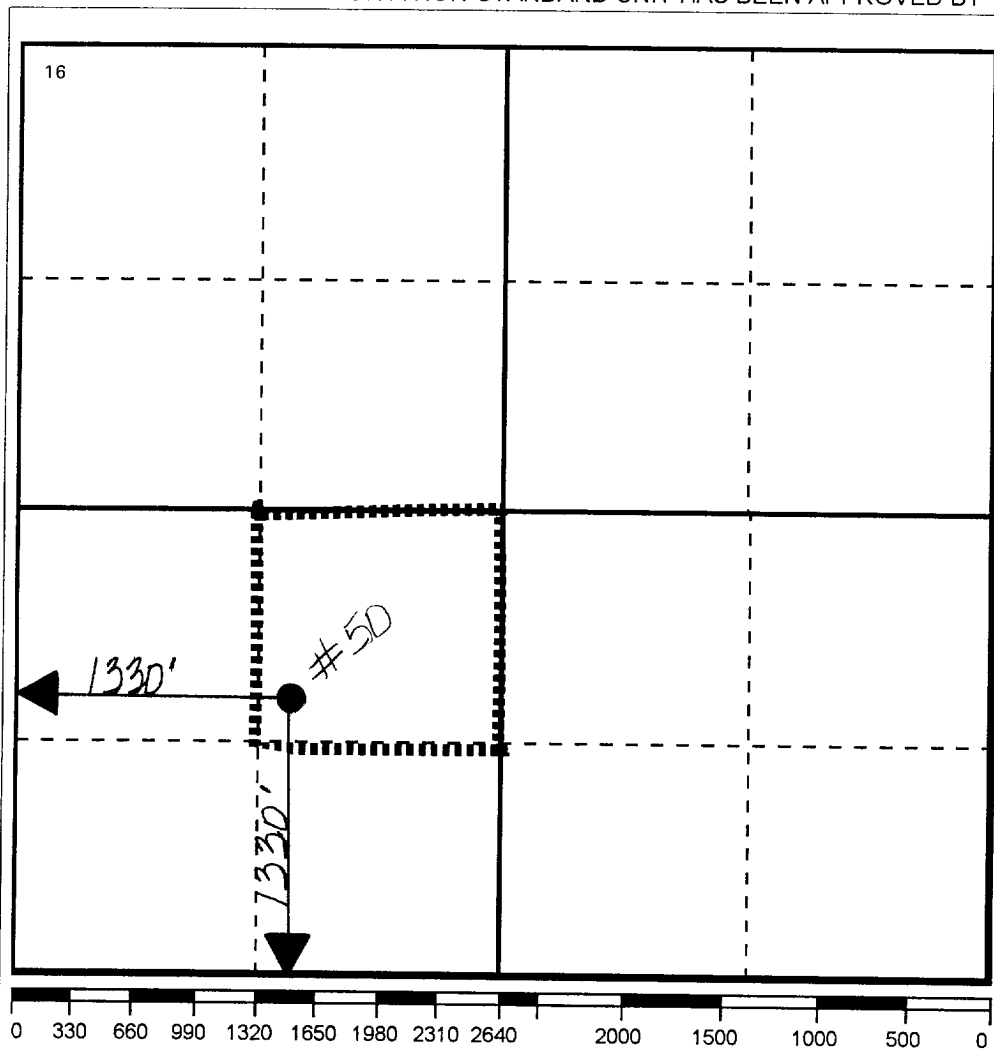

17 OPERATOR CERTIFICATION

I hereby certify that the information
contained herein is true and complete to the
best of my knowledge and belief

Signature

J. Denise Leake

Printed Name

J. Denise Leake

Position

Engineering Assistant

Date

3/16/99

18 SURVEYOR CERTIFICATION

I hereby certify that the well location shown
on this plat was plotted from field notes of
actual surveys made by me or under my
supervision, and that the same is true and
correct to the best of my knowledge and
belief.

Date Surveyed

Signature & Seal of
Professional Surveyor

Certificate No.

N/A