

District I
PO Box 1980, Hobbs, NM 88241-1980
District II
811 South First, Artesia, NM 88210
District III
1000 Rio Brazos Rd., Aztec, NM 87410
District IV
2040 South Pacheco, Santa Fe, NM 87505

State of New Mexico
Energy, Minerals & Natural Resources Department

OIL CONSERVATION DIVISION
2040 South Pacheco
Santa Fe, NM 87505

Form C-101
Revised October 18, 1994
Instructions on back
Submit to Appropriate District Office
State Lease - 6 Copies
Fee Lease - 5 Copies

☐ AMENDED REPORT

APPLICATION FOR PERMIT TO DRILL, RE-ENTER, DEEPEN, PLUGBACK, OR ADD A ZONE

¹ Operator Name and Address. Titan Resources I, Inc. 500 W. Texas, Suite 500 Midland, Texas 79701		² OGRID Number 150661
⁴ Property Code 020000	³ Property Name Brunson-Argo	⁵ API Number 30-025-33964
		⁶ Well No. 25

⁷ Surface Location

UL or lot no.	Section	Township	Range	Lot Idn	Feet from the	North/South line	Feet from the	East/West line	County
F	10	22S	37E		1713	North	1823	West	Lea

⁸ Proposed Bottom Hole Location If Different From Surface

UL or lot no.	Section	Township	Range	Lot Idn	Feet from the	North/South line	Feet from the	East/West line	County
⁹ Proposed Pool 1 Eunice; San Andres, South					¹⁰ Proposed Pool 2				

¹¹ Work Type Code N	¹² Well Type Code O	¹³ Cable/Rotary R	¹⁴ Lease Type Code P	¹⁵ Ground Level Elevation 3406'
¹⁶ Multiple No	¹⁷ Proposed Depth 4,500'	¹⁸ Formation San Andres	¹⁹ Contractor TMBR-SHARP	²⁰ Spud Date 5/27/97

²¹ Proposed Casing and Cement Program

Hole Size	Casing Size	Casing weight/foot	Setting Depth	Sacks of Cement	Estimated TOC
12 1/4"	9 5/8"	36	± 1200'	550	surface
8 3/4"	7"	26	± 4500'	625	surface

²² Describe the proposed program. If this application is to DEEPEN or PLUG BACK give the data on the present productive zone and proposed new productive zone. Describe the blowout prevention program, if any. Use additional sheets if necessary.

1. Drill 12 1/4" hole to ± 1200'. Run 9 5/8" casing. Circulate cement to surface. WOC 18 hrs. Test BOP and casing to 1000 psi before drilling out.
2. Drill 8 3/4" hole to TD + 4500'. Set 7" casing. Circulate cement to surface. Use double ram, 3,000 psi W.P. BOP's under surface approval

Permit Expires 1 Year From Approval
Date Unless Drilling Underway

²³ I hereby certify that the information given above is true and complete to the best of my knowledge and belief. Signature: <i>Ron Lechwar</i> Printed name: Ron Lechwar Title: Project Manager Date: 5/9/97		<div>OIL CONSERVATION DIVISION</div> <div>Approved by: <i>Paul Rautz</i> Title: Geologist</div> <div>Approval Date: MAY 16 1997 Expiration Date:</div> <div>Conditions of Approval: Attached <input type="checkbox"/></div>	
Phone: (915)682-6612			

C-101 Instructions

Measurements and dimensions are to be in feet/inches. Well locations will refer to the New Mexico Principal Meridian.

IF THIS IS AN AMENDED REPORT CHECK THE BOX LABELED "AMENDED REPORT" AT THE TOP OF THIS DOCUMENT.

program. Attach additional sheets if necessary.

1 Operator's OGRID number. If you do not have one it will be assigned and filled in by the District office.

23

The signature, printed name, and title of the person authorized to make this report. The date this report was signed and the telephone number to call for questions about this report.

2 Operator's name and address

3 API number of this well. If this is a new drill the OCD will assign the number and fill this in.

4 Property code. If this is a new property the OCD will assign the number and fill it in.

5 Property name that used to be called 'well name'

6 The number of this well on the property.

7 The surveyed location of this well New Mexico Principal Meridian NOTE: If the United States government survey designates a Lot Number for this location use that number in the 'UL or lot no.' box. Otherwise use the OCD Unit Letter.

8 The proposed bottom hole location of this well at TD

9 and 10 The proposed pool(s) to which this well is being drilled.

11 Work type code from the following table:

N	New well
E	Re-entry
D	Drill deeper
P	Plugback
A	Add a zone

12 Well type code from the following table:

O	Single oil completion
G	Single gas completion
M	Mutiple completion
I	Injection well
S	SWD well
W	Water supply well
C	Carbon dioxide well

13 Cable or rotary drilling code

C	Propose to cable tool drill
R	Propose to rotary drill

14 Lease type code from the following table:

S	State
P	Private

15 Ground level elevation above sea level

16 Intend to mutiple complete? Yes or No

17 Proposed total depth of this well

18 Geologic formation at TD

19 Name of the intended drilling company if known.

20 Anticipated spud date.

21 Proposed hole size ID inches, proposed casing OD inches, casing weight in pounds per foot, setting depth of the casing or depth and top of liner, proposed cementing volume, and estimated top of cement

22 Brief description of the proposed drilling program and BOP

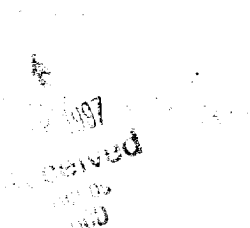

DISTRICT I

P.O. Box 1980, Hobbs, NM 88241-1980

State of New Mexico

Energy, Minerals and Natural Resources Department

Form C-102

Revised February 10, 1994
Submit to Appropriate District Office

State Lease - 4 Copies

Fee Lease - 3 Copies

DISTRICT II

P.O. Drawer DD, Artesia, NM 88211-0719

DISTRICT III

1000 Rio Brazos Rd., Aztec, NM 87410

OIL CONSERVATION DIVISION

P.O. Box 2088

Santa Fe, New Mexico 87504-2088

DISTRICT IV

P.O. Box 2088, Santa Fe, NM 87504-2088

☐ AMENDED REPORT

WELL LOCATION AND ACREAGE DEDICATION PLAT

API Number 30-025-33964		Pool Code 24170	Pool Name Eunice; San Andres, South
Property Code 020000	Property Name BRUNSON -ARGO		Well Number 25
OGRID No. 150661	Operator Name TITAN RESOURCES I, Inc.		Elevation 3406

Surface Location

UL or lot No.	Section	Township	Range	Lot Idn	Feet from the	North/South line	Feet from the	East/West line	County
F	10	22 S	37 E		1713	NORTH	1823	WEST	LEA

Bottom Hole Location If Different From Surface

UL or lot No.	Section	Township	Range	Lot Idn	Feet from the	North/South line	Feet from the	East/West line	County

Dedicated Acres	Joint or Infill	Consolidation Code	Order No.
80	N	--	-

NO ALLOWABLE WILL BE ASSIGNED TO THIS COMPLETION UNTIL ALL INTERESTS HAVE BEEN CONSOLIDATED
OR A NON-STANDARD UNIT HAS BEEN APPROVED BY THE DIVISION

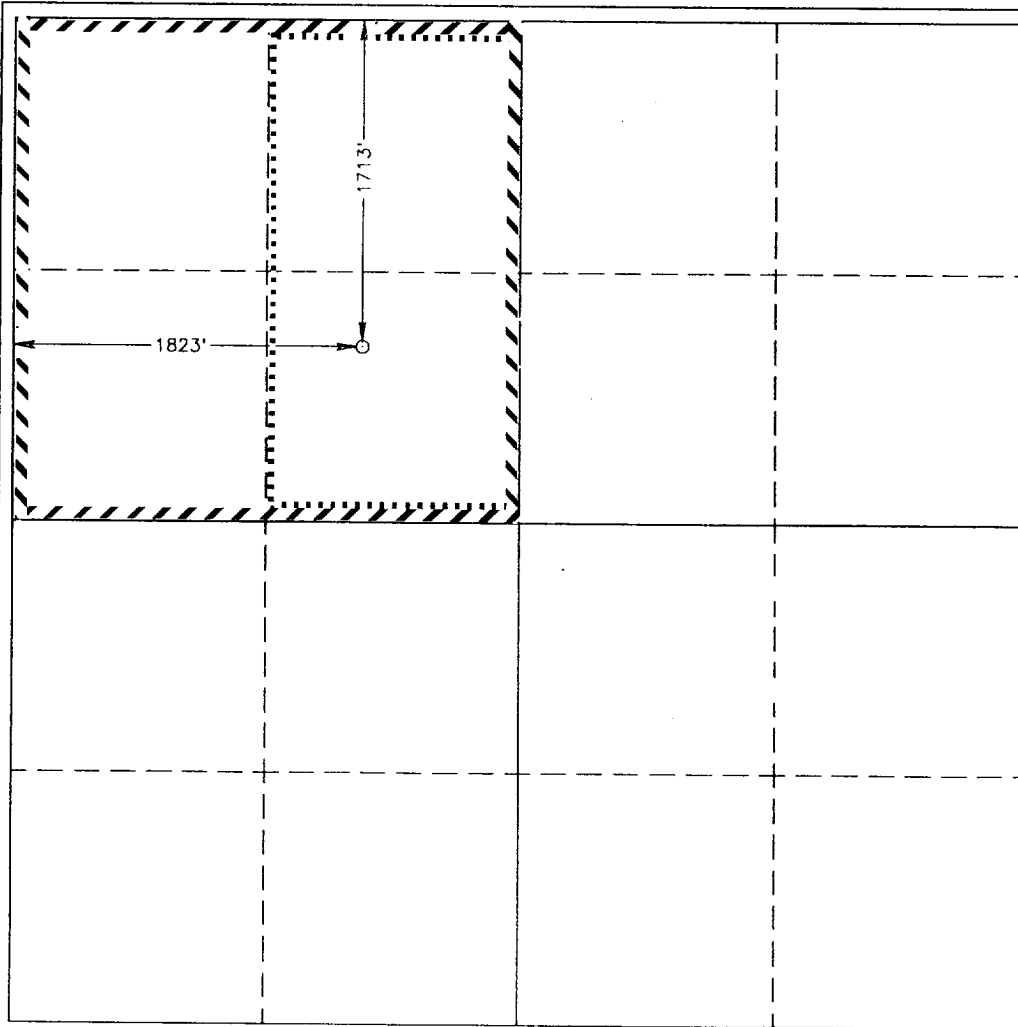

OPERATOR CERTIFICATION

I hereby certify the the information
contained herein is true and complete to the
best of my knowledge and belief.

Ron Lechwar
Signature

Ron Lechwar

Printed Name

Project Manager

Title

5/9/97

Date

SURVEYOR CERTIFICATION

I hereby certify that the well location shown
on this plat was plotted from field notes of
actual surveys made by me or under my
supervision, and that the same is true and
correct to the best of my belief.

MAY

2, 1997

Date Surveyed JLP

Signature & Seal of
Professional Surveyor

Ronald J. Eidson
Professional Surveyor

W.O. Num. 87-1160786

Certified No. JOHN W. WEST, 676
EIDSON, 3239
EIDSON, 12641

RECEIVED

MAY 1997
Received
Hobbs
OCD

4/2/97

173