

Submit 3 Copies
to Appropriate
District Office

State of New Mexico
Energy, Minerals and Natural Resources Department

Form C-103
Revised 1-1-89

DISTRICT I
P.O. Box 1980, Hobbs, NM 88240

DISTRICT II
P.O. Drawer DD, Artesia, NM 88210

DISTRICT III
1000 Rio Brazos Rd., Aztec, NM 87410

OIL CONSERVATION DIVISION
P.O. Box 2088
Santa Fe, New Mexico 87504-2088

WELL API NO. 30-025-34580
5. Indicate Type of Lease STATE <input checked="" type="checkbox"/> FEE <input type="checkbox"/>
6. State Oil & Gas Lease No. V-2798
7. Lease Name or Unit Agreement Name Thistle Unit
8. Well No. 5
9. Pool name or Wildcat Johnson Ranch (Wolfcamp)
10. Elevation (Show whether DF, RKB, RT, GR, etc.) 3656 GR

SUNDRY NOTICES AND REPORTS ON WELLS
(DO NOT USE THIS FORM FOR PROPOSALS TO DRILL OR TO DEEPEN OR PLUG BACK TO A
DIFFERENT RESERVOIR. USE "APPLICATION FOR PERMIT"
(FORM C-101) FOR SUCH PROPOSALS.)

1. Type of Well: OIL WELL <input type="checkbox"/> GAS WELL <input checked="" type="checkbox"/> OTHER
2. Name of Operator Santa Fe Snyder Corp.
3. Address of Operator 550 W. Texas, Suite 1330, Midland, TX 79701

4. Well Location Unit Letter <u>F</u> : <u>1980</u> Feet From The <u>North</u> Line and <u>1980</u> Feet From The <u>West</u> Line Section <u>34</u> Township <u>23 S</u> Range <u>33 E</u> NMPM Lea County

11. Check Appropriate Box to Indicate Nature of Notice, Report, or Other Data	
NOTICE OF INTENTION TO:	SUBSEQUENT REPORT OF:
PERFORM REMEDIAL WORK <input type="checkbox"/>	REMEDIAL WORK <input type="checkbox"/>
TEMPORARILY ABANDON <input type="checkbox"/>	ALTERING CASING <input type="checkbox"/>
PULL OR ALTER CASING <input type="checkbox"/>	COMMENCE DRILLING OPNS. <input type="checkbox"/>
OTHER: <u>Move Surface Location</u> <input checked="" type="checkbox"/>	PLUG AND ABANDONMENT <input type="checkbox"/>
	CASING TEST AND CEMENT JOB <input type="checkbox"/>
	OTHER: <u>Move Surface Location</u> <input checked="" type="checkbox"/>

12. Describe Proposed or Completed Operations (Clearly state all pertinent details, and give pertinent dates, including estimated date of starting any proposed work) SEE RULE 1103.
Santa Fe Snyder Corp. respectfully requests the surface location of the Thistle Unit #5 be moved to the original approved location @ 1980' FNL & 1980' FWL Sec. 34, T-23-S, R-33-E, Lea County, New Mexico.

From: 1500/W & 1250/W

I hereby certify that the information above is true and complete to the best of my knowledge and belief.
SIGNATURE James P. "Phil" Stinson TITLE Agent for Santa Fe Snyder DATE 11-10-99
TYPE OR PRINT NAME James P. "Phil" Stinson TELEPHONE NO. 915-682-6373

(This space for State Use)
APPROVED BY ORIGINAL SIGNED BY CHRIS WILLIAMS TITLE DISTRICT I SUPERVISOR DATE NOV 16 1999
CONDITIONS OF APPROVAL, IF ANY:

DISTRICT I
P. O. Box 1980
Hobbs, NM 88241-1980

State of New Mexico
En Minerals, and Natural Resources Department

Form C-102
Revised 02-10-94
Instructions on back

DISTRICT II
P. O. Drawer DD
Artesia, NM 88211-0719

OIL CONSERVATION DIVISION

P. O. Box 2088
Santa Fe, New Mexico 87504-2088

Submit to the Appropriate
District Office
State Lease - 4 copies
Fee Lease - 3 copies

☐ AMENDED REPORT

DISTRICT III
1000 Rio Brazos Rd.
Aztec, NM 87410

DISTRICT IV
P. O. Box 2088
Santa Fe, NM 87507-2088

WELL LOCATION AND ACREAGE DEDICATION PLAT

1 API Number 30-025-34580	2 Pool Code 79335	3 Pool Name Johnson Ranch; Wildeat (Wolfcamp)
4 Property Code 16629	5 Property Name THISTLE UNIT	6 Well Number 5
7 OGRID No. 020305	8 Operator Name SANTA FE ENERGY RESOURCES, INC.	9 Elevation 3656'

10 SURFACE LOCATION

UL or lot no. F	Section 34	Township 23 SOUTH	Range 33 EAST, N.M.P.M.	Lot Ida	Feet from the 1980'	North/South line NORTH	Feet from the 1980'	East/West line WEST	County LEA
---------------------------	----------------------	-----------------------------	-----------------------------------	---------	-------------------------------	----------------------------------	-------------------------------	-------------------------------	----------------------

11 BOTTOM HOLE LOCATION IF DIFFERENT FROM SURFACE

UL or lot no.	Section	Township	Range	Lot Ida	Feet from the	North/South line	Feet from the	East/West line	County
---------------	---------	----------	-------	---------	---------------	------------------	---------------	----------------	--------

12 Dedicated Acres 320	13 Joint or Infill	14 Consolidation Code	15 Order No.
----------------------------------	--------------------	-----------------------	--------------

NO ALLOWABLE WELL BE ASSIGNED TO THIS COMPLETION UNTIL ALL INTERESTS HAVE BEEN
CONSOLIDATED OR A NON-STANDARD UNIT HAS BEEN APPROVED BY THE DIVISION

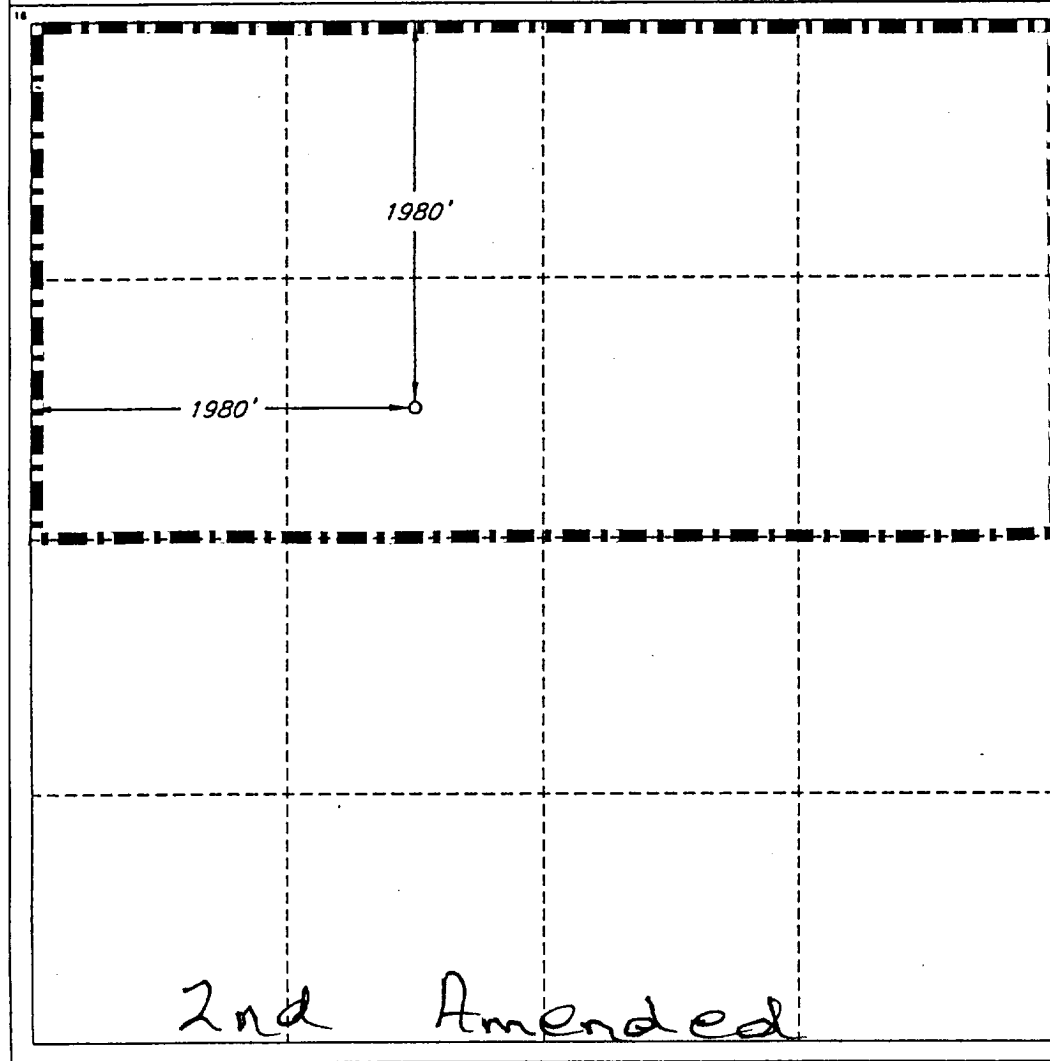

OPERATOR CERTIFICATION

I hereby certify that the information
contained herein is true and complete
to the best of my knowledge and belief.

Signature
Michael R. Burton
Printed Name
MICHAEL R. BURTON
Title
DIVISION Mgr. Drilling
Date
2/19/99

SURVEYOR CERTIFICATION

I hereby certify that the well
location shown on this plat was
plotted from field notes of actual
surveys made by me or under
my supervision, and that the
same is true and correct to the
best of my belief.

Date of Survey
FEBRUARY 15, 1999
Signature and Seal of
Professional Surveyor
ROGER M. ROBBINS
REGISTERED SURVEYOR
NEW MEXICO
12128
Certified to
ROGER M. ROBBINS #12128
JOB #62463 / V.H.B.