



May 21, 2001

Attn: David Catanach  
State of New Mexico - Oil Conservation Division  
1220 South St. Francis Drive  
Santa Fe, New Mexico 87505

**Re: Application to Downhole Commingle  
H Corrigan No. 13  
Penrose Skelly; Grayburg Pool (50350)  
Eunice; San Andres Pool (24150)  
Sec. 4, T22S - R37E  
Lea County, New Mexico**

Apache Corporation would like to request administrative approval to downhole commingle the production from the referenced pools in our H Corrigan # 13 well.

To support this request we submit the following:

- 1) New Mexico - OCD Form C-107A
- 2) New Mexico - OCD Form C-102 for Penrose Skelly; Grayburg Pool
- 3) New Mexico - OCD Form C-102 for Eunice; San Andres Pool
- 4) Production Curve for the Penrose Skelly; Grayburg Pool
- 5) Production Curve for offset well Owen "B" # 9 in the Penrose Skelly; Grayburg Pool
- 6) Production Curve for offset well Owen "B" # 9 in the Eunice; San Andres Pool
- 7) Allocation formula is based on current production

- 8) Copy of letter sent (by Certified Mail) to Offset operators within one-half mile of the H Corrigan # 13
- 9) Well Bore Diagrams of current completion and proposed completion

If you have any questions or require additional information regarding this application, please contact me at 713-296-6338. Thank you.

Sincerely,

**APACHE CORPORATION**

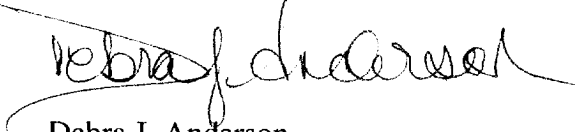
A handwritten signature in black ink, appearing to read "Debra J. Anderson", is written over a horizontal line.

Debra J. Anderson  
Sr. Engineering Technician

Attachments

cc: New Mexico Oil Conservation Division  
District I  
1625 N. French Drive  
Hobbs, New Mexico 88240

**DISTRICT I**  
1625 N. French Drive, Hobbs, NM 88240

**DISTRICT II**  
P.O. Drawer DD, Artesia, NM 88210

**DISTRICT III**  
1000 Rio Brazos Rd., Aztec, NM 87410

**DISTRICT IV**  
1220 South St. Francis Dr., Santa Fe, NM 87505

State of New Mexico  
Energy, Minerals and Natural Resources Department

**OIL CONSERVATION DIVISION**  
1220 South St. Francis Drive  
Santa Fe, New Mexico 87505-6429

Form C-107A  
Revised May 15, 2000

APPLICATION TYPE  
☐ Established Pre-Approved Pools  
☐ Single Well  
Existing Wellbore  
☐ Yes ☐ No

**APPLICATION FOR DOWNHOLE COMMINGLE**

APACHE CORPORATION

2000 POST OAK BLVD., SUITE 100, HOUSTON, TEXAS 77056-4400

Operator

Address

H CORRIGAN

13

B / Sec. 4 / T-22S / R-37E

Lea

Lease

Well No.

Unit Ltr.-Sec-Twp-Rgn

County

OGRID NO. 000873

Property Code

26470 API No.

30-025-35137

☐ Federal

☐ State

☒ Fee

DATA ELEMENT	UPPER ZONE	INTERMEDIATE ZONE	LOWER ZONE
Pool Name	Penrose Skelly; Grayburg		Eunice; San Andres
Pool Code	50350		24150
Top and Bottom of Pay Section (Perforated or Open-Hole Interval)	3692 - 3796		3906 - 4092
Method of Production (Flowing or Artificial Lift)	Artificial Lift		Artificial Lift
Bottomhole Pressure <small>(Note: Pressure data will not be required if the bottom perforation in the lower zone is within 150% of the depth of the top perforation in the upper zone.)</small>			
Oil Gravity or Gas BTU (Degree API or Gas BTU)	36.7		37.1
Producing, Shut-In or New Zone	Producing		Shut-In
Date and Oil/Gas/Water Rates of Last Production <small>(Note: For new zones with no production history, applicant shall be required to attach production estimator and supporting data.)</small>	Date: 5/10/2001 Rates: 7 x 35 x 5	Date: Rates:	Owen "B" # 9 Date: 5/7/2001 Rates: 3 x 36 x 9
Fixed Allocation Percentage <small>(Note: If allocation is based upon something other than current or past production, supporting data or explanation will be required.)</small>	Oil 70% Gas 50%	Oil % Gas %	Oil 30% Gas 50%

**ADDITIONAL DATA**

Are all working, royalty and overriding royalty interest identical in all commingle zones?

☒ Yes ☐ No

If not, have all working, royalty and overriding royalty interest owners been notified by certified mail?

☐ Yes ☐ No

Are all produced fluids from all commingled zones compatible with each other?

☒ Yes ☐ No

Will commingling decrease the value of production?

☐ Yes ☒ No

If this well is on, or communitized with, state or federal lands, has either the Commissioner of Public Lands or the United States Bureau of Land Management been notified in writing of this application?

☐ Yes ☐ No

NMOCD Reference Cases No. applicable to this well:

DHC-2674 / DHC-2675

**Attachments:**

- C-102 for each zone to be commingled showing its spacing unit and acreage dedication.
- Production curve for each zone for at least one year. (If not available, attach explanation.)
- For zones with no production history, estimated production rates and supporting data.
- Data to support allocation method or formula.
- Notification list of working, royalty and overriding interests for uncommon interest cases.
- Any additional statements, data or documents required to support commingling.

**PRE-APPROVED POOLS**

If application is to establish Pre-Approved Pools, the following additional information will be required:

List of other orders approving downhole commingling within the proposed Pre-Approved Pools

List of all operators within the proposed Pre-Approved Pools

Proof that all operators within the proposed Pre-Approved Pools were provided notice of this application

Bottomhole pressure data

I hereby certify that the information above is true and complete to the best of my knowledge and belief.

SIGNATURE

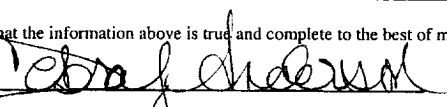

TITLE

Sr. Engineering Technician

DATE

5/21/2001

TYPE OR PRINT NAME

Debra J. Anderson

TELEPHONE NO. 713-296-6338

District I  
1625 N. French Drive, Hobbs, NM 88240

District II  
P O Drawer DD, Artesia, NM 88210

District III  
1000 Rio Brazos Rd., Aztec, NM 87410

District IV  
1220 South St. Francis Drive, Santa Fe, NM 87505

State of New Mexico  
Energy, Minerals and Natural Resources Department

**OIL CONSERVATION DIVISION**  
1220 South St. Francis Drive  
Santa Fe, New Mexico 87505

Form C-102

Revised October 18, 1994

Instruction on Back

Submit to Appropriate District Office

State Lease - 4 Copies

Fee Lease - 3 Copies

☐ AMENDED REPORT

**WELL LOCATION AND ACREAGE DEDICATION PLAT**

1 API Number 30-025-35137		2 Pool Code 50350		3 Pool Name Penrose Skelly; Grayburg	
4 Property Code 26470		5 Property Name HCorrigan			6 Well Number 13
7 OGRID No. 000873		8 Operator Name Apache Corporation			9 Elevation 3456

10 Surface Location									
UL or Lot No. B	Section 4	Township 22S	Range 37E	Lot Idn	Feet from the 936	North/South line North	Feet from the 1986	East/West line East	County Lea

11 Bottom Hole Location If Different From Surface									
UL or Lot No.	Section	Township	Range	Lot Idn	Feet from the	North/South line	Feet from the	East/West line	County

12 Dedicated Acres 40	13 Joint or Infill	14 Consolidation Code	14 Order No.
--------------------------	--------------------	-----------------------	--------------

NO ALLOWABLE WILL BE ASSIGNED TO THIS COMPLETION UNTIL ALL INTERESTS HAVE BEEN CONSOLIDATED  
OR A NON-STANDARD UNIT HAS BEEN APPROVED BY THE DIVISION

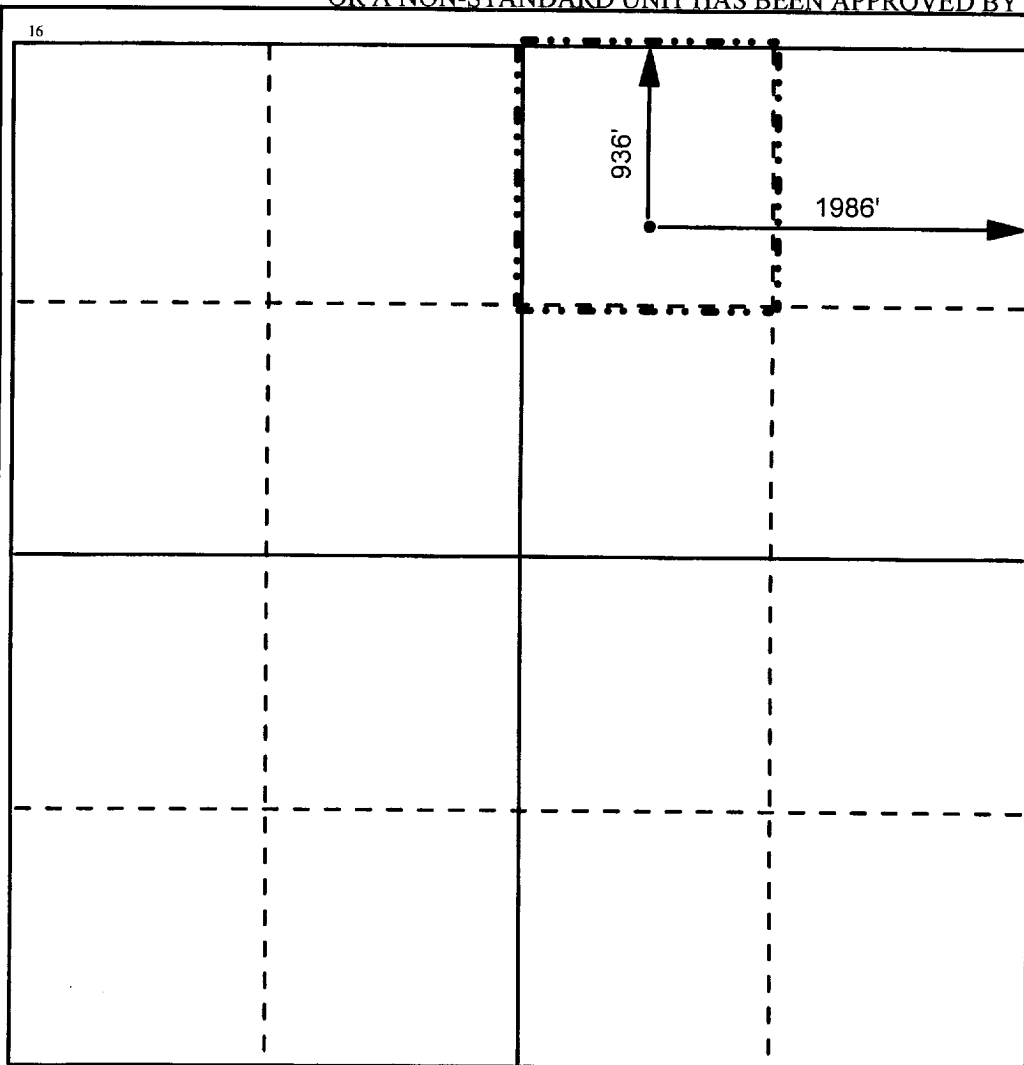

17 OPERATOR CERTIFICATION

I hereby certify that the information contained herein is true and complete to the best of my knowledge and belief.

Signature  
*Debra J. Anderson*

Printed Name  
Debra J. Anderson

Title  
Sr. Engineering Technician

Date  
5/21/01

18 SURVEYOR CERTIFICATION

I hereby certify that the well location shown on this plat was plotted from field notes of actual surveys made by me or under my supervision, and that the same is true and correct to the best of my belief.

Date Surveyed

Signature and Seal of Professional Surveyor

Certificate Number

District I  
1625 N. French Drive, Hobbs, NM 88240

District II  
P O Drawer DD, Artesia, NM 88210

District III  
1000 Rio Brazos Rd., Aztec, NM 87410

District IV  
1220 South St. Francis Drive, Santa Fe, NM 87505

State of New Mexico  
Energy, Minerals and Natural Resources Department

**OIL CONSERVATION DIVISION**

1220 South St. Francis Drive  
Santa Fe, New Mexico 87505

Form C-102

Revised October 18, 1994

Instruction on Back

Submit to Appropriate District Office

State Lease - 4 Copies

Fee Lease - 3 Copies

☐ AMENDED REPORT

**WELL LOCATION AND ACREAGE DEDICATION PLAT**

1 API Number 30-025-35137		2 Pool Code 24150		3 Pool Name Eunice, San Andres	
4 Property Code 26470		5 Property Name HCorrigan			6 Well Number 13
7 OGRID No. 000873		8 Operator Name Apache Corporation			9 Elevation 3456

**10 Surface Location**

UL or Lot No. B	Section 4	Township 22S	Range 37E	Lot Idn	Feet from the 936	North/South line North	Feet from the 1986	East/West line East	County Lea
--------------------	--------------	-----------------	--------------	---------	----------------------	---------------------------	-----------------------	------------------------	---------------

**11 Bottom Hole Location If Different From Surface**

UL or Lot No.	Section	Township	Range	Lot Idn	Feet from the	North/South line	Feet from the	East/West line	County
---------------	---------	----------	-------	---------	---------------	------------------	---------------	----------------	--------

12 Dedicated Acres 40	13 Joint or Infill	14 Consolidation Code	14 Order No.
--------------------------	--------------------	-----------------------	--------------

NO ALLOWABLE WILL BE ASSIGNED TO THIS COMPLETION UNTIL ALL INTERESTS HAVE BEEN CONSOLIDATED  
OR A NON-STANDARD UNIT HAS BEEN APPROVED BY THE DIVISION

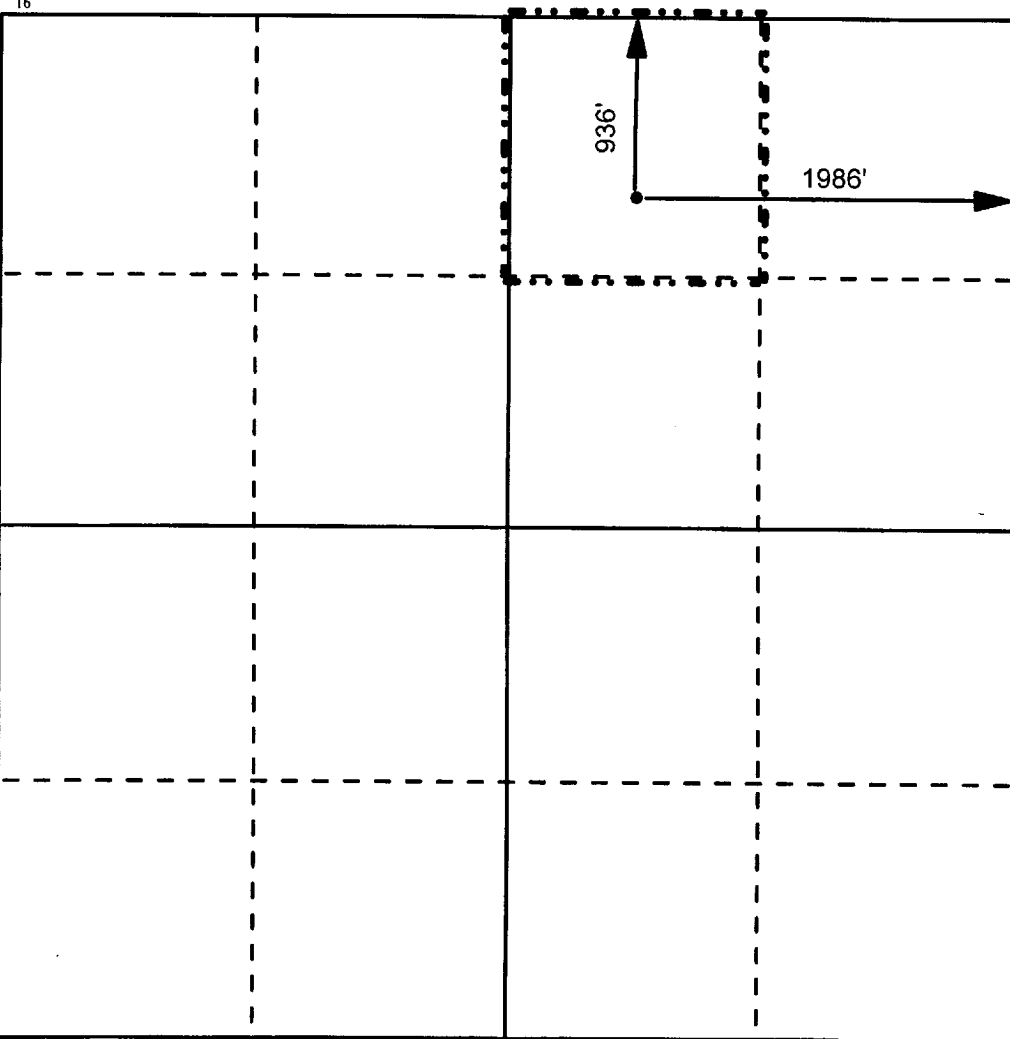
<div>16</div> 	<div>17 OPERATOR CERTIFICATION</div> <p><i>I hereby certify that the information contained herein is true and complete to the best of my knowledge and belief.</i></p> <p>Signature: <i>Debra J. Anderson</i></p> <p>Printed Name: Debra J. Anderson</p> <p>Title: Sr. Engineering Technician</p> <p>Date: 5/21/01</p>
	<div>18 SURVEYOR CERTIFICATION</div> <p><i>I hereby certify that the well location shown on this plat was plotted from field notes of actual surveys made by me or under my supervision, and that the same is true and correct to the best of my belief.</i></p> <p>Date Surveyed:</p> <p>Signature and Seal of Professional Surveyor:</p>
	Certificate Number

# H CORRIGAN NO. 13 - PENROSE SKELLY, GRAYBURG

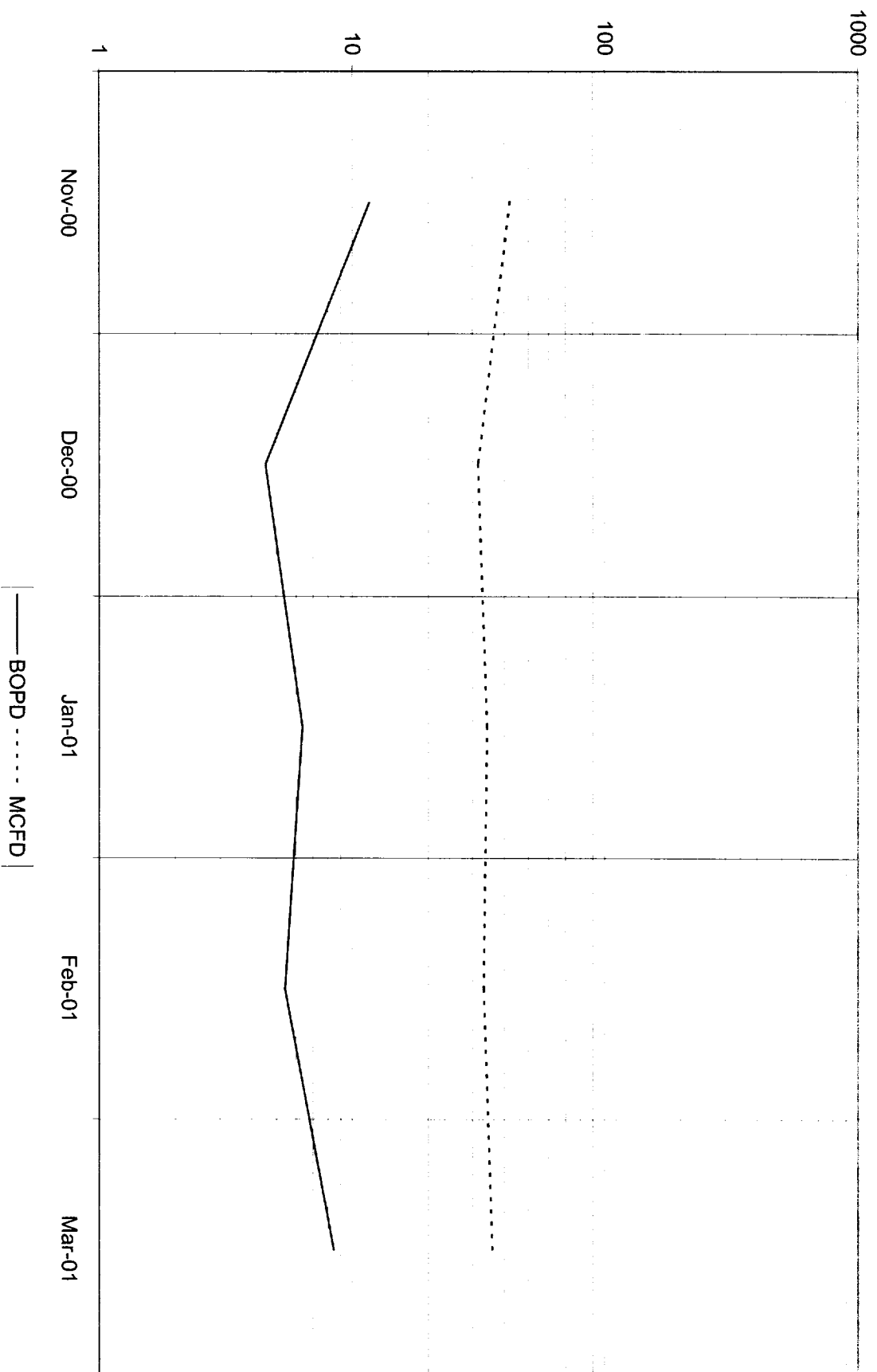

OWEN "B" NO. 9 - PENROSE SKELLY; GRAYBURG

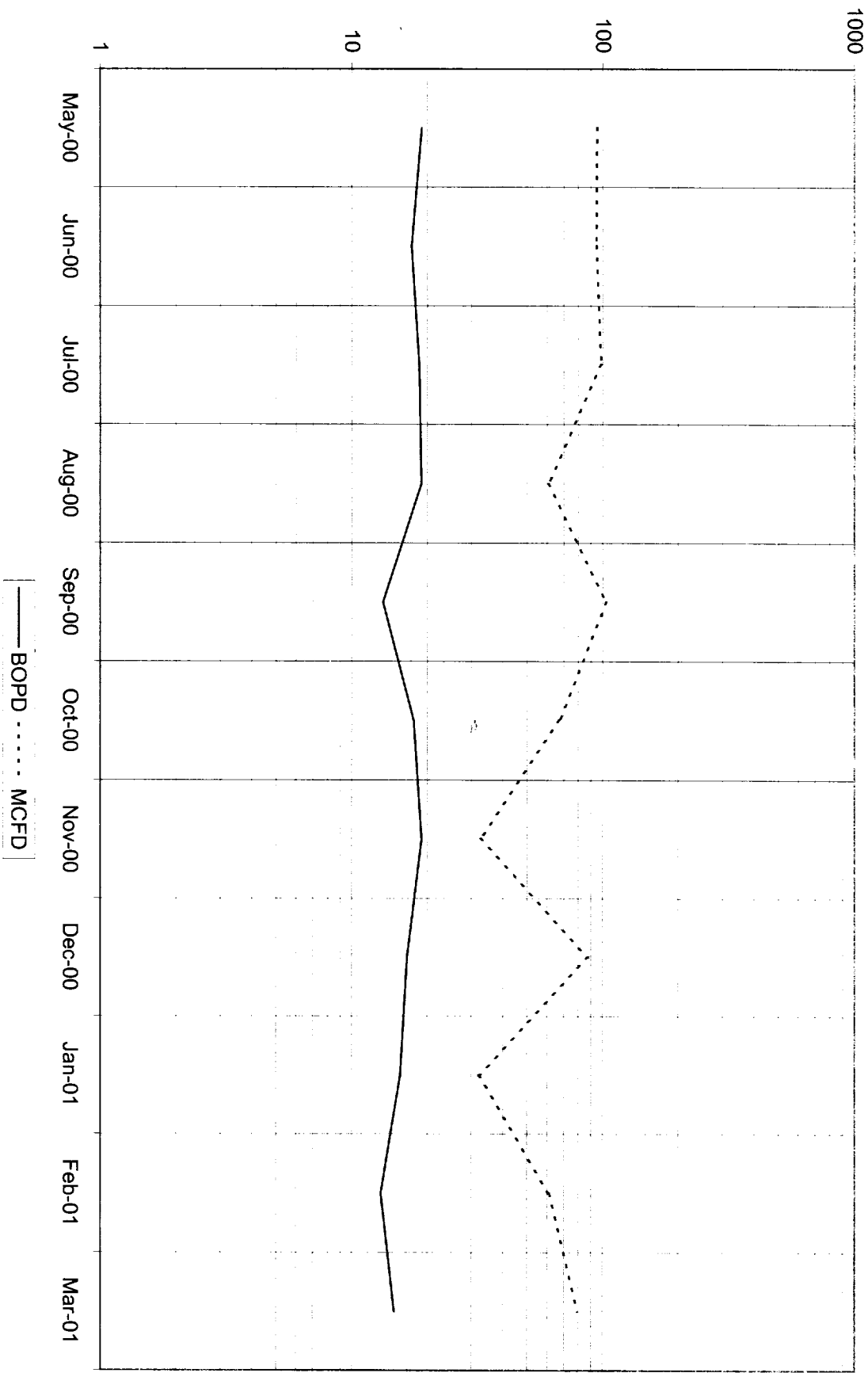

OWEN "B" NO. 9 - EUNICE (SAN ANDRES)

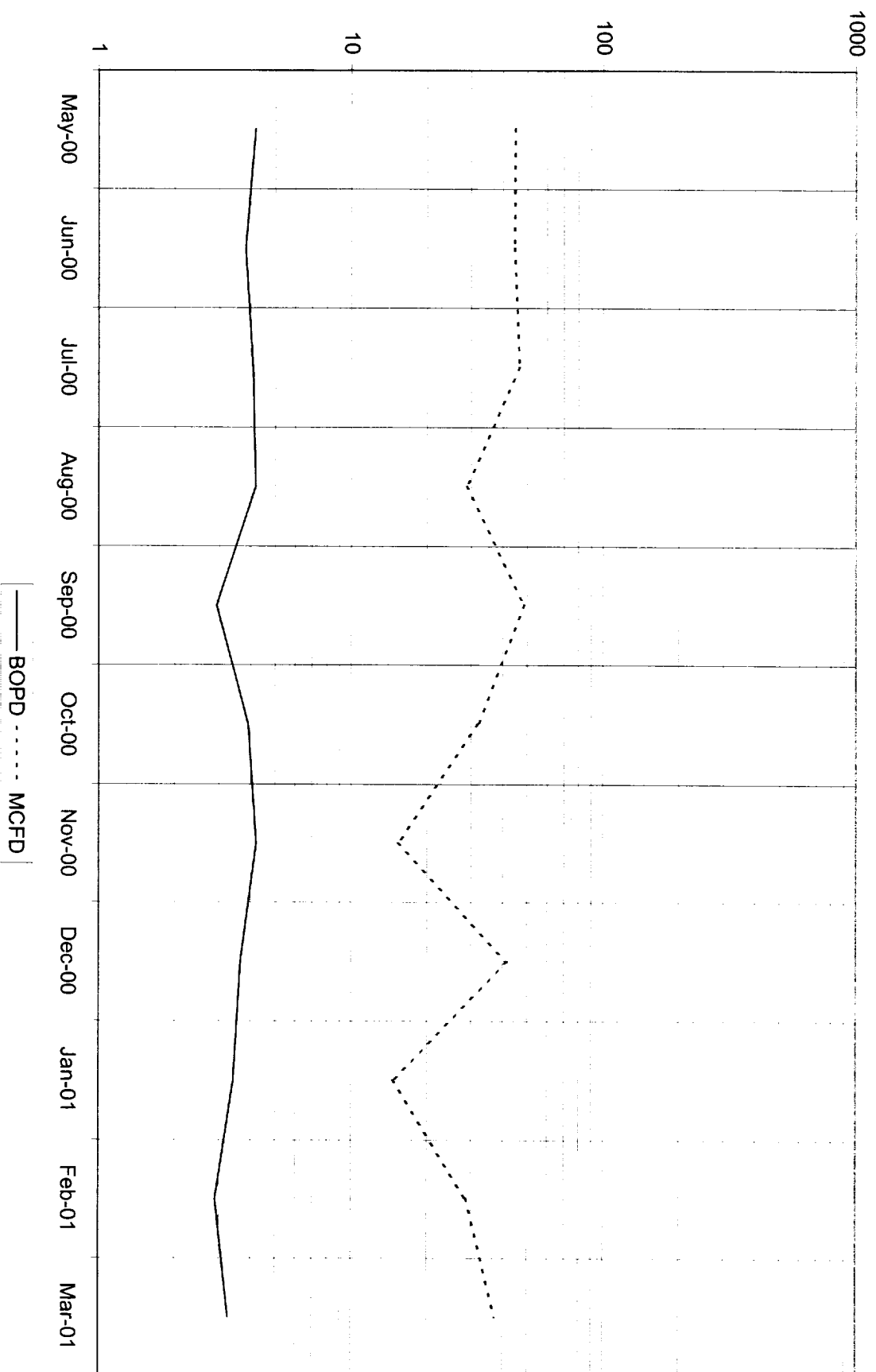



2000 POST OAK BOULEVARD / SUITE 100 / HOUSTON, TEXAS 77056-4400



WWW.APACHECORP.COM  
(713) 296-6000

May 21, 2001

Offset Operators

**Re: Application to Downhole Commingle  
H Corrigan No. 13  
Penrose Skelly; Grayburg Pool (50350)  
Eunice; San Andres Pool (24150)  
Sec. 4, T22S - R37E  
Lea County, New Mexico**

Attached please find a copy of an Application to Downhole Commingle production from the referenced pools in the H Corrigan # 13 well that Apache Corporation has filed with the New Mexico Oil Conservation Division. If you have an objection to this application, you must notify the OCD in writing within 20 days from the date of this letter. Thank you.

Sincerely,

**APACHE CORPORATION**

A handwritten signature in dark ink, appearing to read "Debra J. Anderson", written over a horizontal line.

Debra J. Anderson  
Sr. Engineering Technician

Attachments

cc: New Mexico Oil Conservation Division  
1220 South St. Francis Drive  
Santa Fe, New Mexico 87505

**H Corrigan No. 13 Downhole Commingle Application  
Offset Operators**

Chevron USA Inc  
P O Box 1150  
Midland, Texas 79702  
Certified Rcpt. # Z-207-261-558

Texaco Expl & Prod Inc  
P O Box 3109  
Midland, Texas 79702  
Certified Receipt # Z-207-261-564

Falcon Creek Resources Inc  
621 17<sup>th</sup> Street, Suite 1800  
Denver, Colorado 80293  
Certified Receipt # Z-207-261-563

Titan Resources  
500 W Texas, Suite 500  
Midland, Texas 79701  
Certified Receipt # Z-207-261-561

John H Hendrix Corporation  
110 N. Marienfeld, Suite 400  
Midland, Texas 79702-3040  
Certified Rcpt. # Z-207-261-559

Wiser Oil Company  
3504 N W County Road  
Hobbs, New Mexico 88241  
Certified Receipt # Z-207-261-565

Oxy USA Inc  
Box 50250  
Midland, Texas 79710  
Certified Receipt # Z-207-261-560

Zia Energy Inc  
Box 2510  
Hobbs, New Mexico 88241-2510  
Certified Receipt # Z-207-261-562



Well: H Corrigan No. 13

Pool: Penrose Skelly; Grayburg

Location: 936' FNL & 1986' FEL  
Unit B, Section 4, Township 22S, Range 37E

API#: 30-025-35137

Current Status: Active Oil  
Penrose Skelly; Grayburg

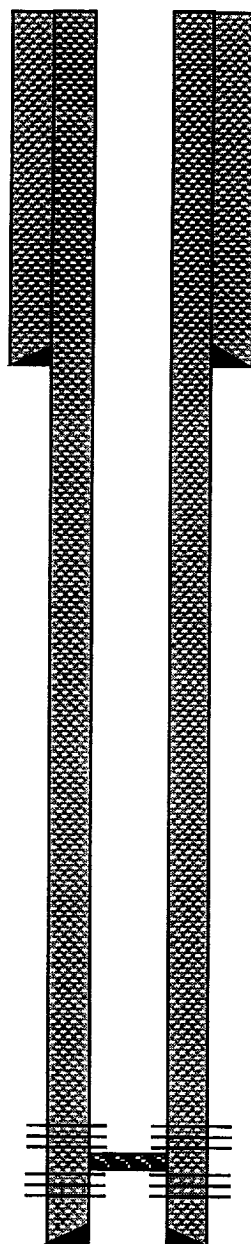

**Surface Casing:** 12-1/4" Hole  
8-5/8" 24# CSA 1160'  
Cement w / 435 sx  
Circulated to Surface

**Penrose Skelly; Grayburg Perfs:**  
3692-96, 99-3704, 08-12, 15-22, 29-96  
4" - 353 Holes

**RBP @ 3839'**

**Eunice; San Andres Perfs:**  
3906, 09, 13, 17, 24, 31, 38, 42, 98,  
4054, 67, 72, 74, 76, 78, 80, 82, 84,  
86, 88, 90, 92 - 4" - 22 Holes

**Production Casing:** 7-7/8" Hole  
5-1/2" 17# CSA 4210'  
Cement w / 750 sx  
Circulated to Surface

**TD @ 4210'**

Well: H Corrigan No. 13  
Pool: Penrose Skelly; Grayburg / Eunice; San Andres  
Location: 936' FNL & 1986' FEL  
Unit B, Section 4, Township 22S, Range 37E  
API#: 30-025-35137

Proposed Status: Active Oil  
Downhole Commingle  
Penrose Skelly; Grayburg &  
Eunice; San Andres Pools

**Penrose Skelly; Grayburg Perfs:**  
3692-96, 99-3704, 08-12, 15-22, 29-96  
4" - 353 Holes

**Eunice; San Andres Perfs:**  
3906, 09, 13, 17, 24, 31, 38, 42, 98,  
4054, 67, 72, 74, 76, 78, 80, 82, 84,  
86, 88, 90, 92 - 4" - 22 Holes

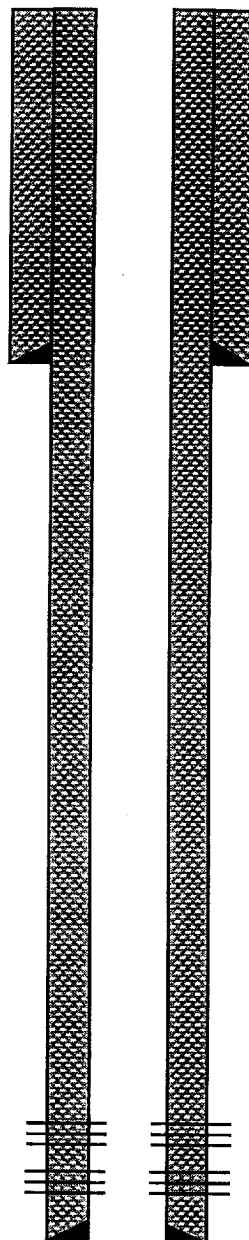

**Surface Casing:** 12-1/4" Hole  
8-5/8" 24# CSA 1160'  
Cement w / 435 sx  
Circulated to Surface

**Production Casing:** 7-7/8" Hole  
5-1/2" 17# CSA 4210'  
Cement w / 750 sx  
Circulated to Surface

TD @ 4210'

