

APPROVED

COPY TO O. C. C.

Budget Bureau No. 42-R358.4.  
Approval expires 12-31-60.Form 9-381a  
(Feb. 1961)

MAY 23 1961

(SUBMIT IN TRIPLICATE)

HOBBS

Land Office

Lease No. NM-039880

Unit

E. W. STANDLEY  
DISTRICT ENGINEERUNITED STATES  
DEPARTMENT OF THE INTERIOR  
GEOLOGICAL SURVEY

MAY 23 PM 1 36

MAY 23 1961

## SUNDRY NOTICES AND REPORTS ON WELLS

S. GEOLOGICAL SURVEY  
HOBBS, NEW MEXICO

NOTICE OF INTENTION TO DRILL	<input checked="" type="checkbox"/>	SUBSEQUENT REPORT OF WATER SHUT-OFF	
NOTICE OF INTENTION TO CHANGE PLANS		SUBSEQUENT REPORT OF SHOOTING OR ACIDIZING	
NOTICE OF INTENTION TO TEST WATER SHUT-OFF		SUBSEQUENT REPORT OF ALTERING CASING	
NOTICE OF INTENTION TO RE-DRILL OR REPAIR WELL		SUBSEQUENT REPORT OF RE-DRILLING OR REPAIR	
NOTICE OF INTENTION TO SHOOT OR ACIDIZE		SUBSEQUENT REPORT OF ABANDONMENT	
NOTICE OF INTENTION TO PULL OR ALTER CASING		SUPPLEMENTARY WELL HISTORY	
NOTICE OF INTENTION TO ABANDON WELL			

(INDICATE ABOVE BY CHECK MARK NATURE OF REPORT, NOTICE, OR OTHER DATA)

May 22, 19 61

Federal-Monagan "E"  
Well No. 2 is located 660 ft. from {N} line and 720 ft. from {E} line of sec. 15SE/4 15 24S 32E NMZM  
(1/4 Sec. and Sec. No.) (Twp.) (Range) (Meridian)Double X Delaware Lea New Mexico  
(Field) (County or Subdivision) (State or Territory)

The elevation of the derrick floor above sea level is ft. 3595.5 Gr. Level

## DETAILS OF WORK

(State names of and expected depths to objective sands; show sizes, weights, and lengths of proposed casings; indicate mudding jobs, cementing points, and all other important proposed work)

It is proposed to drill with rotary tools to the Delaware Sand at approximately 5100'.

Hole Size	Csg. Size	Csg. Wt.		Feet	Sx Cnt.
11"	8-5/8"	24#	New	400'	Circulate
7-7/8"	4-7/2"	9.5#	New	4950'	250

ILLEGIBLE

I understand that this plan of work must recel

ations may be commenced.

Company Gulf Oil Corporation

Address P. O. Box 766

Kermit, Texas

"Original Signed by  
J. L. Pike"

By

Title Area Production Manager

GPO 8 620 40

# NEW MEXICO OIL CONSERVATION COMMISSION WELL LOCATION AND ACREAGE DEDICATION PLAT

FORM C-128  
Revised 5/1/57

SEE INSTRUCTIONS FOR COMPLETING THIS FORM ON THE REVERSE SIDE

SECTION A **1:36**

Operator <b>GULF OIL CORP.</b>			Lease <b>FEDERAL HANMIGAN "B"</b>		Well No. <b>2</b>
Unit Letter <b>P</b>	Section <b>15</b>	Township <b>24 SOUTH</b>	Range <b>32 EAST</b>	County <b>LEA</b>	
Actual Footage Location of Well: <b>660</b> feet from the <b>SOUTH</b> line and <b>720</b> feet from the <b>EAST</b> line					
Ground Level Elev. <b>3595.5</b>	Producing Formation <b>Delaware</b>		Pool <b>Double X Delaware</b>		Dedicated Acreage: <b>40</b> Acres

1. Is the Operator the only owner in the dedicated acreage outlined on the plat below? YES ☒ NO ☐ ("Owner" means the person who has the right to drill into and to produce from any pool and to appropriate the production either for himself or for himself and another. 165-1-29 (e) NMSA 1955 Comp.)
2. If the answer to question one is "no," have the interests of all the owners been consolidated by communitization agreement or otherwise? YES ☐ NO ☐ If answer is "yes," Type of Consolidation \_\_\_\_\_
3. If the answer to question two is "no," list all the owners and their respective interests below.

Owner	Land Description

## SECTION B

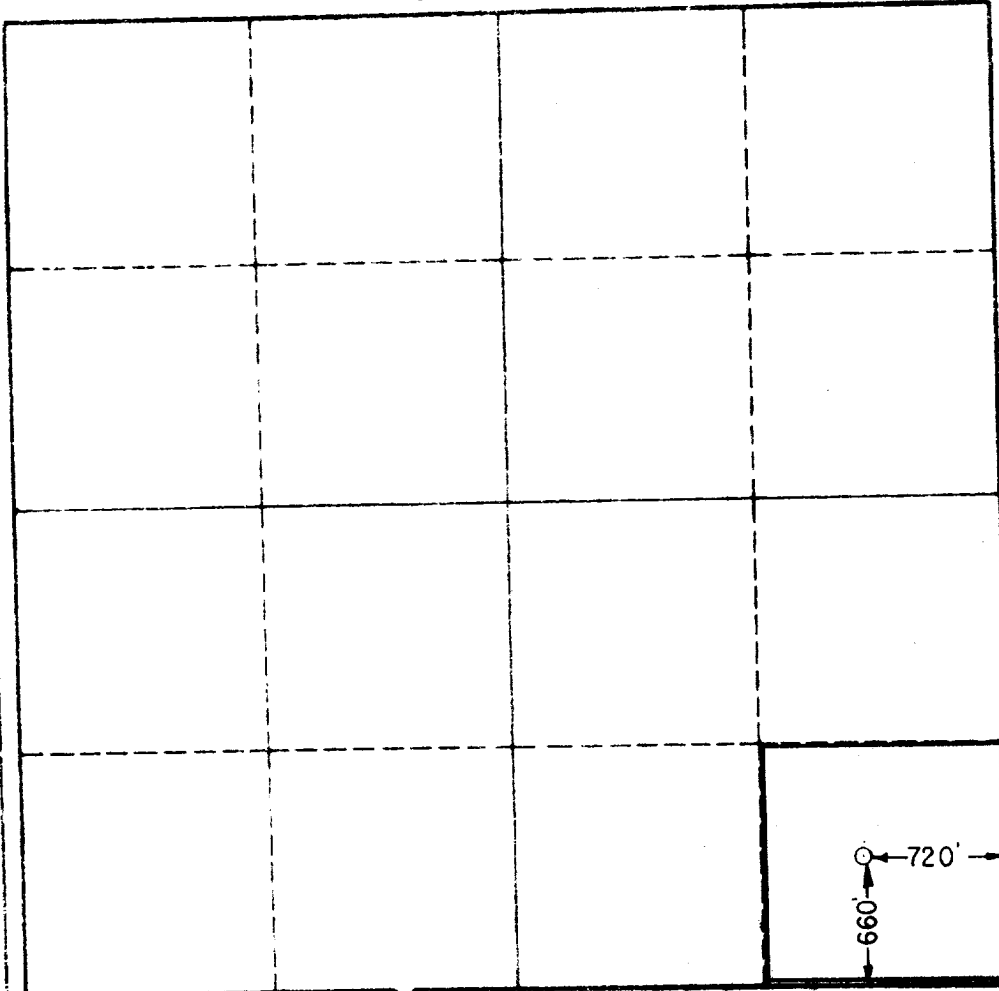

## CERTIFICATION

I hereby certify that the information in SECTION A above is true and complete to the best of my knowledge and belief.

Name **"Original Signed by J. L. Pike"**  
 Position **Area Production Manager**  
 Company **Gulf Oil Corporation**  
 Date **May 22, 1961**

I hereby certify that the well location shown on the plat in SECTION A is plotted from field notes of actual survey made by me or under my supervision, and that the same is true and correct to the best of my knowledge and belief.

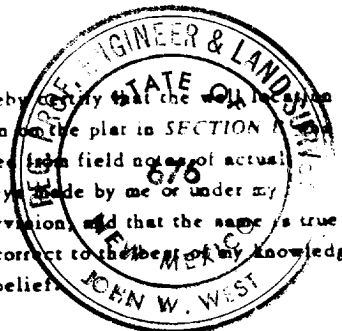

Date Surveyed **5-18-1961**  
 Registered Professional Engineer and/or Land Surveyor, **JOHN W. WEST**  
 Signature: *John W. West*  
 Certificate No. **N.M. - P.E. & L.S. NO. 876**

0 350 660 990 1320 1660 1980 2300 2640 2000 1500 1000 500 0