

Form 9-381a  
(Feb. 1961)

JUN 19 1961

(SUBMIT IN TRIPLICATE)

Land Office

X			

E. W. STANDLEY  
DISTRICT ENGINEER

UNITED STATES  
DEPARTMENT OF THE INTERIOR  
GEOLOGICAL SURVEY

Lease No. **LC-068911-A**  
Unit

1961 JUN 20 AM 8:21

# SUNDRY NOTICES AND REPORTS ON WELLS

U. S. GEOLOGICAL SURVEY  
HOBBS, NEW MEXICO

NOTICE OF INTENTION TO DRILL	X	SUBSEQUENT REPORT OF WATER SHUT-OFF	
NOTICE OF INTENTION TO CHANGE PLANS		SUBSEQUENT REPORT OF SHOOTING OR ACIDIZING	
NOTICE OF INTENTION TO TEST WATER SHUT-OFF		SUBSEQUENT REPORT OF ALTERING CASING	
NOTICE OF INTENTION TO RE-DRILL OR REPAIR WELL		SUBSEQUENT REPORT OF RE-DRILLING OR REPAIR	
NOTICE OF INTENTION TO SHOOT OR ACIDIZE		SUBSEQUENT REPORT OF ABANDONMENT	
NOTICE OF INTENTION TO PULL OR ALTER CASING		SUPPLEMENTARY WELL HISTORY	
NOTICE OF INTENTION TO ABANDON WELL			

(INDICATE ABOVE BY CHECK MARK NATURE OF REPORT, NOTICE, OR OTHER DATA)

June 19, 1961

Federal Borestrant

Well No. 1 is located 330 ft. from N line and 330 ft. from W line of sec. 24  
NM/4 NM/4 Sec. 24 T24S R32E NMFM  
(1/4 Sec. and Sec. No.) (Twp.) (Range) (Meridian)  
Double X Delaware Lea New Mexico  
(Field) (County or Subdivision) (State or Territory)

The elevation of the derrick floor above sea level is \_\_\_\_\_ ft.

## DETAILS OF WORK

(State names of and expected depths to objective sands; show sizes, weights, and lengths of proposed casings; indicate mudding jobs, cementing points, and all other important proposed work)

Intend to drill w/rotary tools-Morwood Drilling Co. to test Delaware at approximate depth of 5200', casing program as follows:

2 1/2" 8-5/8" to be cemented at approx. 300', cement to circulate  
 4-1/2" to be set at total depth w/200 mm if commercial production is obtained

C-126 attached- 5 copies

Designation of Operator in Triplicate from Annie R. Bass

Letter from operators

I understand that this plan of work must receive approval in writing by the Geological Survey before operations may be commenced.

Company OSBORN & TOMPSON and W. D. THORN  
c/o Oil Reports, Box 763, Hobbs, N.M.  
 Address \_\_\_\_\_

By \_\_\_\_\_  
 Title Agent

NEW MEXICO OIL CONSERVATION COMMISSION  
WELL LOCATION AND ACREAGE DEDICATION PLAT

FORM C-128  
Revised 5/1/57

SEE INSTRUCTIONS FOR COMPLETING THIS FORM ON THE REVERSE SIDE

SECTION A

Operator <b>OSBORN &amp; TOMPSON, INCORPORATED &amp; W. D. THORN</b>	Lease <b>FED. BONDURANT</b>	Well No. <b>1</b>
Unit Letter <b>D</b>	Section <b>24</b>	Township <b>24 SOUTH</b>
	Range <b>32 EAST</b>	County <b>LEA</b>
Actual Footage Location of Well: <b>330</b> feet from the <b>NORTH</b> line and <b>330</b> feet from the <b>WEST</b> line		
Ground Level Elev. <b>Delaware</b>	Producing Formation <b>Double X Bel</b>	Dedicated Acreage: <b>40</b> Acres

1. Is the Operator the only owner in the dedicated acreage outlined on the plat below? YES ☒ NO ☐ If answer is "no," "Operator" means the person who has the right to drill into and to produce from any pool and to appropriate the production either for himself or for himself and another. (65-3-29 (e) NMSA 1935 (comp.))
2. If the answer to question one is "no," have the interests of all the owners been consolidated by communication agreement or otherwise? YES ☐ NO ☐ If answer is "yes," Type of Consolidation \_\_\_\_\_
3. If the answer to question two is "no," list all the owners and their respective interests below:

Owner	Land Description

SECTION B

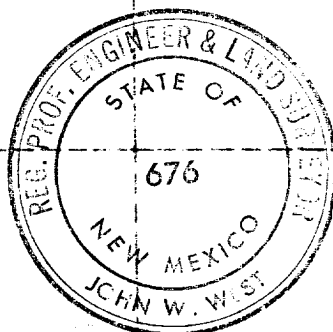
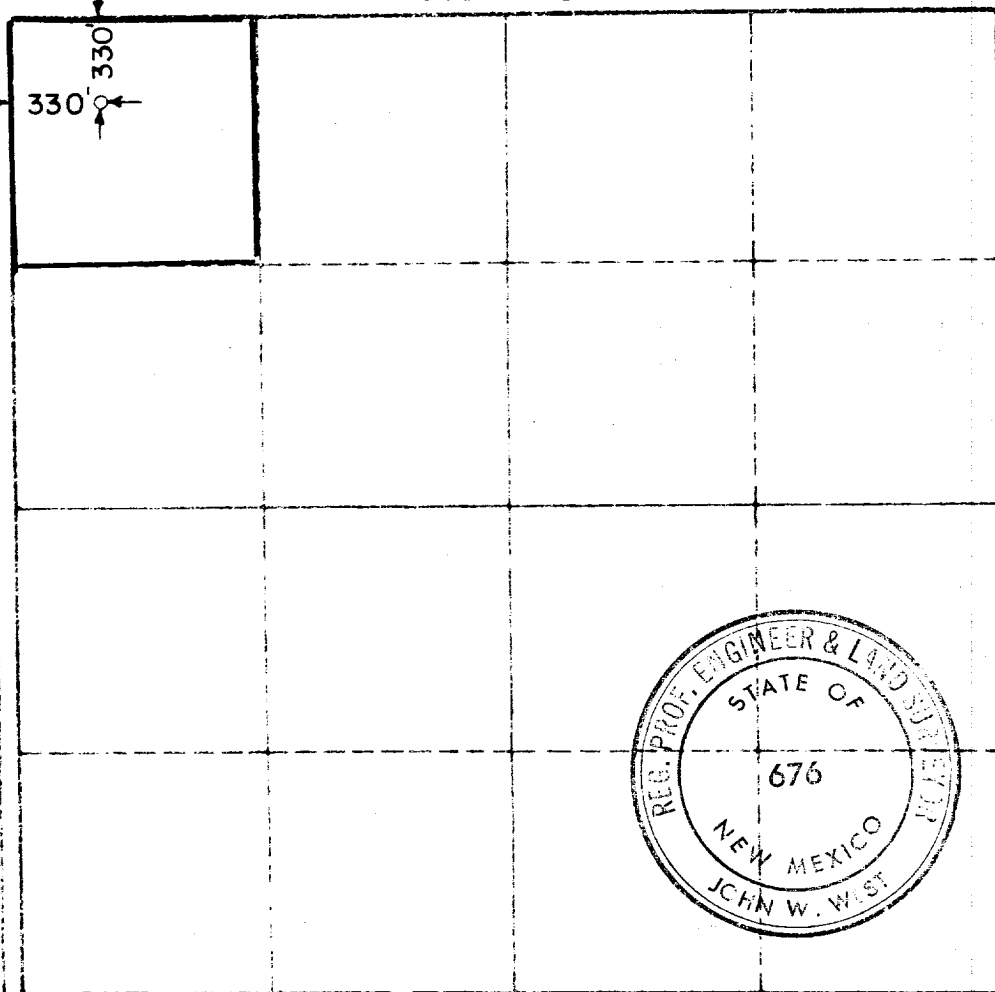

CERTIFICATION

I hereby certify that the information in SECTION A above is true and complete to the best of my knowledge and belief.

**OSBORN & TOMPSON & W.D. THORN**

Position

Company

Date **June 19, 1961**

I hereby certify that the well location shown on the plat in SECTION B was plotted from field notes of actual surveys made by me or under my supervision, and that the same is true and correct to the best of my knowledge and belief.

Date Surveyed

**JUNE 9, 1961**

Registered Professional Engineer and/or Land Surveyor, **JOHN W. WEST**

*John W. West*

Certificate No.

**N.M. P.E. & L.S. NO. 676**

0 330 660 990 1320 1650 1980 2310 2640 2000 1500 1000 500 0