



IN REPLY REFER TO:

UNITED STATES  
DEPARTMENT OF THE INTERIOR  
GEOLOGICAL SURVEY  
P. O. Box 1333  
Hobbs, New Mexico

June 13, 1957

Continental Oil Company  
Box 68  
Dunice, New Mexico

Re: Lease Las Graces 062749-C

Gentlemen:

Receipt is acknowledged of "Notice of Intention to Drill" dated June 10, 1957, covering your well No. 1 Thompson Federal 18 on the subject leasehold in the NE1/4 sec. 18, T. 26 S., R. 32 E., N.M.P.M., North Mason Delaware Pool, Lea County, New Mexico.

Your proposed work is approved subject to compliance with the provisions of the "Oil and Gas Operating Regulations" revised May 25, 1942, copy of which will be furnished you on request, and subject to the following condition:

1. Drilling operations so authorized are subject to the attached sheet (revised February 1955) for general conditions of approval.

The approval granted herein is effective as of June 14, 1957, in accordance with our telephone conversation. Please note year records to show the correct lease number 062749-C on future reports.

Very truly yours,

H. A. DuPont  
District Engineer

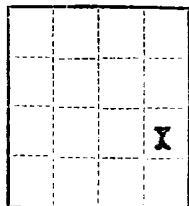

(SUBMIT IN TRIPLICATE)

UNITED STATES  
DEPARTMENT OF THE INTERIOR  
GEOLOGICAL SURVEY

Field Office Las Cruces  
Lease No. LC 062749b  
Unit \_\_\_\_\_

SUNDRY NOTICES AND REPORTS ON WELLS

NOTICE OF INTENTION TO DRILL.....	<input checked="" type="checkbox"/>	SUBSEQUENT REPORT OF WATER SHUT-OFF.....
NOTICE OF INTENTION TO CHANGE PLANS.....		SUBSEQUENT REPORT OF SHOOTING OR ACIDIZING.....
NOTICE OF INTENTION TO TEST WATER SHUT-OFF.....		SUBSEQUENT REPORT OF ALTERING CASING.....
NOTICE OF INTENTION TO RE-DRILL OR REPAIR WELL.....		SUBSEQUENT REPORT OF RE-DRILLING OR REPAIR.....
NOTICE OF INTENTION TO SHOOT OR ACIDIZE.....		SUBSEQUENT REPORT OF ABANDONMENT.....
NOTICE OF INTENTION TO PULL OR ALTER CASING.....		SUPPLEMENTARY WELL HISTORY.....
NOTICE OF INTENTION TO ABANDON WELL.....		

(INDICATE ABOVE BY CHECK MARK NATURE OF REPORT, NOTICE, OR OTHER DATA)

Thompson Federal 18

June 10, 1957

Well No. 1 is located 1980 ft. from 18 line and 660 ft. from E line of sec. 18

SE 1/4 Sec. 18  
(1/4 Sec. and Sec. No.)

26 S 32 E  
(Twp.) (Range)

101 W  
(Meridian)

North Mason Delaware  
(County or Subdivision)

Lea

New Mexico  
(State or Territory)

The elevation of the derrick floor above sea level is \_\_\_\_\_ ft.

DETAILS OF WORK

(State names of and expected depths to objective sands; show sizes, weights, and lengths of proposed casings; indicate mudlogging jobs, cementing points, and all other important proposed work)

It is intended to drill this well with rotary tools at the above location to an estimated TD of 4450'. Casing will be set in accordance with U.S.G.S. standards and other special requirements will be complied with.

The following casing pattern is planned: 10 3/4" OD set at 1000' with 1100 sacks, cement to circulate; 5 1/2" OD set at 4450' with 250 sacks regular cement.

Permission is requested to produce this well upon completion.

I understand that this plan of work must receive approval in writing by the Geological Survey before operations may be commenced.

Company Continental Oil Company

Address Box 68

Eunice, New Mexico

By [Signature]

Title District Superintendent

U. S. GOVERNMENT PRINTING OFFICE 16-5437-6



(See instructions for completion of this form)

Registered Professional  
Engineer and/or Land Surveyor.

Certificate No. 676

NEW MEXICO OIL CONSERVATION COMMISSION  
Well Location and Acreage Dedication Plat

Section A.

Date 6-11-57

Operator Continental Oil Co. (Lease) Thompson Federal 18  
Well No. 1 Unit Letter I Section 18 Township 26 S Range 32 E NMPM  
Located 1980 Feet From South Line, 660 Feet From East Line  
County Lea C. L. Elevation \_\_\_\_\_ Dedicated Acreage 40 Acres  
Name of Producing Formation Delaware Sand Pool North Mason Delaware Extension

1. Is the Operator the only owner\* in the dedicated acreage outlined on the plat below?  
Yes X No \_\_\_\_\_.
2. If the answer to question one is "no," have the interests of all the owners been consolidated by communitization agreement or otherwise? Yes \_\_\_\_\_ No \_\_\_\_\_. If answer is "yes," Type of Consolidation \_\_\_\_\_
3. If the answer to question two is "no," list all the owners and their respective interests below:

Owner

Land Description

Section B

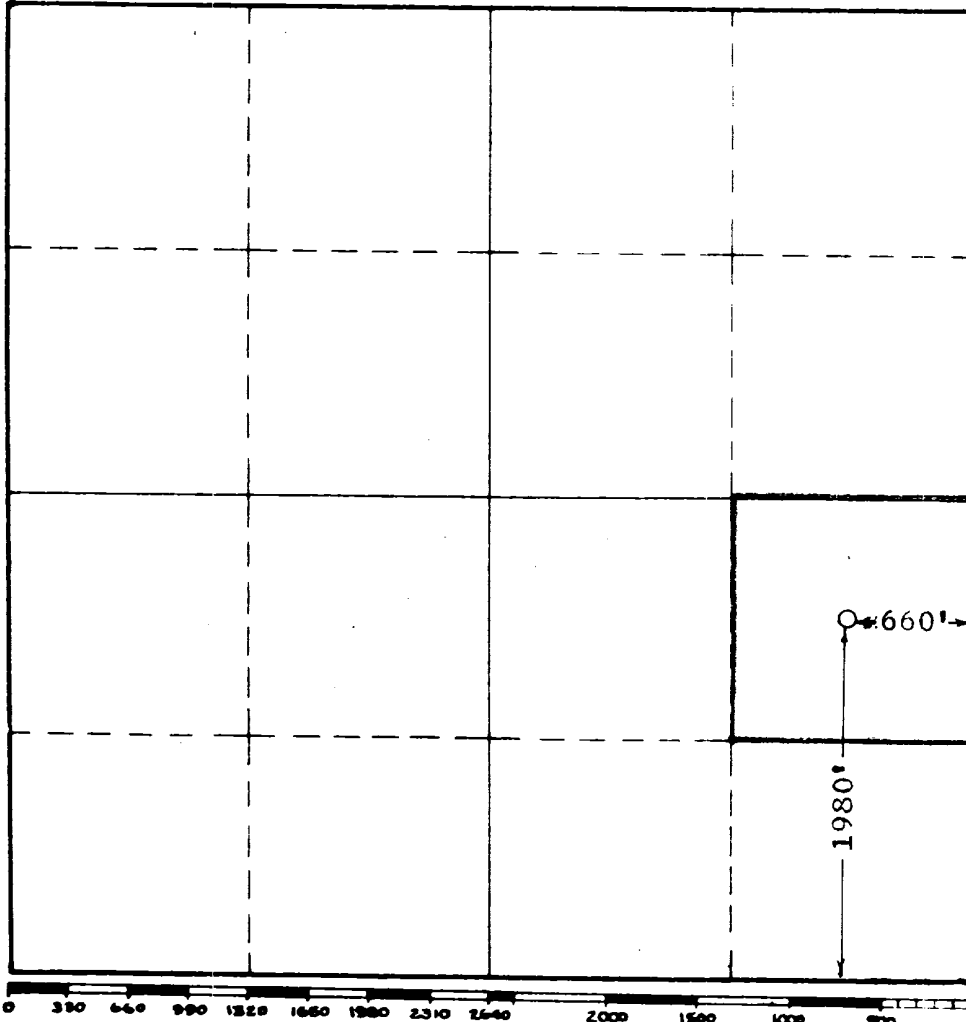

This is to certify that the information in Section A above is true and complete to the best of my knowledge and belief.

**Continental Oil Company**

(Operator)

(Representative)

**Eunice, New Mexico**

Address

This is to certify that the well location shown on the plat in Section B was plotted from field notes of actual surveys made by me or under my supervision and that the same is true and correct to the best of my knowledge and belief.

Date Surveyed 6-11-57

John W. West  
Registered Professional  
Engineer and/or Land Surveyor.

Certificate No. 676

(See instructions for completion of this plat)