

(SUBMIT IN TRIPLICATE)

UNITED STATES
DEPARTMENT OF THE INTERIOR
GEOLOGICAL SURVEY

Budget Bureau No. 42-R358.4.
Approval expires 12-31-60.

Land Office **Las Cruces**
Lease No. **069515**
Unit **G**

RECEIVED

JUL 20 1959

U. S. GEOLOGICAL SURVEY
HOBBS, NEW MEXICO

SUNDRY NOTICES AND REPORTS ON WELLS

NOTICE OF INTENTION TO DRILL	XXX	SUBSEQUENT REPORT OF WATER SHUT-OFF	
NOTICE OF INTENTION TO CHANGE PLANS		SUBSEQUENT REPORT OF SHOOTING OR ACIDIZING	
NOTICE OF INTENTION TO TEST WATER SHUT-OFF		SUBSEQUENT REPORT OF ALTERING CASING	
NOTICE OF INTENTION TO RE-DRILL OR REPAIR WELL		SUBSEQUENT REPORT OF RE-DRILLING OR REPAIR	
NOTICE OF INTENTION TO SHOOT OR ACIDIZE		SUBSEQUENT REPORT OF ABANDONMENT	
NOTICE OF INTENTION TO PULL OR ALTER CASING		SUPPLEMENTARY WELL HISTORY	
NOTICE OF INTENTION TO ABANDON WELL			

(INDICATE ABOVE BY CHECK MARK NATURE OF REPORT, NOTICE, OR OTHER DATA)

W. W. Wilner

July 17, 1959

Well No. 8 is located 1980 ft. from [N] line and 1980 ft. from [E] line of sec. 25
NE/4 25
 (1/4 Sec. and Sec. No.)
E1 Mar Delaware (Field)
26 2 33 E (Twp.) 15S1 (Range) 10W1 (Meridian)
Lee (County or Subdivision) New Mexico (State or Territory)

The elevation of the derrick floor above sea level is 3119 ft. G. L.

DETAILS OF WORK

(State names of and expected depths to objective sands; show sizes, weights, and lengths of proposed casings; indicate mudding jobs, cementing points, and all other important proposed work)

It is intended to drill a well at the above location with rotary tools to an estimated TD of 4715' in the Delaware Sand. Casing will be cemented in accordance with USGS regulations and other special requirements will be complied with.

The following casing pattern is planned: 7 5/8" casing set at 700' with 400 sacks, cement to circulate; 4 1/2" casing set at 4715' with 170 sacks, cement to return to 4000'.

I understand that this plan of work must receive approval in writing by the Geological Survey before operations may be commenced.

Company Continental Oil Company

Address Box 68, Eunice, New Mex

0/4 USGS WAM RLJ GAR

By [Signature]
Title District Superintendent

NEW MEXICO OIL CONSERVATION COMMISSION
WELL LOCATION AND ACREAGE DEDICATION PLAT

FORM C-128
 Revised 5/1/57

SEE INSTRUCTIONS FOR COMPLETING THIS FORM ON THE REVERSE SIDE

SECTION A

Operator Continental Oil Company		Lease Elmer		Well No. 8
Unit Letter G	Section 25	Township 26 S	Range 12 E	County Lea
Actual Footage Location of Well: 1980 feet from the North line and 1980 feet from the West line				
Ground Level Elev. 3119.10	Producing Formation Delaware Sand	Pool El Mar Delaware	Dedicated Acreage: 40 Acres	

1. Is the Operator the only owner in the dedicated acreage outlined on the plat below? YES **XX** NO ____ "Owner" means the person who has the right to drill into and to produce from any pool and to appropriate the production either for himself or for himself and another. (b5-3-29 (e) NMSA 1935 Comp.)
2. If the answer to question one is "no," have the interests of all the owners been consolidated by communitization agreement or otherwise? YES ____ NO ____ If answer is "yes," Type of Consolidation ____
3. If the answer to question two is "no," list all the owners and their respective interests below:

Owner ILLEGIBLE	Land Description ILLEGIBLE
---------------------------	--------------------------------------

JUL 20 1959

U. S. GEOLOGICAL SURVEY,
 HOBBS, NEW MEXICO

SECTION B

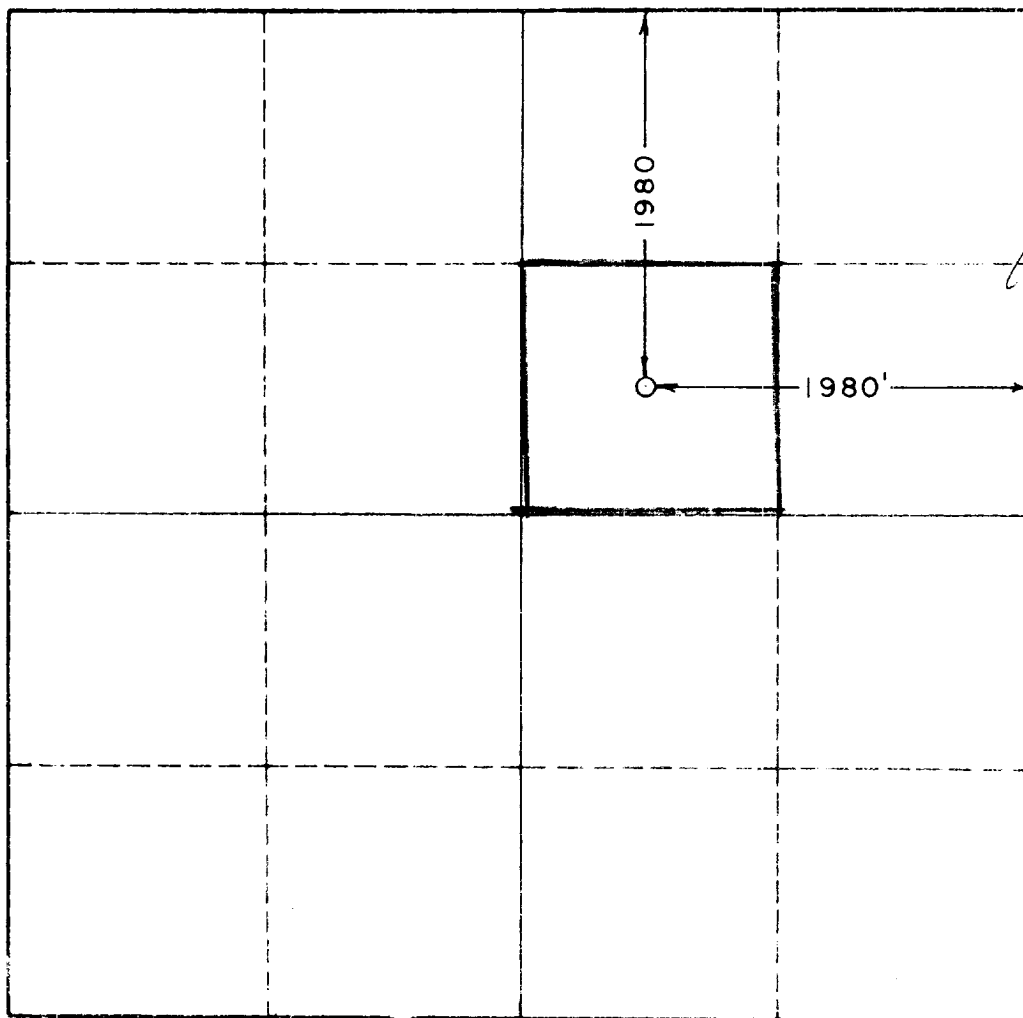

CERTIFICATION

I hereby certify that the information in SECTION A above is true and complete to the best of my knowledge and belief.

Name **J. R. Parker**
 Position **District Superintendent**
 Company **Continental Oil Company**
 Date **7-17-59**

I hereby certify that the well location shown on the plat in SECTION B was plotted from field notes of actual surveys made by me or under my supervision, and that the same is true and correct to the best of my knowledge and belief.

Date Surveyed **July 14, 1959**
 Registered Professional Engineer and/or Land Surveyor, **JOHN W. WEST**
 Certificate No. **N.M. - P.E. & L.S. NO. 676**

0 330 660 990 1320 1650 1980 2310 2640 2000 1500 1000 500 0