

APPROVED

COPY TO O. C. C. HOBBS

Form 9-331a
(Feb. 1951)

JUN 7 1960

Budget Bureau No. 42-R358.4.
Approval expires 12-31-60.

(SUBMIT IN TRIPLICATE)

Land Office Las CrucesLease No. 069515Unit L

DISTRICT ENGINEER

UNITED STATES

DEPARTMENT OF THE INTERIOR

GEOLOGICAL SURVEY

RECEIVED

JUN 7 - 1960

U. S. GEOLOGICAL SURVEY
HOBBS, NEW MEXICO

SUNDRY NOTICES AND REPORTS ON WELLS

NOTICE OF INTENTION TO DRILL.....	<input checked="" type="checkbox"/>	SUBSEQUENT REPORT OF WATER SHUT-OFF.....	
NOTICE OF INTENTION TO CHANGE PLANS.....		SUBSEQUENT REPORT OF SHOOTING OR ACIDIZING.....	
NOTICE OF INTENTION TO TEST WATER SHUT-OFF.....		SUBSEQUENT REPORT OF ALTERING CASING.....	
NOTICE OF INTENTION TO RE-DRILL OR REPAIR WELL.....		SUBSEQUENT REPORT OF RE-DRILLING OR REPAIR.....	
NOTICE OF INTENTION TO SHOOT OR ACIDIZE.....		SUBSEQUENT REPORT OF ABANDONMENT.....	
NOTICE OF INTENTION TO PULL OR ALTER CASING.....		SUPPLEMENTARY WELL HISTORY.....	
NOTICE OF INTENTION TO ABANDON WELL.....			

(INDICATE ABOVE BY CHECK MARK NATURE OF REPORT, NOTICE, OR OTHER DATA)

Wilder

June 2, 1960

19

Well No. 24 is located 1980 ft. from {N} line and 360 ft. from {E} line of sec. 26SW/4 Sec 26

(1/4 Sec. and Sec. No.)

23-7

(Twp.)

32-2

(Range)

N 100° E

(Meridian)

El Mar Delaware

(Field)

Lea

(County or Subdivision)

New Mexico

(State or Territory)

The elevation of the derrick floor above sea level is 3092 ft. GL

DETAILS OF WORK

(State names of and expected depths to objective sands; show sizes, weights, and lengths of proposed casings; indicate mudding jobs, cementing points, and all other important proposed work)

It is intended to drill a well at the above location with rotary tools to a depth of 4565' in the Delaware sand. Casing will be cemented in accordance with USGS regulations and other special requirements will be complied with.

The following casing program is planned: 7 5/8" OD set at 350' with 175 sx, cement to circulate to surface; 4 1/2" OD set at 4565' with 800 sx, cement to return to top of salt.

I understand that this plan of work must receive approval in writing by the Geological Survey before operations may be commenced.

Company Continental Oil CompanyAddress Box 68Eunice, New MexicoBy [Signature]Title District Superintendent0/4 USGS/5 plats 100 KLJ 100 plat file

NEW MEXICO OIL CONSERVATION COMMISSION
WELL LOCATION AND ACREAGE DEDICATION PLAT

FORM C-128
 Revised 5/1/57

SEE INSTRUCTIONS FOR COMPLETING THIS FORM ON THE REVERSE SIDE

SECTION A

Operator Continental Oil Co.			Lease Wilder		Well No. 24
Unit Letter L	Section 26	Township 26 South	Range 32 East	County Lea County	
Actual Footage Location of Well: 660 feet from the West line and 1980 feet from the South line					
Ground Level Elev. 3092.5	Producing Formation Delaware Sand		Pool Elmer Delaware		Dedicated Acreage: 40 Acres

1. Is the Operator the only owner in the dedicated acreage outlined on the plat below? YES XX NO ____ . ("Owner" means the person who has the right to drill into and to produce from any pool and to appropriate the production either for himself or for himself and another. (65-3-29 (e) NMSA 1935 Comp.)
2. If the answer to question one is "no," have the interests of all the owners been consolidated by communitization agreement or otherwise? YES ____ NO ____ . If answer is "yes," Type of Consolidation _____
3. If the answer to question two is "no," list all the owners and their respective interests below:

Owner	Land Description

SECTION B

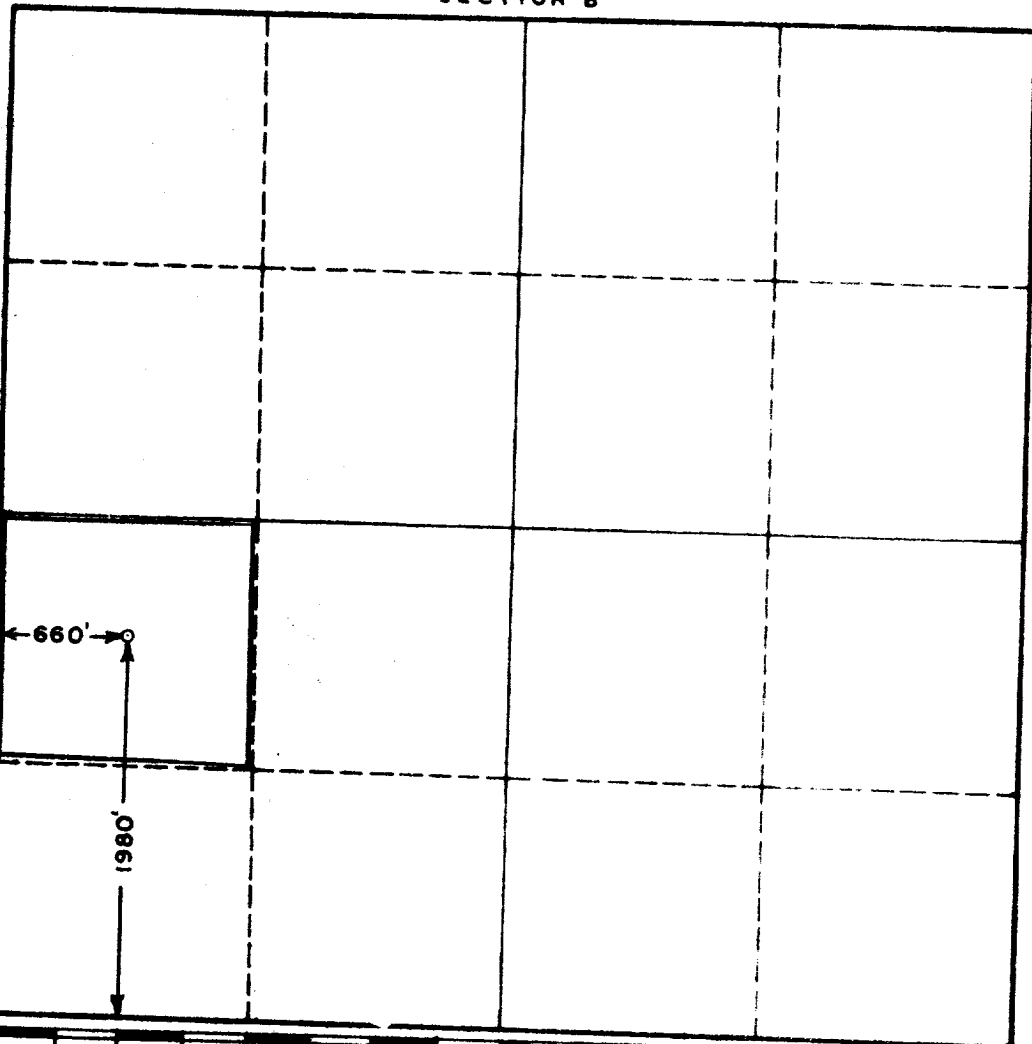

CERTIFICATION

I hereby certify that the information in SECTION A above is true and complete to the best of my knowledge and belief.

Name: J. R. Parker
 Position: District Superintendent
 Company: Continental Oil Company
 Date: June 2, 1960

I hereby certify that the well location shown on the plat in SECTION B was plotted from field notes of actual surveys made by me or under my supervision, and that the same is true and correct to the best of my knowledge and belief.

PROF. ENGINEER & LAND SURVEYOR
STATE OF NEW MEXICO

Date Surveyed: 6-3-60
 Registered Professional Engineer and/or Land Surveyor, JOHN W. WEST
 Certificate No. 676
 N.M. - P.E. & L.S. NO. 676