

(SUBMIT IN TRIPLICATE)

UNITED STATES  
DEPARTMENT OF THE INTERIOR  
GEOLOGICAL SURVEY

Land Office Las Cruces

Lease No. 062515

Unit 9

JUN 21 1960  
U. S. GEOLOGICAL SURVEY  
HOBBS, NEW MEXICO

SUNDRY NOTICES AND REPORTS ON WELLS

NOTICE OF INTENTION TO DRILL	<input checked="" type="checkbox"/>	SUBSEQUENT REPORT OF WATER SHUT-OFF	
NOTICE OF INTENTION TO CHANGE PLANS		SUBSEQUENT REPORT OF SHOOTING OR ACIDIZING	
NOTICE OF INTENTION TO TEST WATER SHUT-OFF		SUBSEQUENT REPORT OF ALTERING CASING	
NOTICE OF INTENTION TO RE-DRILL OR REPAIR WELL		SUBSEQUENT REPORT OF RE-DRILLING OR REPAIR	
NOTICE OF INTENTION TO SHOOT OR ACIDIZE		SUBSEQUENT REPORT OF ABANDONMENT	
NOTICE OF INTENTION TO PULL OR ALTER CASING		SUPPLEMENTARY WELL HISTORY	
NOTICE OF INTENTION TO ABANDON WELL			

(INDICATE ABOVE BY CHECK MARK NATURE OF REPORT, NOTICE, OR OTHER DATA)

Well No. 25 is located 1080 ft. from {N} line and 1280 ft. from {E} line of sec. 26  
10/4 Sec 26 (1/4 Sec. and Sec. No.) 10 (Twp.) 10 (Range) 10 (Meridian)  
El Paso (Field) Lea (County or Subdivision) New Mexico (State or Territory)

The elevation of the derrick floor above sea level is 3105 ft.

DETAILS OF WORK

(State names of and expected depths to objective sands; show sizes, weights, and lengths of proposed casings; indicate mudding jobs, cementing points, and all other important proposed work)

It is intended to drill a well at the above location with rotary to a depth of 4625' in the Delaware sand. Casing will be cemented in accordance with GSA regulations and other special requirements will be complied with.

The following casing program is planned: 7 5/8" OD set at 350' with 175 sx, cement to circulate to surface; 4 1/2" OD set at 4625' with 800 sx, cement to return to 300'.

I understand that this plan of work must receive approval in writing by the Geological Survey before operations may be commenced.

Company Continental Oil Company

Address Box 64

El Paso, New Mexico

By [Signature]

Title Assistant Superintendent

0/4 WTS/5 plots 100' x 100' plot file

NEW MEXICO OIL CONSERVATION COMMISSION  
WELL LOCATION AND ACREAGE DEDICATION PLAT

FORM C-128  
Revised 5/1/57

SEE INSTRUCTIONS FOR COMPLETING THIS FORM ON THE REVERSE SIDE

SECTION A

Operator <b>Continental Oil Co.</b>		Lease <b>Wilder</b>		Well No. <b>25</b>	
Unit Letter <b>G</b>	Section <b>26</b>	Township <b>26 South</b>	Range <b>32 East</b>	County <b>Lea</b>	
Actual Footage Location of Well: <b>1980</b> feet from the <b>north</b> line and <b>1980</b> feet from the <b>east</b> line					
Ground Level Elev. <b>3104.55</b>	Producing Formation <b>Delaware Sand</b>		Pool <b>Oil or Delaware</b>		Dedicated Acreage: <b>40</b> Acres

1. Is the Operator the only owner in the dedicated acreage outlined on the plat below? YES XX NO \_\_\_\_ . ("Owner" means the person who has the right to drill into and to produce from any pool and to appropriate the production either for himself or for himself and another. (65-3-29 (e) NMSA 1935 Comp.)
2. If the answer to question one is "no," have the interests of all the owners been consolidated by communitization agreement or otherwise? YES \_\_\_\_ NO \_\_\_\_ . If answer is "yes," Type of Consolidation \_\_\_\_
3. If the answer to question two is "no," list all the owners and their respective interests below:

Owner	Land Description
	<b>JUN 20 1960</b> <b>U. S. DEPARTMENT OF THE INTERIOR</b> <b>WORMS, NEW MEXICO</b>

SECTION B

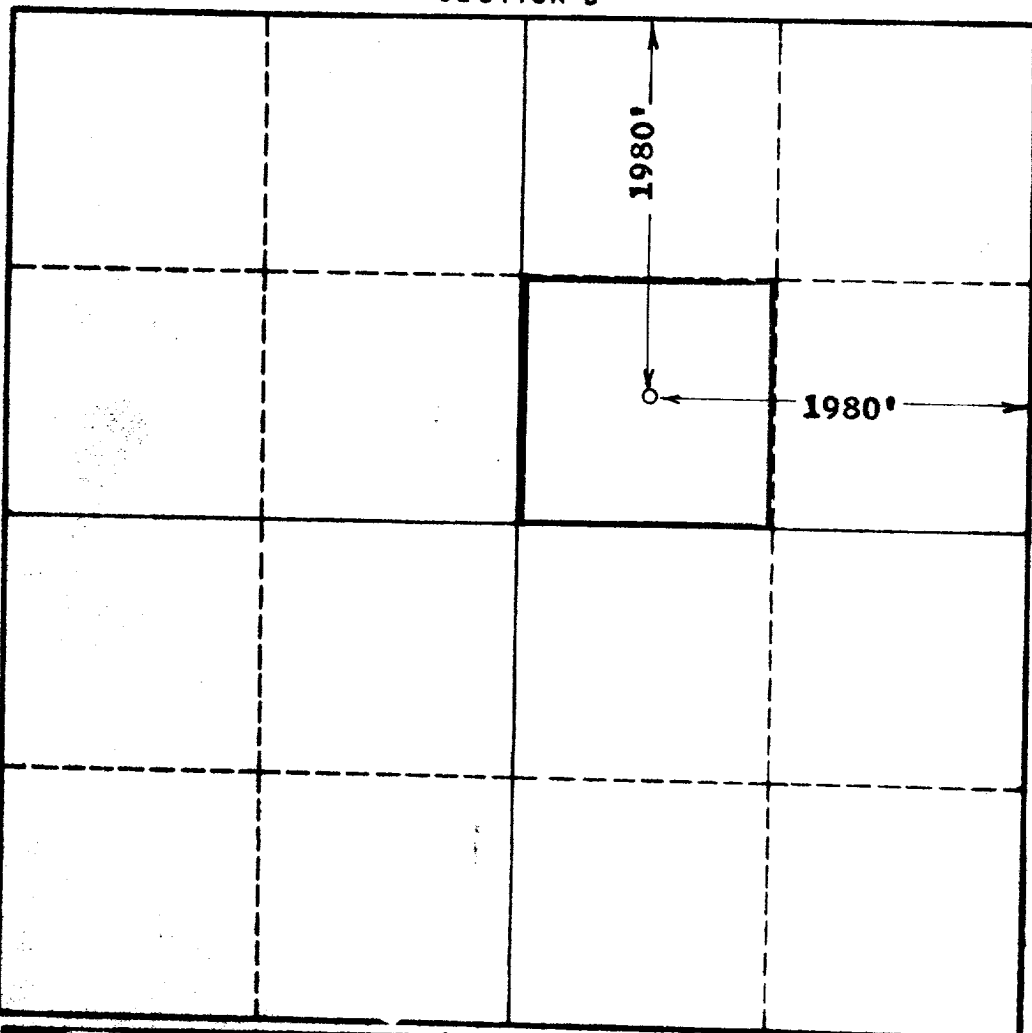

CERTIFICATION

I hereby certify that the information in SECTION A above is true and complete to the best of my knowledge and belief.

Name	<b>J. H. Parker</b>
Position	<b>District Superintendent</b>
Company	<b>Continental Oil Company</b>
Date	<b>June 17, 1960</b>

I hereby certify that the well location shown on the plat in SECTION B was plotted from field notes of actual surveys made by me or under my supervision, and that the same is true and correct to the best of my knowledge and belief.

Date Surveyed	<b>June 16, 1960</b>
Registered Professional Engineer and Land Surveyor	<b>JOHN H. WEST</b>
Certificate No.	<b>676</b>