

HOBBBS
(SUBMIT IN TRIPLICATE)

Land Office Las Cruces

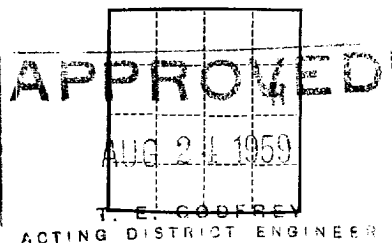

UNITED STATES
DEPARTMENT OF THE INTERIOR
GEOLOGICAL SURVEY

HOBBBS UNIT 02-791-A

Unit 1
1959 AUG 25 AM 10:28
AUG 24 1959

SUNDRY NOTICES AND REPORTS ON WELLS

NOTICE OF INTENTION TO DRILL.....	<input checked="" type="checkbox"/>	SUBSEQUENT REPORT OF WATER SHUT-OFF.....	
NOTICE OF INTENTION TO CHANGE PLANS.....		SUBSEQUENT REPORT OF SHOOTING OR ACIDIZING.....	
NOTICE OF INTENTION TO TEST WATER SHUT-OFF.....		SUBSEQUENT REPORT OF ALTERING CASING.....	
NOTICE OF INTENTION TO RE-DRILL OR REPAIR WELL.....		SUBSEQUENT REPORT OF RE-DRILLING OR REPAIR.....	
NOTICE OF INTENTION TO SHOOT OR ACIDIZE.....		SUBSEQUENT REPORT OF ABANDONMENT.....	
NOTICE OF INTENTION TO PULL OR ALTER CASING.....		SUPPLEMENTARY WELL HISTORY.....	
NOTICE OF INTENTION TO ABANDON WELL.....			

(INDICATE ABOVE BY CHECK MARK NATURE OF REPORT, NOTICE, OR OTHER DATA)

E. Payne 35

August 21, 1959

Well No. 1 is located 490 ft. from NE line and 330 ft. from E line of sec. 35

N3/4 Sec. 35 26 S 32 E R10N4
(1/4 Sec. and Sec. No.) (Twp.) (Range) (Meridian)
El Mar Delaware Dea New Mexico
(Field) (County or Subdivision) (State or Territory)

The elevation of the derrick floor above sea level is 3086 ft. GL

DETAILS OF WORK

(State names of and expected depths to objective sands; show sizes, weights, and lengths of proposed casings; indicate mudding jobs, cementing points, and all other important proposed work)

It is intended to drill a well at the above location with rotary tools to an estimated TD of 4600' in the Delaware Sand. Casing will be cemented in accordance with USGS regulations and other special requirements will be complied with.

The following casing pattern is planned: 7 5/8" casing set at 350' with 150 sacks, cement to circulate. A 1 3/8" casing set at 4600' with 170 sacks, cement to return to 4,000'.

I understand that this plan of work must receive approval in writing by the Geological Survey before operations may be commenced.

Company Continental Oil Company

Address Box 68

Sunice, New Mexico

0/4 USGS SAN HIL

By [Signature]
Title District Superintendent

NEW MEXICO OIL CONSERVATION COMMISSION
WELL LOCATION AND ACREAGE DEDICATION PLAT

FORM C-128
Revised 5/1/57

SEE INSTRUCTIONS FOR COMPLETING THIS FORM ON THE REVERSE SIDE

HOBBS OFFICE OCC

SECTION A

Operator Continental Oil Co.		Lease 1959 AUG 25 AM		Well No. 10:281
Unit Letter A	Section 35	Township 24 N	Range 2 E	County Deer
Actual Footage Location of Well: 400 feet from the 24 N line and 0 feet from the 2 E line				
Ground Level Elev. 3035.7	Producing Formation Delaware Sand	Pool El Mar Delaware	Dedicated Acreage: 49.78 Acres	

1. Is the Operator the only owner in the dedicated acreage outlined on the plat below? YES ☒ NO ☐ ("Owner" means the person who has the right to drill into and to produce from any pool and to appropriate the production either for himself or for himself and another. (65-3-29 (e) NMSA 1935 Comp.)
2. If the answer to question one is "no," have the interests of all the owners been consolidated by communitization agreement or otherwise? YES ☐ NO ☐ If answer is "yes," Type of Consolidation _____
3. If the answer to question two is "no," list all the owners and their respective interests below:

Owner	Land Description
	AUG 24 1959

U. S. DEPARTMENT OF THE INTERIOR
HOBBS, NEW MEXICO

CERTIFICATION

I hereby certify that the information in SECTION A above is true and complete to the best of my knowledge and belief.

Name
J. R. Parker
Position
District Superintendent
Company
Continental Oil Company
Date
8-21-59

I hereby certify that the well location shown on the plat in SECTION B was plotted from field notes of actual surveys made by me or under my supervision, and that the same is true and correct to the best of my knowledge and belief.

Date Surveyed
8-21-59
Registered Professional Engineer and/or Land Surveyor, JOHN W. WEST
Certificate No.
N.M. - P.E. & L.S. NO. 676

SECTION B

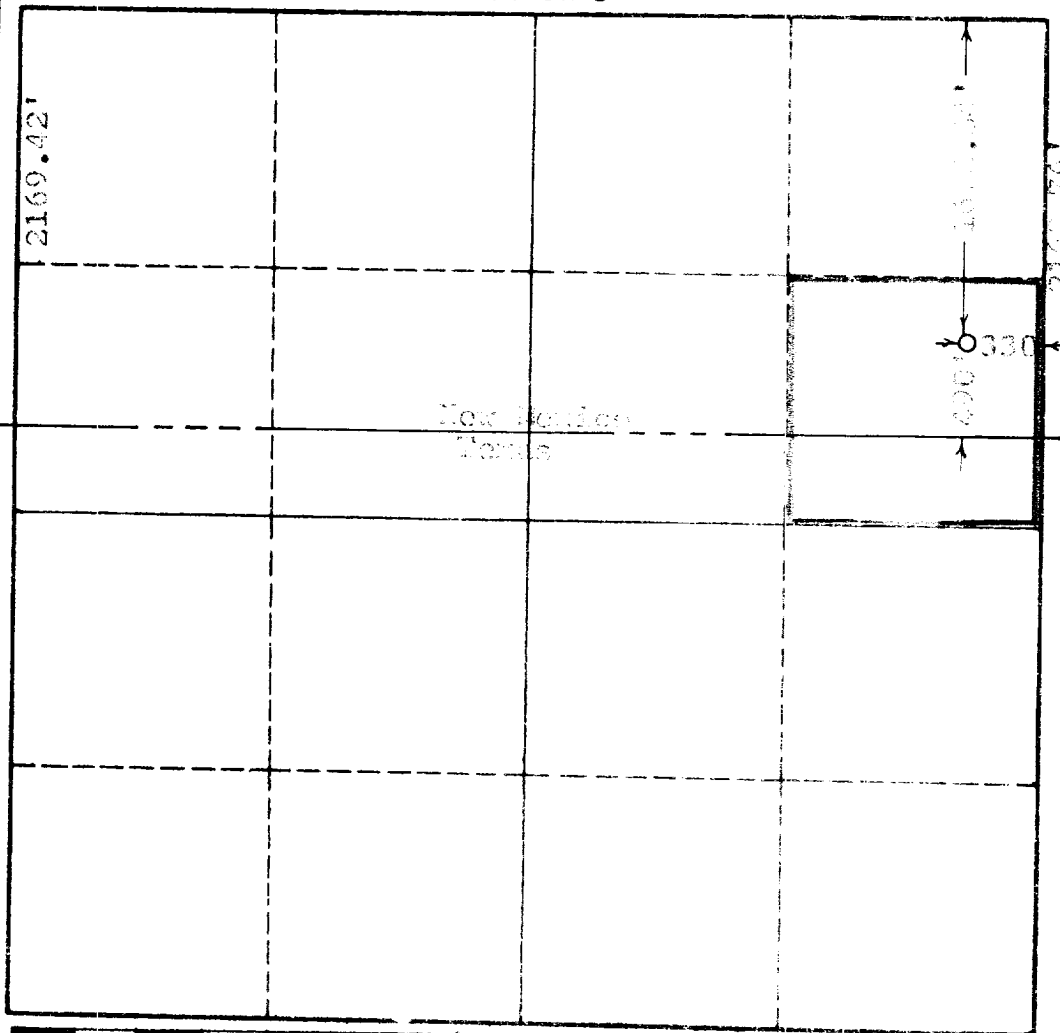

0 330 660 990 1320 1650 1980 2310 2640 2000 1500 1000 500 0