

APPROVED

COPY TO U. C. C.

Form 9-331a
(Feb. 1951)

OCT 22 1962

(SUBMIT IN TRIPLICATE)

HOBBS

Budget Bureau No. 42-R358.4.
Approved.

Land Office Las Cruces

Lease No. NM0127A

Unit Lease

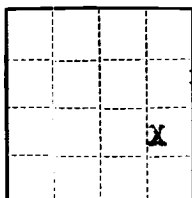

E. W. STANDLEY
DISTRICT ENGINEER

UNITED STATES
DEPARTMENT OF THE INTERIOR
GEOLOGICAL SURVEY

SUNDRY NOTICES AND REPORTS ON WELLS

NOTICE OF INTENTION TO DRILL		SUBSEQUENT REPORT OF WATER SHUT-OFF	
NOTICE OF INTENTION TO CHANGE PLANS	X	SUBSEQUENT REPORT OF SHOOTING OR ACIDIZING	
NOTICE OF INTENTION TO TEST WATER SHUT-OFF		SUBSEQUENT REPORT OF ALTERING CASING	
NOTICE OF INTENTION TO RE-DRILL OR REPAIR WELL		SUBSEQUENT REPORT OF RE-DRILLING OR REPAIR	
NOTICE OF INTENTION TO SHOOT OR ACIDIZE		SUBSEQUENT REPORT OF ABANDONMENT	
NOTICE OF INTENTION TO PULL OR ALTER CASING		SUPPLEMENTARY WELL HISTORY	
NOTICE OF INTENTION TO ABANDON WELL			

(INDICATE ABOVE BY CHECK MARK NATURE OF REPORT, NOTICE, OR OTHER DATA)

October 22, 1962

Goedeke

Well No. 3 is located 195 ft. from ~~XXN~~ [S] line and 660 ft. from ~~XXX~~ [E] line of sec. 10

NE/4 of SE/4 Sec. 10
(1/4 Sec. and Sec. No.)

26S
(Twp.)

33E
(Range)

NMPN
(Meridian)

Salado Draw
(Field)

Lea
(County or Subdivision)

New Mexico
(State or Territory)

The elevation of the derrick floor above sea level is _____ ft.

DETAILS OF WORK

(State names of and expected depths to objective sands; show sizes, weights, and lengths of proposed casings; indicate mudding jobs, cementing points, and all other important proposed work)

It is our intention to drill Goedeke No. 3 at above location which is 25' South of the plugged and abandoned Goedeke No. 3-X. Verbal approval was obtained from Mr. Jack Gordon on 10-16-62. It is proposed to drill the well to an approximate depth of 5200' to attempt a completion in the Delaware horizon. All casing points will be cemented in accordance with approved methods of the U.S.G.S. and any special requirements will be complied with. It is planned to use the following casing pattern: 11" hole, 7 5/8" casing to be set at 384' and cemented with 250 sacks cement. Cement is to circulate. 6 3/4" hole, 4 1/2" casing to be set at 5200' and cemented with 200 sacks cement. Cement is to return to 3800'.

Permission is requested to produce the well upon completion.

I understand that this plan of work must receive approval in writing by the Geological Survey before operations may be commenced.

Company Continental Oil Company

Address Box 427

Hobbs, New Mexico

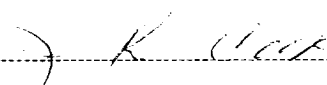
By 

Title

District Superintendent

GPO 914974

NEW MEXICO OIL CONSERVATION COMMISSION
WELL LOCATION AND ACREAGE DEDICATION PLAT

FORM C-128
Revised 5/1/57

SEE INSTRUCTIONS FOR COMPLETING THIS FORM ON THE REVERSE SIDE

SECTION A

Operator CONTINENTAL OIL COMPANY		Lease GOEDEKE		Well No. 3	
Unit Letter I	Section 10	Township 26 SOUTH	Range 33 EAST	County LEA	
Actual Footage Location of Well: 1955 feet from the SOUTH line and 660 feet from the EAST line					
Ground Level Elev. 3338	Producing Formation Delaware		Pool Salado Draw		Dedicated Acreage: 40 Acres

1. Is the Operator the only owner in the dedicated acreage outlined on the plat below? YES ☒ NO ☐ ("Owner" means the person who has the right to drill into and to produce from any pool and to appropriate the production either for himself or for himself and another. (65-3-29 (e) NMSA 1955 Comp.)
2. If the answer to question one is "no," have the interests of all the owners been consolidated by communitization agreement or otherwise? YES ☐ NO ☐ If answer is "yes," Type of Consolidation _____
3. If the answer to question two is "no," list all the owners and their respective interests below:

Owner	Land Description

SECTION B

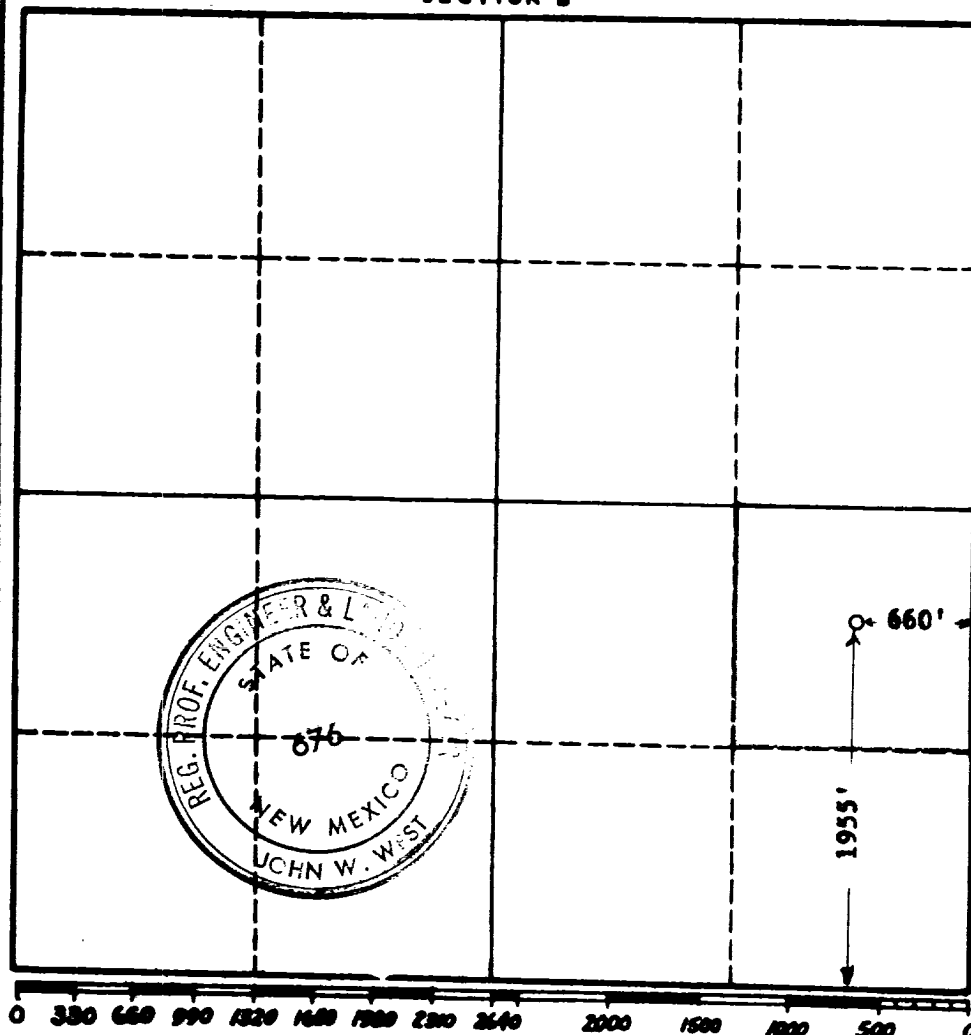

CERTIFICATION

I hereby certify that the information in SECTION A above is true and complete to the best of my knowledge and belief.

Name
J. R. Cook
Position
District Superintendent
Company
Continental Oil Company
Date
October 22, 1962

I hereby certify that the well location shown on the plat in SECTION B was plotted from field notes of actual surveys made by me or under my supervision, and that the same is true and correct to the best of my knowledge and belief.

Date Surveyed
10-9-1962
Registered Professional Engineer and/or Land Surveyor, **JOHN W. WEST**
John W. West
Certificate No.
N. M. - P. E. & L. S. NO. 676