

NEW MEXICO OIL CONSERVATION COMMISSION  
Santa Fe, New Mexico

Form G-101  
Revised (12/1/55)

NOTICE OF INTENTION TO DRILL

Notice must be given to the District Office of the Oil Conservation Commission and approval obtained before drilling or recompletion begins. If changes in the proposed plan are considered advisable, a copy of this notice showing such changes will be returned to the sender. Submit this notice in QUINTUPLICATE. One copy will be returned following approval. See additional instructions in Rules and Regulations of the Commission. If State Land submit 6 Copies Attach Form G-128 in triplicate to first 3 copies of form G-101

Midland, Texas  
(Place)

August 30, 1962  
(Date)

OIL CONSERVATION COMMISSION  
SANTA FE, NEW MEXICO

Gentlemen:

You are hereby notified that it is our intention to commence the Drilling of a well to be known as  
Humble Oil & Refining Company Co. Use Nos. 60-1600, 1600-1

(Company or Operator)

Malcolm R. Madera "B"

(Lease)

, Well No. 1, in E The well is

located 2310' feet from the North line and 900' feet from the West

line of Section 10, T. 33-S, R. 33-E, NMPM.

(GIVE LOCATION FROM SECTION LINE) Salado Draw Pool, Lea County

If State Land the Oil and Gas Lease is No. None

If patented land the owner is Malcolm R. Madera, et al

Address Box 110, Oria, Texas

We propose to drill well with drilling equipment as follows: Rotary

The status of plugging bond is On file in Commission office

Drilling Contractor Lone Drilling Company

We intend to complete this well in the Delaware

formation at an approximate depth of 5200 feet

CASING PROGRAM

We propose to use the following strings of Casing and to cement them as indicated:

Size of Hole	Size of Casing	Weight per Foot	New or Second Hand	Depth	Backs Cement
11"	8-5/8"	24#	New	0'	50' 61" 11"
7-7/8"	2-7/8"	6.4	New	5200'	50' 61" 11"

If changes in the above plans become advisable we will notify you immediately.

ADDITIONAL INFORMATION (If recompletion give full details of proposed plan of work.)

- \* Circled to surface of ground.
- \* Circled to at least 600' above top of uppermost pay zone.
- lin. mud for samples
- Plug & Plug method of cementing.

CORE PROGRAM  
5125' in Ramsey

NOTE: Refer to Mr. Dar S. Nutters letter dated 3-20-62 concerning slim hole drilling in this area.

Sincerely yours,

HUMBLE OIL & REFINING COMPANY

(Company or Operator)

By J. E. Pinkerton

Position Adm. Specialist

Send Communications regarding well to

Name Mr. R. R. McCarty

Address Box 1600, Midland, Texas

OIL CONSERVATION COMMISSION

By [Signature]

HUMBLE LEASE NO. <sup>602833</sup> 602737

NEW MEXICO OIL CONSERVATION COMMISSION

STATE LEASE NO.  
FEDERAL LEASE NO.

Well Location and Acreage Dedication Plat

Form C-128  
Revised 5/1/57

Section A.

Date August 30 1962

Operator Humble Oil & Refining Co. Lease Mohave Maderan "B"  
Well No. 2 Unit Letter "E" Section 10 Township 26 South Range 33 East NMPM  
Located 2310 Feet From North Line, 990 Feet From West Line  
County Lea G. L. Elevation Later Dedicated Acreage 40 Acres  
Name of Producing Formation Delaware Pool Salado Draw

1. Is the Operator the only owner\* in the dedicated acreage outlined on the plat below?  
Yes ☒ No ☐
2. If the answer to question one is "no", have the interests of all the owners been consolidated by communitization agreement or otherwise? Yes ☐ No ☐ If answer is "yes," Type of Consolidation \_\_\_\_\_
3. If the answer to question two is "no," list all the owners and their respective interests below:

Owner

Land Description

Section B

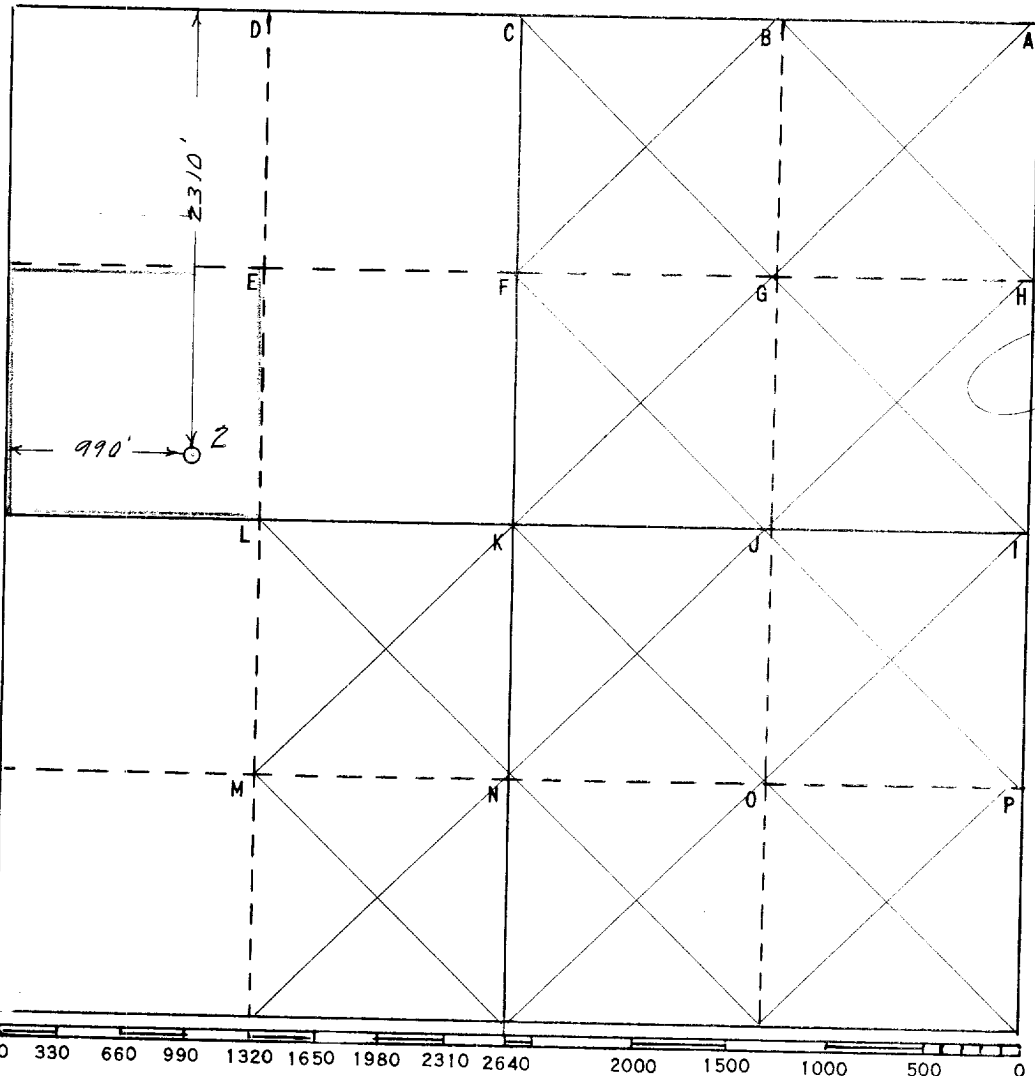

This is to certify that the information in Section A above is true and complete to the best of my knowledge and belief

HUMBLE OIL & REFG. CO.

(Operator)

[Signature]  
(Representative)

Box 1600 Midland, Texas  
Address

This is to certify that the well location shown on the plat in Section B was plotted from field notes of actual surveys made by me or under my supervision and that the same is true and correct to the best of my knowledge and belief.

Date Surveyed B-30-62

[Signature]  
Registered Professional  
Engineer and/or Land Surveyor

Certificate No. 1382

FILE NO. W-A-3371