

HOBBS OFFICE OCC
HUMBLE OIL & REFINING COMPANY

MIDLAND AREA
MIDLAND, TEXAS

APR 5 AM 10:10

April 4, 1962

New Mexico Oil Conservation Commission
Box 1545
Hobbs, N. M.

Re: ELEVATION

~~Texas Railroad Commission~~
~~Oil & Gas Division~~

Attn:

Gentlemen:

The ELEVATION of the following well is: Est 3301 DF 3292 Gr as
reported by Laughlin-Simmons & Company.

COUNTY: Lea, N. M. Field: Salado Draw

Humble Oil & Refining Company

#1 Ammons, Miller

Sec 15, T-26-S, R-33-E

660' FNL & 660' FWL of Sec.

The above is given you to complete your records for the Form 1,
"Notice of Intention to Drill," filed with you on this well under date of:

3-14-62

HUMBLE OIL & REFINING COMPANY
BILL R. PAYNE, AREA EXPL. MANAGER

By: F. H. McMahon

F. H. McMahon

FHM/lst

Orig: 1 cc: Texas RRC
cc: Mr. D. C. Fransen
Mr. R. R. McCarty
Mr. H. L. Beckman
Dist. Supt.
File

NEW MEXICO OIL CONSERVATION COMMISSION
Santa Fe, New Mexico

Form C-101
Revised (12/1/55)

NOTICE OF INTENTION TO DRILL

Notice must be given to the District Office of the Oil Conservation Commission and approval obtained before drilling or recompletion begins. If changes in the proposed plan are considered advisable, a copy of this notice showing such changes will be returned to the sender. Submit this notice in QUINTUPLICATE. One copy will be returned following approval. See additional instructions in Rules and Regulations of the Commission. If State Land submit 6 Copies Attach Form C-128 in triplicate to first 3 copies of form C-101

Midland, Texas
(Place)

3-14-62
(Date)

OIL CONSERVATION COMMISSION
SANTA FE, NEW MEXICO

Gentlemen:

You are hereby notified that it is our intention to commence the Drilling of a well to be known as
Humble Oil & Refining Co. 601100, 600752-53
(Company or Operator)

Miller Ammons (Lease), Well No. 1, in D (Unit) The well is located 660 feet from the North line and 660 feet from the West line of Section 15, T. 26 N., R. 33-E, NMPM.
(GIVE LOCATION FROM SECTION LINE) Salado Draw Undesignated Pool, Lea County

If State Land the Oil and Gas Lease is No.

If patented land the owner is

Address

We propose to drill well with drilling equipment as follows: rotary

The status of plugging bond is on file

Drilling Contractor unknown

We intend to complete this well in the Delaware formation at an approximate depth of 5200' feet.

CASING PROGRAM

We propose to use the following strings of Casing and to cement them as indicated:

Size of Hole	Size of Casing	Weight per Foot	New or Second Hand	Depth	Sacks Cement
11	8-5/8	24	New	300	150 sks*
7-7/8	2-7/8	6.4	New	5200	300 sks**

If changes in the above plans become advisable we will notify you immediately.

ADDITIONAL INFORMATION (If recompletion give full details of proposed plan of work.)

*Circl to surf of the ground.

**Circl to at least 600' above top of uppermost pay zone.

Min. mud for samples.

HONCO method of cmtg. to be used.

CORES

2 5000-5100 Delaware

Approved: _____, 19_____
Except as follows:

OIL CONSERVATION COMMISSION

Sincerely yours,

HUMBLE OIL & REFINING COMPANY

By: J.E. Pinkerton
(Company or Operator)

Position: Adm. Supervisor

Send Communications regarding well to

Name: R. R. McCarty

Box 1600, Midland, Texas

HUMBLE LEASE NO.
STATE LEASE NO.
FEDERAL LEASE NO.

NEW MEXICO OIL CONSERVATION COMMISSION

Form C-128
Revised 5/1/57

Well Location and Acreage Dedication Plat

Section A.

Date 3-9-62

Operator Humble Oil & Refining Co. Lease Miller Ammons, et al
Well No. 1 Unit Letter D Section 15 Township 26 S Range 33 E NMPM
Located 660 Feet From North Line, 660 Feet From West Line
County Lea G. L. Elevation Later Dedicated Acreage 40 Acres
Name of Producing Formation Delaware Pool Salado Draw

1. Is the Operator the only owner* in the dedicated acreage outlined on the plat below?
Yes X No _____
2. If the answer to question one is "no", have the interests of all the owners been consolidated by communitization agreement or otherwise? Yes _____ No _____ If answer is "yes," Type of Consolidation _____
3. If the answer to question two is "no," list all the owners and thier respective interests below:

Owner

Land Description

Section B

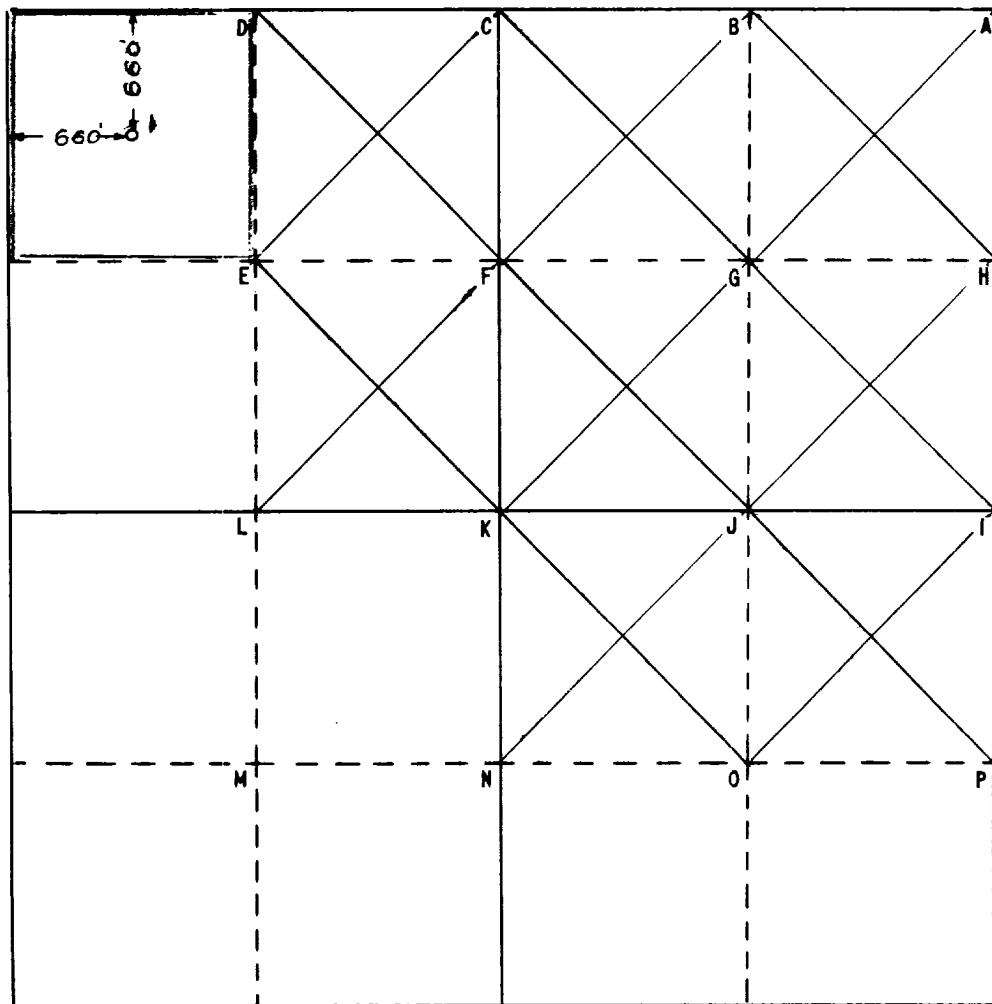

This is to certify that the information in Section A above is true and complete to the best of my knowledge and belief

HUMBLE OIL & REFG. CO.

(Operator)

R. R. McComb

(Representative)

Box 1600 Midland, Texas

Address

This is to certify that the well location shown on the plat in Section B was plotted from field notes of actual surveys made by me or under my supervision and that the same is true and correct to the best of my knowledge and belief.

Date Surveyed 3-7-62

H. S. Winterfeld
Registered Professional
Engineer and/or Land Surveyor

Certificate No. 1382

0 330 660 990 1320 1650 1980 2310 2640 2000 1500 1000 500 0

FILE NO. W. A. 3290

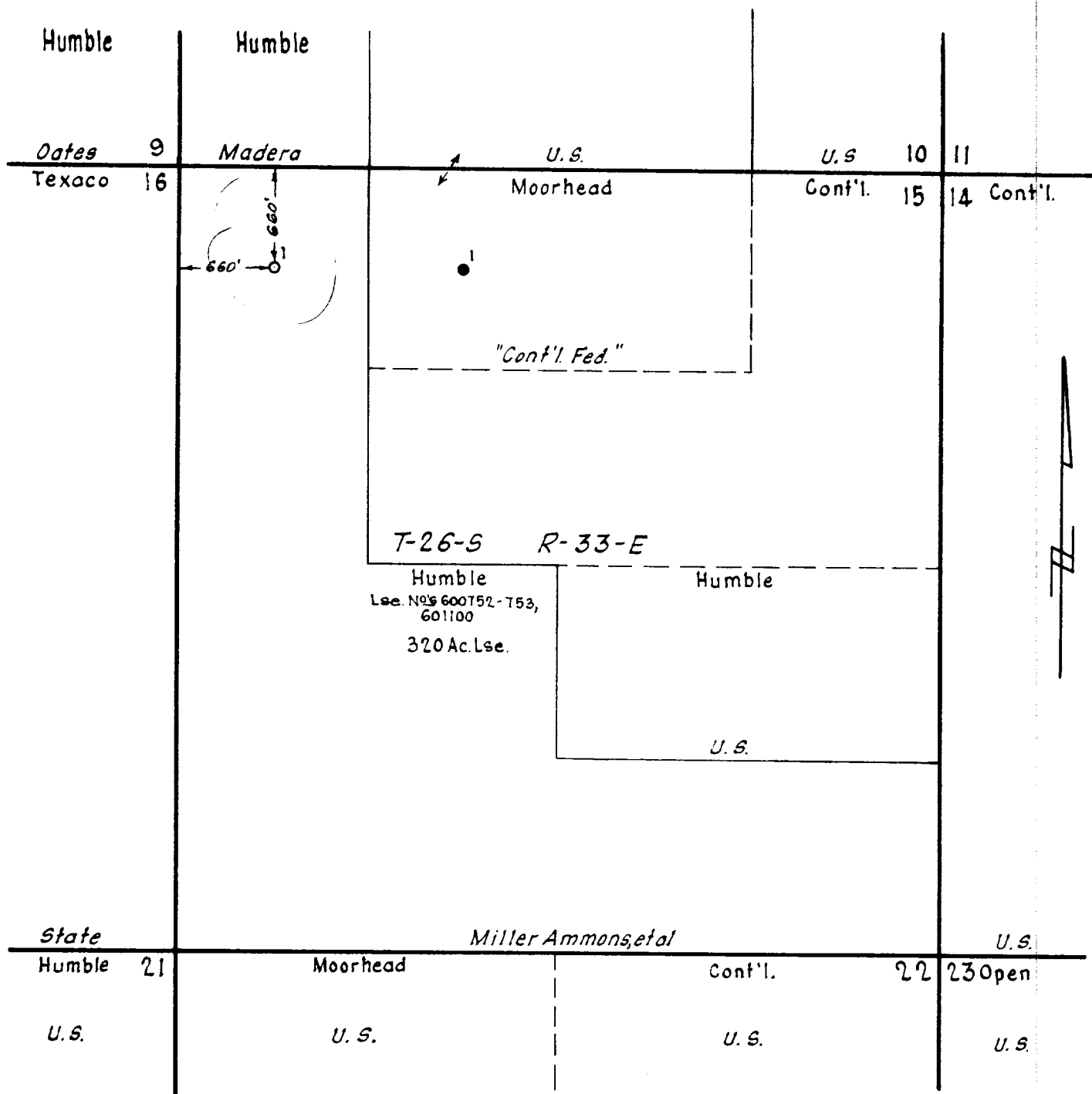

This is to certify that I am a registered professional engineer or registered land surveyor, in the State of New Mexico, that this map was prepared from field notes of actual surveys made by me or under my direction and that the same is true and correct to the best of my knowledge and belief.

1382 *H. S. Hunterfeldt*
Registration Number Registered Professional Engineer or Registered Land Surveyor

THIS APPLICATION FOR WELL NO 1

MILLER AMMONS, ETAL - Lse. Nos 600752-753,
601100

LEA CO, NEW MEXICO

HUMBLE OIL & REFINING COMPANY
CIVIL ENGINEERING DIVISION
MIDLAND, TEXAS

DRAWN *H. M. Geiby*

CHECKED *D. M. Geiby*

APPR.

SCALE 1"=1000'

DATE 3-9-62

REVISED

FILE NO.

W-A3290

1. The first step is to identify the problem. This involves understanding the current situation and the goals that need to be achieved.

1979-1980