

764 K

APPROVED
(Feb. 1951)

OCT 21 1959

A. P. KLEEMAN
DISTRICT ENGINEER

Budget Bureau No. 42-R358.4.
Approval expires 12-31-60.

(SUBMIT IN TRIPLICATE)

Land Office **NM**
 Lease No. **02791 A**
 Unit **K**

UNITED STATES
DEPARTMENT OF THE INTERIOR
GEOLOGICAL SURVEY

RECEIVED
OCT 21 1959
OCT 23 PM 3:11

SUNDRY NOTICES AND REPORTS ON WELLS
U.S. GEOLOGICAL SURVEY
HOBBS, NEW MEXICO

NOTICE OF INTENTION TO DRILL.....	XX	SUBSEQUENT REPORT OF WATER SHUT-OFF.....	
NOTICE OF INTENTION TO CHANGE PLANS.....		SUBSEQUENT REPORT OF SHOOTING OR ACIDIZING.....	
NOTICE OF INTENTION TO TEST WATER SHUT-OFF.....		SUBSEQUENT REPORT OF ALTERING CASING.....	
NOTICE OF INTENTION TO RE-DRILL OR REPAIR WELL.....		SUBSEQUENT REPORT OF RE-DRILLING OR REPAIR.....	
NOTICE OF INTENTION TO SHOOT OR ACIDIZE.....		SUBSEQUENT REPORT OF ABANDONMENT.....	
NOTICE OF INTENTION TO PULL OR ALTER CASING.....		SUPPLEMENTARY WELL HISTORY.....	
NOTICE OF INTENTION TO ABANDON WELL.....			

(INDICATE ABOVE BY CHECK MARK NATURE OF REPORT, NOTICE, OR OTHER DATA)

COPY TO O. C. C. HOBBS

October 20, 1959

Well No. **Payne 34** is located **1980** ft. from **XX** line and **1980** ft. from **XX** line of sec. **30**

SW/4 30 (1/4 Sec. and Sec. No.) **26-S** (Twp.) **33-E** (Range) **NMPM** (Meridian)
El Mar Delaware (Field) **Lea** (County or Subdivision) **New Mexico** (State or Territory)

OPERATIONS BY:

- ☒ RECORD LESSEE
☒ D. OF D. ON FILE
☒ D. OF D. ATTACHED
 BOND COVERAGE
☒ \$5,000 ATTACHED
☒ \$5,000 ON FILE
☒ LESSEE'S NATION - WIDE
☒ OPERATOR'S NATION - WIDE

The elevation of the derrick floor above sea level is **3119** ft. GL

DETAILS OF WORK

(State names of and expected depths to objective sands; show sizes, weights, and lengths of proposed casings; indicate mudding ing points, and all other important proposed work)

It is intended to drill a well at the above location with rotary tools to a depth of 4740' in the Delaware Sand. Casing will be cemented in accordance with USGS regulations and other special requirements will be complied with.

The following casing program is planned: 7 5/8" OD set at 350' with 175 sacks, cement to circulate to surface; 4 1/2" OD set at 4740' with 175 sacks, cement to return to 4000'.

I understand that this plan of work must receive approval in writing by the Geological Survey before operations may be commenced.

Company **Continental Oil Company**

Address **Box 68**

Eunice, New Mexico

By *[Signature]*

Title **District Superintendent**

0/4 USGS; WAM; HLJ; WAR/plat; file

NEW MEXICO OIL CONSERVATION COMMISSION
WELL LOCATION AND ACREAGE DEDICATION PLAT

RECEIVED
FORM C-128
OCT 21 1959
U. S. GEOLOGICAL SURVEY
HORRIS, NEW MEXICO

SEE INSTRUCTIONS FOR COMPLETING THIS FORM ON THE REVERSE SIDE

SECTION A

Operator Continental Oil Co.		Lease Payne		Well No. #84	
Unit Letter K	Section 30	Township 20 South	Range 33 East	County Lea County	
Actual Footage Location of Well: 1980' feet from the South line and 1980' feet from the West line					
Ground Level Elev. 3118.55'	Producing Formation Delaware Sand		Pool El Mar Delaware	Dedicated Acreage: 40 Acres	

1. Is the Operator the only owner in the dedicated acreage outlined on the plat below? YES IX NO ____ ("Owner" means the person who has the right to drill into and to produce from any pool and to appropriate the production either for himself or for himself and another. (65-3-29 (e) NMSA 1935 Comp.)
2. If the answer to question one is "no," have the interests of all the owners been consolidated by communitization agreement or otherwise? YES ____ NO ____ If answer is "yes," Type of Consolidation ____
3. If the answer to question two is "no," list all the owners and their respective interests below:

Owner	Land Description

SECTION B

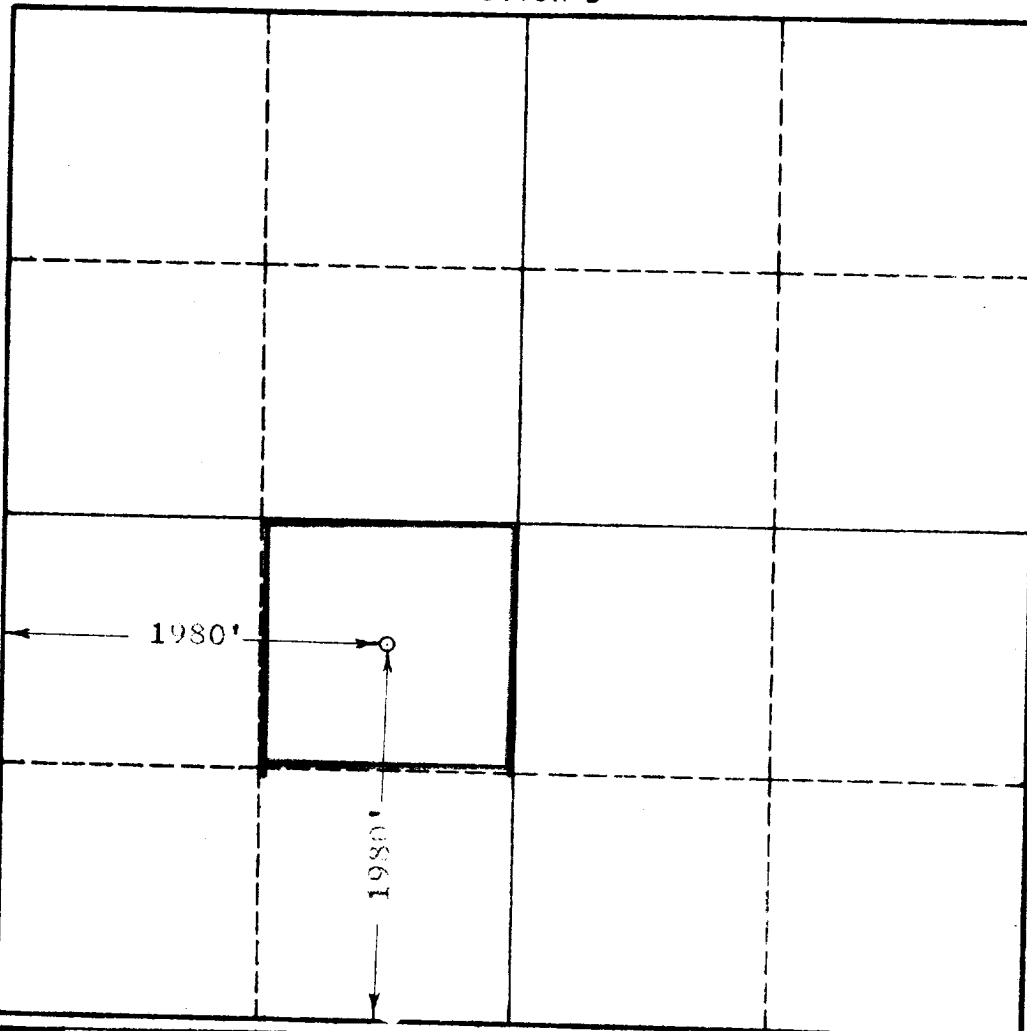

CERTIFICATION

I hereby certify that the information in SECTION A above is true and complete to the best of my knowledge and belief.

Name J. A. Parker
Position District Superintendent
Company Continental Oil Company
Date October 20, 1959

I hereby certify that the well location shown on the plat in SECTION B was plotted from field notes of actual surveys made by me or under my supervision, and that the same is true and correct to the best of my knowledge and belief.

Date Surveyed 10-6-59
Registered Professional Engineer and/or Land Surveyor, JOHN W. WEST
Certificate No. N.M. - P.E. & L.S. NO. 676