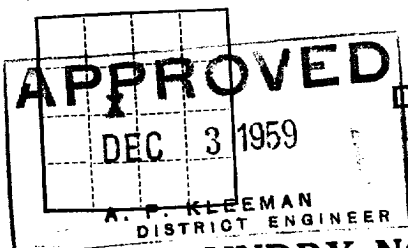

CO - TO O. C. C. HOBBS

Budget Bureau No. 42-R358.4.
Approval expires 12-31-60.

(SUBMIT IN TRIPLICATE)

 UNITED STATES
 DEPARTMENT OF THE INTERIOR
 GEOLOGICAL SURVEY

 Land Office **NM**
 Lease No. **02791 4**
 Unit **11**

DEC 3 1959

SUNDRY NOTICES AND REPORTS ON WELLS

U. S. GEOLOGICAL SURVEY
HOBBS, NEW MEXICO

NOTICE OF INTENTION TO DRILL	<input checked="" type="checkbox"/>	SUBSEQUENT REPORT OF WATER SHUT-OFF	
NOTICE OF INTENTION TO CHANGE PLANS		SUBSEQUENT REPORT OF SHOOTING OR ACIDIZING	
NOTICE OF INTENTION TO TEST WATER SHUT-OFF		SUBSEQUENT REPORT OF ALTERING CASING	
NOTICE OF INTENTION TO RE-DRILL OR REPAIR WELL		SUBSEQUENT REPORT OF RE-DRILLING OR REPAIR	
NOTICE OF INTENTION TO SHOOT OR ACIDIZE		SUBSEQUENT REPORT OF ABANDONMENT	
NOTICE OF INTENTION TO PULL OR ALTER CASING		SUPPLEMENTARY WELL HISTORY	
NOTICE OF INTENTION TO ABANDON WELL			

(INDICATE ABOVE BY CHECK MARK NATURE OF REPORT, NOTICE, OR OTHER DATA)

November 30, 1959

 Well No. **Payne 5** is located **1880** ft. from **N** line and **1980** ft. from **W** line of sec. **30**
NW/4 **Sec 30** **26-S** **33-E** **HMPM**
 (1/4 Sec. and Sec. No.) (Twp.) (Range) (Meridian)
El Mar Delaware **Lea** **New Mexico**
 (Field) (County or Subdivision) (State or Territory)
The elevation of the derrick floor above sea level is **3133** ft. GL

DETAILS OF WORK

(State names of and expected depths to objective sands; show sizes, weights, and lengths of proposed casings; indicate mudlogging jobs, cementing points, and all other important proposed work)

It is intended to drill a well at the above location with rotary tools to a depth of 4715' in the Delaware Sand. Casing will be cemented in accordance with USGS regulations and other special requirements will be complied with.

The following casing program is planned: 7 5/8" OD set at 350 with 175 sacks, cement to circulate to surface; 4 1/2" OD set at 4715 with 175 sacks, cement to return to 4000'.

I understand that this plan of work must receive approval in writing by the Geological Survey before operations may be commenced.

Company **Continental Oil Company**Address **Box 68****Eunice, New Mexico**By *J. K. Harker*Title **District Superintendent**

GPO 862040

all units / 5 plat: HLL; WAM; WAR/plat; File

NEW MEXICO OIL CONSERVATION COMMISSION
WELL LOCATION AND ACREAGE DEDICATION PLAT

FORM C-128
Revised 5/1/57

SEE INSTRUCTIONS FOR COMPLETING THIS FORM ON THE REVERSE SIDE

SECTION A

Operator Continental Oil Co.		Lease Payne DEC 8 AM 11 45		Well No. 25
Unit Letter E	Section 30	Township 26 South	Range 33 East	County Lea County
Actual Footage Location of Well: 1880' feet from the North line and 1980' feet from the West line				
Ground Level Elev. 3132.60'	Producing Formation Delaware Sand	Pool El Mar Delaware	Dedicated Acreage: 40 Acres	

1. Is the Operator the only owner in the dedicated acreage outlined on the plat below? YES ☒ NO _____. ("Owner" means the person who has the right to drill into and to produce from any pool and to appropriate the production either for himself or for himself and another. (65-3-29 (e) NMSA 1935 Comp.)
2. If the answer to question one is "no," have the interests of all the owners been consolidated by communitization agreement or otherwise? YES _____. If answer is "yes," Type of Consolidation _____
3. If the answer to question two is "no," list all the owners and their respective interests below:

Owner	Land Description

SECTION B

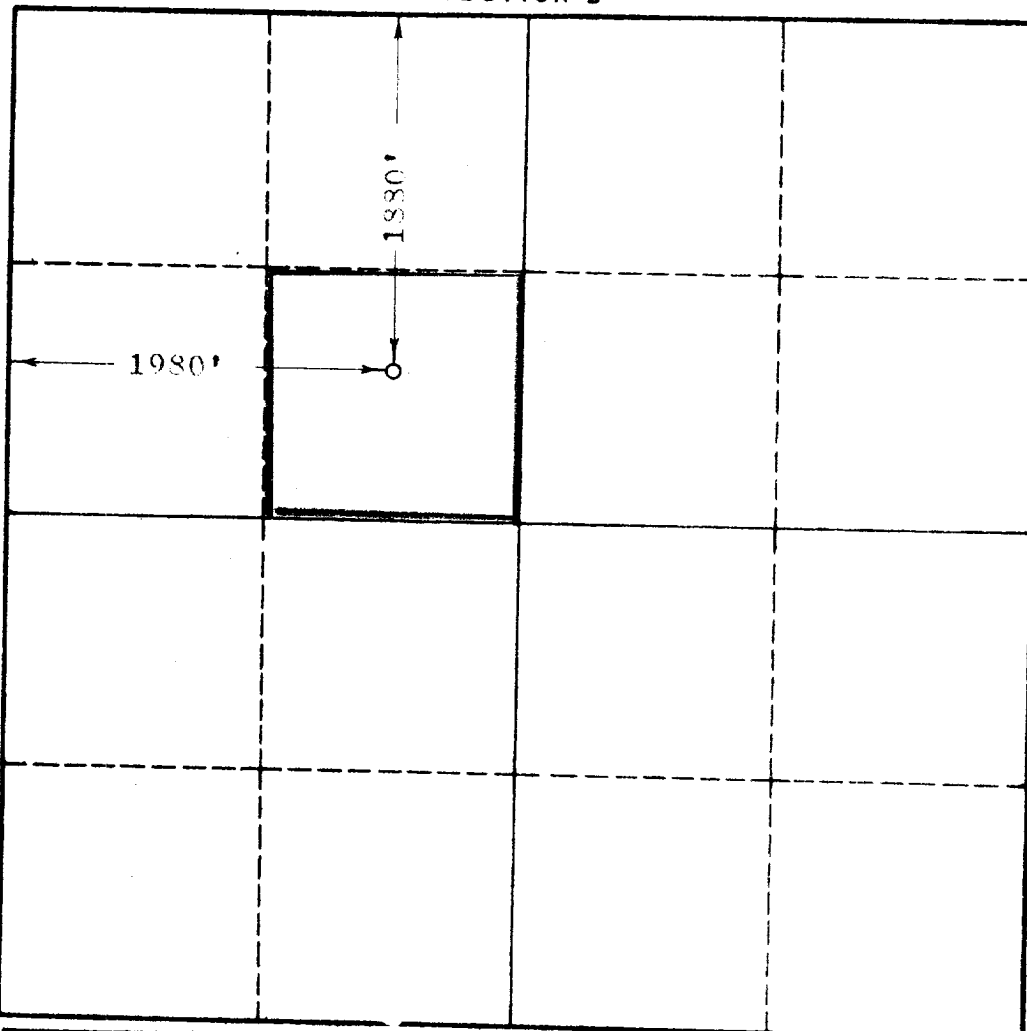

CERTIFICATION

I hereby certify that the information in SECTION A above is true and complete to the best of my knowledge and belief.

Name	J. R. Parker
Position	District Superintendent
Company	Continental Oil Company
Date	November 30, 1959

I hereby certify that the well location shown on the plat in SECTION B was plotted from field notes of actual surveys made by me or under my supervision, and that the same is true and correct to the best of my knowledge and belief.

Date Surveyed	11-30-59
Registered Professional Engineer and/or Land Surveyor	JOHN W. WEST
Certificate No.	N.M. - P.E. & L.S. NO. 876

0 330 660 990 1320 1650 1980 2310 2640 2000 1500 1000 500 0