

DUPLICATE

NEW MEXICO OIL CONSERVATION COMMISSION

Santa Fe, New Mexico

NOTICE OF INTENTION TO DRILL OR RECOMPLETION

Notice must be given to the District Office of the Oil Conservation Commission and approval obtained before drilling or recompletion begins. If changes in the proposed plan are considered advisable, a copy of this notice showing such changes will be returned to the sender. Submit this notice in **QUINTUPLICATE**. One copy will be returned following approval. See additional instructions in Rules and Regulations of the Commission.

Hobbs, New Mexico

(Place)

June 6, 1955

(Date)

OIL CONSERVATION COMMISSION
SANTA FE, NEW MEXICO

Gentlemen:

You are hereby notified that it is our intention to commence the (Drilling) (Recompletion) of a well to be known as

Continental Oil Company

(Company or Operator)

Ball Lake Unit

(Lease)

, Well No. **3**, in **G** The well is

(Unit)

located **660** feet from the **North** line and **3900** feet from the

East

line of Section **6**, T. **24S**, R. **34E**, NMPM.

(GIVE LOCATION FROM SECTION LINE) **Wildcat** Pool, **Lee** County

D	C	B	A
E	F	G	H
L	K	J	I
M	N	O	P

If State Land the Oil and Gas Lease is No.

If patented land the owner is.

Address.

We propose to drill well with drilling equipment as follows: **Rotary**

The status of plugging bond is.

Drilling Contractor **Layton and Newell Drilling Company**

We intend to complete this well in the **Bone Spring** formation at an approximate depth of **9,000** feet.

CASING PROGRAM

We propose to use the following strings of Casing and to cement them as indicated:

Size of Hole	Size of Casing	Weight per Foot	New or Second Hand	Depth	Seal Cement
17 1/4"	13 3/8"	48#	New	1,500	1250
8 1/4"	5 1/2"	17#	New	500	2,500 used to set
	5 1/2"	15.5#	New	6,200	5 1/2" casing
	5 1/2"	17#	New	9,000	

If changes in the above plans become advisable we will notify you immediately.

ADDITIONAL INFORMATION (If recompletion give full details of proposed plan of work.)

Approved....., 19.....
Except as follows:

OIL CONSERVATION COMMISSION

S. J. STANLEY

By.....

ENGINEER-DIST.

Title.....

Sincerely yours,

Continental Oil Company

(Company or Operator)

By.....

Position..... **District Superintendent**
Send Communications regarding well to

Name..... **Continental Oil Company**

Address..... **Box 427**
Hobbs, New Mexico

JUN 9 1955

NEW MEXICO OIL CONSERVATION COMMISSION
Santa Fe, New Mexico

NOTICE OF INTENTION TO DRILL OR RECOMPLETE

Notice must be given to the District Office of the Oil Conservation Commission and approval obtained before drilling or recompletion begins. If changes in the proposed plan are considered advisable, a copy of this notice showing such changes will be returned to the sender. Submit this notice in QUINTUPLICATE. One copy will be returned following approval. See additional instructions in Rules and Regulations of the Commission.

Santa Fe, New Mexico
(Place)

June 6, 1953
(Date)

OIL CONSERVATION COMMISSION
SANTA FE, NEW MEXICO

Gentlemen:

You are hereby notified that it is our intention to commence the (Drilling) (Recompletion) of a well to be known as

Continental Oil Company
(Company or Operator)

Boil Lake Unit (Lease), Well No. 3, in 0 (Unit). The well is

located 440 feet from the North line and 3300 feet from the

Boil Lake line of Section 6, T. 21S, R. 11E, NMPM.

(GIVE LOCATION FROM SECTION LINE) Boil Lake Pool, Loc County

If State Land the Oil and Gas Lease is No.

If patented land the owner is.

Address.

We propose to drill well with drilling equipment as follows: Electric

The status of plugging bond is.

Drilling Contractor Caplan and Maxwell Drilling Company

We intend to complete this well in the Boil Spring formation at an approximate depth of XXXX 9,000 feet.

CASING PROGRAM

We propose to use the following strings of Casing and to cement them as indicated:

Size of Hole	Size of Casing	Weight per Foot	New or Second Hand	Depth	Sacks Cement
<u>37 1/4"</u>	<u>37 3/8"</u>	<u>20</u>	<u>New</u>	<u>1,200</u>	<u>1250</u>
<u>1 1/4"</u>	<u>5 1/2"</u>	<u>17</u>	<u>New</u>	<u>500</u>	<u>2,200 used to set</u>
	<u>5 1/2"</u>	<u>15</u>	<u>New</u>	<u>2,200</u>	<u>5 1/2" casing</u>
	<u>5 1/2"</u>	<u>17</u>	<u>New</u>	<u>5,000</u>	

If changes in the above plans become advisable we will notify you immediately.

ADDITIONAL INFORMATION (If recompletion give full details of proposed plan of work.)

Sincerely yours,

Continental Oil Company
(Company or Operator)

By [Signature]

Position District Superintendent
Send Communications regarding well to

Name Continental Oil Company

Address Box 427
Santa Fe, New Mexico

OIL CONSERVATION COMMISSION

By _____

Title _____

WELL LOCATION SURVEY PLAT

OPERATOR CONTINENTAL OIL CO.

LEASE BELL LAKE UNIT

WELL NO. 3

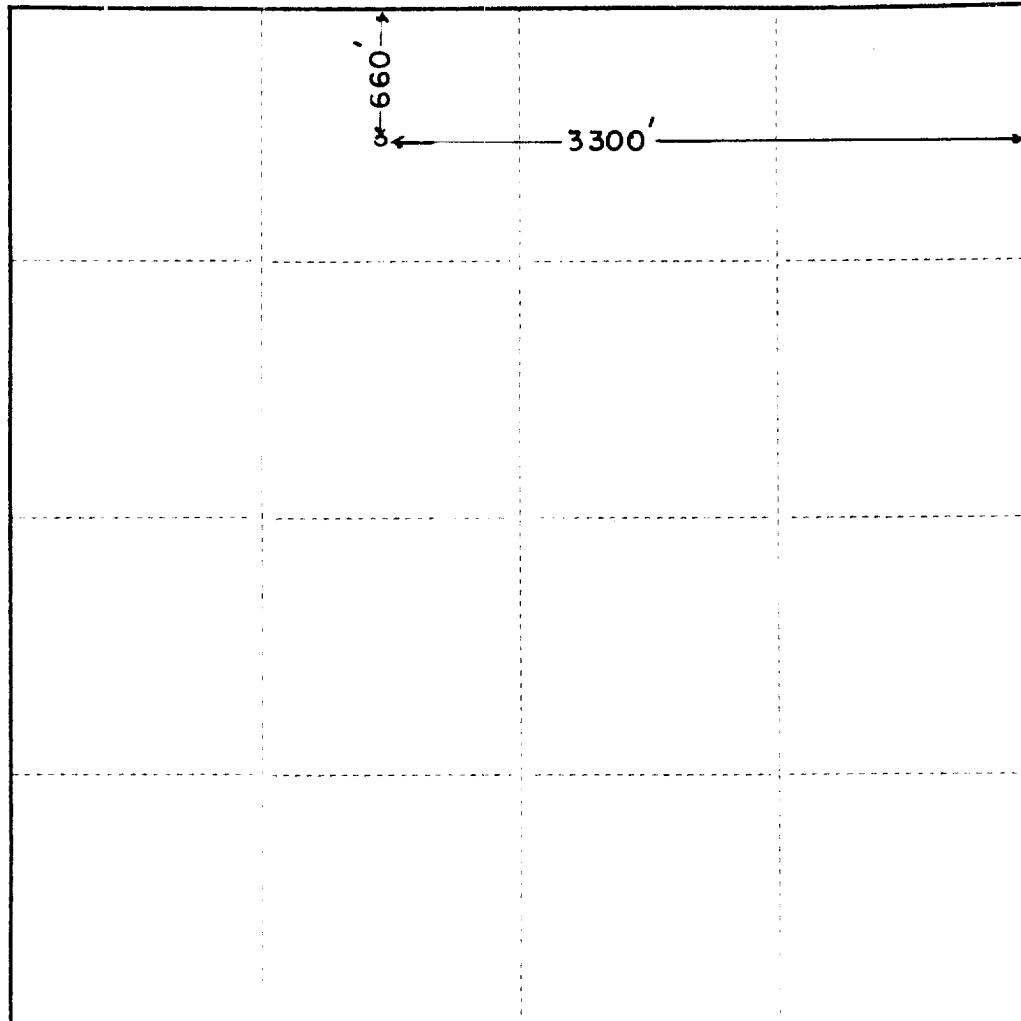

SEC. 6, TWP. 24 S., RGE. 34 E., N.M.P.M.

I HEREBY CERTIFY THAT THIS PLAT WAS MADE
FROM NOTES TAKEN IN THE FIELD BY ME AND
THAT THE SAME IS TRUE AND CORRECT TO THE
BEST OF MY KNOWLEDGE AND BELIEF.

John W West

JOHN W. WEST, FE & LS NO. 676

6-4-55