

Form 9-881a
(Feb. 1961)

(SUBMIT IN TRIPLICATE)

Land Office _____
Lease No. 10 061351
Unit _____

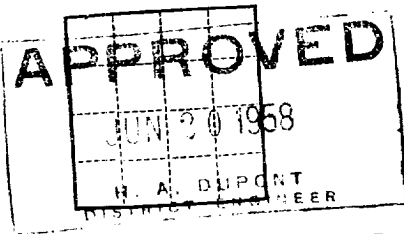

UNITED STATES
DEPARTMENT OF THE INTERIOR
GEOLOGICAL SURVEY

SUNDRY NOTICES AND REPORTS ON WELLS

NOTICE OF INTENTION TO DRILL	<input checked="" type="checkbox"/>	SUBSEQUENT REPORT OF WATER SHUT-OFF	
NOTICE OF INTENTION TO CHANGE PLANS		SUBSEQUENT REPORT OF SHOOTING OR ACIDIZING	
NOTICE OF INTENTION TO TEST WATER SHUT-OFF		SUBSEQUENT REPORT OF ALTERING CASING	
NOTICE OF INTENTION TO RE-DRILL OR REPAIR WELL		SUBSEQUENT REPORT OF RE-DRILLING OR REPAIR	
NOTICE OF INTENTION TO SHOOT OR ACIDIZE		SUBSEQUENT REPORT OF ABANDONMENT	
NOTICE OF INTENTION TO PULL OR ALTER CASING		SUPPLEMENTARY WELL HISTORY	
NOTICE OF INTENTION TO ABANDON WELL			

(INDICATE ABOVE BY CHECK MARK NATURE OF REPORT, NOTICE, OR OTHER DATA)

Well No. 1 Federal Johnson is located 660 ft. from S line and 660 ft. from W line of sec. 13
34 (1/4 Sec. and Sec. No.) 24 S (Twp.) 34 E (Range) R. 1 E. T. 1 N. (Meridian)
Wilcox (Field) Lee (County or Subdivision) New Mexico (State or Territory)

The elevation of the derrick floor above sea level is _____ ft.

DETAILS OF WORK

(State names of and expected depths to objective sands; show sizes, weights, and lengths of proposed casings; indicate mudding jobs, cementing points, and all other important proposed work)

Set 3 5/8" casing in Anhydrite and cement with 100 sacks, 45 gal. cement
preceded by Ken-Pak to cover Santa Rosa formation.

Drill out of 3 5/8" with air to Delaware Sand at approximately 5200'.

If production encountered, to run 5 1/2" on top of pay and will obtain U.S.G.S.
approval as to amount of cement to be used.

I understand that this plan of work must receive approval in writing by the Geological Survey before operations may be commenced.

Company George H. Williams
Address 207 West Avenue B
Lovington, New Mexico

By _____
Title _____

MEXICO OIL CONSERVATION COMMISSION
Well Location and Acreage Dedication Plat

Section A.

Date 6/17/1958

Operator George H. Williams Lease Federal Johnson #1
Well No. 1 Unit Letter M Section 13 Township 24S Range 34E NMPM
Located 660 Feet From South Line, 660 Feet From West Line
County Lea G. L. Elevation _____ Dedicated Acreage 40 Acres
Name of Producing Formation Wildcat Pool Wildcat

1. Is the Operator the only owner* in the dedicated acreage outlined on the plat below?
Yes _____ No No.
2. If the answer to question one is "no," have the interests of all the owners been consolidated by communitization agreement or otherwise? Yes _____ No No. If answer is "yes," Type of Consolidation _____
3. If the answer to question two is "no," list all the owners and their respective interests below:

Owner

Land Description

Section. B

R34E

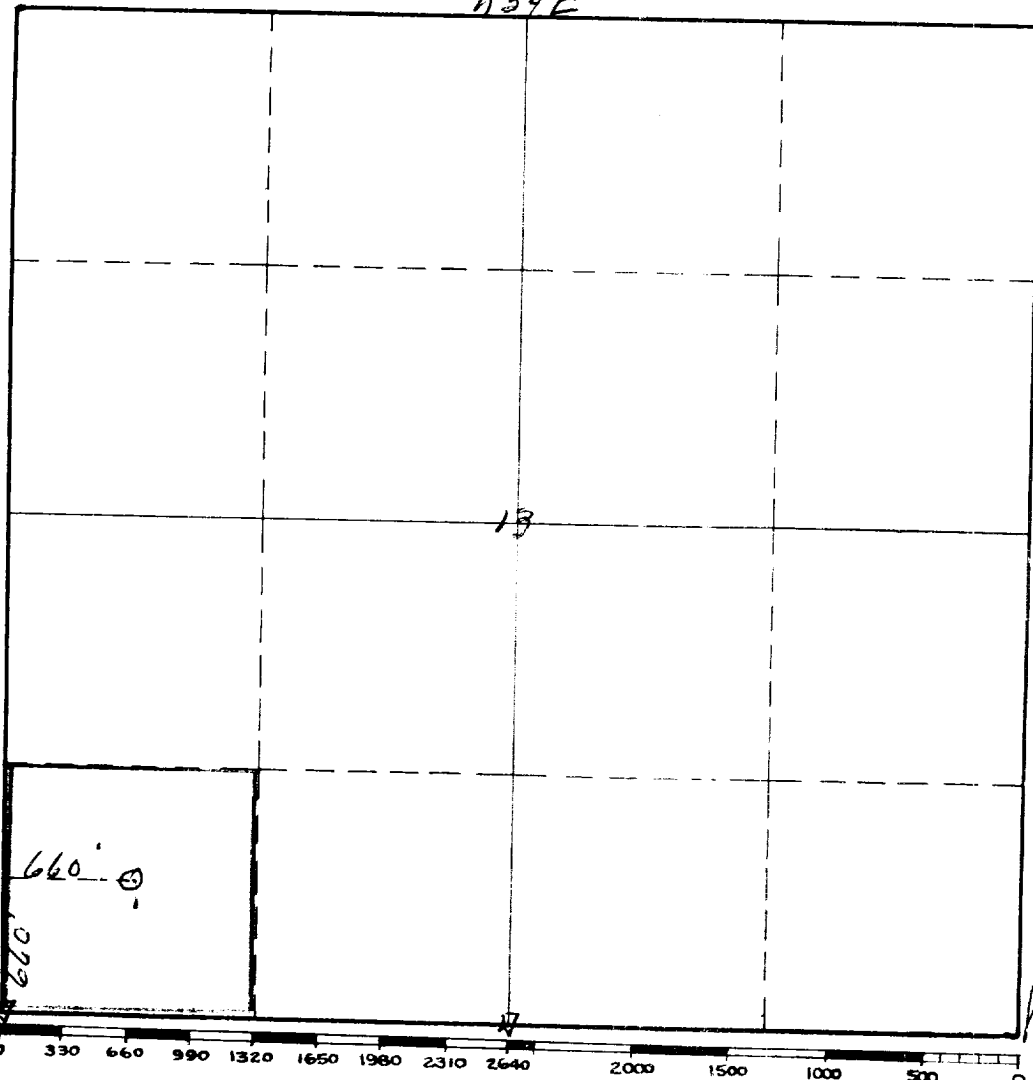

This is to certify that the information in Section A above is true and complete to the best of my knowledge and belief.

George H. Williams
(Operator)

George H. Williams
(Representative)

Lovington, New Mexico
Address

This is to certify that the well location shown on the plat in Section B was plotted from field notes of actual surveys made by me or under my supervision and that the same is true and correct to the best of my knowledge and belief.

Date Surveyed June 6th 1958

James H. Brown
Registered Professional
Engineer and/or Land Surveyor.

(See instructions for completing this form on the reverse side)

Certificate No. 542

INSTRUCTIONS FOR COMPLETION:

1. Operator shall furnish and certify to the information called for in Section A.
2. Operator shall outline the dedicated acreage for both oil and gas wells on the plat in Section B.
3. A registered professional engineer or land surveyor registered in the State of New Mexico or approved by the Commission shall show on the plat the location of the well and certify this information in the space provided.
4. All distances shown on the plat must be from the outer boundaries of Section.
5. If additional space is needed for listing owners and their respective interests as required in question 3, Section A, please use space below

* "Owner" means the person who has the right to drill into and to produce from any pool and to appropriate the production either for himself or for himself and another. (65-3-29 (e) NMSA 1953 Comp.)