

Submit to Appropriate  
District Office  
State Leases - 4 copies  
Fee Leases - 3 copies

State of New Mexico  
Energy, Minerals and Natural Resources Department

Form C-102  
Revised 1-1-85

OIL CONSERVATION DIVISION

P.O. Box 2088  
Santa Fe, New Mexico 87504-2088

DISTRICT I  
P.O. Box 1980, Hobbs, NM 88240

DISTRICT II  
P.O. Drawer DD, Artesia, NM 88210

DISTRICT III  
1000 Rio Brazos Rd., Aztec, NM 87410

WELL LOCATION AND ACREAGE DEDICATION PLAT

All Distances must be from the outer boundaries of the section

Operator ARCO OIL AND GAS COMPANY			Lease T. M. LANKFORD WN		Well No. 1
Unit Letter C	Section 25	Township T-23S	Range R-36E	County LEA	
Actual Footage Location of Well: 660 feet from the NORTH line and 1980 feet from the WEST line					
Ground level Elev. 3354'	Producing Formation TANSIL/YATES/7-RIVERS		Pool JALMAT GAS		Dedicated Acreage: 160 Acres

1. Outline the acreage dedicated to the subject well by colored pencil or lacquer marks on the plat below.
2. If more than one lease is dedicated to the well, outline each and identify the ownership thereof (both as to working interest and royalty).
3. If more than one lease of different ownership is dedicated to the well, have the interest of all owners been consolidated by communitization, unitization, force-pooling, etc.?  
☐ Yes ☐ No If answer is "yes" type of consolidation \_\_\_\_\_  
If answer is "no" list the owners and tract descriptions which have actually been consolidated. (Use reverse side of this form if necessary.)  
No allowable will be assigned to the well until all interests have been consolidated (by communitization, unitization, forced-pooling, or otherwise) or until a non-standard unit, eliminating such interest, has been approved by the Division.

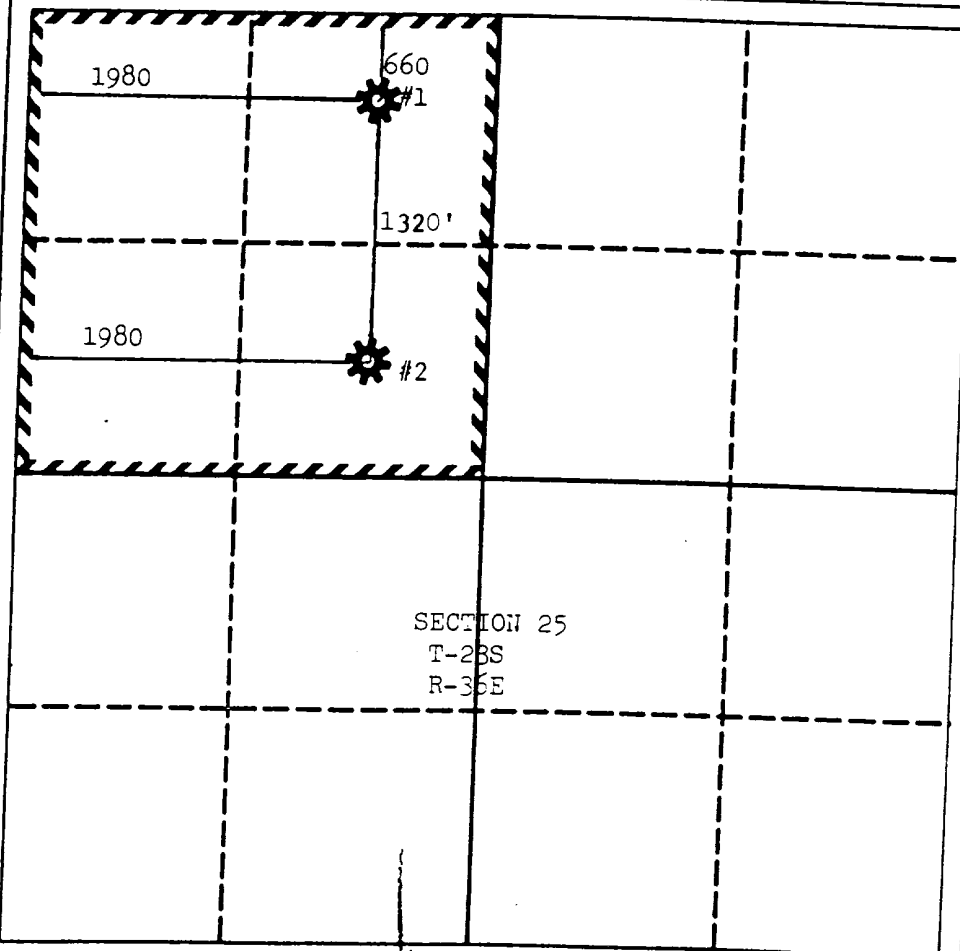

OPERATOR CERTIFICATION

I hereby certify that the information contained herein is true and complete to the best of my knowledge and belief.

Signature

*E. E. Gilson*

Printed Name

E. E. GILSON

Position

ENGINEERING TECHNICIAN

Company

ARCO OIL AND GAS COMPANY

Date

FEBRUARY 4, 1993

SURVEYOR CERTIFICATION

I hereby certify that the well location shown on this plat was plotted from field notes of actual surveys made by me or under my supervision, and that the same is true and correct to the best of my knowledge and belief.

Date Surveyed

Signature & Seal of  
Professional Surveyor

Certificate No.

### INSTRUCTIONS

1. Is this gas well a dual completion? Yes X No
2. If the answer to Question 1 is Yes, are there any other  
dually completed wells within the dedicated acreage?  
Yes                      No X

A separate plat must be filed for each gas well, outlining the area dedicated to such well and showing the location of all other wells (oil and gas) within the outlined area.

Mail in duplicate to the district office for the district in which the well is located.

NEW MEXICO  
OIL CONSERVATION COMMISSION

Gas Well Plat

Date May 26, 1955

Western Natural Gas Company

Bankford

Operator

Lease

Well No. 1

Name of Producing Formation Yates

Pool Jalnet

No. Acres Dedicated to the Well 160

SECTION 25 TOWNSHIP 23 RANGE 36

	660' FNL 1980' FEL 		

I hereby certify that the information given above is true and complete to the best of my knowledge.

Name R. H. McKey  
 Position Division Superintendent  
 Representing Western Natural Gas Company  
 Address 623 Main and Tower, Lubbock, Texas

(over)

### INSTRUCTIONS

1. Is this gas well a dual completion? Yes X No
2. If the answer to Question 1 is Yes, are there any other  
dually completed wells within the dedicated acreage?  
Yes                      No X

A separate plat must be filed for each gas well, outlining the area dedicated to such well and showing the location of all other wells (oil and gas) within the outlined area.

Mail in duplicate to the district office for the district in which the well is located.

NEW MEXICO  
OIL CONSERVATION COMMISSION

Gas Well Plat

Date November 27, 1953

Western Natural Gas Co.      Lankford      1-Casing  
Operator      Lease      Well No.

Name of Producing Formation      Yates      Pool      Langmat

No. Acres Dedicated to the Well      120

SECTION 25      TOWNSHIP 23S      RANGE 36E

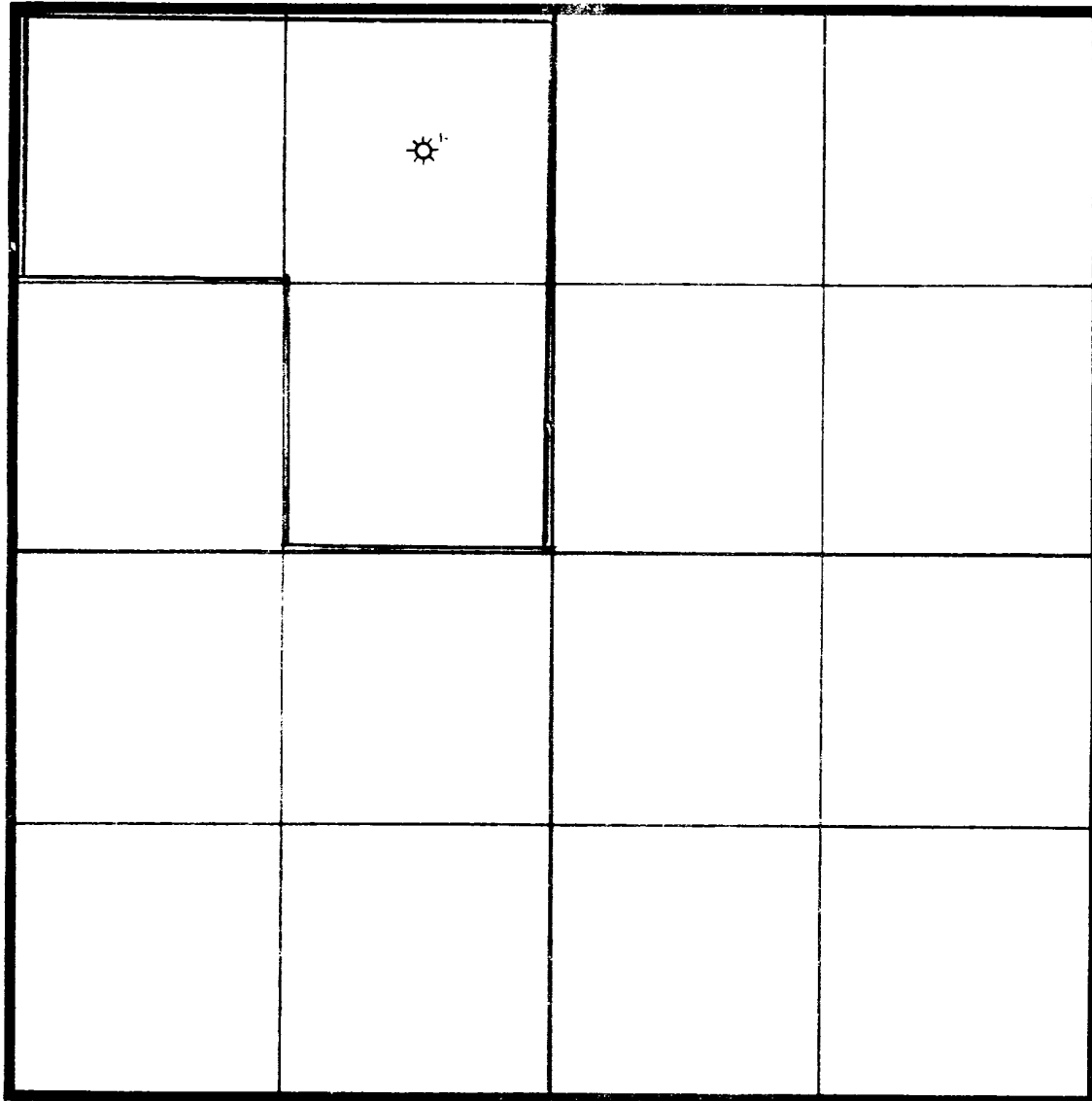

I hereby certify that the information given above is true and complete to the best of my knowledge.

Name H. H. Roy  
Position Division Superintendent  
Representing Western Natural Gas Company  
Address 823 Midland Tower, Midland, Texas

(over)

### INSTRUCTIONS

1. Is this gas well a dual completion? Yes x No
2. If the answer to Question 1 is Yes, are there any other dually completed wells within the dedicated acreage? Yes      No x

A separate plat must be filed for each gas well, outlining the area dedicated to such well and showing the location of all other wells (oil and gas) within the outlined area.

Mail in duplicate to the district office for the district in which the well is located.

