

NEW MEXICO OIL CONSERVATION COMMISSION  
WELL LOCATION AND ACREAGE DEDICATION PLAT

Form C-102  
Supersedes C-1  
Effective 1-1-65

All distances must be from the outer boundaries of the Section.

Operator <i>Continental Oil</i>		Lease <i>Lynn B. J.</i>		Well No. <i>1</i>
Unit Letter <i>T</i>	Section <i>23</i>	Township <i>23S</i>	Range <i>36E</i>	County <i>Lea</i>
Actual Footage Location of Well: <i>2725</i> feet from the <i>W. H.</i> line <i>2316</i> feet from the <i>East</i> line				
Ground Level Elev. <i>3390</i>	Producing Formation <i>Tarrant</i>	Pool <i>NATES</i>	Dedicated Acreage: <i>646.5</i> Acres	

1. Outline the acreage dedicated to the subject well by colored pencil or hachure marks on the plat below.
2. If more than one lease is dedicated to the well, outline each and identify the ownership thereof (both as to working interest and royalty).
3. If more than one lease of different ownership is dedicated to the well, have the interests of all owners been consolidated by communitization, unitization, force-pooling, etc?

☐ Yes ☐ No If answer is "yes," type of consolidation \_\_\_\_\_

If answer is "no," list the owners and tract descriptions which have actually been consolidated. (Use reverse side of this form if necessary.) \_\_\_\_\_

No allowable will be assigned to the well until all interests have been consolidated (by communitization, unitization, forced-pooling, or otherwise) or until a non-standard unit, eliminating such interests, has been approved by the Commission.

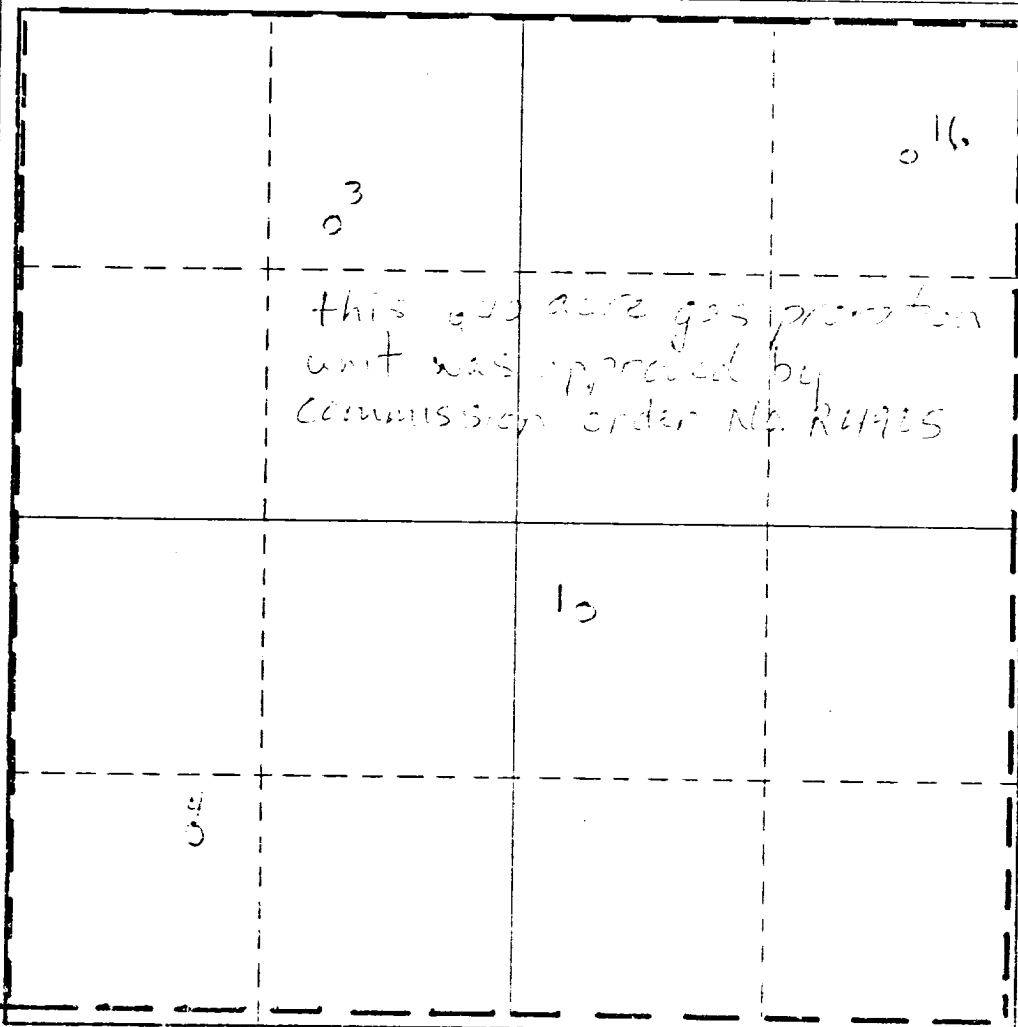

CERTIFICATION

I hereby certify that the information contained herein is true and complete to the best of my knowledge and belief.

Name  
*W. H. J. J.*  
Position  
*Staff Surveyor*  
Company  
*Continental Oil*  
Date  
*11-11-74*

I hereby certify that the well location shown on this plat was plotted from field notes of actual surveys made by me or under my supervision, and that the same is true and correct to the best of my knowledge and belief.

Date Surveyed \_\_\_\_\_  
Registered Professional Engineer and/or Land Surveyor \_\_\_\_\_

Certificate No. \_\_\_\_\_

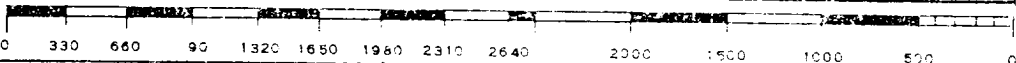

NEW MEXICO OIL CONSERVATION COMMISSION  
WELL LOCATION AND ACREAGE DEDICATION PLAT

Form C-102  
Supersedes C-128  
Effective 1-1-55

All distances must be from the outer boundaries of the Section.

R-3492

Operator <b>Continental Oil Company</b>			Lease <b>Lynn B-1</b>		Well No. <b>1</b>
Unit Letter <b>J</b>	Section <b>26</b>	Township <b>23</b>	Range <b>36</b>	County <b>Lea</b>	
Actual Footage Location of Well: <b>2310</b> feet from the <b>South</b> line and <b>2310</b> feet from the <b>East</b> line					
Ground Level Elev: <b>3390</b>	Producing Formation <b>Jalmat Yates</b>	Pool <b>Jalmat Gas Pool</b>		Dedicated Acreage: <b>640</b> Acres	

1. Outline the acreage dedicated to the subject well by colored pencil or hachure marks on the plat below.
2. If more than one lease is dedicated to the well, outline each and identify the ownership thereof (both as to working interest and royalty).
3. If more than one lease of different ownership is dedicated to the well, have the interests of all owners been consolidated by communitization, unitization, force-pooling, etc?

☐ Yes   ☐ No   If answer is "yes," type of consolidation \_\_\_\_\_

If answer is "no," list the owners and tract descriptions which have actually been consolidated. (Use reverse side of this form if necessary.) \_\_\_\_\_

No allowable will be assigned to the well until all interests have been consolidated (by communitization, unitization, forced-pooling, or otherwise) or until a non-standard unit, eliminating such interests, has been approved by the Commission.

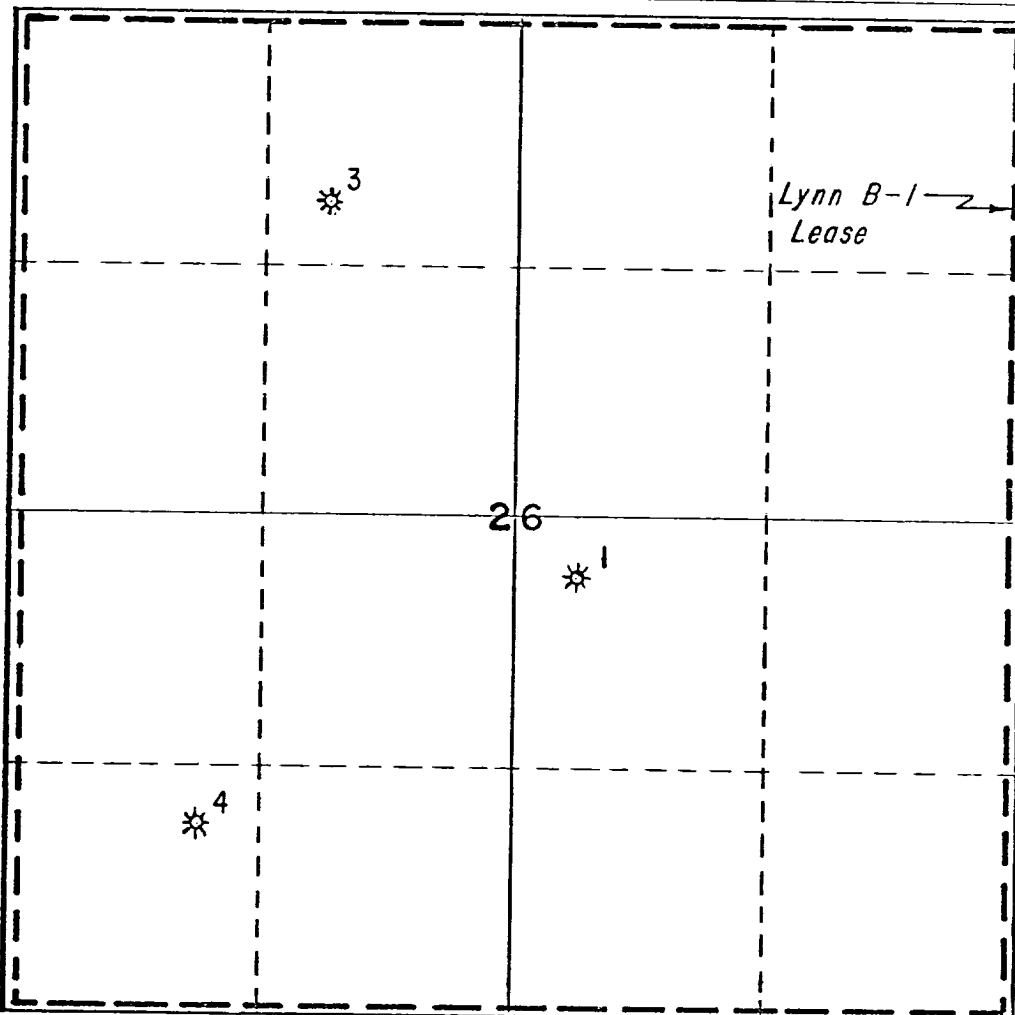

**CERTIFICATION**

I hereby certify that the information contained herein is true and complete to the best of my knowledge and belief.

*[Signature]*  
Name \_\_\_\_\_

Adm. Section Chief

Position

Continental Oil Co.

Company

9-20-68

Date

I hereby certify that the well location shown on this plat was plotted from field notes of actual surveys made by me or under my supervision, and that the same is true and correct to the best of my knowledge and belief.

Date Surveyed \_\_\_\_\_

Registered Professional Engineer and/or Land Surveyor

Certificate No. \_\_\_\_\_

0 330 660 990 1320 1650 1980 2310 2640 2000 1500 1000 500 0

**NEW MEXICO OIL CONSERVATION COMMISSION  
WELL LOCATION AND ACREAGE DEDICATION PLAT**

Form C-102  
Supersedes C-128  
Effective 1-1-65

All distances must be from the outer boundaries of the Section.

Operator <b>Continental Oil Company</b>			Lease <b>Lynn B-1</b>		Well No. <b>1</b>
Unit Letter <b>J</b>	Section <b>26</b>	Township <b>23S</b>	Range <b>36E</b>	County <b>Lea</b>	
Actual Footage Location of Well: <b>2310</b> feet from the <b>South</b> line and <b>2310</b> feet from the <b>East</b> line					
Ground Level Elev. <b>3390</b>	Producing Formation <b>Seven Rivers</b>		Pool <b>Jalmat Gas Pool</b>		Dedicated Acreage: <b>320</b> Acres

1. Outline the acreage dedicated to the subject well by colored pencil or hachure marks on the plat below.
2. If more than one lease is dedicated to the well, outline each and identify the ownership thereof (both as to working interest and royalty).
3. If more than one lease of different ownership is dedicated to the well, have the interests of all owners been consolidated by communitization, unitization, force-pooling, etc?

Not Applicable

☒ Yes   ☐ No   If answer is "yes," type of consolidation \_\_\_\_\_

If answer is "no," list the owners and tract descriptions which have actually been consolidated. (Use reverse side of this form if necessary.) \_\_\_\_\_

No allowable will be assigned to the well until all interests have been consolidated (by communitization, unitization, forced-pooling, or otherwise) or until a non-standard unit, eliminating such interests, has been approved by the Commission.

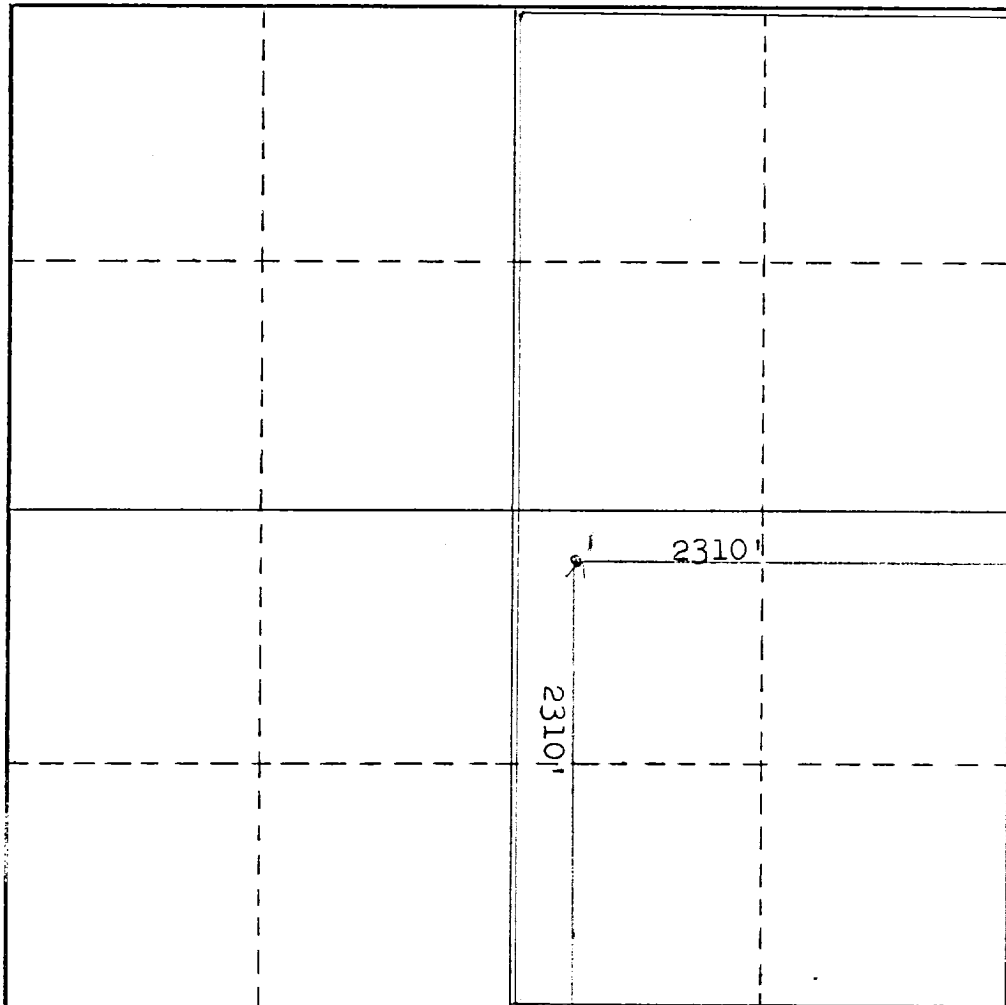

**CERTIFICATION**

*I hereby certify that the information contained herein is true and complete to the best of my knowledge and belief.*

Name  
**SHIRLEY M. R. STEPHENS**

Position  
**Staff Supervisor**

Company  
**Continental Oil Company**

Date  
**September 22, 1965**

**NMOCC-3, File**

*I hereby certify that the well location shown on this plat was plotted from field notes of actual surveys made by me or under my supervision, and that the same is true and correct to the best of my knowledge and belief.*

Date Surveyed

Registered Professional Engineer  
and/or Land Surveyor

Certificate No.

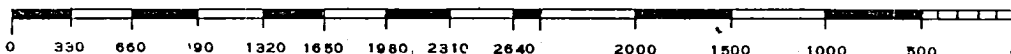

NEW MEXICO OIL CONSERVATION COMMISSION  
WELL LOCATION AND ACREAGE DEDICATION PLAT

FORM C-128  
Revised 5/1/57

SEE INSTRUCTIONS FOR COMPLETING THIS FORM ON THE REVERSE SIDE

SECTION A

Operator <b>Continental Oil Company</b>		Lease <b>Lynn B-26</b>		Well No. <b>1</b>
Unit Letter <b>J</b>	Section <b>26</b>	Township <b>23-S</b>	Range <b>36-E</b>	County <b>Lea</b>
Actual Footage Location of Well: <b>2310</b> feet from the <b>South</b> line and <b>2310</b> feet from the <b>East</b> line				
Ground Level Elev. <b>3379 GL</b>	Producing Formation <b>Seven Rivers</b>		Pool <b>Jalmat</b>	Dedicated Acreage: <b>320</b> Acres

1. Is the Operator the only owner in the dedicated acreage outlined on the plat below? YES ☒ NO ☐ . ("Owner" means the person who has the right to drill into and to produce from any pool and to appropriate the production either for himself or for himself and another. (65-3-29 (e) NMSA 1935 Comp.)
2. If the answer to question one is "no," have the interests of all the owners been consolidated by communitization agreement or otherwise? YES ☐ NO ☐ . If answer is "yes," Type of Consolidation \_\_\_\_\_
3. If the answer to question two is "no," list all the owners and their respective interests below:

Owner	Land Description

SECTION B

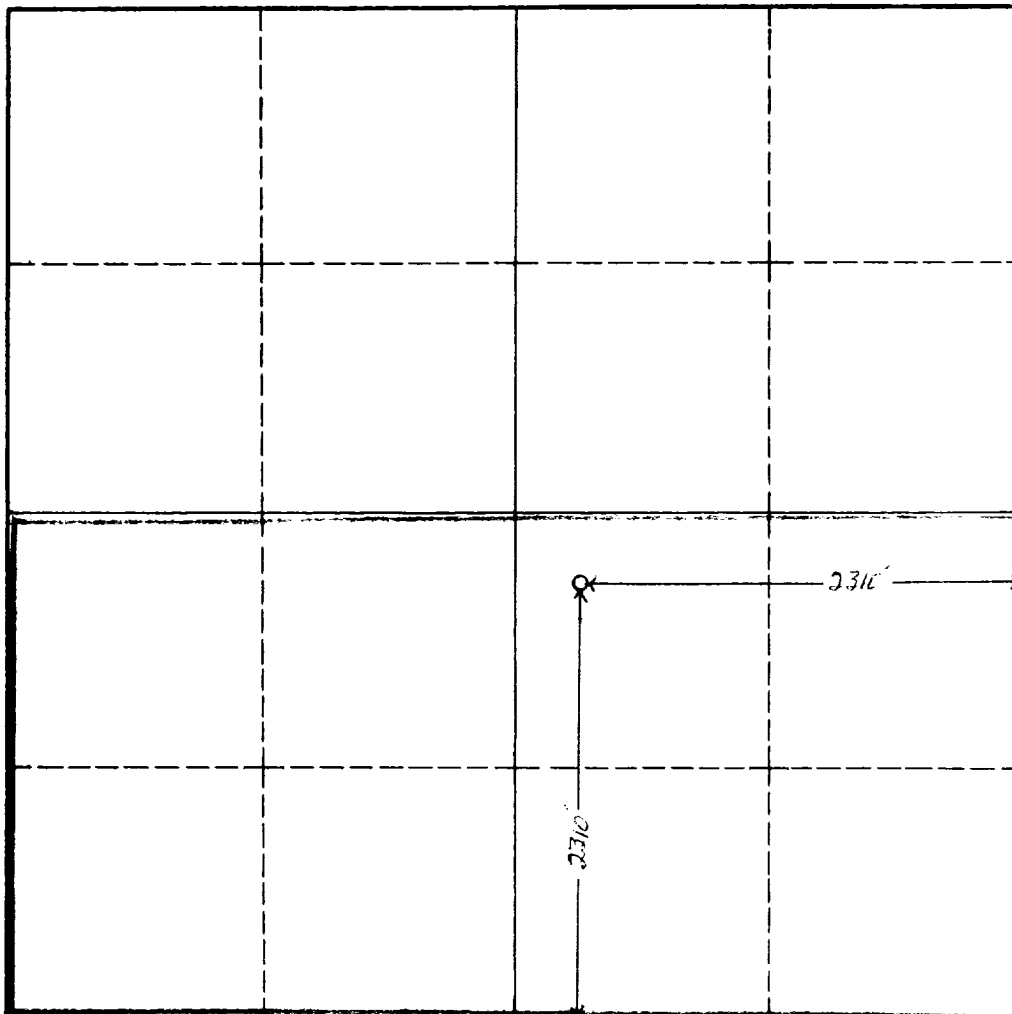

CERTIFICATION

I hereby certify that the information in SECTION A above is true and complete to the best of my knowledge and belief.

Name  
**J. K. Parker**  
Position  
**District Superintendent**  
Company  
**Continental Oil Company**  
Date  
**May 19, 1960**

I hereby certify that the well location shown on the plat in SECTION B was plotted from field notes of actual surveys made by me or under my supervision, and that the same is true and correct to the best of my knowledge and belief.

Date Surveyed  
**Unknown**  
Registered Professional Engineer  
and/or Land Surveyor

Certificate No.

### **INSTRUCTIONS FOR COMPLETION OF FORM C-128**

1. Operator shall furnish and certify to the information called for in Section A.
2. Operator shall outline the dedicated acreage for *both* oil and gas wells on the plat in Section B.
3. A registered professional engineer or land surveyor registered in the State of New Mexico or approved by the Commission shall show on the plat the location of the well and certify this information in the space provided.
4. All distances shown on the plat must be from the outer boundaries of the Section.
5. If additional space is needed for listing owners and their respective interests as required in question 3 of Section A, please use space below.

NEW MEXICO OIL CONSERVATION COMMISSION

Well Location and Acreage Dedication Plat

Section A.

Date June 6, 1958

Operator Continental Oil Company Lease Lynn B-26  
Well No. 1 Unit Letter J Section 26 Township 23 Range 36 NMPM  
Located 2310 Feet From South Line, 2310 Feet From East Line  
County Lea G. L. Elevation 3390' DF Dedicated Acreage 640 Acres  
Name of Producing Formation Yates-Seven Rivers Pool Jalmat

1. Is the Operator the only owner\* in the dedicated acreage outlined on the plat below?  
Yes X No       .
2. If the answer to question one is "no," have the interests of all the owners been consolidated by communitization agreement or otherwise? Yes        No       . If answer is "yes," Type of Consolidation
3. If the answer to question two is "no," list all the owners and their respective interests below:

Owner

Land Description

Section B

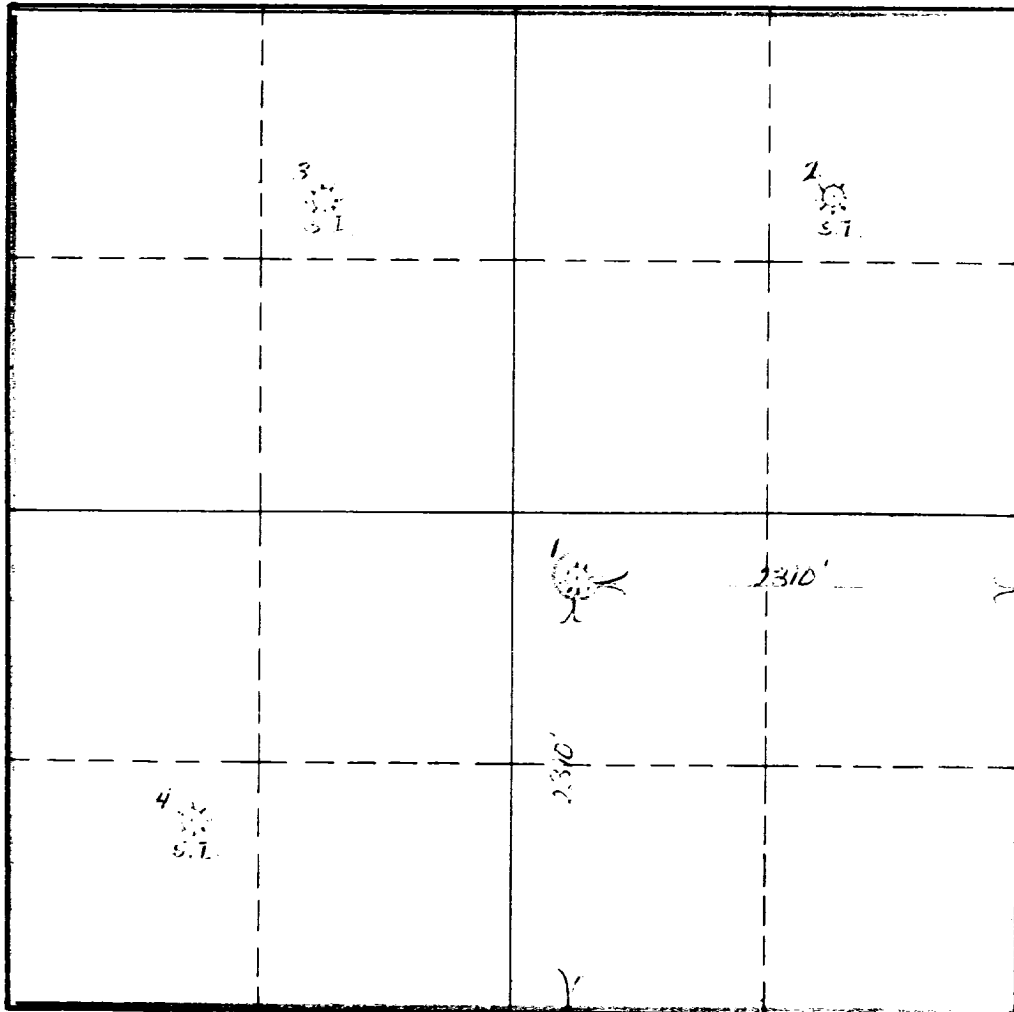

This is to certify that the information in Section A above is true and complete to the best of my knowledge and belief.

Continental Oil Company  
(Operator)

        
(Representative)

Box 68, Eunice, New Mexico  
Address

This is to certify that the well location shown on the plat in Section B was plotted from field notes of actual surveys made by me or under my supervision and that the same is true and correct to the best of my knowledge and belief.

Date Surveyed 1928

Unknown  
Registered Professional  
Engineer and/or Land Surveyor.

Certificate No.

INSTRUCTIONS FOR COMPLETION:

1. Operator shall furnish and certify to the information called for in Section A.
2. Operator shall outline the dedicated acreage for both oil and gas wells on the plat in Section B.
3. A registered professional engineer or land surveyor registered in the State of New Mexico or approved by the Commission shall show on the plat the location of the well and certify this information in the space provided.
4. All distances shown on the plat must be from the outer boundaries of Section.
5. If additional space is needed for listing owners and their respective interests as required in question 3, Section A, please use space below

\* "Owner" means the person who has the right to drill into and to produce from any pool and to appropriate the production either for himself or for himself and another. (65-3-29 (e) NMSA 1953 Comp.)

NEW MEXICO  
OIL CONSERVATION COMMISSION

Gas Well

RECEIVED

Date 11/4/53 DEC 17 1953

Continental Oil Co.  
Operator

Lynn B-26  
Lease

OIL CONSERVATION COMMISSION  
Well No. HOBBS OFFICE

Name of Producing Formation Yates & 7-Rivers Pool Langmat

No. Acres Dedicated to the Well 160

SECTION 26 TOWNSHIP 23 RANGE 36

		1 ⊗	

I hereby certify that the information given above is true and complete to the best of my knowledge.

Name Calvin Wilson  
Position Dist. Supt.  
Representing Continental Oil Co.  
Address Box 427, Hobbs, N. M.

(over)



### INSTRUCTIONS

1. Is this gas well a dual completion?    Yes                      No
2. If the answer to Question 1 is Yes, are there any  
other dually completed wells within the dedicated  
acreage?                      Yes                      No

A separate plat must be filed for each gas well, outlining the area dedicated to such well and showing the location of all other wells (oil and gas) within the outlined area.

Mail in duplicate to the district office for the district in which the well is located.