

OIL CONSERVATION DIVISION

STATE OF NEW MEXICO
ENERGY AND MINES DEPARTMENT

P. O. BOX 2088

SANTA FE, NEW MEXICO 87501

Form C-102
Revised 10-1-78

All distances must be from the outer boundaries of the Section.

Operator ARCO Oil and Gas Company Division of Atlantic Richfield Company			Lease B. Davis		Well No. 2
Unit Letter N	Section 34	Township 23S	Range 36E	County Lea	
Actual Footage Location of Well: 330 feet from the South line and 2310 feet from the West line					
Ground Level Elev. 3392' GL	Producing Formation Tansill Yates 7Rivers		Pool Jalmat Gas		Dedicated Acreage: 80 Acres

1. Outline the acreage dedicated to the subject well by colored pencil or hatchure marks on the plat below.
2. If more than one lease is dedicated to the well, outline each and identify the ownership thereof (both as to working interest and royalty).
3. If more than one lease of different ownership is dedicated to the well, have the interests of all owners been consolidated by communitization, unitization, force-pooling, etc?

☐ Yes ☐ No If answer is "yes," type of consolidation _____

If answer is "no," list the owners and tract descriptions which have actually been consolidated. (Use reverse side of this form if necessary.) _____

No allowable will be assigned to the well until all interests have been consolidated (by communitization, unitization, forced-pooling, or otherwise) or until a non-standard unit, eliminating such interests, has been approved by the Division.

CERTIFICATION

I hereby certify that the information contained herein is true and complete to the best of my knowledge and belief.

Name
David L. Shackelford
Position
Engrg. Tech. Spec.
Company ARCO Oil and Gas Co.
Div of Atlantic Richfield Co
Date
9/17/84

I hereby certify that the well location shown on this plat was plotted from field notes of actual surveys made by me or under my supervision, and that the same is true and correct to the best of my knowledge and belief.

Date Surveyed

Registered Professional Engineer
and/or Land Surveyor

Certificate No.

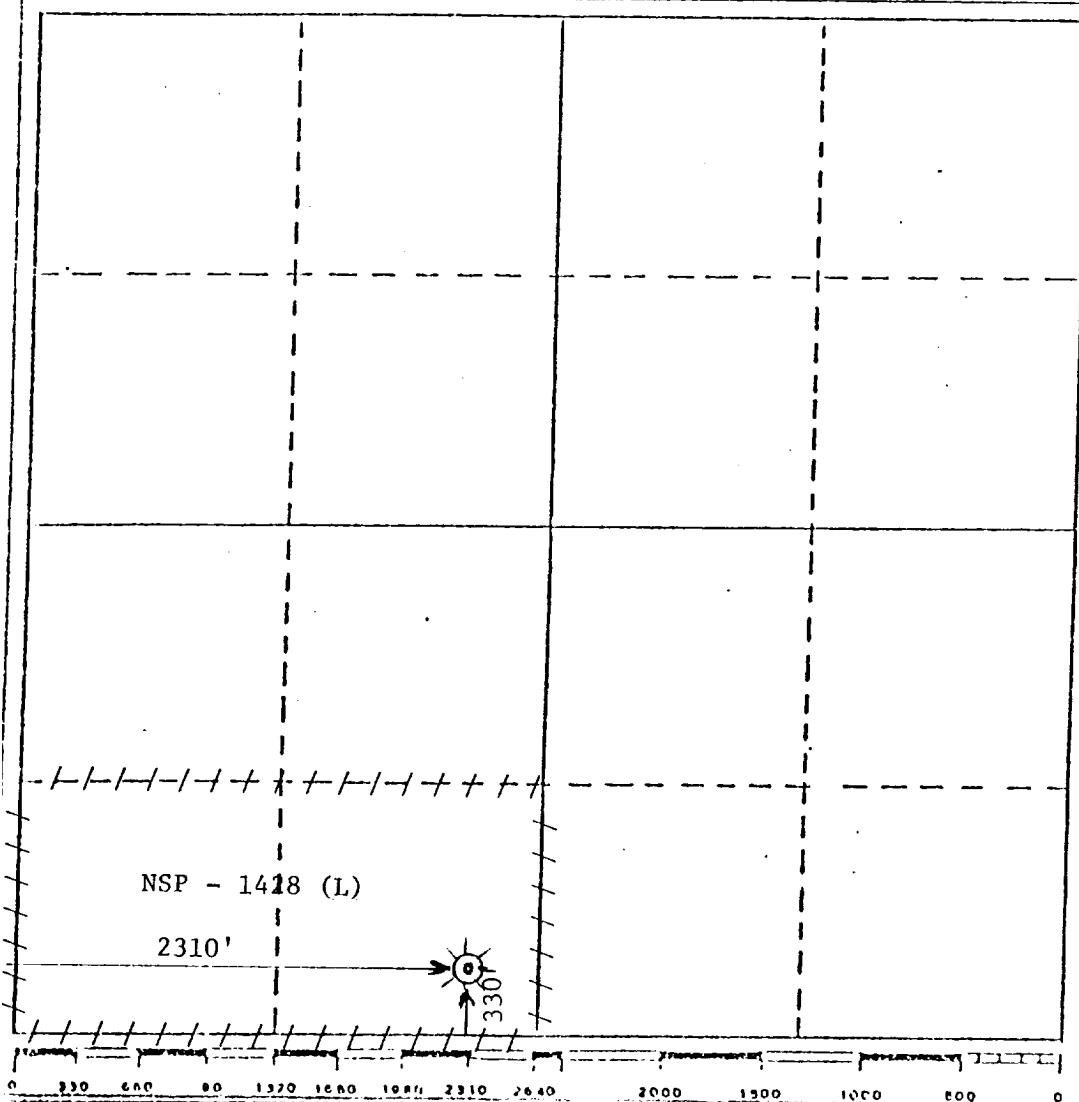

OWWO

COUNTY LEA FIELD Langlie Mattix STATENM MN 09463
 OPR ATLANTIC RICHFIELD CO. MAP
2 Davis, B.
Sec 34, T-23-S, R-36-E CO-ORD
330' FSL, 2310' FWL of Sec

Re-Cmp 3-20-72	CLASS		EL	
	FORMATION	DATUM	FORMATION	DATUM
CSG & SX - TUBING				
10 3/4" at 279' w/200 sx				
7" at 1368' w/225 sx				
5" at 3532' w/255 sx				
LOGS EL GR RA IND HC A				

TD 3607'; PBD 3520'

(Queen) Perfs 3486-3500' NO NEW POTENTIAL

Distribution limited and publication prohibited by subscribers' agreement.
 Reproduction rights reserved by Williams & Lee Scouting Service, Inc.

CONT. _____ PROP DEPTH 3500' TYPE WO
 DATE _____

F.R.C. 4-8-72; Opr's Elev. 3392' DF
 PD 3500' WO (Queen)
 (Orig. Republic Production Co., comm 12-16-40
 from OH 3532-3607', OTD 3607')
 4-4-72 TD 3607'; PBD 3520'; COMPLETE
 BP @ 3520'
 Perf @ 3486', 3490', 3496', 3498', 3500' w/1 SPI
 Acid (3486-3500') 420 gals
 Ppd 30 BO + 1068 BW in 24 hrs (3486-3500')
 4-8-72 COMPLETION REPORTED