

NEW MEXICO OIL CONSERVATION COMMISSION

Well Location and Acreage Dedication Plat

Section A.

Operator CLARA T. SCOTT AND FIRST NATIONAL BANK
IN DALLAS, TRUSTEE, CYNTHIA PAUL P. SCOTT Lease Vaughn B-3 Date 1957 DEC 9
Well No. 1 Unit Letter F Section 3 Township 24S Range 9N NMPM
Located 1980 Feet From North Line, 1980 Feet From West Line
County Lea G. L. Elevation 2405 Dedicated Acreage 320 Acres
Name of Producing Formation Tates Pool Jalnet

1. Is the Operator the only owner* in the dedicated acreage outlined on the plat below?
Yes X No X. (See note on back)
2. If the answer to question one is "no," have the interests of all the owners been consolidated by communitization agreement or otherwise? Yes No . If answer is "yes," Type of Consolidation
3. If the answer to question two is "no," list all the owners and their respective interests below:

Owner

Land Description

Section B

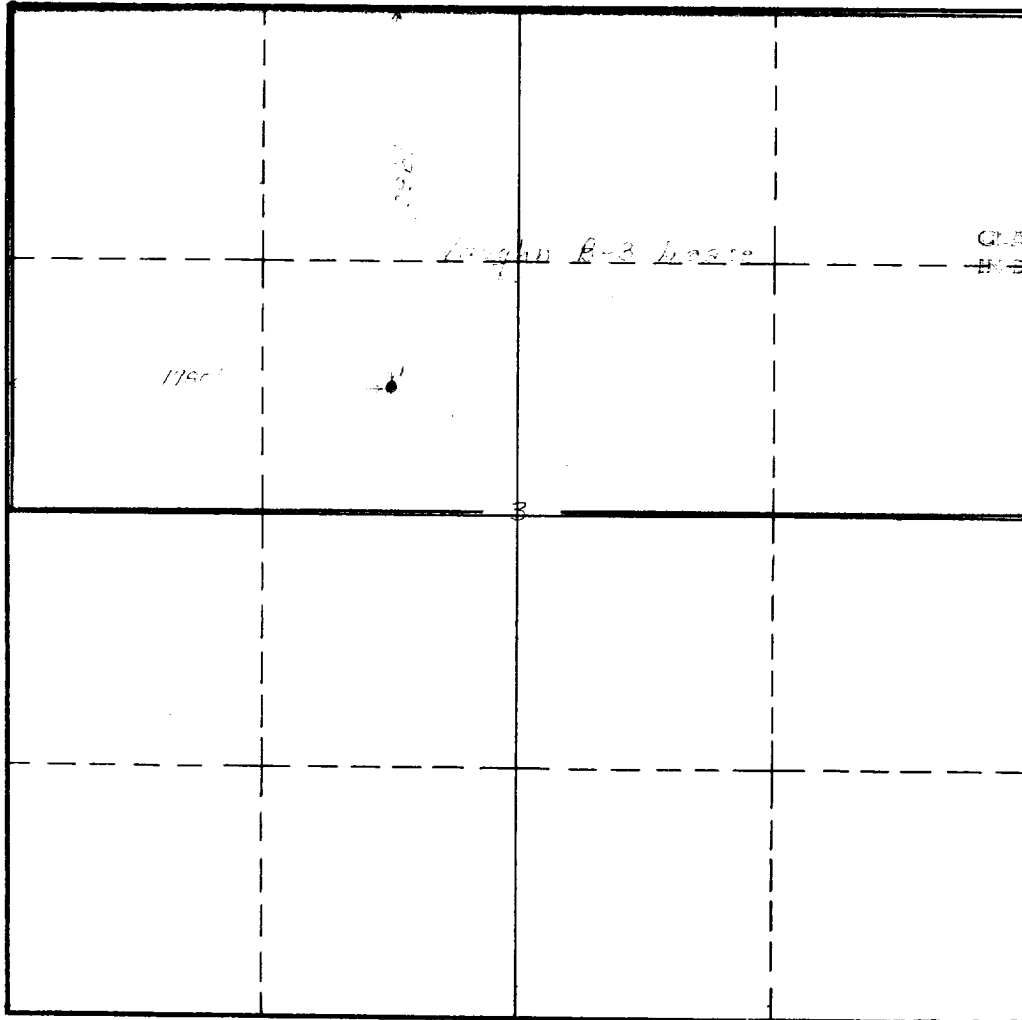

This is to certify that the information in Section A above is true and complete to the best of my knowledge and belief.

CLARA T. SCOTT AND FIRST NATIONAL BANK
IN DALLAS, TRUSTEE, CYNTHIA PAUL P. SCOTT

(Operator)

Robert B. Ray Robert B. Ray
(Representative)

Trust Dept.
First National Bank in Dallas
P. O. Box 6031
Dallas 22, Texas

This is to certify that the well location shown on the plat in Section B was plotted from field notes of actual surveys made by me or under my supervision and that the same is true and correct to the best of my knowledge and belief.

Date Surveyed XX See back

of page,

Registered Professional
Engineer and/or Land Surveyor.

Certificate No.
(See instructions for completing this form on the reverse side)

INSTRUCTIONS FOR COMPLETION:

1. Operator shall furnish and certify to the information called for in Section A.
2. Operator shall outline the dedicated acreage for both oil and gas wells on the plat in Section B.
3. A registered professional engineer or land surveyor registered in the State of New Mexico or approved by the Commission shall show on the plat the location of the well and certify this information in the space provided.
4. All distances shown on the plat must be from the outer boundaries of Section.
5. If additional space is needed for listing owners and their respective interests as required in question 3, Section A, please use space below

* The working Interest in this lease is owned 1/2 by Mrs. Clara T. Scott and 1/2 by the Paul P. Scott Trust. The First National Bank in Dallas is Trustee for the Paul P. Scott Trust, ~~and the agent for Mrs. Clara T. Scott.~~

The subject 320 acres was obtained from the New Mexico Federal Unit by a farmout agreement in which all oil and gas rights to 5,000 feet were obtained.

** This is an amended form that shows a change in status for an old well.

* "Owner" means the person who has the right to drill into and to produce from any pool and to appropriate the production either for himself or for himself and another. (65-3-29 (e) NMSA 1953 Comp.)