

**NEW MEXICO OIL CONSERVATION COMMISSION
WELL LOCATION AND ACREAGE DEDICATION PLAT**

Form C-102
Supersedes C-128
Effective 1-1-65

All distances must be from the outer boundaries of the Section.

Operator Atlantic Richfield Company			Lessee G. W. Toby WN Gas Unit		Well No. 1
Unit Letter P	Section 12	Township 24S	Range 36E	County Lea	
Actual Footage Location of Well:					
660 feet from the South line and		660 feet from the East line			
Ground Level Elev. 3322'	Producing Formation Yates & Seven Rivers		Pool Jalmat Gas		Dedicated Acreage: 320 Acres

1. Outline the acreage dedicated to the subject well by colored pencil or hachure marks on the plat below.
2. If more than one lease is dedicated to the well, outline each and identify the ownership thereof (both as to working interest and royalty).
3. If more than one lease of different ownership is dedicated to the well, have the interests of all owners been consolidated by communitization, unitization, force-pooling, etc?

Pooled by Lease Amendment as to

☒ Yes ☐ No If answer is "yes," type of consolidation Jalmat Gas only.

If answer is "no," list the owners and tract descriptions which have actually been consolidated. (Use reverse side of this form if necessary.) _____

No allowable will be assigned to the well until all interests have been consolidated (by communitization, unitization, forced-pooling, or otherwise) or until a non-standard unit, eliminating such interests, has been approved by the Commission.

R-36E

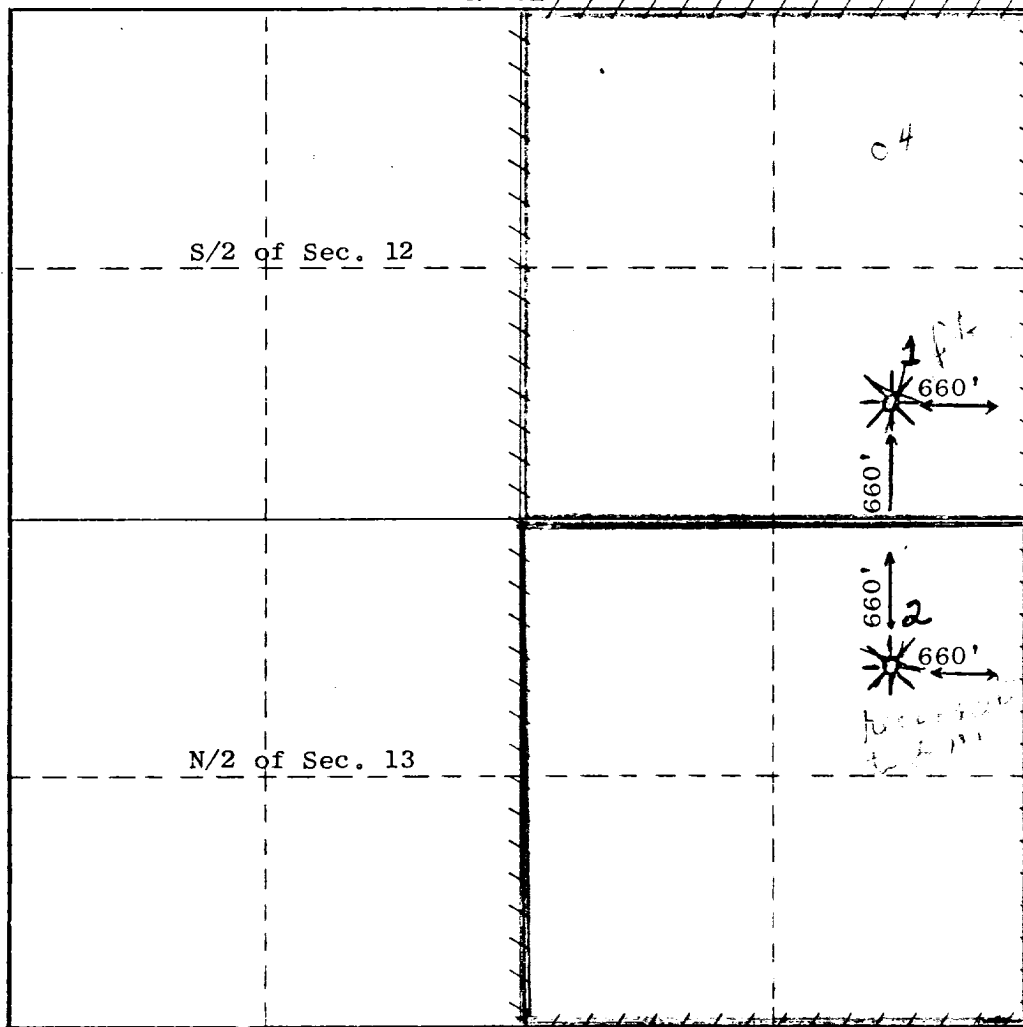

CERTIFICATION

I hereby certify that the information contained herein is true and complete to the best of my knowledge and belief.

Name: Arthur Shackelford
Position: Accountant I

Company: Atlantic Richfield Company

Date: 4/4/75

I hereby certify that the well location shown on this plat was plotted from field notes of actual surveys made by me or under my supervision, and that the same is true and correct to the best of my knowledge and belief.

Date Surveyed: _____

Registered Geologist, Engineer and/or Land Surveyor

Certificate No. _____

0 330 660 990 1320 1650 1980 2310 2640 2000 1500 1000 500 0

NEW MEXICO
OIL CONSERVATION COMMISSION

Gas Well Plat

Date November 27, 1953

Western Natural Gas Co. Toby 1-Casing
Operator Lease Well No.

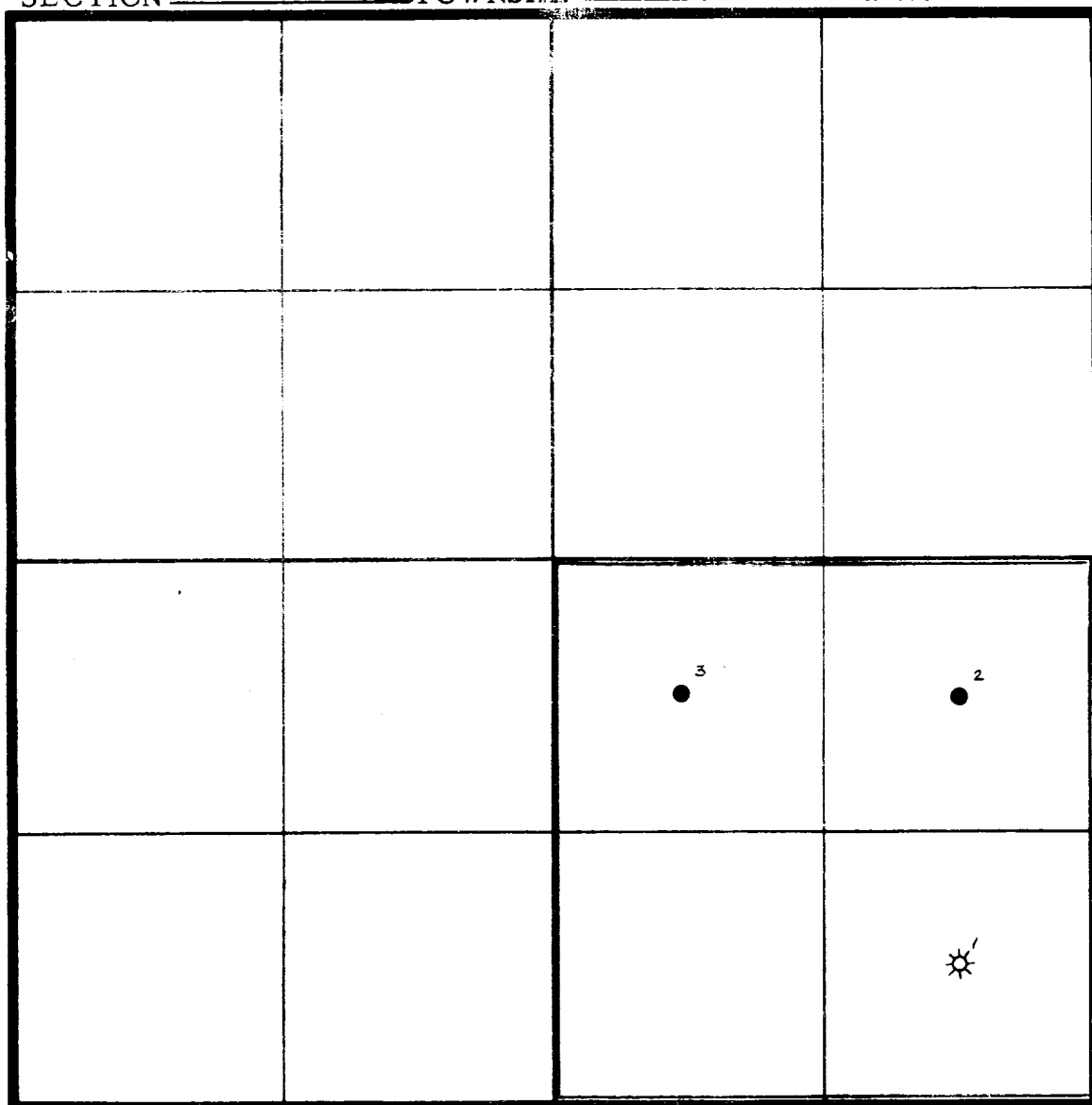
Name of Producing Formation Yates-Seven Rivers Pool LangmatNo. Acres Dedicated to the Well 160SECTION 12 TOWNSHIP 24S RANGE 36E

I hereby certify that the information given above is true and complete
to the best of my knowledge.

Name J. H. King
Position Division Superintendent
Representing Western Natural Gas Company
Address 923 Midland Tower, Midland, Texas

(over)

INSTRUCTIONS

1. Is this gas well a dual completion? Yes **x** No
2. If the answer to Question 1 is Yes, are there any other dually completed wells within the dedicated acreage? Yes No **x**

A separate plat must be filed for each gas well, outlining the area dedicated to such well and showing the location of all other wells (oil and gas) within the outlined area.

Mail in duplicate to the district office for the district in which the well is located.

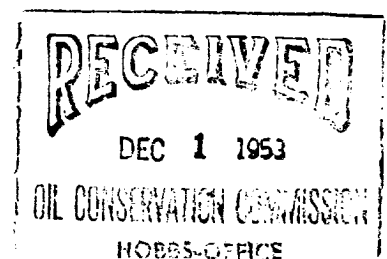

Langlie Mattix

ATLANTIC RICHFIELD CO.

1 DEAN Toby, G. W. WN Gas Com.

Sec 12, T24S, R36E

660' FSL, 660' EEL of Sec

8 mi N/Jal

RE 12

2-2-19 NM

1-14-79

12 1/2" at 290' w/200 sx

9 5/8" at 2844' w/700 sx

7" at 3257' w/40 sx

3685' (OUT)

IP (Yates) Perfs 2989-3236' F 25 MCFGPD

hr test thru 3/4" chk. GOR (NR); gty (NR) C 45#

3322' DE

5200' WO

2-5-79 F.R.C. 2-10-79 OWWO
(Orig. El Paso Natural Gas Co., 1937)
2-19-37 from (Seven Rivers-Queeny)
3257-3685', OTD 3685')
TD 3685'; PBD 3240'; Complete
Sqzd OH 3257-3685' w/200 sx
Perf (Csg Sqze) 3028-30'
Sqzd 3028-30' w/164 sx
Perf (Csg Sqze) @ 2900' w/40 shots
Sqzd @ 2900' w/200 sx
DOC to 3240'
Perf (Yates) 2989-3236' w/1 SPT
Acid (2989-3236') 3000 gals (15#)
Frac (2989-3236') 16,500 gals + 27,000# sd
+ 16,500 gals CO2
COMPLETION ISSUED

2-10-79

2-2-19 NM
IC 30-025-70031-79