

AD-RECEIVED

COPY TO O. C. S.

Budget Bureau No. 42-R358.4.
Form Approved.

DEC 13 1962

(SUBMIT IN TRIPLICATE)

HOBBSS

Land Office

Santa Fe

Lease No.

BN 040763

Unit

Federal

E. W. STANDLEY
DISTRICT ENGINEER

UNITED STATES

DEPARTMENT OF THE INTERIOR

GEOLOGICAL SURVEY

DEC 13 AM 10 06

SUNDRY NOTICES AND REPORTS ON WELLS

NOTICE OF INTENTION TO DRILL.....	SUBSEQUENT REPORT OF WATER SHUT-OFF.....
NOTICE OF INTENTION TO CHANGE PLANS.....	SUBSEQUENT REPORT OF SHOOTING OR ACIDIZING.....
NOTICE OF INTENTION TO TEST WATER SHUT-OFF.....	SUBSEQUENT REPORT OF ALTERING CASING.....
NOTICE OF INTENTION TO RE-DRILL OR REPAIR WELL.....	SUBSEQUENT REPORT OF RE-DRILLING OR REPAIR.....
NOTICE OF INTENTION TO SHOOT OR ACIDIZE.....	SUBSEQUENT REPORT OF ABANDONMENT.....
NOTICE OF INTENTION TO PULL OR ALTER CASING.....	SUPPLEMENTARY WELL HISTORY.....
NOTICE OF INTENTION TO ABANDON WELL.....	

(INDICATE ABOVE BY CHECK MARK NATURE OF REPORT, NOTICE, OR OTHER DATA)

December 4

1962

Well No. 1 is located 660 ft. from N line and 660 ft. from E line of sec. 20

R2/4 R2/4 24-6 36-1 MPM

(1/4 Sec. and Sec. No.) (Twp.) (Range) (Meridian)

Walnut Lee County New Mexico

(Field) (County or Subdivision) (State or Territory)

The elevation of the derrick floor above sea level is 4000 ft.

DETAILS OF WORK

(State names of and expected depths to objective sands; show sizes, weights, and lengths of proposed casings; indicate mudding jobs, cementing points, and all other important proposed work)

Drilled from surface to 305' w/12 1/2" hole, ran 8 5/8", 24' casing set @ 305', cemented w/175 sacks Lone Star Reg. cement. Cement was circulated to outside of surface and allowed to set 18 hours, nipples up, tested w/1000 cold water pressure for 30 minutes prior to drilling plug. No decline in pressure. Cement was circulated on 8 5/8" surface casing. Total depth 3820'

Propose to temporary abandon by filling hole with 10' mud, close hole at surface and clean up the location. Hole will be used by Hubble before permanently being abandoned.

I understand that this plan of work must receive approval in writing by the Geological Survey before operations may be commenced.

Company ROY H. SMITH DRILLING CO.

Address 728 First Wichita National Bldg.

Wichita Falls, Texas

By Betty Gelford, Agent
for Roy H. Smith Drig. Co.

Title

APPROVED

COPY TO B.C.C.

H 35

Budget Bureau No. 42-R358.4.
Form Approved.Form 9-331a
(Feb. 1951)

NOV 29 1962

(SUBMIT IN TRIPLICATE)

E. W. STANDLEY
DISTRICT ENGINEERUNITED STATES
DEPARTMENT OF THE INTERIOR
GEOLOGICAL SURVEYLand Office **Santa Fe**Lease No. **HM 040763**Unit **Federal**

RECEIVED

NOV 29 1962

SUNDRY NOTICES AND REPORTS ON WELLS

NOTICE OF INTENTION TO DRILL	SUBSEQUENT REPORT OF WATER SHUT-OFF	<input checked="" type="checkbox"/>
NOTICE OF INTENTION TO CHANGE PLANS	SUBSEQUENT REPORT OF SHOOTING OR ACIDIZING	
NOTICE OF INTENTION TO TEST WATER SHUT-OFF	SUBSEQUENT REPORT OF ALTERING CASING	
NOTICE OF INTENTION TO RE-DRILL OR REPAIR WELL	SUBSEQUENT REPORT OF RE-DRILLING OR REPAIR	
NOTICE OF INTENTION TO SHOOT OR ACIDIZE	SUBSEQUENT REPORT OF ABANDONMENT	
NOTICE OF INTENTION TO PULL OR ALTER CASING	SUPPLEMENTARY WELL HISTORY	
NOTICE OF INTENTION TO ABANDON WELL		

(INDICATE ABOVE BY CHECK MARK NATURE OF REPORT, NOTICE, OR OTHER DATA)

November 26, 1962

Well No. 1 is located 660 ft. from N line and 660 ft. from E line of sec. 20

<u>NE/4 NE/4</u> (1/4 Sec. and Sec. No.)	<u>24-8</u> (Twp.)	<u>36-E</u> (Range)	<u>N27W</u> (Meridian)
<u>Wildcat</u> (Field)	<u>Lee County</u> (County or Subdivision)	<u>New Mexico</u> (State or Territory)	

The elevation of the derrick floor above sea level is 4000 ft.

DETAILS OF WORK

(State names of and expected depths to objective sands; show sizes, weights, and lengths of proposed casings; indicate mudding jobs, cementing points, and all other important proposed work)

Drilling from surface to 305' w/12 1/2" hole, ran 8 5/8", 24' casing set @ 305', cemented w/175 sacks Lone Star Reg. Cement. Cement circulated to outside of surface, allowed to set 18 hours, nipples up, tested w/1000 cold water pressure for 30 minutes prior to drilling plug. No decline in pressure.

I understand that this plan of work must receive approval in writing by the Geological Survey before operations may be commenced.

Company ROY H. SMITH DRILLING CO.
Address 726 First Wichita National Bldg.
Wichita Falls, Texas

By Roy H. Smith
ROY H. SMITH
Owner
Title _____

APPROVED

NOV 9 1962

Budget Bureau No. 42-R358.4.
Approval expires 12-31-60.

NOV 9 1962

(SUBMIT IN TRIPLICATE)

Land Office

Lease No.

Unit

E. W. STANDLEY
DISTRICT ENGINEERUNITED STATES
DEPARTMENT OF THE INTERIOR
GEOLOGICAL SURVEY

NOV 13 AM 10 06

SUNDRY NOTICES AND REPORTS ON WELLS

NOTICE OF INTENTION TO DRILL.....	<input checked="" type="checkbox"/>	SUBSEQUENT REPORT OF WATER SHUT-OFF.....	
NOTICE OF INTENTION TO CHANGE PLANS.....		SUBSEQUENT REPORT OF SHOOTING OR ACIDIZING.....	
NOTICE OF INTENTION TO TEST WATER SHUT-OFF.....		SUBSEQUENT REPORT OF ALTERING CASING.....	
NOTICE OF INTENTION TO RE-DRILL OR REPAIR WELL.....		SUBSEQUENT REPORT OF RE-DRILLING OR REPAIR.....	
NOTICE OF INTENTION TO SHOOT OR ACIDIZE.....		SUBSEQUENT REPORT OF ABANDONMENT.....	
NOTICE OF INTENTION TO PULL OR ALTER CASING.....		SUPPLEMENTARY WELL HISTORY.....	
NOTICE OF INTENTION TO ABANDON WELL.....			

(INDICATE ABOVE BY CHECK MARK NATURE OF REPORT, NOTICE, OR OTHER DATA)

October 12, 1962

Well No. 1 is located 660 ft. from N line and 660 ft. from E line of sec. 20
NE/4 NE/4 24-S R-36-E BM
(1/4 Sec. and Sec. No.) (Twp.) (Range) (Meridian)
Wildcat Leon County New Mexico
(Field) (County or Subdivision) (State or Territory)

The elevation of the derrick floor above sea level is 4000 ft.

DETAILS OF WORK

(State names of and expected depths to objective sands; show sizes, weights, and lengths of proposed casings; indicate mudding jobs, cementing points, and all other important proposed work)

Proposed total depth 4,000' (Tates Sandstone)

Proposed casing program:

300' of 8 5/8" cemented w/50 sacks

* 1/2" casing cemented at top of pay w/approx. 100 sacks

* Cement being circulated on 8-5/8" surface casing and through the salt section on the 8-1/8" production string.

I understand that this plan of work must receive approval in writing by the Geological Survey before operations may be commenced.

Company ROY H. SMITHAddress 728 First Wichita National Bldg.Wichita Falls, TexasBy ROY H. SMITHTitle OWNER

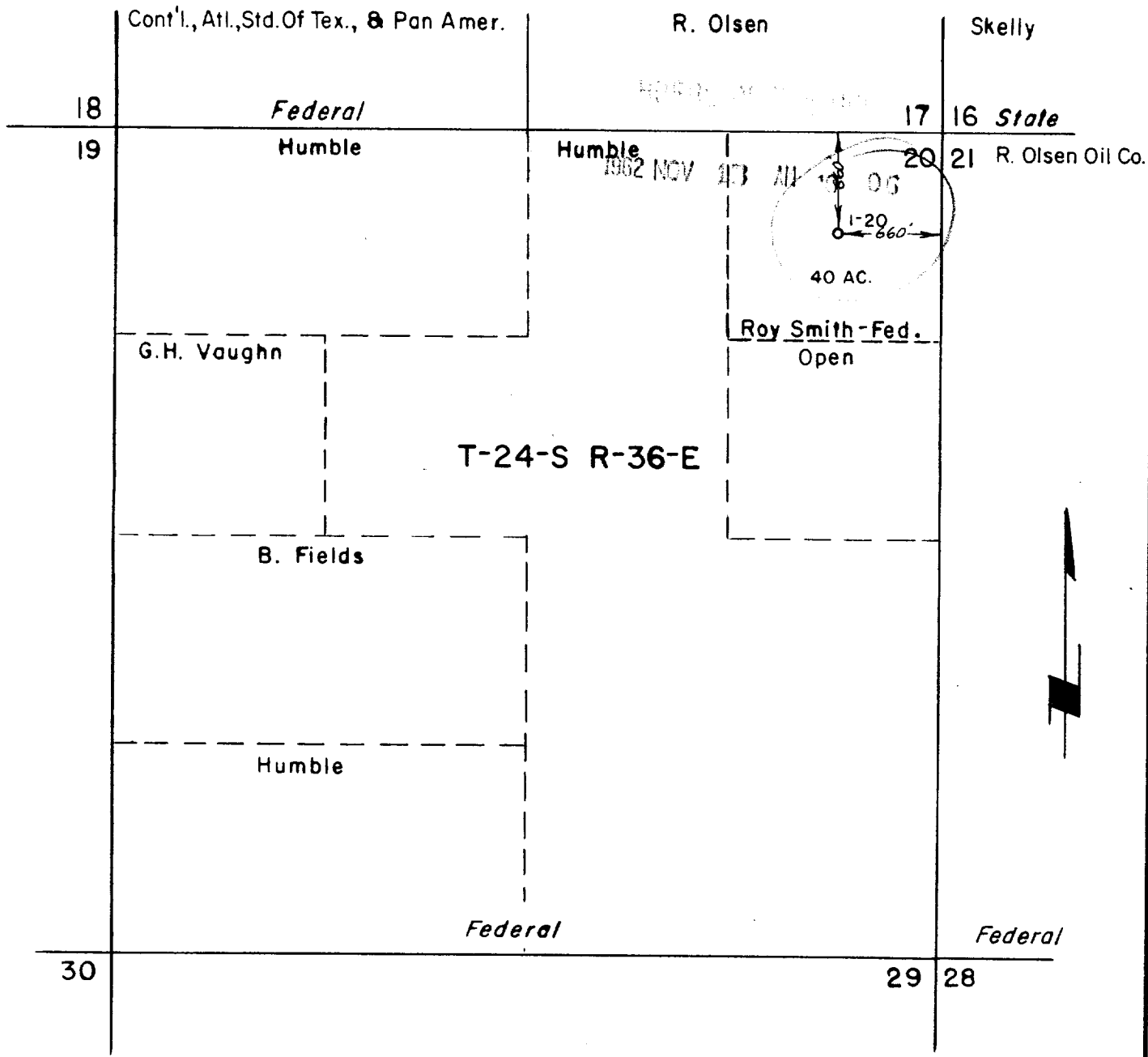

This is to certify that I am a registered professional engineer or registered land surveyor, in the State of New Mexico, that this map was prepared from field notes or actual surveys made by me or under my direction and that the same is true and correct to the best of my knowledge and belief.

2156 H. N. S.
 Registration Number Registered Professional Engineer or Registered Land Surveyor

This Application For Well No. 1-20

ROY SMITH - FEDERAL
 LEA CO., NEW MEX.

DRAWN <u>J.E.C.</u>	ENGR. SECTION <u>Civil</u>	REVISD	SCALE <u>1" = 1000'</u>	JOB NO.	FILE NO.
CHECKED <u>D. W. H.</u>	APPROVED <u>H. N. S.</u>		DATE <u>10-3-62</u>		