

**NEW MEXICO OIL CONSERVATION COMMISSION
WELL LOCATION AND ACREAGE DEDICATION PLAT**

Form C-102
Supersedes C-128
Effective 1-1-65

All distances must be from the outer boundaries of the Section.

Operator Worldwide Energy Corporation			Lease R.L. Gates		Well No. 1
Unit Letter D	Section 23	Township 24S	Range 36E	County Lea	
Actual Footage Location of Well: 660' feet from the North line and 660' feet from the West line					
Ground Level Elev. 3329'	Producing Formation Yates		Pool Jalmat		Dedicated Acreage: 40 Acres

1. Outline the acreage dedicated to the subject well by colored pencil or hachure marks on the plat below.
2. If more than one lease is dedicated to the well, outline each and identify the ownership thereof (both as to working interest and royalty).
3. If more than one lease of different ownership is dedicated to the well, have the interests of all owners been consolidated by communitization, unitization, force-pooling, etc?

☐ Yes ☐ No If answer is "yes," type of consolidation _____

If answer is "no," list the owners and tract descriptions which have actually been consolidated. (Use reverse side of this form if necessary.) _____

No allowable will be assigned to the well until all interests have been consolidated (by communitization, unitization, forced-pooling, or otherwise) or until a non-standard unit, eliminating such interests, has been approved by the Commission.

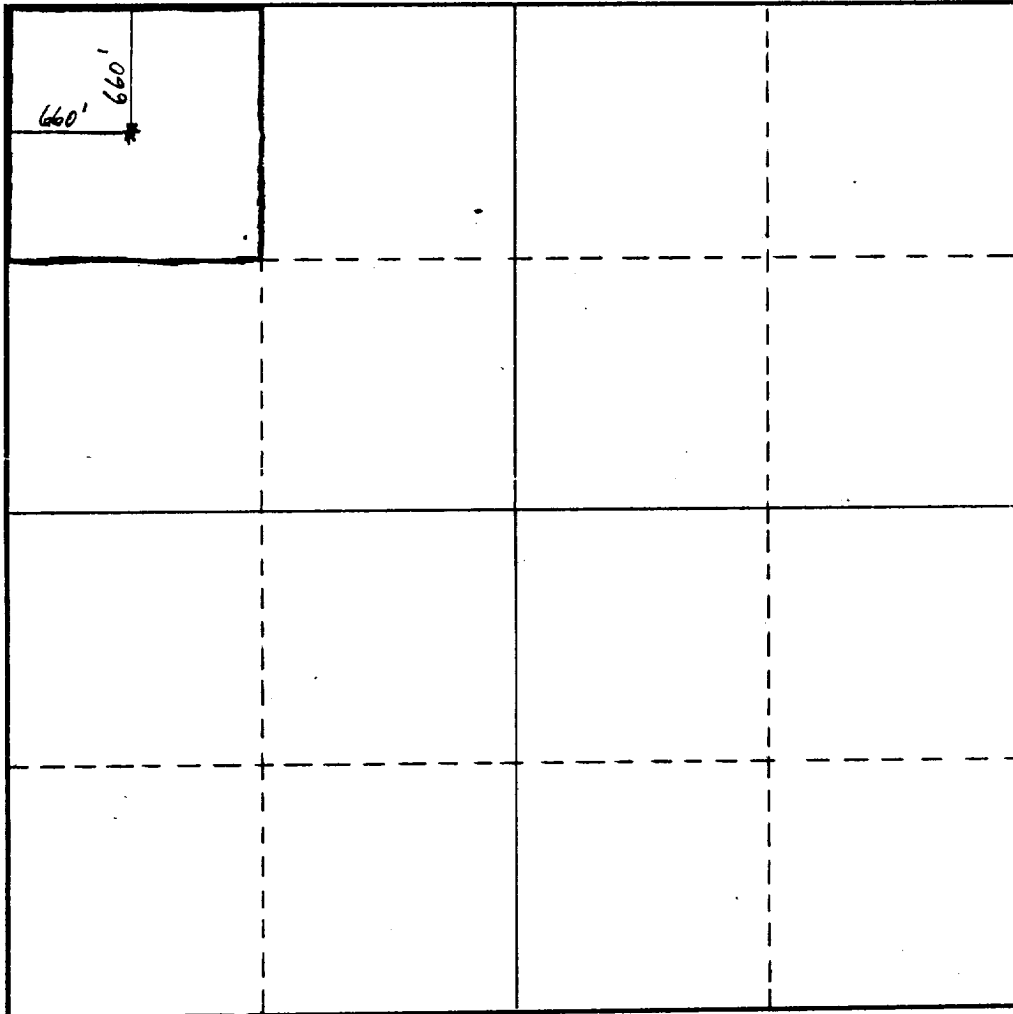

CERTIFICATION

I hereby certify that the information contained herein is true and complete to the best of my knowledge and belief.

Robert B. Tenison Jr.

Name
Robert B. Tenison Jr.

Position
Lead Production Clerk

Company
Worldwide Energy Corp.

Date
7/14/86

I hereby certify that the well location shown on this plat was plotted from field notes of actual surveys made by me or under my supervision, and that the same is true and correct to the best of my knowledge and belief.

Date Surveyed _____

Registered Professional Engineer
and/or Land Surveyor _____

Certificate No. _____

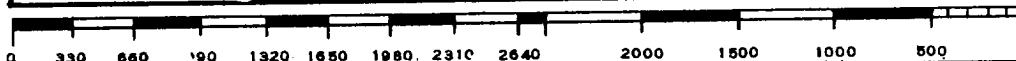

RECEIVED
JUL 16 1966
S.C.P.
HONOLULU OFFICE

NEW MEXICO OIL CONSERVATION COMMISSION
WELL LOCATION AND ACREAGE DEDICATION PLAT

Form C-102
Supersedes C-128
Effective 1-1-65

All distances must be from the outer boundaries of the Section.

Operator Paul P. Scott Trust & Est. Clara T. Scott, Deceased			Lease R. L. Gates SEP 27 1967		Well No. 1
Unit Letter D	Section 23	Township 24S	Range 36E	County Lea	

Actual Footage Location of Well:

660 feet from the **N** line and **660** feet from the **W** line

Ground Level Elev. 3329	Producing Formation Yates	Pool Jalmat Gas	Dedicated Acreage: Proposed 80 Acres
-----------------------------------	-------------------------------------	---------------------------	--

1. Outline the acreage dedicated to the subject well by colored pencil or hachure marks on the plat below.
2. If more than one lease is dedicated to the well, outline each and identify the ownership thereof (both as to working interest and royalty). **NE/4 obtained by farmout from New Mexico Federal Unit. Basic Royalty under both Quarter Sections identical.**
3. If more than one lease of different ownership is dedicated to the well, have the interests of all owners been consolidated by communitization, unitization, force-pooling, etc?

☐ Yes ☐ No If answer is "yes," type of consolidation _____

If answer is "no," list the owners and tract descriptions which have actually been consolidated. (Use reverse side of this form if necessary.) _____

No allowable will be assigned to the well until all interests have been consolidated (by communitization, unitization, forced-pooling, or otherwise) or until a non-standard unit, eliminating such interests, has been approved by the Commission. **Non-Standard Unit approved by Oil Conservation Commission per Administrative Order MSP-784.**

SCOTT (previous NMFU Conoco Oper.) 61A			
U.S.	U.S.		

CERTIFICATION

I hereby certify that the information contained herein is true and complete to the best of my knowledge and belief.

Name **Bryan P. Dixon**
 Position **Petroleum Engineer**
First National Bank in Dallas
 Company **P.O. Box 6031**
Dallas, Texas 75222
 Date **September 26, 1967**

I hereby certify that the well location shown on this plat was plotted from field notes of actual surveys made by me or under my supervision, and that the same is true and correct to the best of my knowledge and belief.

Unavailable

Date Surveyed

Registered Professional Engineer and/or Land Surveyor

Certificate No.

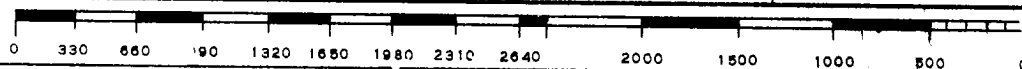

NEW MEXICO OIL CONSERVATION COMMISSION
WELL LOCATION AND ACREAGE DEDICATION PLAT

FORM C-128
 Revised 5/1/57

SEE INSTRUCTIONS FOR COMPLETING THIS FORM ON THE REVERSE SIDE

SECTION A

Operator Paul P. Scott Trust			Lease R. L. Gates		Well No. 1
Unit Letter D	Section 23	Township 24-S	Range 36-E	County Lea	
Actual Footage Location of Well: 660 feet from the North line and 660 feet from the West line					
Ground Level Elev. 3329	Producing Formation Yates		Pool Jalmat		Dedicated Acreage: 40 Acres

- Is the Operator the only owner in the dedicated acreage outlined on the plat below? YES ☒ NO ____ . ("Owner" means the person who has the right to drill into and to produce from any pool and to appropriate the production either for himself or for himself and another. (65-3-29 (e) NMSA 1935 Comp.)
- If the answer to question one is "no," have the interests of all the owners been consolidated by communitization agreement or otherwise? YES ____ NO ____ . If answer is "yes," Type of Consolidation _____
- If the answer to question two is "no," list all the owners and their respective interests below:

Owner	Land Description

SECTION B

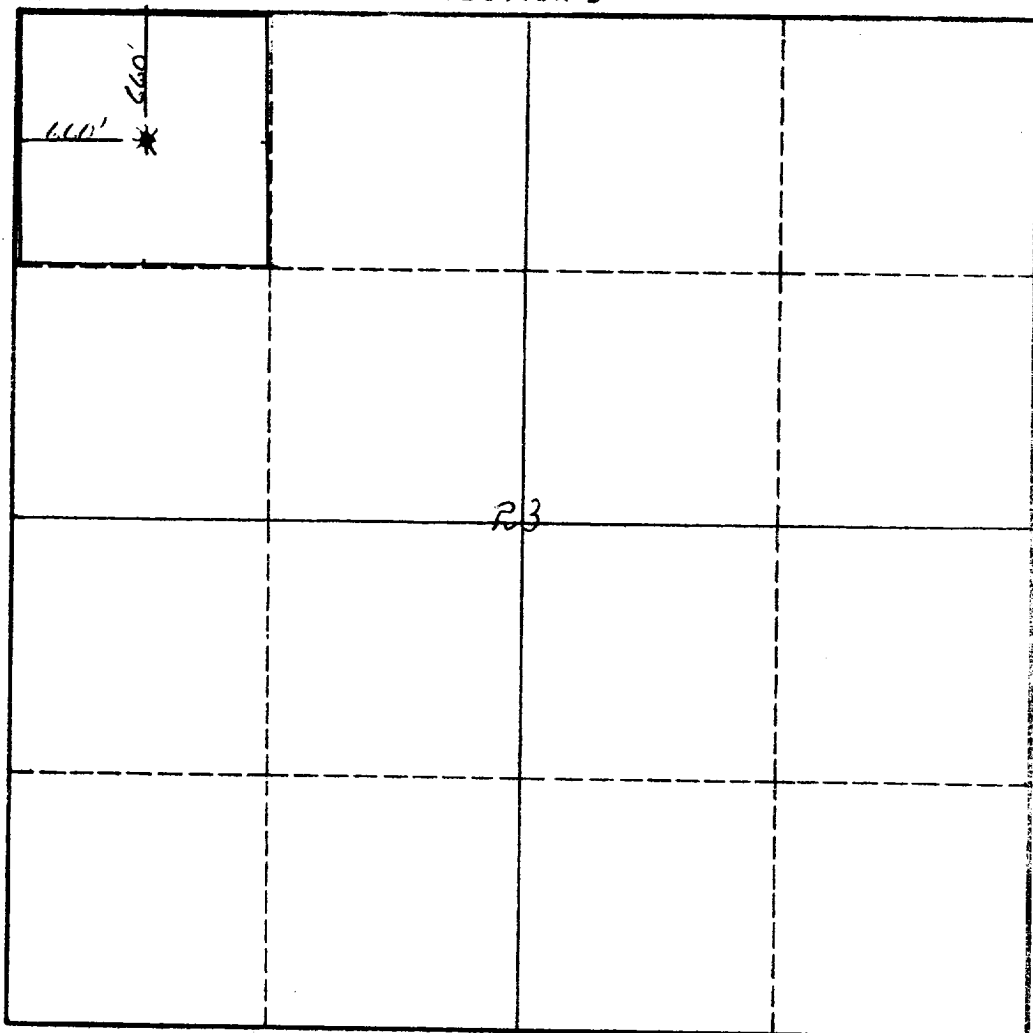

CERTIFICATION

I hereby certify that the information in SECTION A above is true and complete to the best of my knowledge and belief.

Robert B. May
 Name **Robert B. May**
 Position **Petroleum Engineer**
 Company **First National Bank in Dallas**
 Date **December 24, 1964**

I hereby certify that the well location shown on the plat in SECTION B was plotted from field notes of actual surveys made by me or under my supervision, and that the same is true and correct to the best of my knowledge and belief.

Date Surveyed _____
 Registered Professional Engineer and/or Land Surveyor _____
 Certificate No. _____

0 330 660 990 1320 1650 1980 2310 2640 2000 1500 1000 500 0

INSTRUCTIONS FOR COMPLETION OF FORM C-128

1. Operator shall furnish and certify to the information called for in Section A.
2. Operator shall outline the dedicated acreage for *both* oil and gas wells on the plat in Section B.
3. A registered professional engineer or land surveyor registered in the State of New Mexico or approved by the Commission shall show on the plat the location of the well and certify this information in the space provided.
4. All distances shown on the plat must be from the outer boundaries of the Section.
5. If additional space is needed for listing owners and their respective interests as required in question 3 of Section A, please use space below.

COUNTY	LEA	FIELD	Jalmat Gas	STATE	N.M.	OWWO
OPR	SCOTT, PAUL P. Trustee				MAP	
	1 Gates, R. L. A-23					
	Sec. 23, T-24-S, R-36-E				CO-ORD	
	660' fr N & W Lines of Sec.					
	Re-Spud 6-1-64		CLASS		EL	
	Re-Comp 6-5-64		FORMATION	DATUM	FORMATION	DATUM
CSG & SX - TUBING						
LOGS EL GR RA IND HC A						
			TD 3514', PBD 3270'			

IP Yates Perfs 3055-3264' Flwd 1500 MCFGPD. Pot. Based on 24 hr test thru 27/64" chk., TP 375#, SITP 755#.

Distribution limited and publication prohibited by subscribers' agreement.
Reproduction rights reserved by Williams & Lee Scouting Service, Inc.

CONT.	PROP DEPTH	TYPE
DATE		

8-17-64 F.R.C. 8-20-64; OWWO, OTD 3514'.
Orig Temp Abd in 1952, perf 3055-3264'; tstd & made small amt of gas. Operator was Kan-Mex Corp.
TD 3514', PBD 3270', COMPLETED.
Ac. 500 gals.,
Frac 37,000 gals wtr + 40,000# sd. (3055-3264')