

NEW MEXICO OIL CONSERVATION COMMISSION
WELL LOCATION AND ACREAGE DEDICATION PLAT

FORM C-128
 Revised 5/1/57

SEE INSTRUCTIONS FOR COMPLETING THIS FORM ON THE REVERSE SIDE

Operator TEXACO Inc.		SECTION A Post Aug 8 AM 10:07 Lease C. W. Shepherd (b)		Well No. 5
Unit Letter I	Section 1	Township 26 South	Range 36 East	County Lea
Actual Footage Location of Well: 1980 feet from the South line and 660 feet from the East line Sec. 1				
Ground Level Elev. 2963	Producing Formation Seven Rivers	Pool Undesignated (Oil)	Dedicated Acreage: 40 Acres	

1. Is the Operator the only owner in the dedicated acreage outlined on the plat below? YES _____ NO X. ("Owner" means the person who has the right to drill into and to produce from any pool and to appropriate the production either for himself or for himself and another. (65-3-29 (e) NMSA 1935 Comp.)
2. If the answer to question one is "no," have the interests of all the owners been consolidated by communitization agreement or otherwise? YES X NO _____. If answer is "yes," Type of Consolidation Joint Operating Agreement
3. If the answer to question two is "no," list all the owners and their respective interests below:

Owner	Land Description

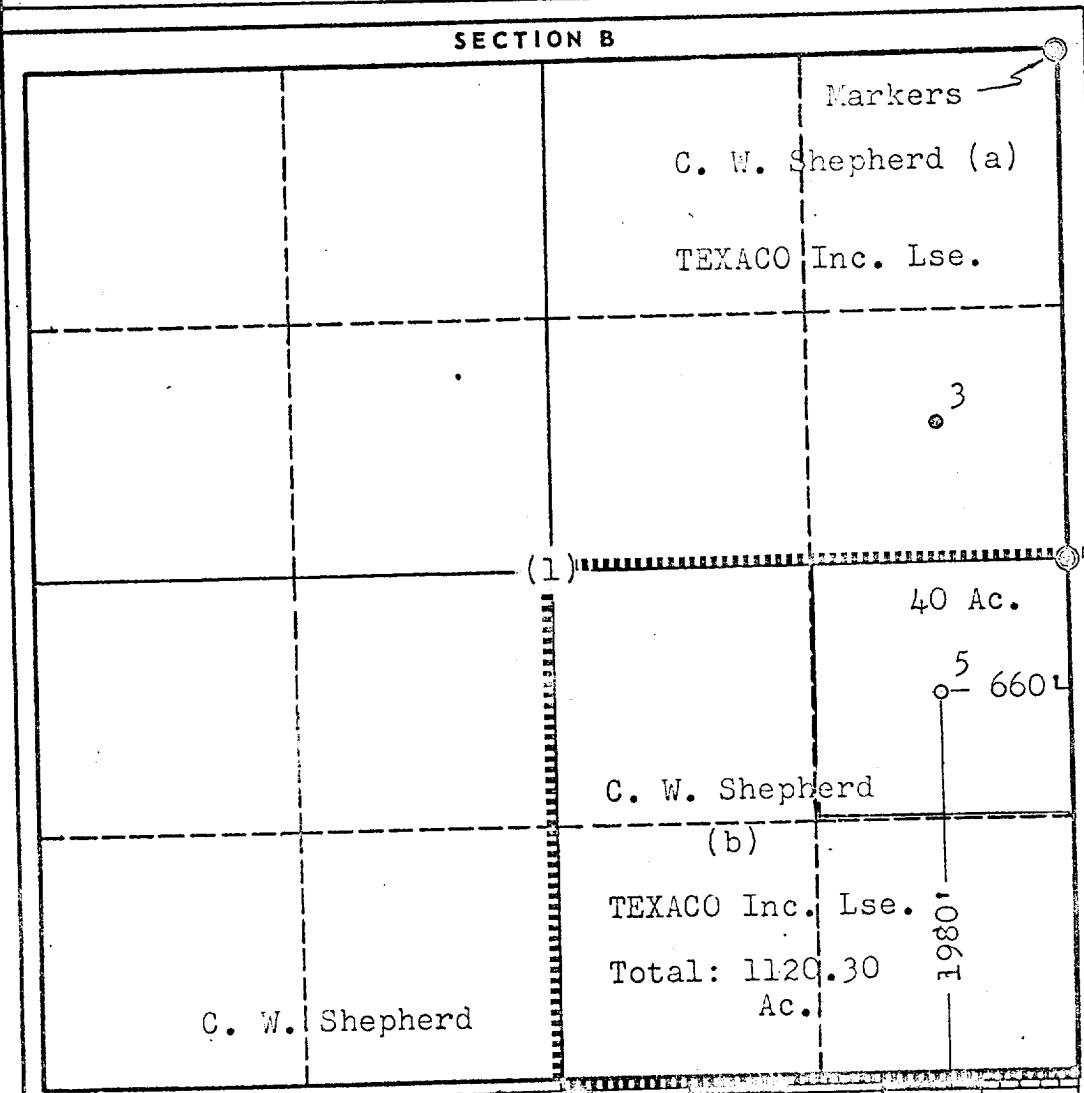

CERTIFICATION

I hereby certify that the information in SECTION A above is true and complete to the best of my knowledge and belief.

Name: J. J. Velten
 Position: Division Civil Engineer
 Company: TEXACO Inc.
 Date: 8/3/61

I hereby certify that the well location shown on the plat in SECTION B was plotted from field notes of actual surveys made by me or under my supervision, and that the same is true and correct to the best of my knowledge and belief.

Date Signed: 8/2/61
 Registered Professional Engineer and/or Land Surveyor:
J. J. Velten
 Certificate No. 8174

