

NEW MEXICO OIL CONSERVATION COMMISSION
Santa Fe, New Mexico

NOTICE OF INTENTION TO DRILL

Notice must be given to the Oil Conservation Commission or its proper agent and approval obtained before drilling begins. If changes in the proposed plan are considered advisable, a copy of this notice showing such changes will be returned to the sender. Submit this notice in triplicate. One copy will be returned following approval. See additional instructions in Rules and Regulations of the Commission.

Dallas, Texas

March 18, 1936.

OIL CONSERVATION COMMISSION,
Santa Fe, New Mexico

Gentlemen:

You are hereby notified that it is our intention to commence the drilling of a well to be known as _____

Sun Oil Company A. D. Richards Well No. 1 in SE/4
Company or Operator Lease
of Sec. 6, T. 23-S, R. 37-E, N. M. P. M., South Eunice Field, Lea County.

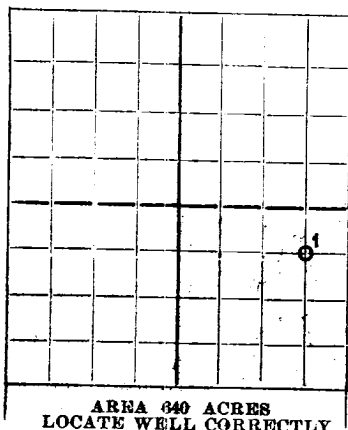

The well is 660 feet DM. [S.] of the North line and 660 feet

MM [W.] of the East line of SE/4 of Sec. 6

(Give location from section or other legal subdivision lines. Cross out wrong directions.)

If state land the oil and gas lease is No. _____ Assignment No. _____

If patented land the owner is Arthur D. Richards and wife,

Address Abilene, Texas.

If government land the permittee is _____

Address _____

The lessee is Sun Oil Company,

Address Dallas, Texas.

We propose to drill well with drilling equipment as follows: _____

Rotary rig from top to bottom.

The status of a bond for this well in conformance with Rule 39 of the General Rules and Regulations of the Commission is as follows: \$10,000.00 blanket bond filed with State Land Office.

We propose to use the following strings of casing and to land or cement them as indicated:

| Size of Hole | Size of Casing | Weight Per Foot | New or Second Hand | Depth | Landed or Cemented | Sacks Cement |
|-------------------|-------------------|-----------------|--------------------|----------------------|--------------------|----------------|
| 12-1/2 | 10-3/4 | 40# | New | 260 feet | | 125 |
| 8-3/4 | 7" | 24# | New | 3500 feet | | 600 |
| <u>12-1/2</u> | <u>10-3/4</u> | <u>40#</u> | <u>New</u> | <u>260 feet</u> | | <u>125</u> |
| <u>8-3/4</u> | <u>7"</u> | <u>24#</u> | <u>New</u> | <u>3500 feet</u> | | <u>600</u> |

If changes in the above plan become advisable we will notify you before cementing or landing casing. We estimate that the first productive oil or gas sand should occur at a depth of about 3760 feet.

Additional information:

DUPLICATE

Approved MAR 18 1936, 19 _____
except as follows:

Subject to general regulations for drilling and casing wells in this area

OIL CONSERVATION COMMISSION,

By [Signature]

Title [Signature]

Sincerely yours,

SUN OIL COMPANY
Company or Operator
By [Signature]
Position Superintendent
Send communication regarding well to
Name Mr. J. A. Ritter,
Address Sun Oil Company,

• **What is the purpose of the study?**

[illegible]
$$f_{\text{eff}} = \frac{\sum_{i=1}^n f_i}{n} = \frac{1}{n} \left(\sum_{i=1}^n f_i \right) = \frac{1}{n} \left(\sum_{i=1}^n f_i \right)$$
$$f(x) = \frac{1}{2} \left(1 + \frac{x}{\sqrt{1+x^2}} \right)$$