

**NEW MEXICO OIL CONSERVATION COMMISSION
WELL LOCATION AND ACREAGE DEDICATION PLAT**

Form C-102
Supersedes C-128
Effective 1-1-65

All distances must be from the outer boundaries of the Section.

Operator Sinclair Oil & Gas Company			Lease Dethle-Anderson Unit		Well No. 1
Unit Letter J	Section 18	Township 23-S	Range 37-E	County Lea	
Actual Footage Location of Well: 1700 feet from the South line and 1900 feet from the East line					
Ground Level Elev. 3336	Producing Formation Yates		Pool Jalisco Gas Pool		Dedicated Acreage: 160 Acres

1. Outline the acreage dedicated to the subject well by colored pencil or hachure marks on the plat below.
2. If more than one lease is dedicated to the well, outline each and identify the ownership thereof (both as to working interest and royalty).
3. If more than one lease of different ownership is dedicated to the well, have the interests of all owners been consolidated by communitization, unitization, force-pooling, etc?

☐ Yes ☐ No If answer is "yes," type of consolidation _____

If answer is "no," list the owners and tract descriptions which have actually been consolidated. (Use reverse side of this form if necessary.) _____

No allowable will be assigned to the well until all interests have been consolidated (by communitization, unitization, forced-pooling, or otherwise) or until a non-standard unit, eliminating such interests, has been approved by the Commission.

ILLEGIBLE

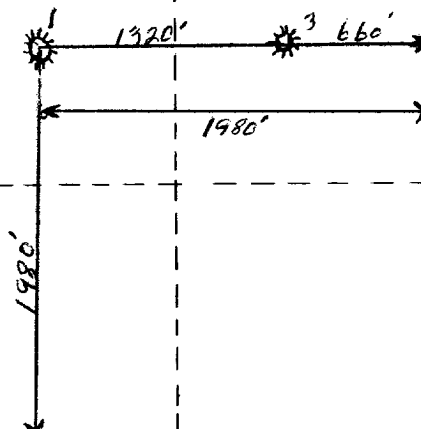

CERTIFICATION

I hereby certify that the information contained herein is true and complete to the best of my knowledge and belief.

Name **Fred Burns**

Position **District Superintendent**

Company **Sinclair Oil & Gas Co.**

Date **February 2, 1965**

I hereby certify that the well location shown on this plat was plotted from field notes of actual surveys made by me or under my supervision, and that the same is true and correct to the best of my knowledge and belief.

Date Surveyed _____

Registered Professional Engineer and/or Land Surveyor

*** Over**

Certificate No. _____

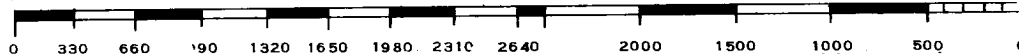

•

This well was completed in March, 1942 in the Langlie Mattix Pool by Western Natural Gas Company. The data received from Western Natural, after its purchase by Sinclair, did not show the name of the surveyor or the survey date.