

NEW MEXICO OIL CONSERVATION COMMISSION
WELL LOCATION AND ACREAGE DEDICATION PLAT

FORM C-128
Revised 5/1/57

SEE INSTRUCTIONS FOR COMPLETING THIS FORM ON THE REVERSE SIDE

SECTION A

Operator JOHN H. HILL JOHN H. HILL		Lease La Huyen " "		Well No. 3
Unit Letter O	Section 22	Township 23 S	Range 37 E	County Lea
Actual Footage Location of Well: 660 feet from the South line and 1980 feet from the East line				
Ground Level Elev. 3258.7	Producing Formation Penrose	Pool Undesignated(Mtx)	Dedicated Acreage: 40 Acres	
1. Is the Operator the only owner in the dedicated acreage outlined on the plat below? YES <input checked="" type="checkbox"/> NO <input type="checkbox"/> ("Owner" means the person who has the right to drill into and to produce from any pool and to appropriate the production either for himself or for himself and another. (65-3-29 (e) NMSA 1935 Comp.)				
2. If the answer to question one is "no," have the interests of all the owners been consolidated by communitization agreement or otherwise? YES <input type="checkbox"/> NO <input type="checkbox"/> . If answer is "yes," Type of Consolidation _____				
3. If the answer to question two is "no," list all the owners and their respective interests below:				
Owner		Land Description		
		AUG 27 1959 U. S. GEOLOGICAL HOBBES, NEW MEXICO		

SECTION B

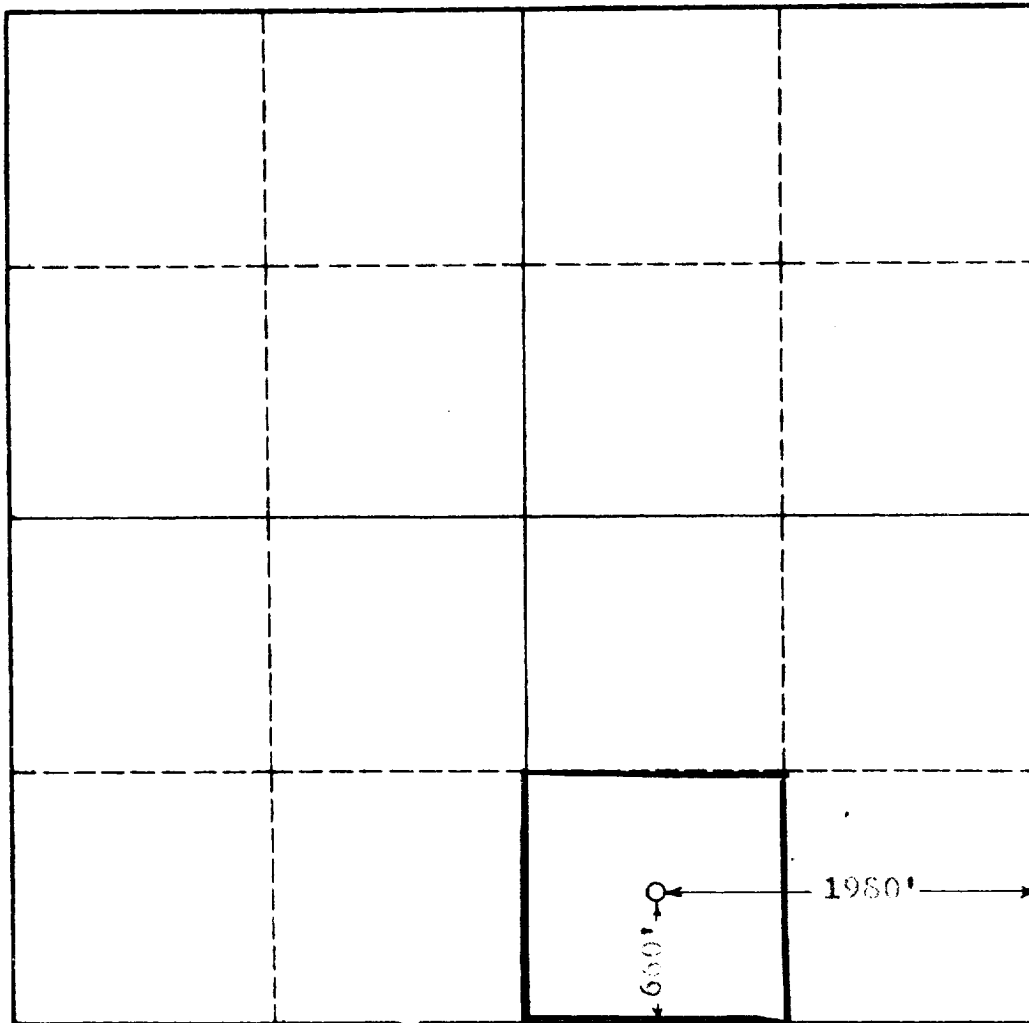

0 330 660 990 1320 1650 1980 2310 2640 2000 1500 1000 500 0

CERTIFICATION

I hereby certify that the information in SECTION A above is true and complete to the best of my knowledge and belief.

Name Agent
Position JOHN H. HILL Company
Date 8/25/59

I hereby certify that the well location shown on the plat in SECTION B was plotted from field notes of actual surveys made by me or under my supervision, and that the same is true and correct to the best of my knowledge and belief.

Date Surveyed Aug. 13, 1959
Registered Professional Engineer and/or Land Surveyor, JOHN W. WEST
Certificate No. N.M. - P.E. & L.S. NO. 676