

NEW MEXICO OIL CONSERVATION COMMISSION
WELL LOCATION AND ACREAGE DEDICATION PLAT

FORM C-128
 Revised 5/1/57

SEE INSTRUCTIONS FOR COMPLETING THIS FORM ON THE REVERSE SIDE

SECTION A

Operator Texas Pacific Coal & Oil Co.		Lease Eva Blinebry "B"		Well No. 7
Unit Letter F	Section 34	Township 23 South	Range 37 East	County Lea County
Actual Footage Location of Well: 2310 feet from the North line and 1650 feet from the West line				
Ground Level Elev. 3270.35	Producing Formation		Pool	Dedicated Acreage: Acres

1. Is the Operator the only owner in the dedicated acreage outlined on the plat below? YES _____ NO _____. ("Owner" means the person who has the right to drill into and to produce from any pool and to appropriate the production either for himself or for himself and another. (65-3-29 (e) NMSA 1935 Comp.)
2. If the answer to question one is "no," have the interests of all the owners been consolidated by communitization agreement or otherwise? YES _____ NO _____. If answer is "yes," Type of Consolidation _____
3. If the answer to question two is "no," list all the owners and their respective interests below:

Owner	Land Description

SECTION B

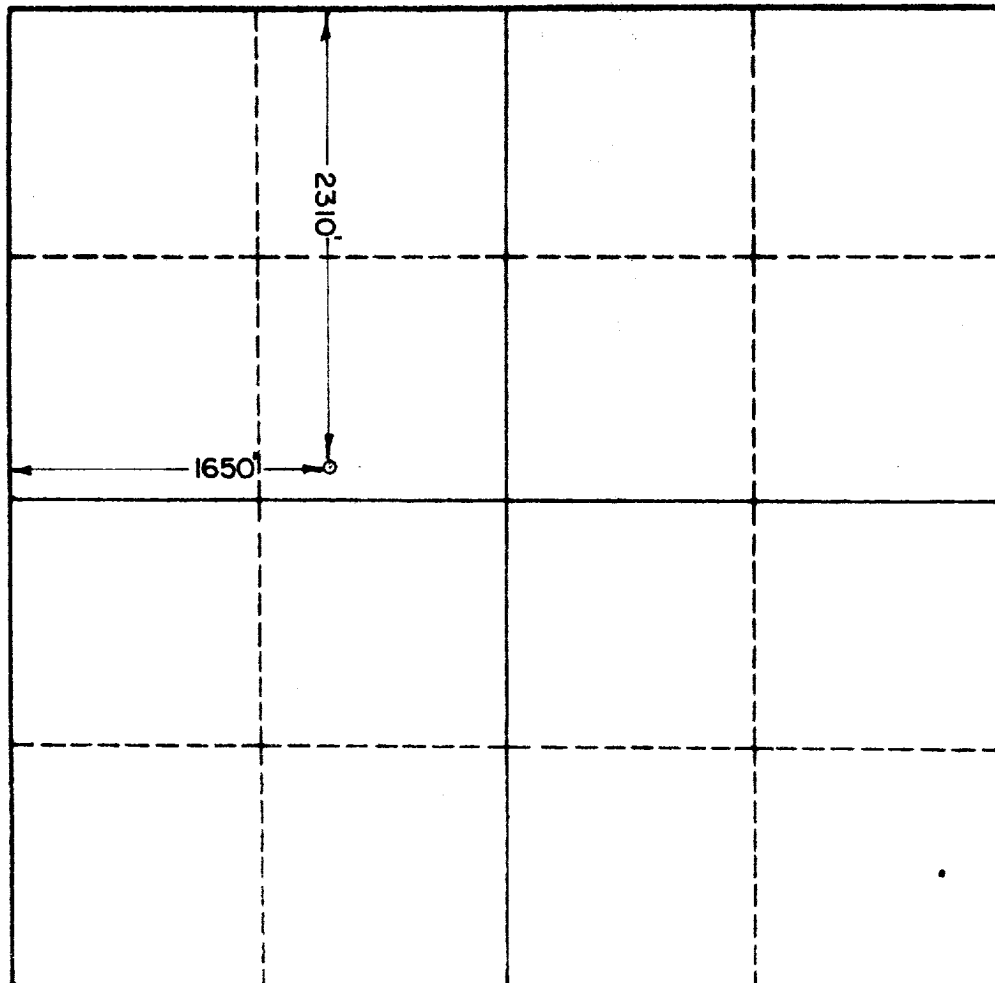

CERTIFICATION

I hereby certify that the information in SECTION A above is true and complete to the best of my knowledge and belief.

Name	<i>John W. West</i>
Position	<i>District Engineer</i>
Company	<i>Texas Pacific Coal & Oil Co.</i>
Date	<i>8/10/61</i>

I hereby certify that the well location shown on the plat in SECTION B plotted from field notes of actual survey made by me or under my supervision, and that the same is true and correct to the best of my knowledge and belief.

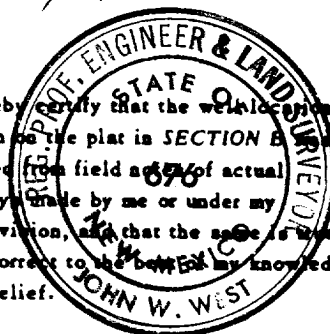

Date Surveyed	August 1, 1961
Registered Professional Engineer and/or Land Surveyor, JOHN W. WEST	
<i>John W. West</i>	
Certificate No.	N. M. - P. E. & L. S. NO. 676

