

NEW MEXICO  
OIL CONSERVATION COMMISSION

Form C-128

Well Location and/or Gas Proration Plat

Date 6-13-1956

Operator Getty Oil Co. Owner  
Tidewater Oil Co. Operator Lease By Riggs "B"

Well No. 3 Section 1 Township 26 South Range 37 East NMPM

Located 1980 Feet From North Line, 1980 Feet From East Line,

Lea County, New Mexico. G. L. Elevation \_\_\_\_\_

Name of Producing Formation Queen Pool Langlie-Matt Dedicated Acreage 40

(Note: All distances must be from outer boundaries of Section)

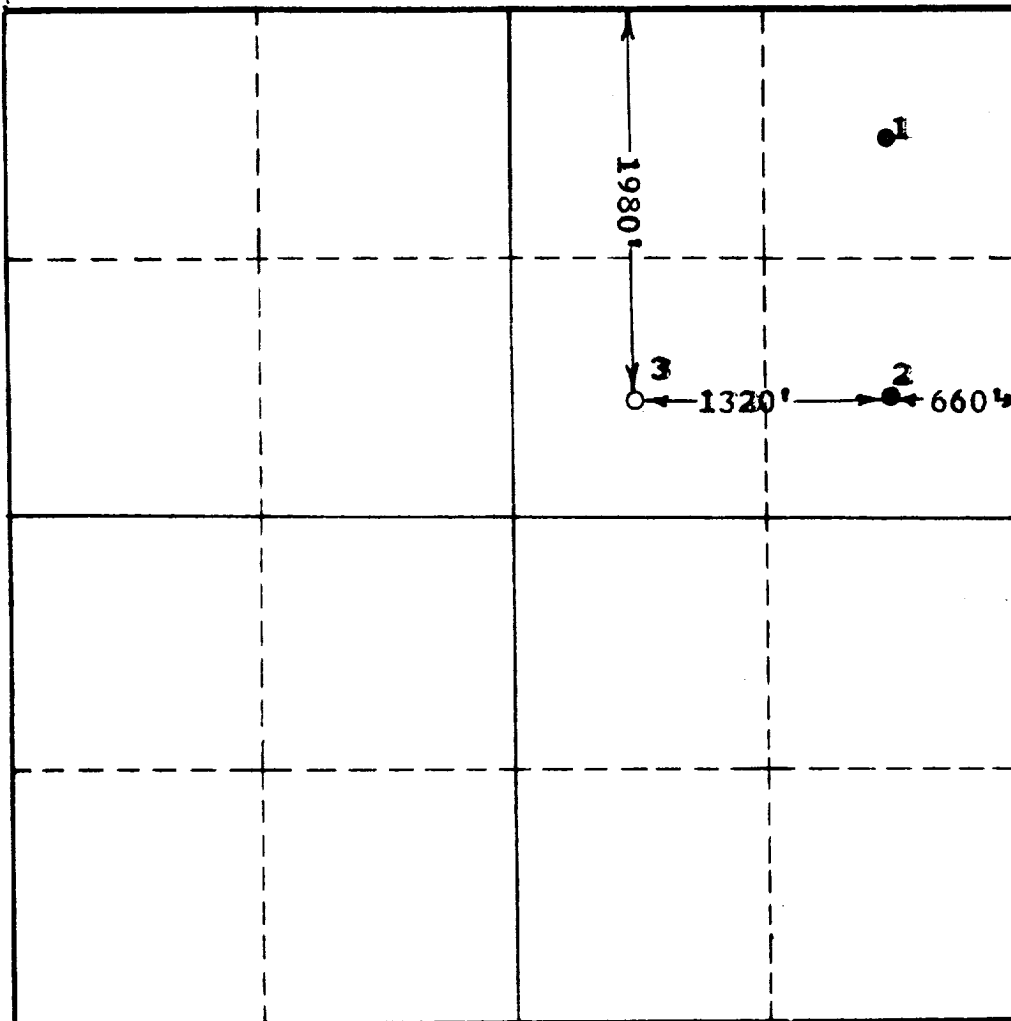

NOTE

This section of form is to be used for gas wells only.

1. Is this Well a Dual Comp. ? Yes      No     .
2. If the answer to Question 1 is yes, are there any other dually completed wells within the dedicated acreage ? Yes      No     .

Name \_\_\_\_\_  
Position \_\_\_\_\_  
Representing \_\_\_\_\_  
Address \_\_\_\_\_

This is to certify that the above plat was prepared from field notes of actual surveys made by me or under my supervision and that the same are true and correct to the best of my knowledge and belief.

Date Surveyed 6-13-1956  
John W. West  
Registered Professional Engineer and/or  
Land Surveyor