

APPROVED COPY TO O. C. C.

Form 9-381a
(Feb. 1961)

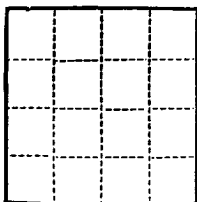

JAN 17 1962 (SUBMIT IN TRIPLICATE)

HOBAS

Budget Bureau No. 42-E358.4
Approval expires 12-31-60.
Las Cruces

E. W. STANDLEY
DISTRICT ENGINEER

UNITED STATES
DEPARTMENT OF THE INTERIOR
GEOLOGICAL SURVEY

Land Office
Lease No. **LC-054668**
Unit **Farnsworth 4**

SUNDRY NOTICES AND REPORTS ON WELLS

NOTICE OF INTENTION TO DRILL.....	<input checked="" type="checkbox"/>	SUBSEQUENT REPORT OF WATER SHUT-OFF.....	
NOTICE OF INTENTION TO CHANGE PLANS.....		SUBSEQUENT REPORT OF SHOOTING OR ACIDIZING.....	
NOTICE OF INTENTION TO TEST WATER SHUT-OFF.....		SUBSEQUENT REPORT OF ALTERING CASING.....	
NOTICE OF INTENTION TO RE-DRILL OR REPAIR WELL.....		SUBSEQUENT REPORT OF RE-DRILLING OR REPAIR.....	
NOTICE OF INTENTION TO SHOOT OR ACIDIZE.....		SUBSEQUENT REPORT OF ABANDONMENT.....	
NOTICE OF INTENTION TO PULL OR ALTER CASING.....		SUPPLEMENTARY WELL HISTORY.....	
NOTICE OF INTENTION TO ABANDON WELL.....			

(INDICATE ABOVE BY CHECK MARK NATURE OF REPORT, NOTICE, OR OTHER DATA)

January 15, 1962

Well No. **13** is located **990** ft. from **S** line and **1650** ft. from **E** line of sec. **4**
SW/4 of 4 **26-S** **37-E**
 (1/4 Sec. and Sec. No.) (Twp.) (Range) (Meridian)
Langlie-Mattix **Lea** **New Mexico**
 (Field) (County or Subdivision) (State or Territory)

The elevation of the derrick floor above sea level is _____ ft.

DETAILS OF WORK

(State names of and expected depths to objective sands; show sizes, weights, and lengths of proposed casings; indicate mudding jobs, cementing points, and all other important proposed work)

It is proposed to drill with Rotary Tools to the Seven Rivers-Queen formation at about 3500'. Set 8 5/8" casing @ 300' with cement circulated. If productive set 5 1/2" casing to total depth and cement with about 250 sacks, which gives a calculated fillup of 1,691'.

I understand that this plan of work must receive approval in writing by the Geological Survey before operations may be commenced.

Company **TEXAS PACIFIC COAL AND OIL COMPANY**

Address **P. O. Box 2110**

Fort Worth 1, Texas

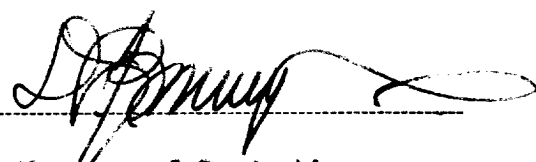
By 
Title **Manager of Production**

NEW MEXICO OIL CONSERVATION COMMISSION
WELL LOCATION AND ACREAGE DEDICATION PLAT

FORM C-128
Revised 5/1/57

SEE INSTRUCTIONS FOR COMPLETING THIS FORM ON THE REVERSE SIDE

SECTION A

Operator Texas Pacific Coal & Oil Company			Lease Cyrus M. Farnsworth		Well No. 13
Unit Letter 0	Section 4	Township 26 South	Range 37 East	County Lea	
Actual Footage Location of Well: 990 feet from the South line and 1650 feet from the East line					
Ground Level Elev. 2983.3	Producing Formation 7-Rivers - Queen		Pool Langlie Mattix		Dedicated Acreage: 40 Acres

1. Is the Operator the only owner in the dedicated acreage outlined on the plat below? YES _____ NO _____. ("Owner" means the person who has the right to drill into and to produce from any pool and to appropriate the production either for himself or for himself and another. (65-3-29 (e) NMSA 1953 Comp.)
2. If the answer to question one is "no," have the interests of all the owners been consolidated by communitization agreement or otherwise? YES _____ NO _____. If answer is "yes," Type of Consolidation _____
3. If the answer to question two is "no," list all the owners and their respective interests below:

Owner	Land Description

SECTION B

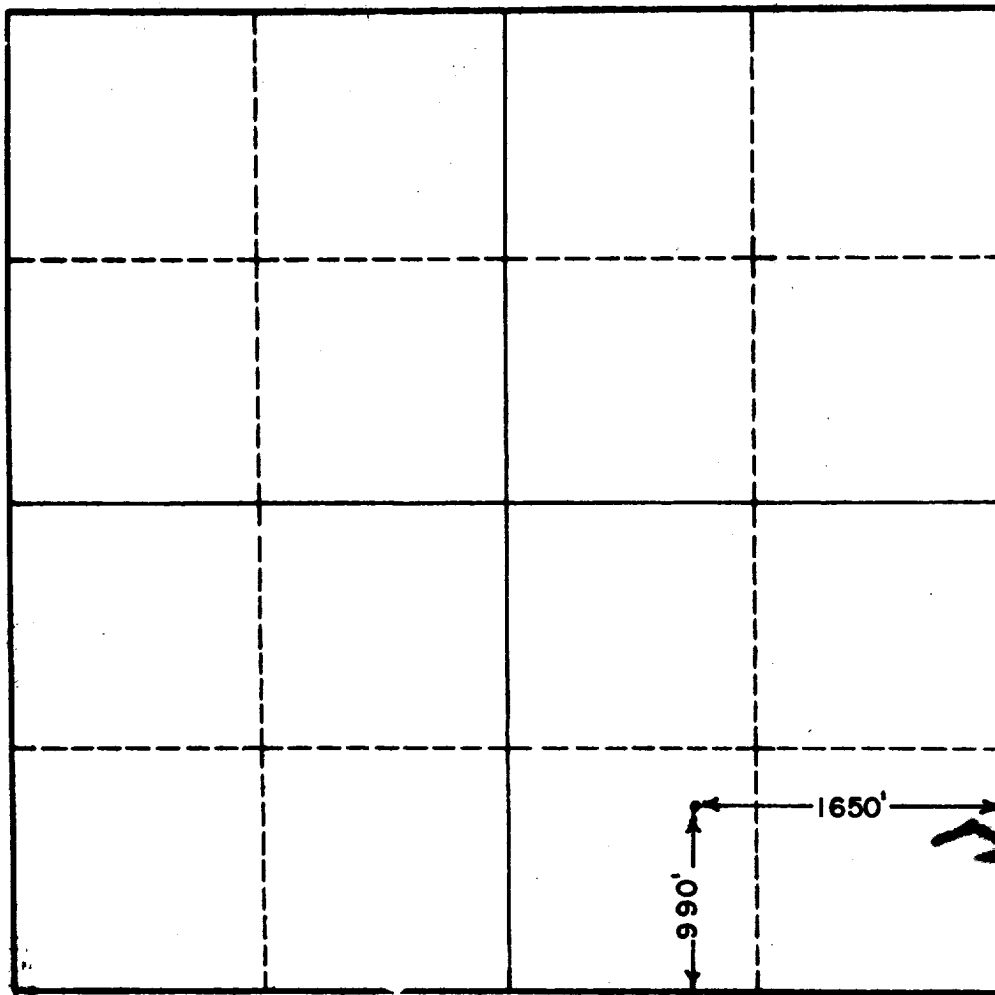

CERTIFICATION

I hereby certify that the information in SECTION A above is true and complete to the best of my knowledge and belief.

Name <i>[Signature]</i>
Position Manager of Production
Company TEXAS PACIFIC COAL AND OIL CO.
Date January 15, 1962

I hereby certify that the well location shown on the plat in SECTION B was plotted from field notes of actual surveys made by me under my supervision, and that the same is true and correct to the best of my knowledge and belief.

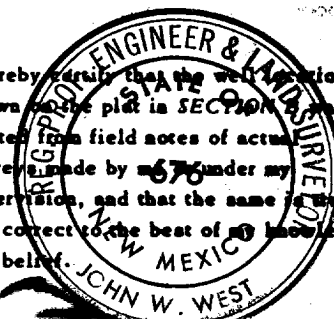

Date Surveyed 1-12-62
Registered Professional Engineer and/or Land Surveyor, JOHN W. WEST
<i>[Signature]</i>
Certificate No. N. M. - P. E. & L. S. NO. 676