

NEW MEXICO OIL CONSERVATION COMMISSION

Well Location and Acreage Dedication Plat

Section A.

Operator Pan American Pet. Corp. Lease U.S.A. Farnsworth 2 53
Well No. 7 Init letter C Section 4 Township 26 S Range 37 E NMPM
Located 660 Feet from North line, 1980 Feet from West line
County Lea U. S. Elevation furnish later Dedicated 50 Acres
Name of Producing Formation Devonian Pool Crosby Devonian

1. Is the Operator the only owner* in the dedicated acreage outlined on the plat below?
Yes x No .
2. If the answer to question one is "no," have the interests of all the owners been consolidated by communitization agreement or otherwise? yes If answer is "yes," Type of Consolidation
3. If the answer to question two is "no," list all the owners and their respective interests below:

Owner

Land Description

RECORDED

DEC 17 1958

U. S. GEOLOGICAL SURVEY

HOBBS, NEW MEXICO

Section B

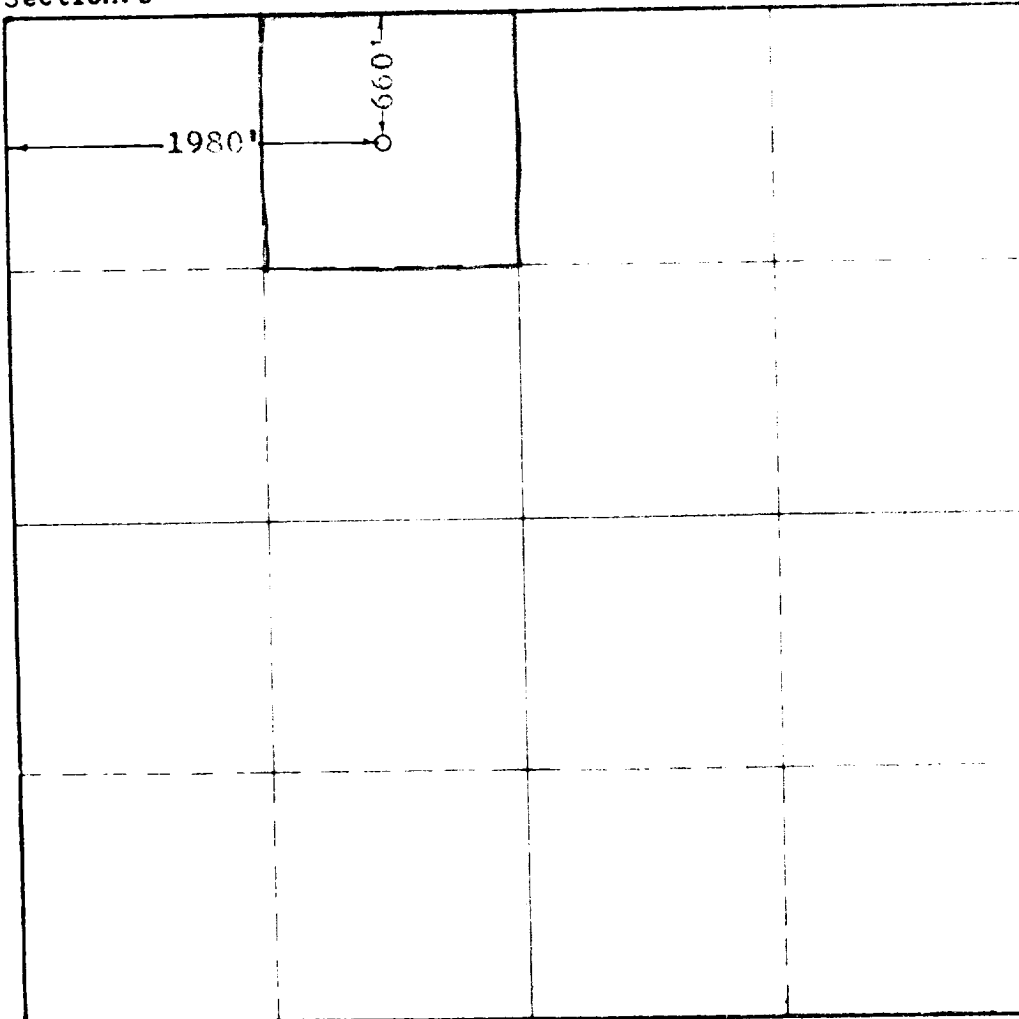

This is to certify that the information in Section A above is true and complete to the best of my knowledge and belief.

Pan American Petroleum Corporation
(Operator)

Ralph H. Huelshagen
(Representative) Fld. Supt.

Box 68 - Hobbs, New Mexico
Address

This is to certify that the well location shown on the plat in Section B was plotted from field notes of actual surveys made by me or under my supervision and that the same is true and correct to the best of my knowledge and belief.

Date Surveyed 12-4-58

John L. West
Registered Professional
Engineer and/or Land Surveyor.

Plat No. 676

(See instructions for completion of this plat on reverse side)

JOHN W. WEST ENGINEERING COMPANY

412 NORTH DAL PASO
HOBBS, NEW MEXICO

December 8, 1958

RECEIVED

DEC 17 1958

U. S. GEOLOGICAL SURVEY
HOBBS, NEW MEXICOPan American Pet. Corp.
Hobbs, New Mexico

Gentlemen:

On December 4, 1958, a survey was made to locate your U.S.A. Farnsworth "C" No. 7 Well location at a point 660 feet from the North line and 1980 feet from the West line of Section 4, Township 26 South, Range 37 East, Lea County, New Mexico.

A flag was set at the U.S.G.L.O. Quarter corner marker common to Sections 4 and 33 and the Transit was set up at the U.S.G.L.O. Section corner marker common to Sections 32, 33, 5 and 4. Thence chaining East from Transit 1980 feet and thence South 660 feet to location site of the U.S.A. Farnsworth "C" No. 7. As a check on our survey we chained West from location site 1980 feet and North 660 feet to the beginning of the survey, checking in within the allowable error for this survey.

I hereby certify that the foregoing survey was made in the field under my supervision, and that the same is true and correct to the best of my knowledge and belief.

Respectfully submitted,

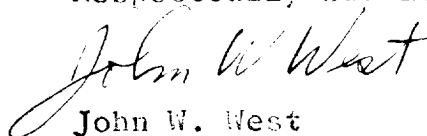
John W. West