

COUNTY LEA FIELD Jalmat (Oil) STATE NM OWDD
 OPR PAN AMERICAN PETROLEUM CORP. MAP
 3 Farnsworth, C. M. "B"
 Sec. 7, T-26-S, R-37-E
 1980' fr S Line & 1650' fr W Line of Sec. CO-ORD

Re-Cmp 9-25-65		CLASS		EL	
CSG & SX - TUBING		FORMATION	DATUM	FORMATION	DATUM
13" 297' 210					
9 5/8" 1167' 400					
7" 2705' 250					
4 1/2" lnr 2571-2878' 100					
LOGS EL GR RA IND HC A					
TD 3039'					

IP Yates OH 3019-39' Pmpd 32 BOPD + 292 BW. Pot. Based on 24 hr test.

Distribution limited and publication prohibited by subscribers' agreement.
 Reproduction rights reserved by Williams & Lee Scouting Service, Inc.

CONT.
 DATE

PROP DEPTH

TYPE

10-11-65 F.R.C. 10-14-65; OWDD, OTD 3025'
 Orig. comp from perfs 2826-46' in Jalmat (gas)
 TD 3039', COMPLETED.
 Deepened 3025-39'
 Set Pkr @ 3019'
 Ac. 200 gals. (OH 3019-39')

NEW MEXICO OIL CONSERVATION COMMISSION

FORM C-128
Revised 5/1/57

WELL LOCATION AND ACREAGE DEDICATION PLAT

SEE INSTRUCTIONS FOR COMPLETING THIS FORM ON THE REVERSE SIDE

HOBBS OFFICE OCC

SECTION A

Operator

Pan American Petroleum Corporation

Lease

G. H. Farnsworth "B"

1961 JUL 11 AM

Well No.

10 95

Unit Letter

Section

Township

Range

County

Actual Footage Location of Well:

1980

feet from the

South

line and

1650

feet from the

West

line

Ground Level Elev.

2959'

Producing Formation

Tater-Soren Rivers

Pool

Salmon

Dedicated Acreage:

4.1

Acres

1. Is the Operator the only owner in the dedicated acreage outlined on the plat below? YES ☒ NO ☐ . ("Owner" means the person who has the right to drill into and to produce from any pool and to appropriate the production either for himself or for himself and another. (65-3-29 (e) NMSA 1935 Comp.)
2. If the answer to question one is "no," have the interests of all the owners been consolidated by communization agreement or otherwise? YES ☐ NO ☐ . If answer is "yes," Type of Consolidation _____
3. If the answer to question two is "no," list all the owners and their respective interests below:

Owner

Land Description

SECTION B

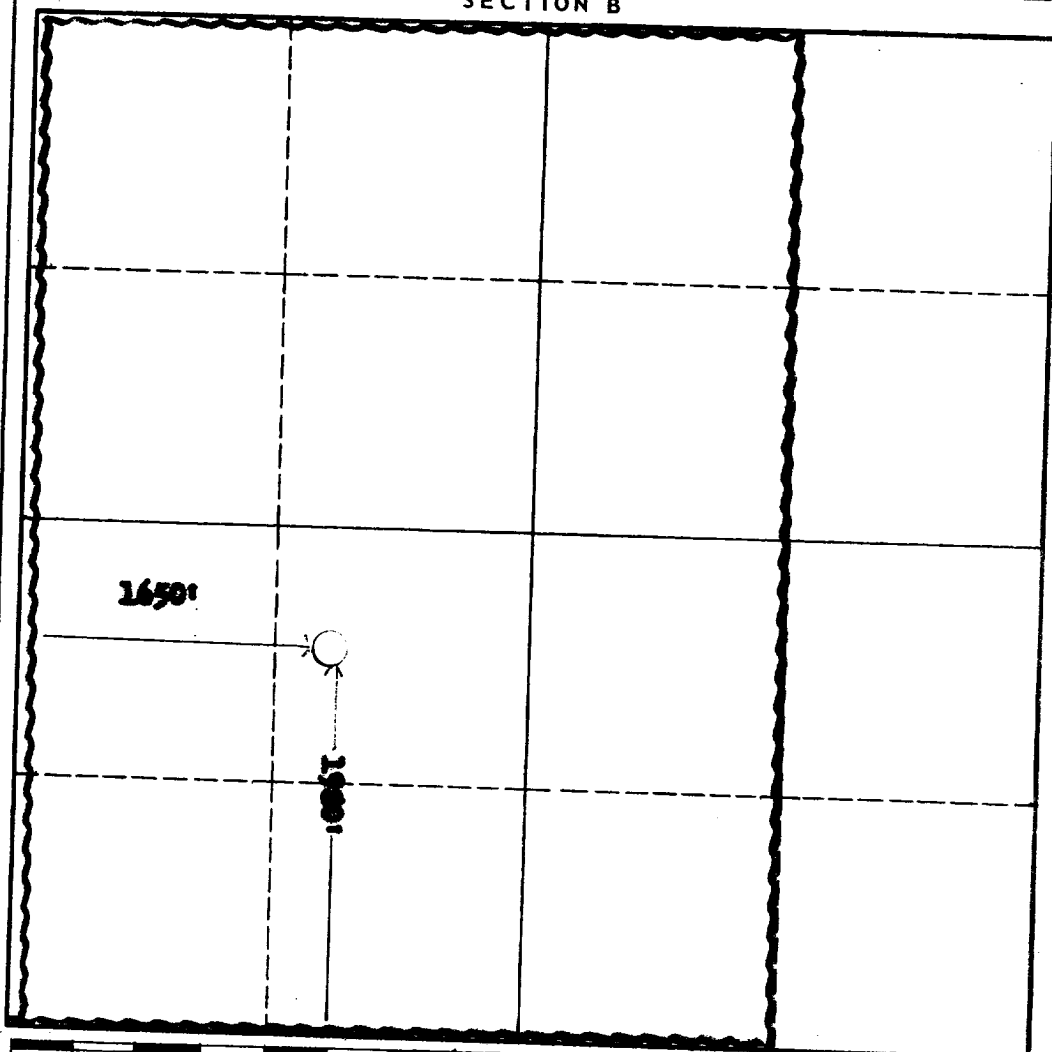

CERTIFICATION

I hereby certify that the information in SECTION A above is true and complete to the best of my knowledge and belief.

Name

Original Signed by:

V. E. STALEY

Position

Area Superintendent

Company

Pan American Petroleum Corp.

Date

February 16, 1961

I hereby certify that the well location shown on the plat in SECTION B was plotted from field notes of actual surveys made by me or under my supervision, and that the same is true and correct to the best of my knowledge and belief.

Date Surveyed

Registered Professional Engineer and/or Land Surveyor

Certificate No.

0 330 660 990 1320 1650 1980 2310 2640 2000 1500 1000 500 0

INSTRUCTIONS FOR COMPLETION OF FORM C-128

1. Operator shall furnish and certify to the information called for in Section A.
2. Operator shall outline the dedicated acreage for *both* oil and gas wells on the plat in Section B.
3. A registered professional engineer or land surveyor registered in the State of New Mexico or approved by the Commission shall show on the plat the location of the well and certify this information in the space provided.
4. All distances shown on the plat must be from the outer boundaries of the Section.
5. If additional space is needed for listing owners and their respective interests as required in question 3 of Section A, please use space below.