

Getty Oil Company

P.O. Box 730

Hobbs, New Mexico 88240

(505) 397-3571

Central Exploration and Production Division

November 29, 1983

Oil Conservation Commission
State of New Mexico
P.O. Box 2088
Santa Fe, NM 87501

Attention: Mr. Joe Ramey, Division Director

RE: Application for downhole commingling
Getty Oil Company
George D. Riggs "B" Lease, Well No. 8
Langlie Mattix Queen and Justis Blinebry Pools
Lea County, New Mexico

Gentlemen:

We respectfully request Administrative Approval for downhole commingling in the George D. Riggs Well No. 8. The subject well is a single completion to the Langlie Mattix Queen. In accordance with Commission Rule 303, Paragraph C, the following facts are submitted:

1. The well is located in Unit Letter B, Section 1, Township 26 South, Range 37 East, 330' FNL and 1650' FEL, on the G.D. Riggs Lease, Lea County, New Mexico. The pools to be downhole commingled are the Langlie Mattix Queen and the Justis Blinebry.
2. Acreage dedicated to this well is 40 acres, and a plat is attached showing the locations of well no. 8 and offset wells. Offsetting wells, aside from those on the Riggs Lease, are the Vinson Ramsay Lease by Gulf Oil Company. (See attached plat.).
3. The Langlie Mattix Queen produced 2 BOPD, 2 BWPD, and 17 MCFPD on October 20, 1983, from perforations at 3169-3292', (1 spf, selective). Production for the Justis Blinebry on May 12, 1983 was 4 BOPD, 40 BWPD, and 23 MCFPD from perforations at 5111-5402', (selective). Oil Conservation Commission Form C-116 is attached. Prior to downhole commingling, it is proposed to acidize the Blinebry zone and increase its potential to 8 BOPD and 66 BWPD. The combined daily oil production from the two zones before commingling will not exceed the limit of 30 BOPD specified in Section 1, Paragraph (a), Part (1). Total combined water production before commingling will exceed the aforementioned limit. Pumping equipment presently on location in the Langlie Mattix Queen has a potential of producing 97 barrels of fluid per day from 5410'. Thus, upon approval to downhole commingle, both zones will be effectively pumped down without any loss in total production due to cross-flow. (See attached analysis program.).

4. Attached is a production decline curve for both oil zones. The Blinebry zone exhibited a constant rate of decline until the recompletion into the Langlie Mattix Queen in June, 1983. Due to this recent completion, a constant decline rate for the Queen zone cannot be determined at this time. Future production from the Queen is anticipated to remain at current levels.
5. The Queen zone maintains a bottom hole pressure of 400 psi. A bottomhole pressure for the Blinebry is estimated to be 500 psi.
6. Getty Oil Company has received approval to surface commingle the two wellstreams on the Riggs Lease, (June 27, 1983), and has since encountered no problems in fluid incompatibility. By utilizing water analyses for both wellstreams, a computer compatibility program indicated no scaling tendencies in the subject well, (see attached computer analysis.). Therefore, no permanent reservoir damage should result from downhole commingling these two zones.
7. Both oil streams are sour crude and will not experience a loss in value upon downhole commingling.
8. Gulf Oil Company has been notified in writing of this proposed commingling.

Commingling downhole, as opposed to surface commingling, will yield significant reductions in equipment and operating costs. By utilizing pumping equipment with sufficient capacity to pump both zones, we request special consideration as per Rule 303-C for this Getty well.

Sincerely yours,

GETTY OIL COMPANY

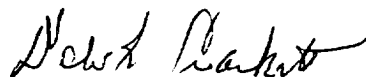

Dale R. Crockett
Area Superintendent

29d
SDB
BDB/ly

cc: NMOCD/Santa Fe (2)
NMOCD/Hobbs
BLM/Roswell
File

Getty Oil Company
G.D. Riggs "B" Lease
Lea County, N.M.

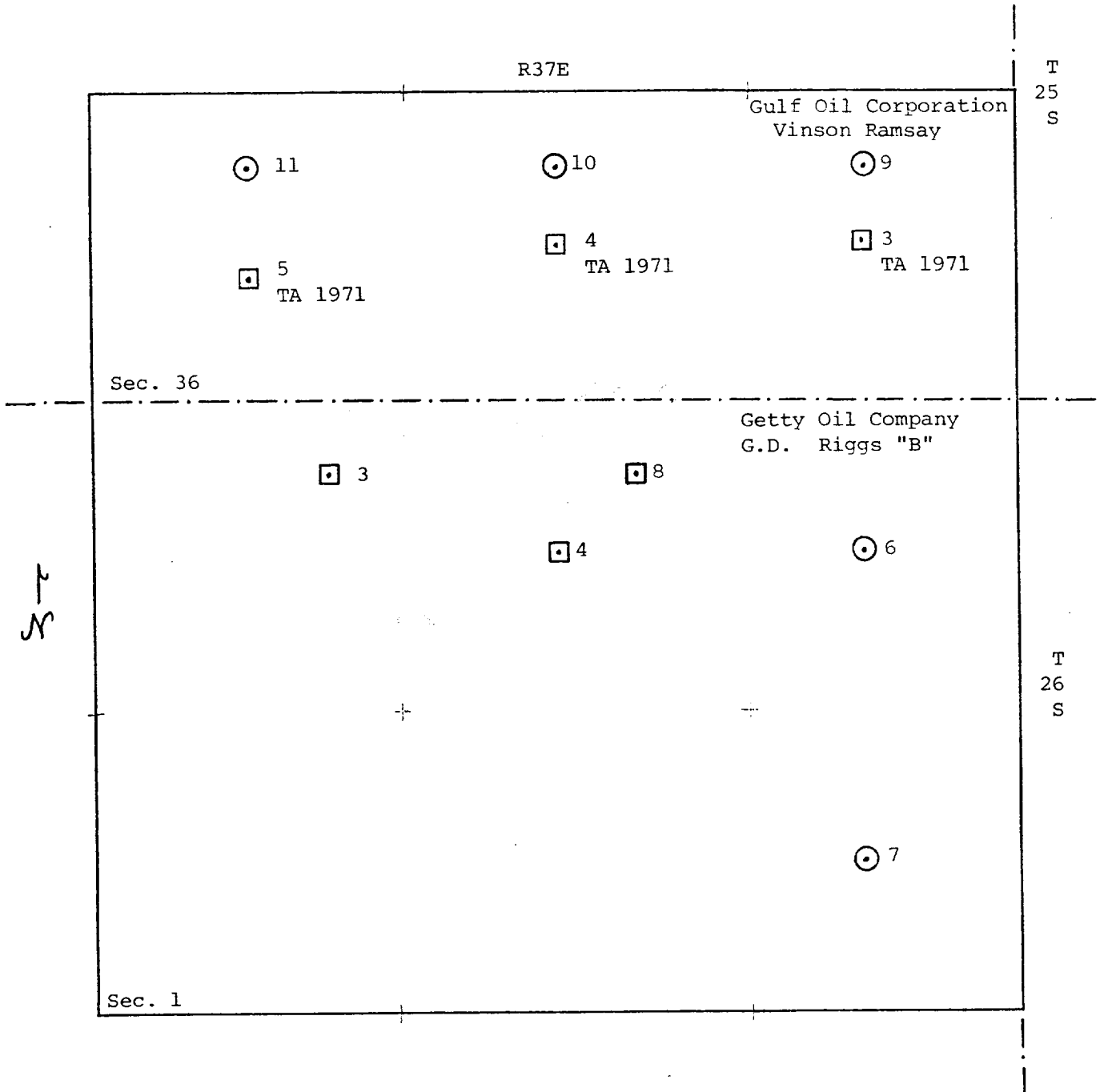

□ Langlie Mattix Queen Well

○ Justis Blinberry Well

— Section Line
40 acre spacing

G. D. Riggs "B" No. 8

Well Diagram

Justis Field

(All measurements taken from 3030' G.L.)

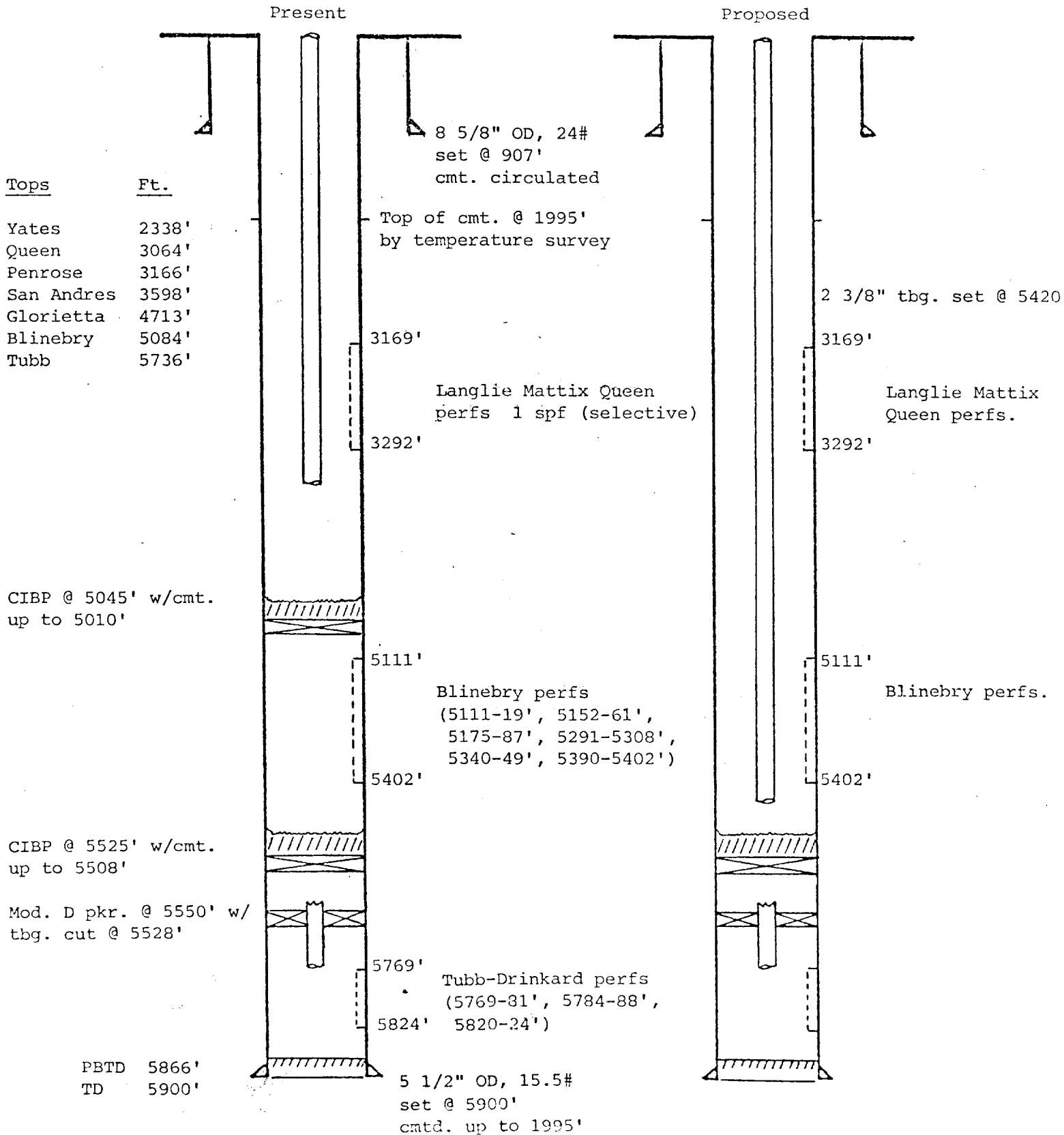

G. D. Riggs "B" Well No. 8

Well History

10-62. Well was completed to a total depth of 5900'. The Tubb zone was perforated with 2 spf @ 5769-81', 5784-88', and 5820-24'; followed by a treatment of 1000 gals. mud acid and 4000 gals. HCL acid. The zone potentialled on pump for 26 BOPD and 1 BWPD.

The Blinebry zone was also perforated with 2 spf at 5111-19', 5152-61', 5175-87', 5291-5308', 5340-49', and 5390-5402'. Subsequent treatment to the perfs. was 500 gals. of mud acid, 24,000 gals. of refined oil, and 44,000 lbs. of 20/40 sand. The zone potentialled for a natural flow of 80 BOPD and 35 BWPD on a 10/64" choke.

11-63. Pumping equipment was installed to the Blinebry zone.

2-66. Plugged and abandoned the Tubb zone after production had declined to 2 BOPD and 7 BWPD.

6-83. Temporarily abandoned the Blinebry zone and recompleted to the Langlie Mattix Queen zone with perforations of 1 spf at 3169-3292'. The perfs. were treated with 2500 gals. of 15% HCL acid and with a foam frac of 9450 gals. of nitrogen and 70,000 lbs. 12/20 sand. The zone potentialled for 2 BOPD, 18 BWPD, and 18 MCFPD.

BDB/sc

OIL CONSERVATION DIVISION
DISTRICT 1

OIL CONSERVATION DIVISION
P. O. BOX 2088
SANTA FE, NEW MEXICO 87501

DATE 12/21/83

RE: Proposed MC _____
Proposed DHC X _____
Proposed NSL _____
Proposed HSP _____
Proposed SWD _____
Proposed WFX _____
Proposed PMX _____

Gentlemen:

I have examined the application for the:

Betty Oil Co. G. D. Riggs B # 8-B 1-26-37
Operator Lease and Well No. Unit, S - T - R

and my recommendations are as follows:

OK - LS

Yours very truly,

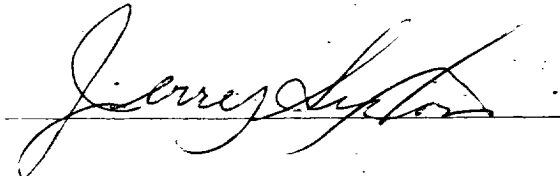

/mc