

NEW MEXICO OIL CONSERVATION COMMISSION
WELL LOCATION AND ACREAGE DEDICATION PLAT

Form O-1
Supersedes O-128
Effective 1-1-65

All distances must be from the outer boundaries of the Section

Owner El Paso Exploration Co.			Lease Elliott Federal		Well No. 2
Tract, Block D	Section 21	Township 26S	Range 37E	County Lea	
Approximate Location of Well: 660 feet from the North line and 660 feet from the West line Well Elev. 2973 Farm Name Yates-Seven Rivers Pool Rhodes Yates-Seven Rivers Oil Dedicated Acreage 40 Acres					

- Outline the acreage dedicated to the subject well by colored pencil or hachure marks on the plat below.
- If more than one lease is dedicated to the well, outline each and identify the ownership thereof (both as to working interest and royalty).
- If more than one lease of different ownership is dedicated to the well, have the interests of all owners been consolidated by communitization, unitization, force-pooling, etc?

☐ Yes ☐ No If answer is "yes," type of consolidation _____

If answer is "no," list the owners and tract descriptions which have actually been consolidated. (Use reverse side of this form if necessary.) _____

No allowable will be assigned to the well until all interests have been consolidated (by communitization, unitization, forced-pooling, or otherwise) or until a non-standard unit, eliminating such interests, has been approved by the Commission.

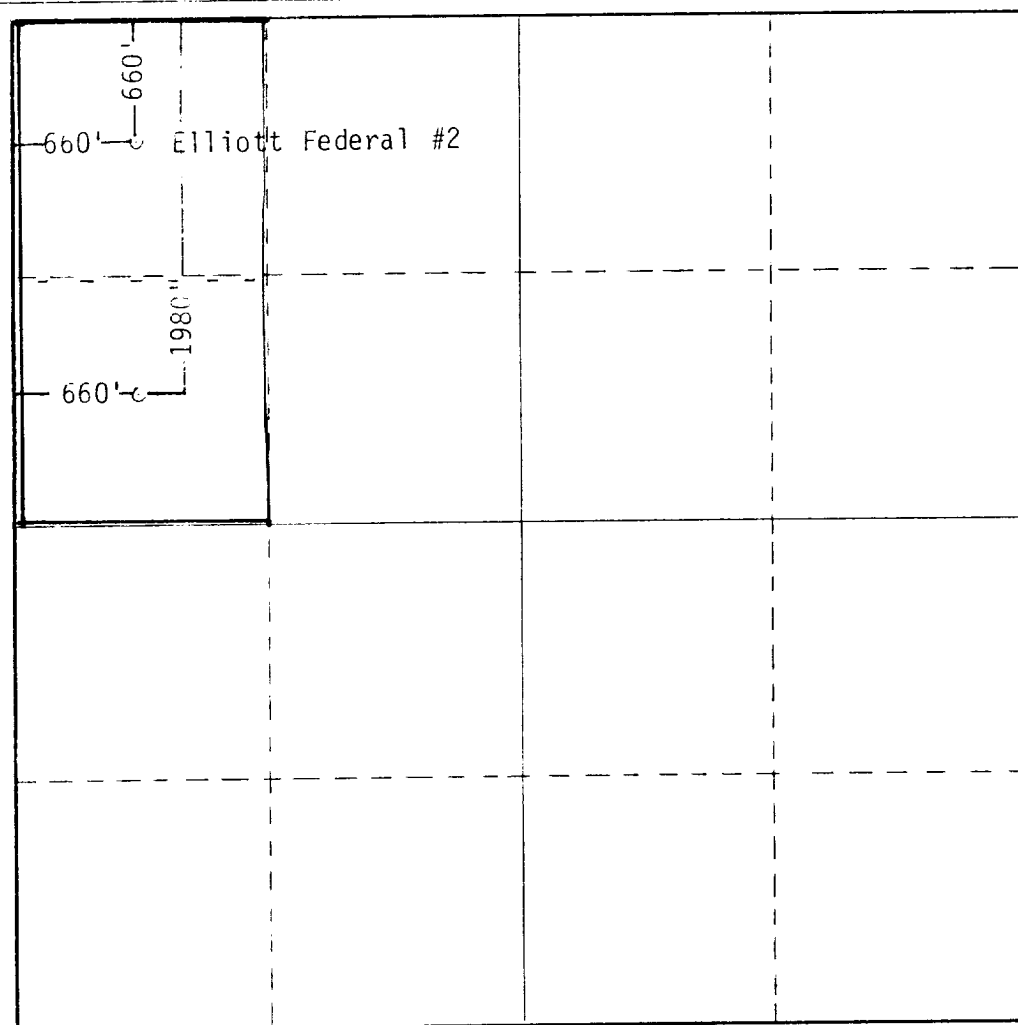

CERTIFICATION

I hereby certify that the information contained herein is true and complete to the best of my knowledge and belief.

C. J. Cilfone
Name

C. J. Cilfone

Position

Production Engineer

Company

El Paso Exploration Co.

Date

February 25, 1985

I hereby certify that the well location shown on this plat was plotted from field notes of actual surveys made by me or under my supervision, and that the same is true and correct to the best of my knowledge and belief.

Not Available

Date Surveyed

Registered Professional Engineer and/or Land Surveyor

Certificate No.

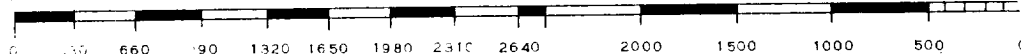

RECEIVED

FEB 26 1985

6524
POLICE OFFICE

ORDER - NSP-1292

NSP-1292

All distances must be from the outer boundaries of the Section.

EL PASO NATURAL GAS COMPANY			Lease Elliott Federal		Well No. 2
Unit Letter D	Section 21	Township 26 S	Range 37 E	County LEA	
Actual Footage Location of Well: 660 feet from the North line and 660 feet from the East line					
Ground Level Elev. 2973.0	Producing Formation YATES - 7 RIVERS		Pool RHODES YATES - 7 RIVERS		Dedicated Acreage 120 Acres

1. Outline the acreage dedicated to the subject well by colored pencil or hachure marks on the plat below.
2. If more than one lease is dedicated to the well, outline each and identify the ownership thereof (both as to working interest and royalty).
3. If more than one lease of different ownership is dedicated to the well, have the interests of all owners been consolidated by communitization, unitization, force-pooling, etc?

☐ Yes ☐ No If answer is "yes," type of consolidation _____

If answer is "no," list the owners and tract descriptions which have actually been consolidated. (Use reverse side of this form if necessary.) _____

No allowable will be assigned to the well until all interests have been consolidated (by communitization, unitization, forced-pooling, or otherwise) or until a non-standard unit, eliminating such interests, has been approved by the Commission.

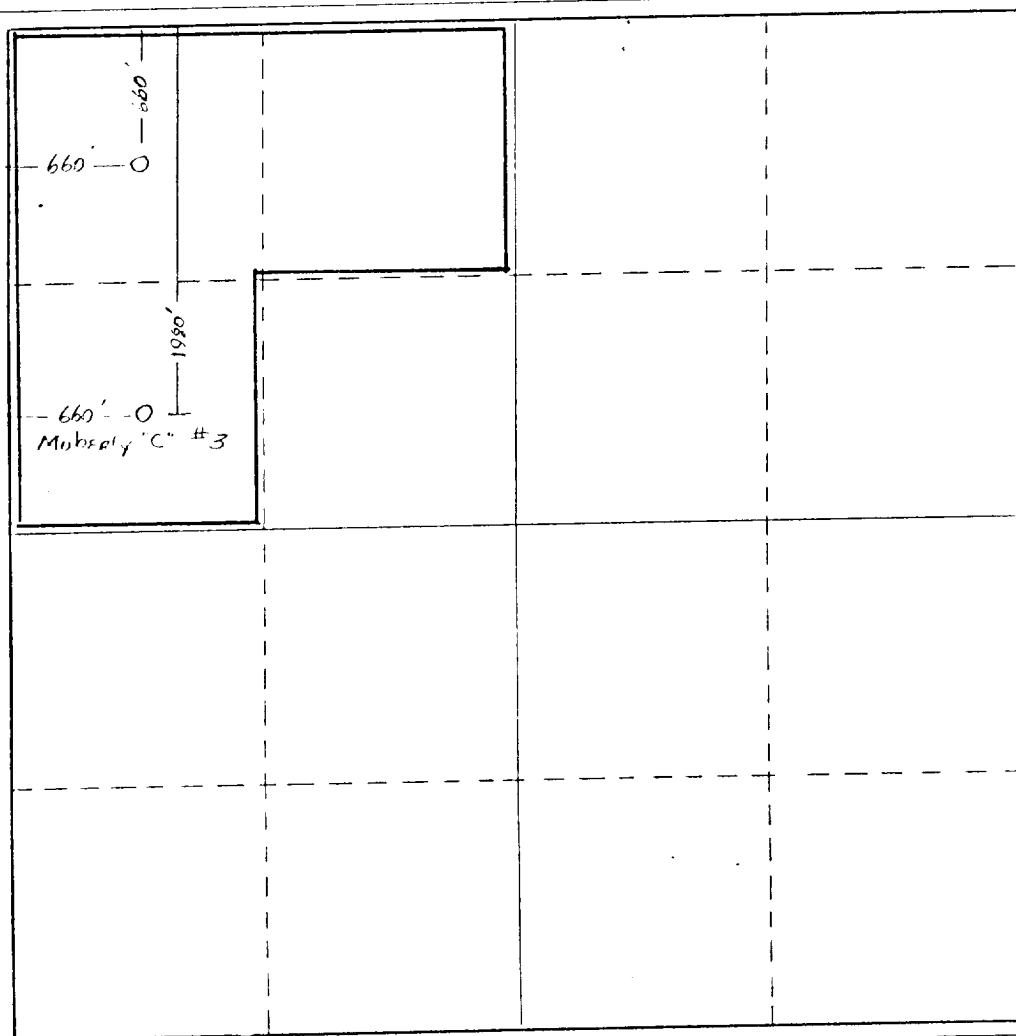

CERTIFICATION

I hereby certify that the information contained herein is true and complete to the best of my knowledge and belief.

John S. Delk
JOHN S. DELK

SUPERVISOR PROD. SVCS.

Company
EL PASO NATURAL GAS CO.

Date
MARCH 2, 1982

I hereby certify that the well location shown on this plat was plotted from field notes of actual surveys made by me or under my supervision, and that the same is true and correct to the best of my knowledge and belief.

Date Surveyed

Not Available

Registered Professional Engineer
and/or Land Surveyor

Certificate No.

0 330 660 990 1320 1650 1980 2310 2640 2000 1500 1000 500 0

NEW MEXICO
OIL CONSERVATION COMMISSION

Gas Well Plat

Date January 21, 1954
H. P. Hubbard ~~Hubbard~~ Elliott Federal 2
Operator Lease Well No.

Name of Producing Formation Yates Pool Jalco

No. Acres Dedicated to the Well 80 - Ground 10-473

SECTION	21	TOWNSHIP	26-S	RANGE	37-E

I hereby certify that the information given above is true and complete to the best of my knowledge.

Name L. B. Schlemmer
Position Superintendent
Representing H. P. Hubbard
Address 3102 Rogers Drive, Odessa,

(over)

INSTRUCTIONS

1. Is this gas well a dual completion? Yes No **X**
2. If the answer to Question 1 is Yes, are there any other dually completed wells within the dedicated acreage? Yes No

A separate plat must be filed for each gas well, outlining the area dedicated to such well and showing the location of all other wells (oil and gas) within the outlined area.

Mail in duplicate to the district office for the district in which the well is located.

