

**NEW MEXICO OIL CONSERVATION COMMISSION**  
**WELL LOCATION AND ACREAGE DEDICATION PLAT**

FORM C-128  
 Revised 5/1/57

**SEE INSTRUCTIONS FOR COMPLETING THIS FORM ON THE REVERSE SIDE**

**SECTION A**

Operator <b>CONTINENTAL OIL COMPANY</b>		Lesse <b>LEAVES B-30</b>		Well No. <b>4</b>
Unit Letter <b>O</b>	Section <b>30</b>	Township <b>26 SOUTH</b>	Range <b>37 EAST</b>	County <b>LEA</b>
Actual Postage Location of Well: <b>660</b> feet from the <b>SOUTH</b> line and <b>1650</b> feet from the <b>EAST</b> line				
Ground Level Elev.	Producing Formation <b>Texas A. Santa Elena</b>	Pool <b>Jalisco</b>	Dedicated Acreage: <b>40</b> Acres	

1. Is the Operator the only owner in the dedicated acreage outlined on the plat below? YES ☒ NO ☐ ("Owner" means the person who has the right to drill into and to produce from any pool and to appropriate the production either for himself or for himself and another. (65-3-29 (e) NMSA 1935 Comp.)
2. If the answer to question one is "no," have the interests of all the owners been consolidated by communization agreement or otherwise? YES ☐ NO ☐ If answer is "yes," Type of Consolidation \_\_\_\_\_
3. If the answer to question two is "no," list all the owners and their respective interests below:

Owner	Land Description

**SECTION B**

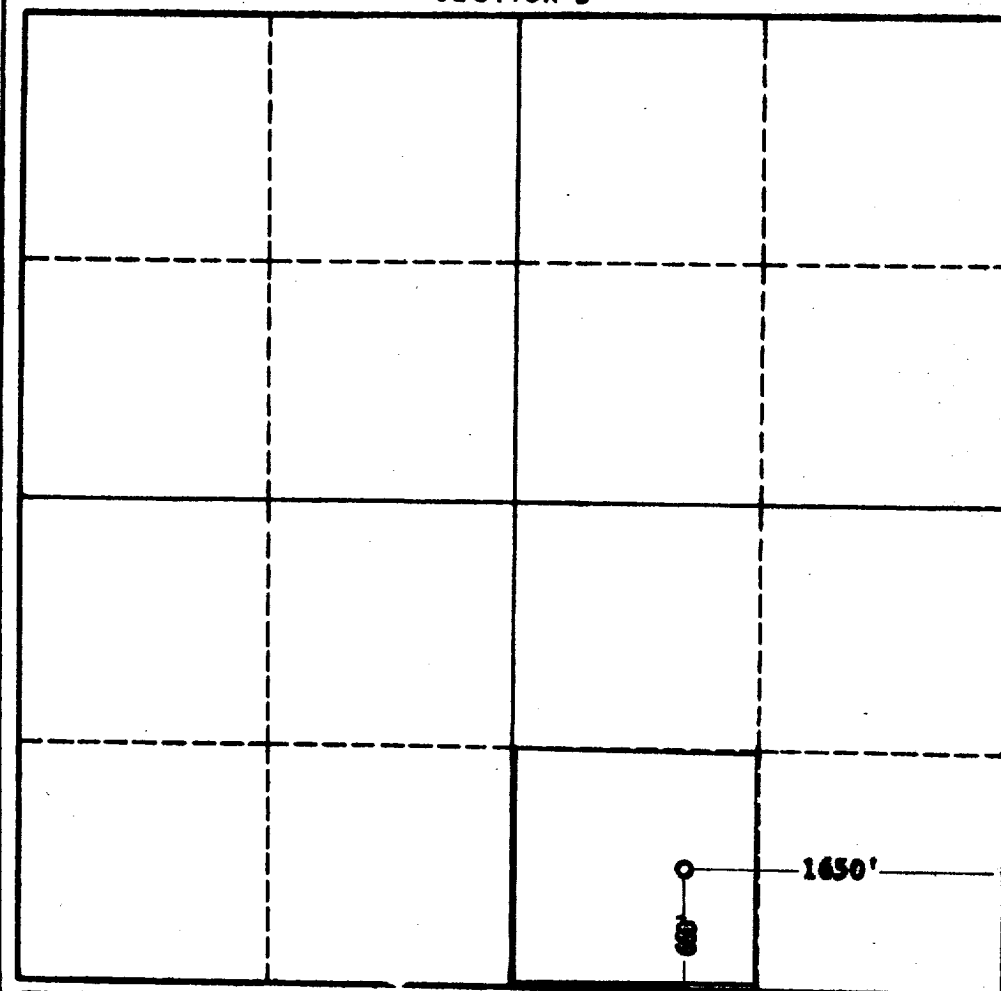

**CERTIFICATION**

I hereby certify that the information in SECTION A above is true and complete to the best of my knowledge and belief.

Name <i>J. R. Hall</i>
Position <b>District Superintendent</b>
Company <b>Continental Oil Company</b>
Date <b>7-10-62</b>

I hereby certify that the well location shown on the plat in SECTION B was plotted from field notes of actual surveys made by **676** under my supervision, and that the same is true and correct to the best of my knowledge and belief.

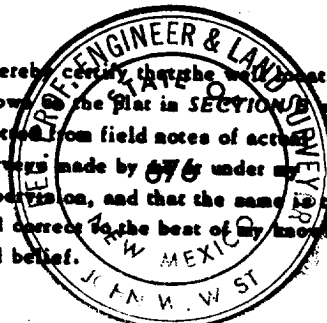

Date Surveyed <b>7-10-62</b>
Registered Professional Engineer and/or Land Surveyor, <b>JOHN W. WEST</b>
Certificate No. <i>John W. West</i> <b>N. M. - P. E. &amp; L. S. NO. 676</b>