

|                        |  |
|------------------------|--|
| NO. OF COPIES RECEIVED |  |
| DISTRIBUTION           |  |
| SANTA FE               |  |
| FILE                   |  |
| U.S.G.S.               |  |
| LAND OFFICE            |  |
| OPERATOR               |  |

5A. Indicate Type of Lease  
STATE ☒ FEE ☐  
5. State Oil & Gas Lease No.  
B-1732

APPLICATION FOR PERMIT TO DRILL, DEEPEN, OR PLUG BACK

1a. Type of Work  
b. Type of Well  
OIL WELL ☐ GAS WELL ☐ OTHER Water Injection well ☒ SINGLE ZONE ☒ MULTIPLE ZONE ☐  
2. Name of Operator  
Sirgo-Collier, Inc.  
3. Address of Operator  
P. O. Box 3531, Midland, Texas 79702  
4. Location of Well  
UNIT LETTER E LOCATED 1994 FEET FROM THE North LINE  
AND 330 FEET FROM THE West LINE OF SEC. 4 TWP. 25-S RGE. 38-E NMPM  
19. Proposed Depth  
4010'  
19A. Formation  
Queen  
20. Rotary or C.T.  
Rotary Re-enter  
21. Elevations (Show whether DF, RT, etc.)  
3150' GR  
21A. Kind & Status Plug. Bond  
Cash Statewide  
21B. Drilling Contractor  
22. Approx. Date Work will start  
January 28, 1988

PROPOSED CASING AND CEMENT PROGRAM

| SIZE OF HOLE | SIZE OF CASING | WEIGHT PER FOOT | SETTING DEPTH | SACKS OF CEMENT | EST. TOP |
|--------------|----------------|-----------------|---------------|-----------------|----------|
| 12-1/4"      | * 9-5/8"       | 36#             | 380'          | 300 sx          | Surface  |
| 8-3/4"       | * 7"           | 20#             | 3584'         | 650 sx          | Surface  |
| 6-1/8"       | 4-1/2"         | 10.5#           | TD            | 500 sx          | Surface  |

Sirgo-Collier, Inc. plans to re-enter, deepen to 4010' and convert to water injection this P&A (12-2-72) Queen producer. New 4-1/2" casing will be run to TD and cemented to surface, the Queen zone will be selectively perforated and acidized, and a Baker AD-1 packer will be run on 2-3/8" tubing, set approximately 100' above the top perf.

\* Casing already present in the wellbore.

ABOVE SPACE DESCRIBE PROPOSED PROGRAM: IF PROPOSAL IS TO DEEPEN OR PLUG BACK, GIVE DATA ON PRESENT PRODUCTIVE ZONE AND PROPOSED NEW PRODUCTIVE ZONE. GIVE BLOWOUT PREVENTER PROGRAM, IF ANY.  
I hereby certify that the information above is true and complete to the best of my knowledge and belief.

Signed Amy L. Whitley Title Agent Date December 14, 1987

(This space for State Use)

ORIGINAL SIGNED BY JERRY CEXTON

DISTRICT 1 SUPERVISOR

PROVED BY DLL TITLE DLL DATE DLL

CONDITIONS OF APPROVAL, IF ANY:

SUBJECT TO APPROVAL OF AUTHORITY TO INJECT

Permit Expires 6 Months From Approval  
Date Unless Drilling Underway.

NEW MEXICO OIL CONSERVATION COMMISSION  
WELL LOCATION AND ACREAGE DEDICATION PLAT

Form C-102  
Supersedes C-128  
Effective 1-1-65

All distances must be from the outer boundaries of the Section.

|   |                                     |                                 |  |                                       |                       |
|---|-------------------------------------|---------------------------------|--|---------------------------------------|-----------------------|
| Operator<br><b>Sirgo-Collier, Inc.</b>  |                                     |                                 | Lease:<br><b>West Dollarhide Queen Sand Unit</b> |                                       | Well No.<br><b>55</b> |
| Unit Letter<br><b>E</b>   | Section<br><b>4</b>                 | Township<br><b>25-S</b>         | Range<br><b>38-E</b>                             | County<br><b>Lea</b>                  |                       |
| Actual Footage Location of Well:  |                                     |                                 |  |                                       |                       |
| <b>1994</b> feet from the <b>North</b> line and <b>330</b> feet from the <b>West</b> line |                                     |                                 |  |                                       |                       |
| Ground Level Elev.<br><b>3150'</b>  | Producing Formation<br><b>Queen</b> | Pool<br><b>Dollarhide Queen</b> |  | Dedicated Acreage:<br><b>40</b> Acres |                       |

1. Outline the acreage dedicated to the subject well by colored pencil or hachure marks on the plat below.
2. If more than one lease is dedicated to the well, outline each and identify the ownership thereof (both as to working interest and royalty).
3. If more than one lease of different ownership is dedicated to the well, have the interests of all owners been consolidated by communitization, unitization, force-pooling, etc?

☒ Yes    ☐ No    If answer is "yes," type of consolidation Unitization, R-2356

If answer is "no," list the owners and tract descriptions which have actually been consolidated. (Use reverse side of this form if necessary.) \_\_\_\_\_

No allowable will be assigned to the well until all interests have been consolidated (by communitization, unitization, forced-pooling, or otherwise) or until a non-standard unit, eliminating such interests, has been approved by the Commission.

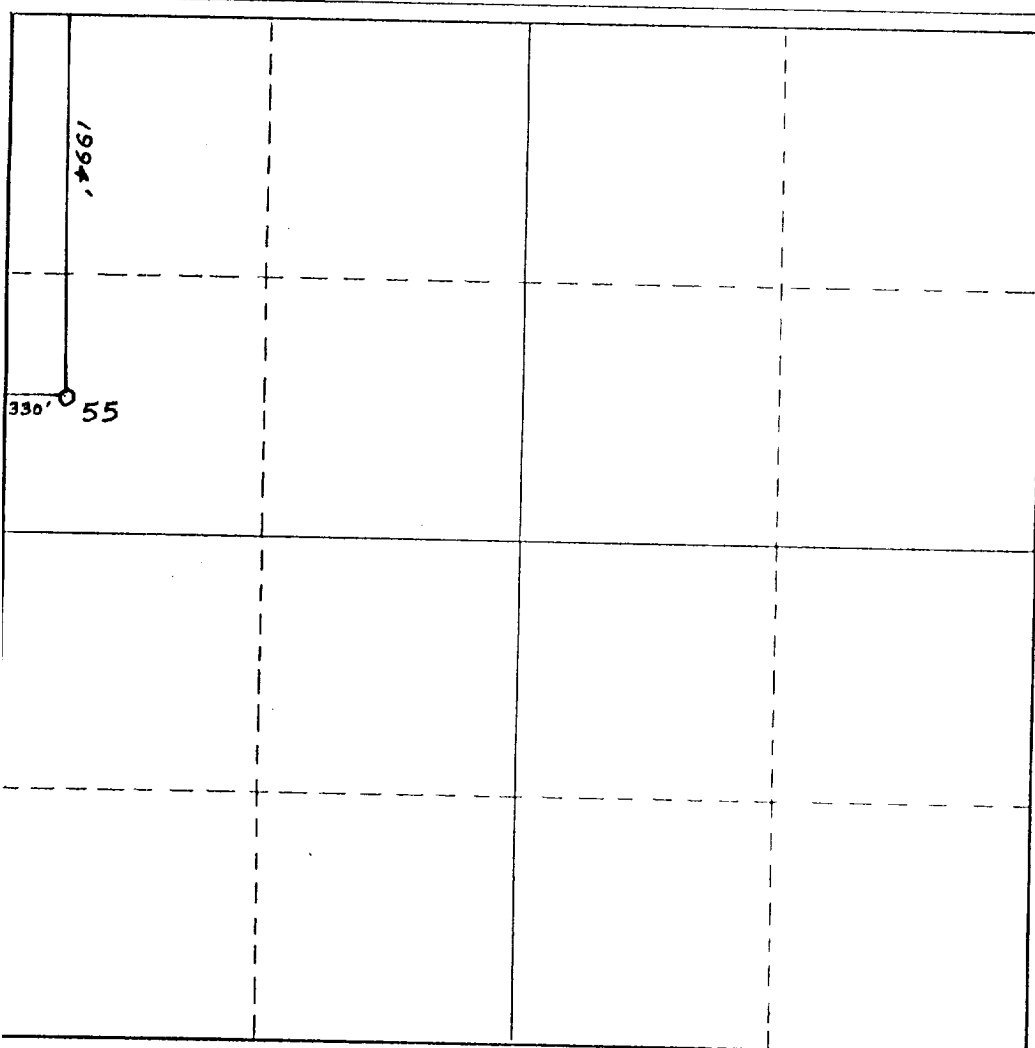

**CERTIFICATION**

*I hereby certify that the information contained herein is true and complete to the best of my knowledge and belief.*

*Amy L. Whitley*

Name  
**Amy L. Whitley**

Position  
**Agent**

Company  
**Sirgo-Collier, Inc.**

Date  
**December 18, 1987**

*I hereby certify that the well location shown on this plat was plotted from field notes of actual surveys made by me or under my supervision, and that the same is true and correct to the best of my knowledge and belief.*

Date Surveyed \_\_\_\_\_

Registered Professional Engineer  
and/or Land Surveyor

Certificate No. \_\_\_\_\_