

NO. OF COPIES RECEIVED	
DISTRIBUTION	
SANTA FE	
FILE	
U.S.G.S.	
LAND OFFICE	
OPERATOR	

NEW MEXICO OIL CONSERVATION COMMISSION

Form C-101
Revised 1-1-65

5A. Indicate Type of Lease	
STATE <input checked="" type="checkbox"/>	FEE <input type="checkbox"/>
5. State Oil & Gas Lease No.	
B-8312	
7. Unit Agreement Name	
Mexico "L"	
8. Farm or Lease Name	
Dollardhide Fusselman	
9. Well No.	
3	
10. Field and Pool, or Wildcat	
Dollardhide Fusselman	
12. County	
Lea	
18. Proposed Depth	19A. Formation
8380'	Fusselman
20. Rotary or C.T.	22. Approx. Date Work will start
Recompletion Unit	ASAP

APPLICATION FOR PERMIT TO DRILL, DEEPEN, OR PLUG BACK

1a. Type of Work	
b. Type of Well	
DRILL <input type="checkbox"/>	DEEPEN <input type="checkbox"/>
OIL WELL <input checked="" type="checkbox"/>	GAS WELL <input type="checkbox"/>
2. Name of Operator	
Getty Oil Company	
3. Address of Operator	
P. O. Box 1351, Midland, Texas 79702	
4. Location of Well	
UNIT LETTER B	LOCATED 160'
FEET FROM THE	LINE
AND 1980	FEET FROM THE East
LINE OF SEC. 5	TWP. 28N
RGE. 33E	NMPM
15. Proposed Depth	
8380'	
19A. Formation	
Fusselman	
20. Rotary or C.T.	
Recompletion Unit	
21. Elevations (Show whether DF, RT, etc.)	
3168' DF	
21A. Kind & Status Plug. Bond	
Blanket Bond	
21B. Drilling Contractor	
22. Approx. Date Work will start	
ASAP	

PROPOSED CASING AND CEMENT PROGRAM

SIZE OF HOLE	SIZE OF CASING	WEIGHT PER FOOT	SETTING DEPTH	SACKS OF CEMENT	EST. TOP
No Change					

1. Move in workover rig. Pull rods and tubing.
2. Set Bridge Plug at \pm 8400' with cement on top, plugging back to \pm 8380' PBED.
3. Run GR-Neutron log 8250-8350'.
4. Perforate 5-1/2" OD casing 8298-8304' with 12 shots, 8305-8310' with 8 shots, 8311-8315' with 8 shots, total of 28 shots.
5. Treat perms. 8298-8315' with 6000 gallons 15% HCl acid in 3 stages using ball sealers.
6. Return well to producing status, pumping Fusselman perms. 8298-8315'.

Getty Oil Company is currently in the process of obtaining a hearing to allow exception to Rule 104, Oil Conservation Commission Rules and Regulations, to produce two wells from the same 40 acre proration unit with production limited to one top allowable for this proration unit.

IN ABOVE SPACE DESCRIBE PROPOSED PROGRAM: IF PROPOSAL IS TO DEEPEN OR PLUG BACK, GIVE DATA ON PRESENT PRODUCTIVE ZONE AND PROPOSED NEW PRODUCTION ZONE. GIVE BLOWOUT PREVENTER PROGRAM, IF ANY.

hereby certify that the information above is true and complete to the best of my knowledge and belief.

Signed AUDRA B. GARY Audra B. Gary Title District Production Manager Date May 9, 1977

(This space for State Use) Orig. Signed by

Jerry Sexton

Dist 1, Supv. TITLE

APPROVED BY

CONDITIONS OF APPROVAL, IF ANY:

DATE

MAY 16 1977

RECEIVED

1977 1977

OIL CONSERVATION

HUBBS, N. M. 2000

NEW MEXICO OIL CONSERVATION BOARD
WELL LOCATION AND ACREAGE PLAT

SPON
PLAT

Form C-102
Supersedes C-128
Effective 1-1-65

All distances must be from the center of the well.

Operator Getty Oil Company			Lease Mexico "L"			Well No. 3		
Unit Letter B	Section 5	Township 25S	Range 38E			County Lea		
Actual Footage Location of Well: 660 feet from the North line and 1980 feet from the East line								
Ground Level Elev. 3168' DF		Producing Formation Fusselman		Dedicated Acreage Dollarhide Fusselman			40.40 Acres	

1. Outline the acreage dedicated to the subject well by colored lines and square marks on the plat below.
2. If more than one lease is dedicated to the well, outline each lease and the ownership thereof (both as to working interest and royalty).
3. If more than one lease of different ownership is dedicated to the well, outline the interests of all owners herein consolidated by communitization, unitization, force-pooling, etc?

☐ Yes ☐ No If answer is "yes," type of consolidation _____

If answer is "no," list the owners and tract descriptions which have been consolidated. (Use reverse side of this form if necessary.) _____

No allowable will be assigned to the well until all interests have been consolidated (by communitization, unitization, forced-pooling, or otherwise) or until a non-standard unit, if approved by the Commission, has been approved by the Commission.

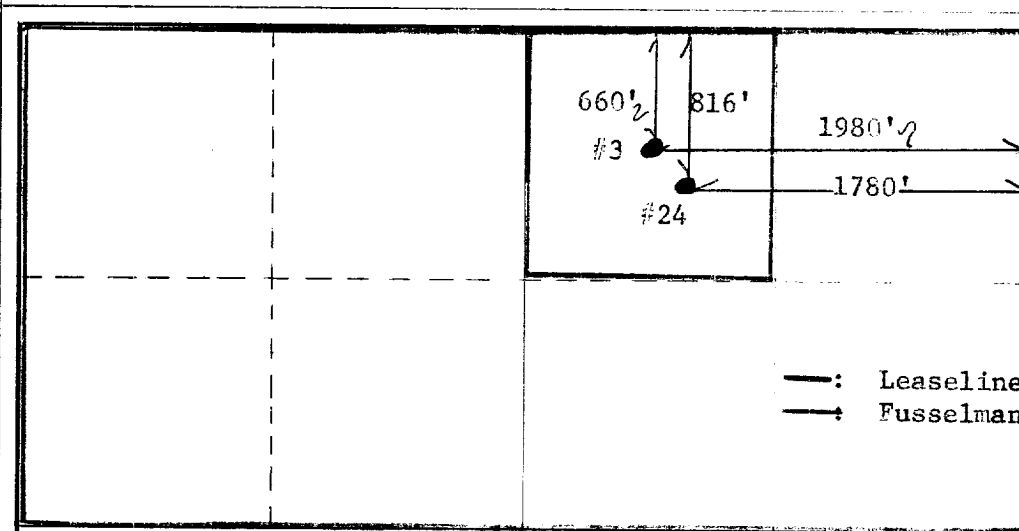

CERTIFICATION

I hereby certify that the information contained herein is true and complete to the best of my knowledge and belief.

(SIGNED) AUDRA B. CARY

Audra B. Cary

District Production Manager

Company
Getty Oil Company

Date
May 9, 1977

I hereby certify that the well location shown on this plat was plotted from field notes of actual surveys made by me or under my supervision, and that the same is true and correct to the best of my knowledge and belief.

Date Surveyed _____

Registered Professional Engineer
Mining and Surveying

Certificate No. _____

0 330 660 990 1320 1650 1980 2310 2640 2970 3300 3630 3960 4290 4620 4950 5280 5610 5940 6270 6600

12-1-77

OIL COMSTIVA. - V COMM.
HOBBS. N. M.