

Submit to Appropriate  
District Office  
State Lease - 6 copies  
Fee Lease - 5 copies

State of New Mexico  
Energy, Minerals and Natural Resources Department

Form C-101  
Revised 1-1-89

OIL CONSERVATION DIVISION

DISTRICT I  
P.O. Box 1980, Hobbs, NM 88240

P.O. Box 2088  
Santa Fe, New Mexico 87504-2088

DISTRICT II  
P.O. Drawer DD, Artesia, NM 88210

DISTRICT III  
1000 Rio Brazos Rd., Aztec, NM 87410

API NO. (assigned by OCD on New Wells)
30-025-12370
5. Indicate Type of Lease STATE <input checked="" type="checkbox"/> FEE <input type="checkbox"/>
6. State Oil & Gas Lease No. B-9312

APPLICATION FOR PERMIT TO DRILL, DEEPEN, OR PLUG BACK					
1a. Type of Work: DRILL <input type="checkbox"/> RE-ENTER <input checked="" type="checkbox"/> DEEPEN <input checked="" type="checkbox"/> PLUG BACK <input type="checkbox"/>			7. Lease Name or Unit Agreement Name West Dollarhide Queen Sand Unit		
b. Type of Well: OIL WELL <input type="checkbox"/> GAS WELL <input type="checkbox"/> OTHER <input type="checkbox"/> WIW <input type="checkbox"/> SINGLE ZONE <input checked="" type="checkbox"/> MULTIPLE ZONE <input type="checkbox"/>					
2. Name of Operator Sirgo Operating, Inc.			8. Well No. 59		
3. Address of Operator P.O. Box 3531, Midland, Texas 79702			9. Pool name or Wildcat Dollarhide Queen		
4. Well Location Unit Letter <u>E</u> : <u>1942</u> Feet From The <u>North</u> Line and <u>660</u> Feet From The <u>West</u> Line Section <u>5</u> Township <u>25S</u> Range <u>38E</u> NMPM <u>Lea</u> County					
10. Proposed Depth 4000'		11. Formation Queen		12. Rotary or C.T. Reverse	
13. Elevations (Show whether DF, RT, GR, etc.) 3121' DF		14. Kind & Status Plug. Bond Cash Statewide		15. Drilling Contractor Peterson Drlg.	
16. Approx. Date Work will start June 1989					
17. PROPOSED CASING AND CEMENT PROGRAM					
SIZE OF HOLE	SIZE OF CASING	WEIGHT PER FOOT	SETTING DEPTH	SACKS OF CEMENT	EST. TOP
12-1/4"	* 9-5/8"	36#	1171'	400	unknown
8-3/4"	* 7"	20#	3605'	250	unknown
6-1/8"	4-1/2"	10.50#	TD	400	surface

Sirgo Operating, Inc. plans to re-enter and deepen to 4000' this P&A (12-29-72) Queen water injection well. New 4-1/2" casing will be run to TD and cemented to surface, the Queen zone will be selectively perforated and acidized, and a Baker AD-1 packer will be run on 2-3/8" tubing, set approximately 100' above the top perf.

\*Casing already in wellbore.

IN ABOVE SPACE DESCRIBE PROPOSED PROGRAM: IF PROPOSAL IS TO DEEPEN OR PLUG BACK, GIVE DATA ON PRESENT PRODUCTIVE ZONE AND PROPOSED NEW PRODUCTIVE ZONE. GIVE BLOWOUT PREVENTER PROGRAM, IF ANY.

I hereby certify that the information above is true and complete to the best of my knowledge and belief.

SIGNATURE Bonnie Atwater TITLE Production Technician DATE 5-30-89

TYPE OR PRINT NAME

TELEPHONE NO.

(This space for State Use) ORIGINAL SIGNED BY JERRY SEXTON  
DISTRICT I SUPERVISOR

JUN 1 1989

APPROVED BY \_\_\_\_\_ TITLE \_\_\_\_\_ DATE \_\_\_\_\_

CONDITIONS OF APPROVAL, IF ANY:

Permit Expires 6 Months From Approval  
Date Unless Drilling Underway.

Submit to Appropriate  
District Office  
State Lease - 4 copies  
Fee Lease - 3 copies

State of New Mexico  
Energy, Minerals and Natural Resources Department

Form C-102  
Revised 1-1-89

OIL CONSERVATION DIVISION

P.O. Box 2088  
Santa Fe, New Mexico 87504-2088

DISTRICT I  
P.O. Box 1980, Hobbs, NM 88240

DISTRICT II  
P.O. Drawer DD, Artesia, NM 88210

DISTRICT III  
1000 Rio Brazos Rd., Aztec, NM 87410

WELL LOCATION AND ACREAGE DEDICATION PLAT

All Distances must be from the outer boundaries of the section

Operator <b>Sirgo Operating, Inc.</b>			Lease <b>West Dollarhide Queen Sand Unit</b>		Well No. <b>59</b>
Unit Letter <b>E</b>	Section <b>5</b>	Township <b>25S</b>	Range <b>38E</b>	County <b>NMPM Lea</b>	
Actual Footage Location of Well: <b>1942</b> feet from the <b>North</b> line and <b>660</b> feet from the <b>West</b> line					
Ground level Elev. <b>3121' DF</b>		Producing Formation <b>Queen</b>		Pool <b>Dollarhide Queen</b>	Dedicated Acreage: <b>40 Acres</b>

1. Outline the acreage dedicated to the subject well by colored pencil or hatchure marks on the plat below.

2. If more than one lease is dedicated to the well, outline each and identify the ownership thereof (both as to working interest and royalty).

3. If more than one lease of different ownership is dedicated to the well, have the interest of all owners been consolidated by communitization, unitization, force-pooling, etc.?

☒ Yes

☐ No

If answer is "yes" type of consolidation Unitization R-2356

If answer is "no" list the owners and tract descriptions which have actually been consolidated. (Use reverse side of this form if necessary.)

No allowable will be assigned to the well until all interests have been consolidated (by communitization, unitization, forced-pooling, or otherwise) or until a non-standard unit, eliminating such interest, has been approved by the Division.

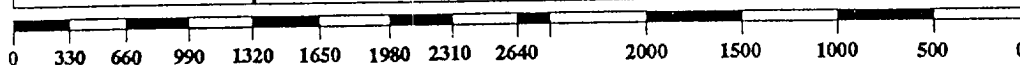
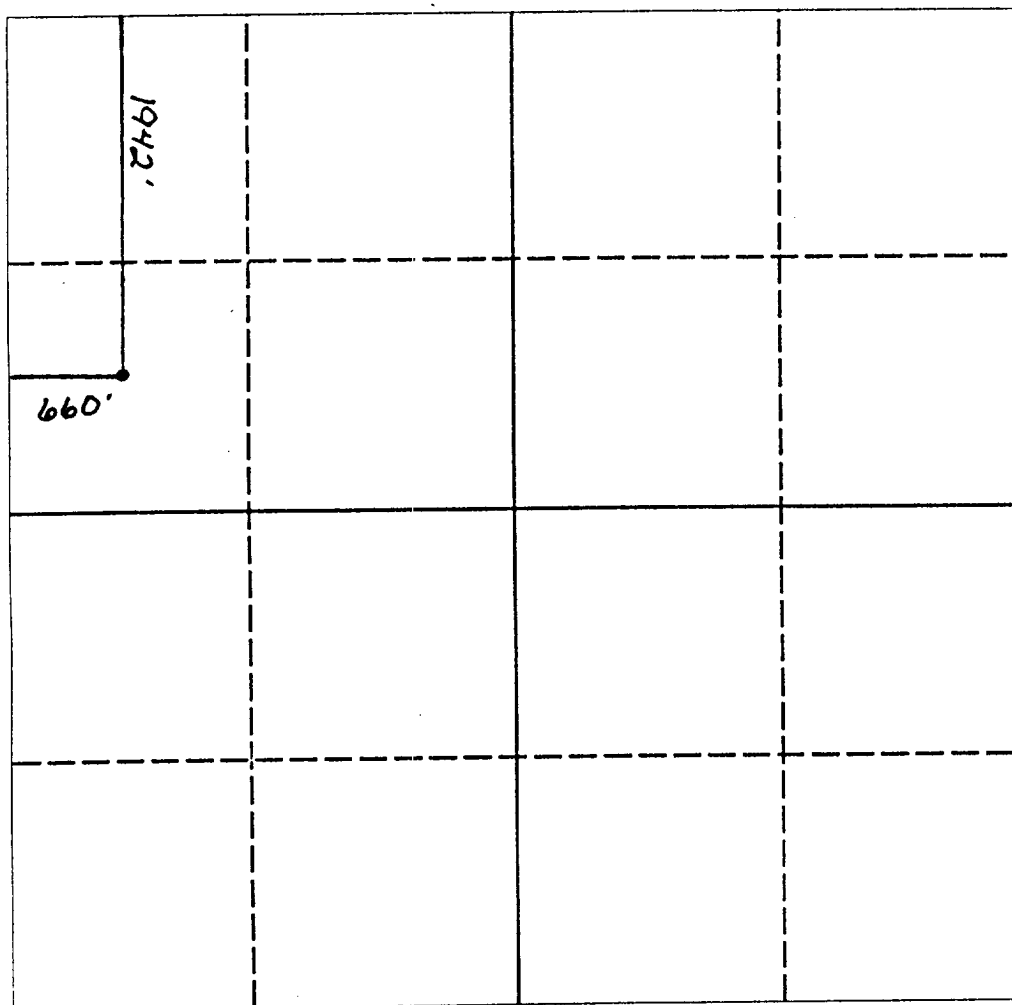

OPERATOR CERTIFICATION

I hereby certify that the information contained herein is true and complete to the best of my knowledge and belief.

Signature

*Bonnie Atwater*

Printed Name

Bonnie Atwater

Position

Production Technician

Company

Sirgo Operating, Inc.

Date

5-30-89

SURVEYOR CERTIFICATION

I hereby certify that the well location shown on this plat was plotted from field notes of actual surveys made by me or under my supervision, and that the same is true and correct to the best of my knowledge and belief.

Date Surveyed

ORIGINAL ON FILE.

Signature & Seal of  
Professional Surveyor

Certificate No.

# BOP

