

Submit to Appropriate
District Office
State Lease -- 6 copies
For Lease -- 5 copies

State of New Mexico
Energy, Minerals and Natural Resources Department

Form C-101
Revised 1-1-89

OIL CONSERVATION DIVISION

DISTRICT I
P.O. Box 1980, Hobbs, NM 88240

DISTRICT II
P.O. Drawer DD, Artesia, NM 88210

DISTRICT III
1000 Rio Brazos Rd., Aztec, NM 87410

P.O. Box 2088
Santa Fe, New Mexico 87504-2088

API NO. (assigned by OCD on New Wells)

30-025 12375

5. Indicate Type of Lease

STATE ☒

FEE ☐

6. State Oil & Gas Lease No.

B-9317

APPLICATION FOR PERMIT TO DRILL, DEEPEN, OR PLUG BACK

1a. Type of Work:

DRILL ☐

RE-ENTER ☐

DEEPEN ☐

PLUG BACK ☒

b. Type of Well:

OIL
WELL ☒

GAS
WELL ☐

OTHER ☐

SINGLE
ZONE ☒

MULTIPLE
ZONE ☐

7. Lease Name or Unit Agreement Name

Mexico "L"

2. Name of Operator

Texaco Producing Inc.

8. Well No.

11

3. Address of Operator

P. O. Box 728, Hobbs, New Mexico 88240

9. Pool name or Wildcat

Dollarhide Devonian

4. Well Location

Unit Letter C : 516 Feet From The North Line and 2130 Feet From The West Line

Section 5 Township 25-S Range 38-E NMPM Lea County

10. Proposed Depth

PBTD 8185

11. Formation

Devonian

12. Rotary or C.T.

Pulling Unit

13. Elevations (Show whether DF, RT, GR, etc.)

3133 GR

14. Kind & Status Plug. Bond

Blanket

15. Drilling Contractor

16. Approx. Date Work will start

May 25, 1989

17.

PROPOSED CASING AND CEMENT PROGRAM

SIZE OF HOLE	SIZE OF CASING	WEIGHT PER FOOT	SETTING DEPTH	SACKS OF CEMENT	EST. TOP
18"	13-3/8"	36# & 48#	250'	250	Circulated
12-1/4"	9-5/8"	36#	3150'	1800	250'
	5-1/2"	17#	8490'	1210	3150'

1. MIRU. Install BOP.
2. Pull tubing to 7570'. Spot 100 gallons 10% acetic acid.
3. Pull tubing out of hole.
4. Perf w/2 JPF: 7514'-30', 7533'-38', 7541'-44'.
5. GIH w/packer, set at 7475'. Acidize w/4000 gallons 15% NE acid.
6. Pull packer out of hole.
7. Run production equipment, test perfs 7514'-44'.
8. TIH w/RBP. Set at 7500'.
9. Spot 100 gallons acetic acid 7485'.
10. Perf w/2 JSPF: 7405'-16', 7438'-51', 7458'-60', 7476'-82'.
11. GIH w/packer, set at 7375'.
12. Acidize 7405'-82' w/4000 gallons 15% NE acid.
13. POH w/packer.
14. Run production equipment.

IN ABOVE SPACE DESCRIBE PROPOSED PROGRAM: IF PROPOSAL IS TO DEEPEN OR PLUG BACK, GIVE DATA ON PRESENT PRODUCTIVE ZONE AND PROPOSED NEW PRODUCTIVE ZONE. GIVE BLOWOUT PREVENTER PROGRAM, IF ANY.

I hereby certify that the information above is true and complete to the best of my knowledge and belief.

SIGNATURE J. A. Schaffer TITLE Dist. Operations Manager DATE 5/04/89

TYPE OR PRINT NAME

TELEPHONE NO.

(This space for State Use)

Orig. Signed by
Paul Kautz
Geologist

MAY 17 1989

APPROVED BY

TITLE

DATE

CONDITIONS OF APPROVAL, IF ANY:

Permit Expires 6 Months From Approval
Date Unless Drilling Underway

Submit to Appropriate
District Office
State Lease - 4 copies
Fee Lease - 3 copies

State of New Mexico
Energy, Minerals and Natural Resources Department

Form C-102
Revised 1-1-89

OIL CONSERVATION DIVISION

DISTRICT I
P.O. Box 1980, Hobbs, NM 88240

P.O. Box 2088

Santa Fe, New Mexico 87504-2088

DISTRICT II
P.O. Drawer DD, Artesia, NM 88210

DISTRICT III
1000 Rio Brazos Rd., Aztec, NM 87410

WELL LOCATION AND ACREAGE DEDICATION PLAT

All Distances must be from the outer boundaries of the section

Operator Texaco Producing Inc.			Lease Mexico "L"		Well No. 11
Unit Letter C	Section 5	Township 25-S	Range 38-E	NMPM	County Lea
Actual Footage Location of Well: 516 feet from the North line and 2130 feet from the West line					
Ground level Elev. 3133	Producing Formation Devonian		Pool Dollarhide Devonian		Dedicated Acreage: 40 Acres

- Outline the acreage dedicated to the subject well by colored pencil or hatchure marks on the plat below.
- If more than one lease is dedicated to the well, outline each and identify the ownership thereof (both as to working interest and royalty).
- If more than one lease of different ownership is dedicated to the well, have the interest of all owners been consolidated by communitization, unitization, force-pooling, etc.?
☐ Yes ☐ No If answer is "yes" type of consolidation _____
If answer is "no" list the owners and tract descriptions which have actually been consolidated. (Use reverse side of this form if necessary). _____
No allowable will be assigned to the well until all interests have been consolidated (by communitization, unitization, forced-pooling, or otherwise) or until a non-standard unit, eliminating such interest, has been approved by the Division.

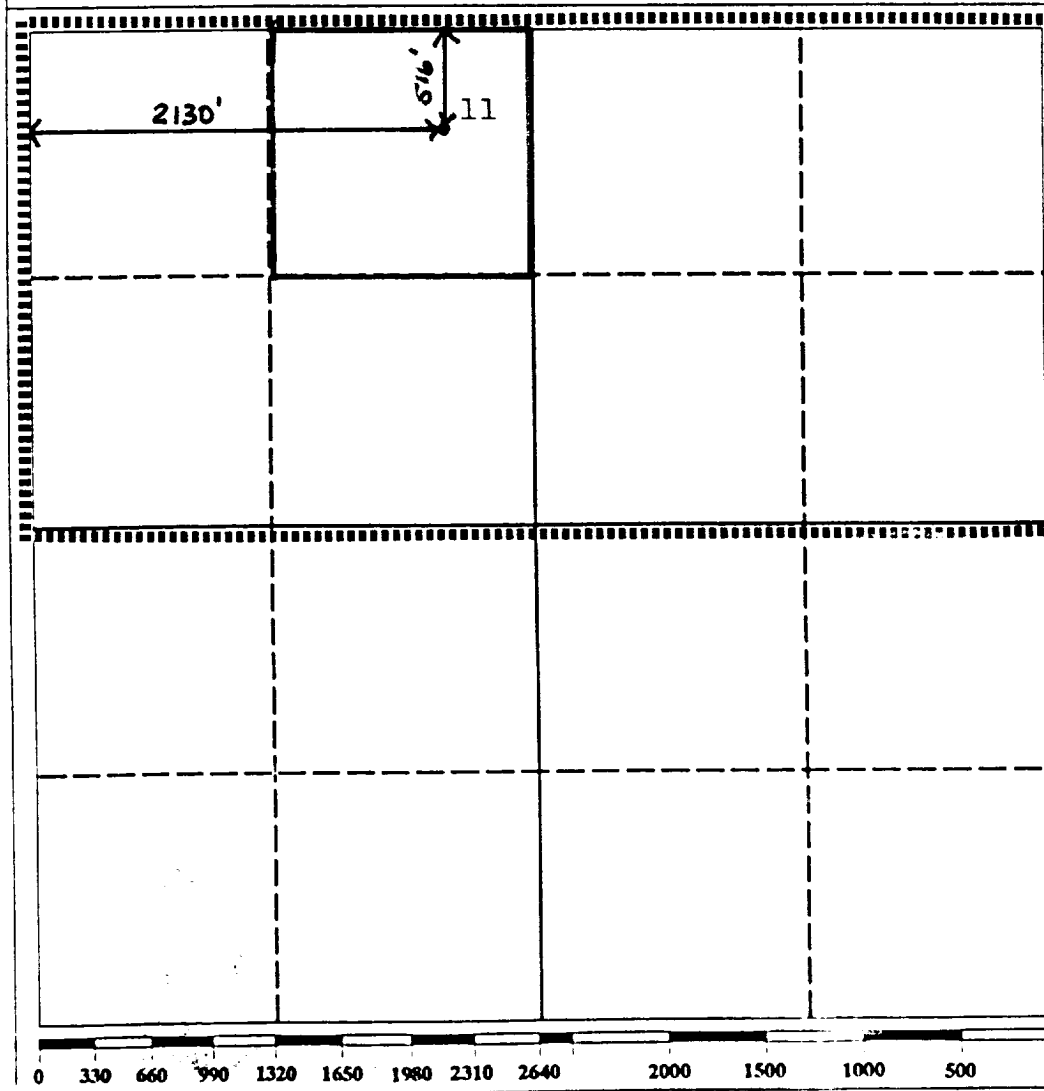

OPERATOR CERTIFICATION

I hereby certify that the information contained herein is true and complete to the best of my knowledge and belief.

Signature

Printed Name

J. A. Schaffer

Position

Dist. Opr. Mgr.

Company

Texaco Prod. Inc.

Date

05-04-89

SURVEYOR CERTIFICATION

I hereby certify that the well location shown on this plat was plotted from field notes of actual surveys made by me or under my supervision, and that the same is true and correct to the best of my knowledge and belief.

Date Surveyed

Signature & Seal of
Professional Surveyor

Certificate No.