

COPY TO O. C. C.

HOBBBS

(SUBMIT IN TRIPLICATE)

Budget Bureau No. 42-R358.4.  
Approval expires 12-31-60.

Santa Fe, New Mexico

Land Office

0820

Lease No.

Unit

**APPROVED**

UNITED STATES  
DEPARTMENT OF THE INTERIOR  
GEOLOGICAL SURVEY

A. P. KLEEMAN  
DISTRICT ENGINEER

**SUNDRY NOTICES AND REPORTS ON WELLS**

NOTICE OF INTENTION TO DRILL	<input checked="" type="checkbox"/>	SUBSEQUENT REPORT OF WATER SHUT-OFF
NOTICE OF INTENTION TO CHANGE PLANS		SUBSEQUENT REPORT OF SHOOTING OR ACIDIZING
NOTICE OF INTENTION TO TEST WATER SHUT-OFF		SUBSEQUENT REPORT OF ALTERING CASING
NOTICE OF INTENTION TO RE-DRILL OR REPAIR WELL		SUBSEQUENT REPORT OF RE-DRILLING OR REPAIR
NOTICE OF INTENTION TO SHOOT OR ACIDIZE		SUBSEQUENT REPORT OF ABANDONMENT
NOTICE OF INTENTION TO PULL OR ALTER CASING		SUPPLEMENTARY WELL HISTORY
NOTICE OF INTENTION TO ABANDON WELL		

(INDICATE ABOVE BY CHECK MARK NATURE OF REPORT, NOTICE, OR OTHER DATA)

March 9th, 19 59

Sinclair-Federal  
Well No. 1 is located 1980 ft. from <sup>(N)</sup>~~(S)~~ line and 660 ft. from <sup>(E)</sup>~~(W)~~ line of sec. 28

SE/4NW Sec. 28 (1/4 Sec. and Sec. No.)  
26S (Twp.) 38E (Range) NMPM (Meridian)  
Wildcat (Field) Lea (County or Subdivision) New Mexico (State or Territory)

The elevation of the derrick floor above sea level is \_\_\_\_\_ ft.

**DETAILS OF WORK**

(State names of and expected depths to objective sands; show sizes, weights, and lengths of proposed casings; indicate mudding jobs, cementing points, and all other important proposed work)

This well will be drilled with cable tools. We will set approximately 150' of 13 3/8" casing; approximately 650' of 10 3/4" casing; approximately 1100' of 8 5/8" casing and cement with 50 sacks. We will then pull the 10 3/4" casing. We will drill to test the San Andres Formation at approximately 4500 feet, and if productive will run 7" casing.

\* Conditions:

- (1) 13 3/8" casing to be cemented if any surface water sands are encountered.
- (2) Cementing program for the 7" production string to be approved before the casing is run.

I understand that this plan of work must receive approval in writing by the Geological Survey before operations may be commenced.

Company William A. & Edward R. Hudson

Address 1810 Electric Building

Port Worth, Texas

By *Edward R. Hudson*

Title Partner

**NEW MEXICO OIL CONSERVATION COMMISSION**  
**WELL LOCATION AND ACREAGE DEDICATION PLAT**

FORM C-128  
 Revised 5-1-57

SEE INSTRUCTIONS FOR COMPLETING THIS FORM ON THE REVERSE SIDE

Operator <b>Wm. A &amp; Edward R. Hudson</b>					Lease <b>1950 MAR 17</b>		Well No. <b>1</b>	
Unit Letter <b>F</b>	Section <b>28</b>	Township <b>26 S</b>	Range <b>38 E</b>	County <b>Lea</b>				
Actual Footage Location of Well: <b>1980</b> feet from the <b>North</b> line and <b>660</b> feet from the <b>East</b> line								
Ground Level Elev.		Producing Formation <b>San Andres</b>		Pool <b>Wildcat</b>		Dedicated Acreage: <b>49.17</b> Acres		

1. Is the Operator the only owner in the dedicated acreage outlined on the plat below? YES ☒ NO ☐ ("Owner" means the person who has the right to drill into and to produce from any pool and to appropriate the production either for himself or for himself and another. (65-3-29 (e) NMSA 1935 (Comp.))
2. If the answer to question one is "no," have the interests of all the owners been consolidated by communitization agreement or otherwise? YES ☐ NO ☐ If answer is "yes," Type of Consolidation \_\_\_\_\_
3. If the answer to question two is "no," list all the owners and their respective interests below: \_\_\_\_\_

Owner	Land Description
	<b>MAR 17 1959</b>
	<b>U. S. GEOLOGICAL SURVEY</b>
	<b>HOBBS, NEW MEXICO</b>

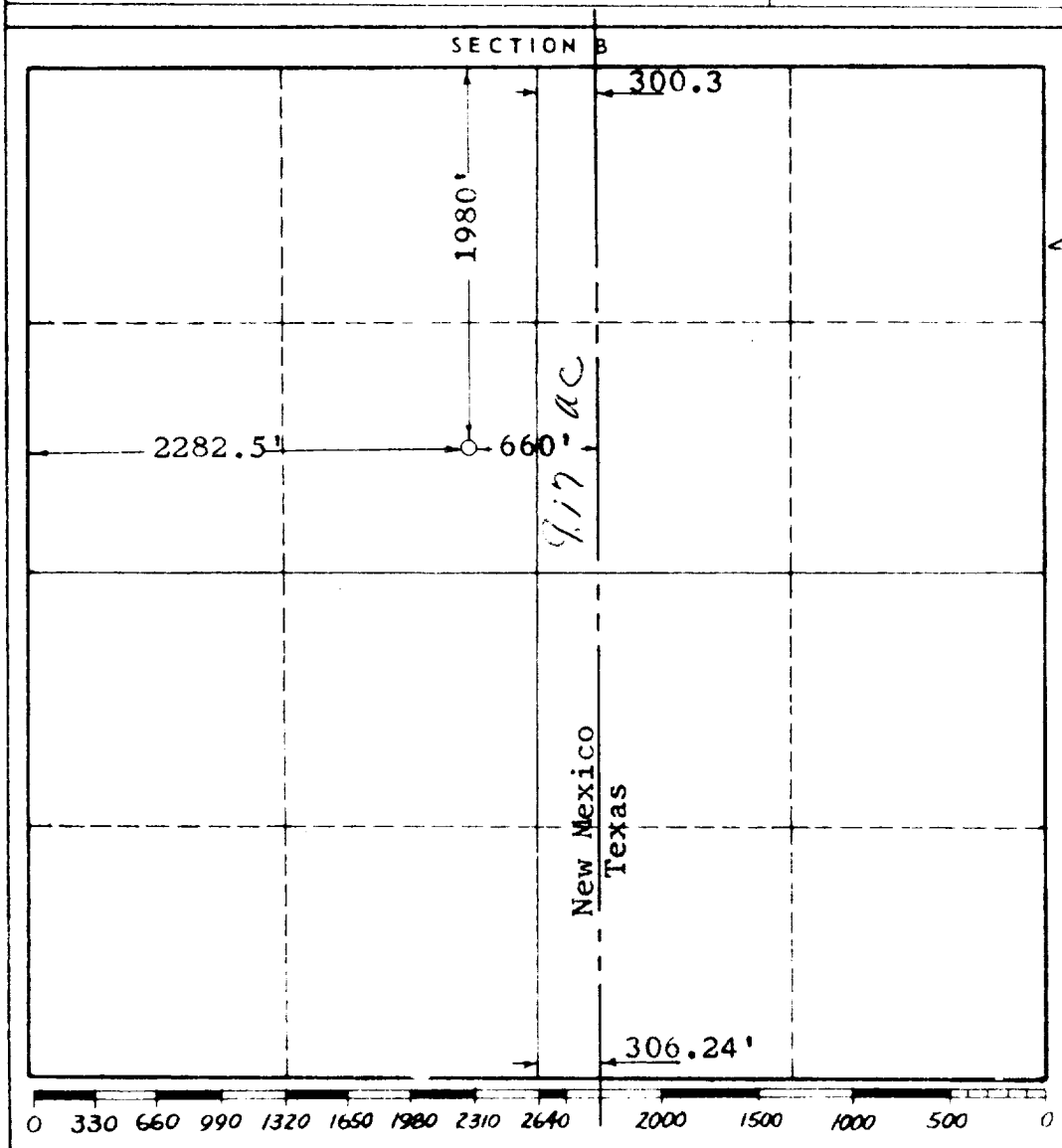

**CERTIFICATION**

I hereby certify that the information in SECTION A above is true and complete to the best of my knowledge and belief.

*Edward R. Hudson*  
 Name  
**Partner**  
 Position  
**WILLIAM A. & EDWARD R. HUDSON**  
 Company  
**March 9th, 1959**  
 Date

I hereby certify that the well location shown on the plat in SECTION B was plotted from field notes of actual surveys made by me or under my supervision, and that the same is true and correct to the best of my knowledge and belief.

Date Surveyed  
**3-4-59**  
 Registered Professional Engineer and/or Land Surveyor, **JOHN W. WEST**  
*John W. West*  
 Certificate No.  
**N. M. - P. E. & L. S. NO. 676**