

NEW MEXICO OIL CONSERVATION COMMISSION
WELL LOCATION AND ACREAGE DEDICATION PLAT

FORM C-128
Revised 5/1/57

SEE INSTRUCTIONS FOR COMPLETING THIS FORM ON THE REVERSE SIDE

SECTION A

Operator Woodriver Oil & Refining Co.		Lease Kills Federal		Well No. 6	
Unit Letter B	Section 35	Township 26 S	Range 37 E	County Leon	
Actual Footage Location of Well: 20 feet from the South line and 1315 feet from the East line					
Ground Level Elev. 2977.78	Producing Formation		Pool Rhodes	Dedicated Acreage: Water Injection Well Acres	

1. Is the Operator the only owner in the dedicated acreage outlined on the plat below? YES ☒ NO ☐ ("Owner" means the person who has the right to drill into and to produce from any pool and to appropriate the production either for himself or for himself and another. (65-3-29 (e) NMSA 1935 Comp.)
2. If the answer to question one is "no," have the interests of all the owners been consolidated by communitization agreement or otherwise? YES ☐ NO ☐ . If answer is "yes," Type of Consolidation _____
3. If the answer to question two is "no," list all the owners and their respective interests below:

Owner	Land Description

RECEIVED

JUL 10 1959

U. S. GEOLOGICAL SURVEY
HOBBS, NEW MEXICO

SECTION B

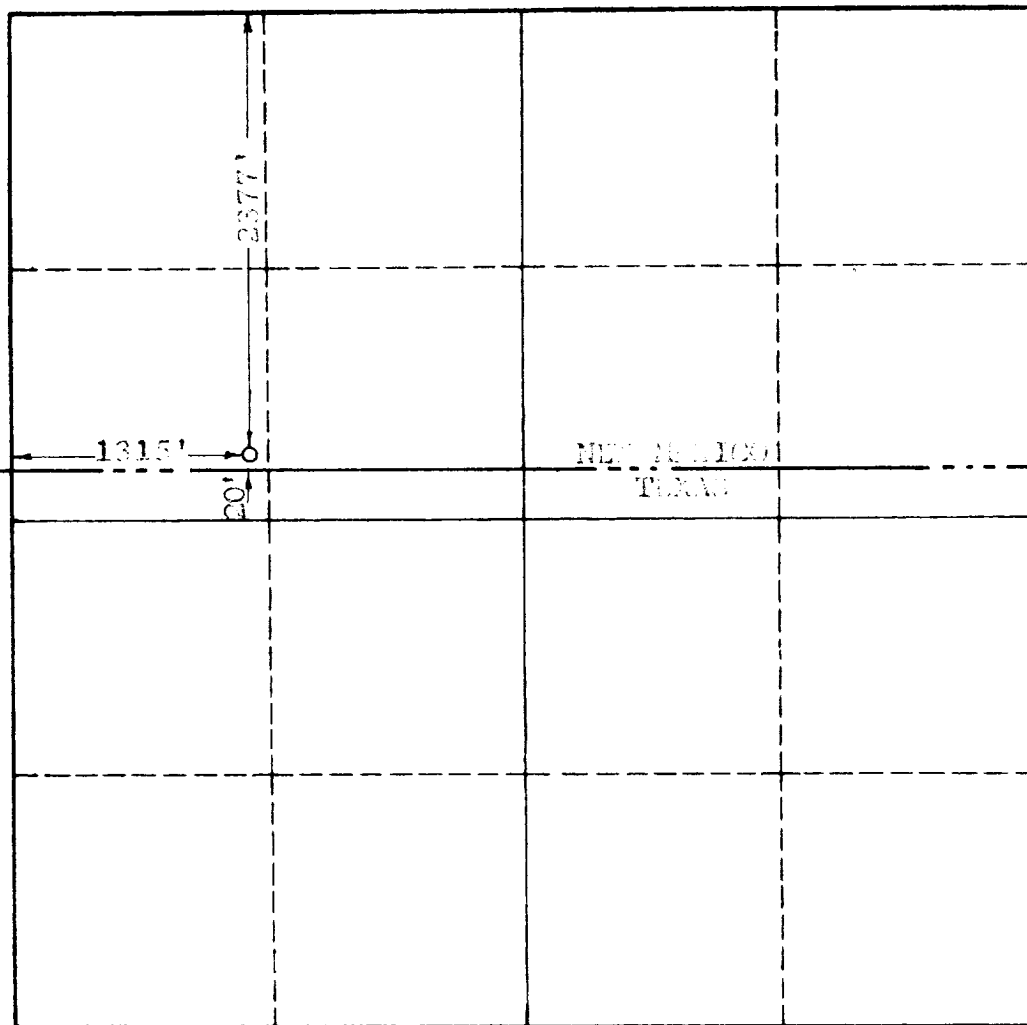

CERTIFICATION

I hereby certify that the information in SECTION A above is true and complete to the best of my knowledge and belief.

Name
Agent
Position
WOODRIVER OIL & REFINING CO.
Company
July 8, 1959
Date

I hereby certify that the well location shown on the plat in SECTION B was plotted from field notes of actual surveys made by me or under my supervision, and that the same is true and correct to the best of my knowledge and belief.

Date Surveyed
July 2, 1959
Registered Professional Engineer
and/or Land Surveyor, JOHN W. WEST
Certificate No.
N.M. - P.E. & L.S. NO. 676